

GEODETSURVEY OF N.S.W.

CENTRAL MAPPING AUTHORITY

GEODETTIC STATION RECONNAISSANCE and MAINTENANCE REPORT

Description:

1. Cleared by lanes bearing $2.5^{\circ} 35'$, $43^{\circ} 83'$, $118^{\circ} 194'$, $247^{\circ} 282'$, from Trig. Mast $328^{\circ} 351'$.
2. Mast & Vanes have been painted white & black respectively.
3. The station/pillar was unpiled/~~not unpiled~~/~~constructed on~~ 1.2×3 dimensions now being: 19.79 , diameters now being: Description of mark: ~~Brass Plate~~ 145 should be explicit, e.g., S/Steel Pillar Plate, Steel plug, Brass plug, Bolt, G.I. Pipe Height of mark: 0.33 m. ^{above} ~~below~~ ~~concrete~~ Mark is 0.07 m. Diameter of Vanes (vertical): 0.765 m. Height of Top Vanes to Top Mark/Pillar-plate 3.007 m. Diameter of Cairn: 3.0 m. Diameter of Cairn: 2.46 m. Name Plate found/not found/placed. Length of Mast: 3.040 m. (approximate if not unpiled)
4. A $S.S.M.$ 1639 set in conc/rock has been placed/round, bearing 2.65° M from Mast/Plug/Pillar
5. A $G.I.P.P.$ set in conc/rock has been placed/round, bearing 9° M from Mast/Plug/Pillar
6. A set in conc/rock has been placed/round, bearing 0° M from Mast/Plug/Pillar
7. A set in conc/rock has been placed/round, bearing 0° M from Mast/Plug/Pillar
8. Action required:

STATION: **Black Jack** No: **965**
 MAP SHEET SCALE 1:250 000
 INSPECTED BY: **W.M. Gillivray** DATE: **13.3.79**
 AUTHORITY: **CMIA** FIELD BOOK: **1657**

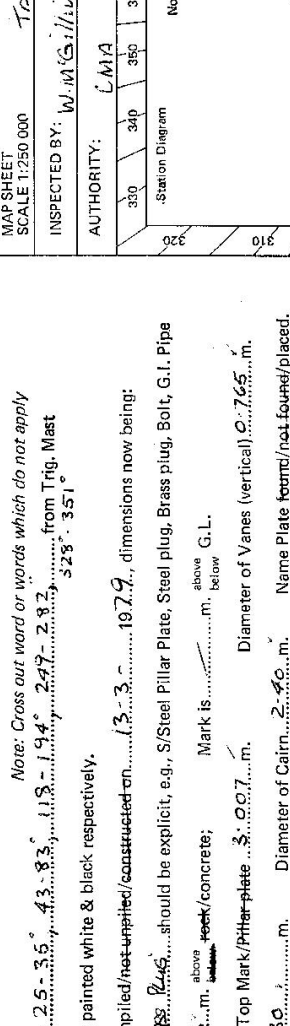

Mark	Direction	Horiz. Distance	Height Difference	Mark	Direction	Horiz. Distance	Height Difference
YELLOW PIN	$359^{\circ} 59' 60''$		above standpt.	YELLOW PIN	$359^{\circ} 59' 60''$		above standpt.
S.S.M. 1639	$132^{\circ} 57' 35''$	2.524	above standpt.	G.I. Pipe	$269^{\circ} 15' 05''$	4.357	above standpt.
G.I. Pipe	$234^{\circ} 41' 00''$	3.073	below	DUNGSOWAN Pillar	$272^{\circ} 19' 00''$		above standpt.
DUNGSOWAN Pillar	$272^{\circ} 18' 40''$		below	TRIG PLUG	$312^{\circ} 57' 05''$	2.526	below
			above standpt.				above standpt.
			below				below
			above standpt.				above standpt.
			below				below
			above standpt.				above standpt.
			below				below

STANDPOINT: **BRASS PLUG** STATION: **S.S.M. N° 1639**
 Prepared by: *[Signature]* Checked: *[Signature]* Noted on U.T.M. Card
 S: 2733-1

St 2733-2 D. West, Government Printer

STATION **BLACK JACK - 965**

Owner's Name: **S. HIGGINSBOTHAM**
 Address: **ALLOWAY BANK**
VIA DANBARIAN
 Phone: **677507**

Current Occupant:
 Address:
 Phone:

ACCESS

Access Report of 27/10/1971 was found suitable/unsuitable.
TRANSITION TO NEVINGHA
 INTERSECTION THROUGH ARMADALE, MANDEL.
 TURN RIGHT OF BURNED ON TO GRAVEL ROAD
 TAKE LEFT FORK THEN TURN RIGHT.
 CROSS ROAD GO STRAIGHT AHEAD SIGN BENDS.
 GATE. "ALLOWAY BANK".
 DOWNST HOUSE ON RIGHT. FOLLOW TRACK FIRST SKEDS
 DOUBLE IRON GATE, HOUSE ON RIGHT YARDS ON LEFT
 DOUBLE IRON GATE TRACK VEERS TO RIGHT.
 DOUBLE IRON GATE.
 GATE. TANK & MILL FOLLOW TRACK PASS OLD HAY STACK ON RIGHT
 SLIP RAILS. TAKE TRACK UP HILL TO LEFT, TAKE GATE ON LEFT
 WOODEN GATE IN CORNER NEAR LARGE TREE GO THROUGH GATE &
 FOLLOW TRACK FOR ABOUT 30M TURN LEFT & FIND WAY UP ONTO RIDGE,
 FOLLOW RIDGE UP TO FENCE, CONTINUE AROUND FENCE, THEN UP TO
 ROCKY OUTCROP. 4M CLIMB WITH LOAD.
 * OWNER MUST BE SEEN BEFORE PROCEEDING TO GS.
NO CLIMBING WITHOUT PERMISSION OF OWNER

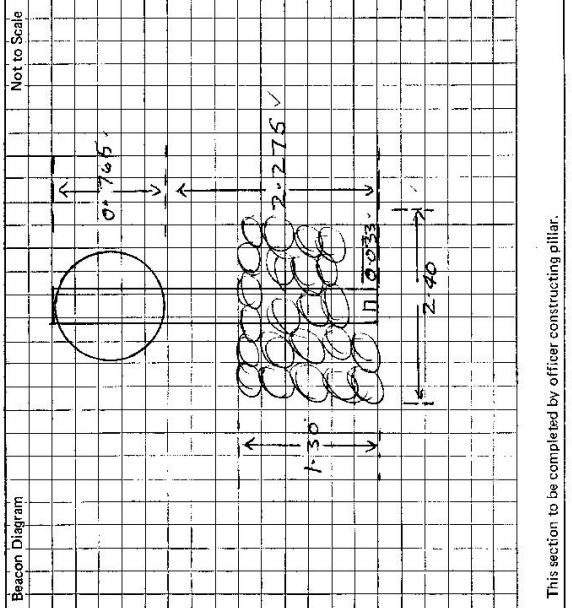

This section to be completed by officer constructing pillar.

Original station mark found/net found:

Description of mark: **BRASS PEGS IN CONC** ✓

Original beacon found/net found:

Description of beacon: **CAIRN MARSH x V. RANSEY** ✓

Height Top of Vanes to Top Mark: **3.722** ✓ m.

Height of mark: **0.33** ✓ above rock/conc m. below G.L.

Diameter of Vanes: **0.765** ✓ m. Height of Cairn: **1.40** ✓ m.

Original Beacon has/has not been destroyed by me.

Record of Station

Date

CENTRAL MAPPING AUTHORITY

GEODETIC SURVEY OF R.S.W.
 GEODETIC STATION RECONNAISSANCE and MAINTENANCE REPORT

Description:

1. Cleared by lanes bearing..... Note: Cross out word or words which do not apply
 from Trig. Mast

2. Mast & Vanes have been painted white & black respectively.

3. The station/~~pillar~~ was ~~replaced~~/not unpiled/~~replaced~~ on August 14 19.79, dimensions now being:

Description of mark..... ~~should be explicitly e.g. S/Steel Pillar/Plate/Steel plug, Brass plug, Berty-G.I. Pipe~~

Height of mark..... m. above below rock/concrete; Mark is..... m. above below G.L.

Height of Top Vanes to Top Mark/~~Plate~~..... m. Diameter of Vanes (vertical)..... 0.160..... m.

Height of Cairn..... m. Diameter of Cairn..... m. Name Plate found/~~not found~~/~~placed~~

Length of Mast m. (approximate if not unpiled)

4. A..... S.S.M. 1639..... set in conc/~~rock~~ has been ~~placed~~/found, bearing..... 267.°M from Mast/~~Plug/Pillar~~

5. A..... G.I. Pipe..... set in conc/~~rock~~ has been ~~placed~~/found, bearing..... 8.°M from Mast/~~Plug/Pillar~~

6. A..... set in conc/rock has been placed/found, bearing..... °M from Mast/Plug/Pillar

7. A..... set in conc/rock has been placed/found, bearing..... °M from Mast/Plug/Pillar

8. Action required:.....

STANDPOINT: G.I.Nail in G.I. Pipe found in Conc. STANDPOINT: S.S.M. 1639 found in Concrete

Mark	Direction	Horiz. Distance	Height Difference	Mark	Direction	Horiz. Distance	Height Difference
Bottom	198° 33 32	3.033	2.179 above	G.I.Nail/G.I.Pipe	53° 27 28	4.356	0.046 above
Mean Mast of Vanes	233 27 01	4.356	0.046 above	CRAWNEY (P)	196° 06 23		above standpt.
S.S.M. 1639	144° 13 56		below	RAZORBACK	219 46 49		below standpt.
YEEROWIN (P)	180 09 45		below	GOONOO GOONOO	290 46 08		below standpt.
NUNDIE	196 06 36		below	GOAT MOUNTAIN (P)	356 46 50		below standpt.
CRAWNEY (P)	281 34 55		below				below standpt.
LOOMBERAH (P)	106 25 41		below				below standpt.
SANDON VOR Radome			below				below standpt.

Prepared by: *H. P. Jackson*

Checked: *H. P. Jackson*

Sr 2733-1

Checked

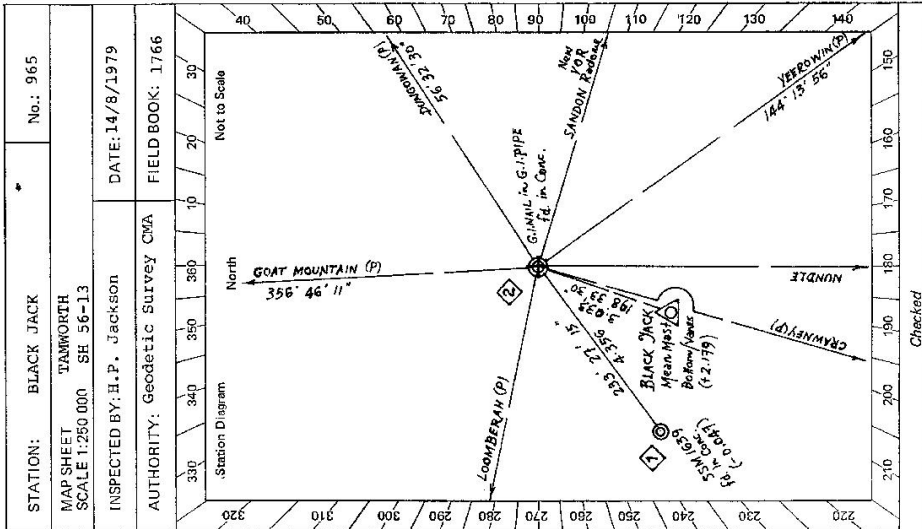

STATION: BLACK JACK No.: 965

MAP SHEET TAMWORTH SH 56-13

INSPECTED BY: H. P. Jackson DATE: 14/8/1979

AUTHORITY: Geodetic Survey CMA FIELD BOOK: 1766

