

TS 7370

STATION **SMA KMM** **TS 7370**

Co: \_\_\_\_\_  
 Map Sheet: \_\_\_\_\_  
 Inspected by: \_\_\_\_\_  
 Authority: \_\_\_\_\_  
 Beacon Diagram: \_\_\_\_\_  
 No: \_\_\_\_\_  
 Date: \_\_\_\_\_  
 Field Book: \_\_\_\_\_  
 Not to Scale

Please see  

Date: \_\_\_\_\_  
 Record of Station

Department of Lands  
 Integration Survey of N.S.W.  
 RECONNAISSANCE and MAINTENANCE REPORT

Note: Cross out word or words which do not apply

This Trig. Station has been:-

1. Completely cleared to permit 360° vision to surrounding Trigs.
2. Cleared by lanes bearing..... from Trig. Mast
3. Trig. Mast & Vanes have been painted white & black respectively.
4. The Trig. was unpiled/not unpiled, dimensions now being:

Description of mark..... should be explicit, e.g. Steel plug, Brass plug, Bolt, Concrete Pillar

Height of mark..... m above rock, concrete..... m below G.L.

Height of Top Vanes to Top Mark/Top pillar plate..... m Diameter of Vanes (vertical)..... m.

Height of Cairn..... m. Diameter of Cairn..... m.

Length of Mast..... m. (approximate if not unpiled)

5. A..... set in conc/rock has been placed/fd..... m. bearing..... °M from Trig. Mast/pillar
6. A..... set in conc/soil has been placed/fd..... m. bearing..... °M from Trig. Mast/pillar
7. A..... set in conc/soil has been placed/fd..... m. bearing..... °M from Trig. Mast/pillar
8. A..... set in conc/rock has been placed/fd..... m. bearing..... °M from Trig. Mast/pillar

9. Connection..... to..... m. bearing..... °M

10. Connection..... to..... m. bearing..... °M

11. Connection..... to..... m. bearing..... °M

12. Connection..... to..... m. bearing..... °M

13. Diff. Ht. .... is..... m. above below

14. Diff. Ht. .... is..... m. above below

15. Diff. Ht. .... is..... m. above below

16. Diff. Ht. .... is..... m. above below

Prepared by: \_\_\_\_\_  
 Checked: \_\_\_\_\_

see SNOWY CP) TS 7370  
 STATION: SMA KMM No: 5345

MAP SHEET SCALE 1:250 000  
 BESA

INSPECTED BY: I. Robins DATE: 13-7-82

AUTHORITY: C.M.A. FIELD BOOK:

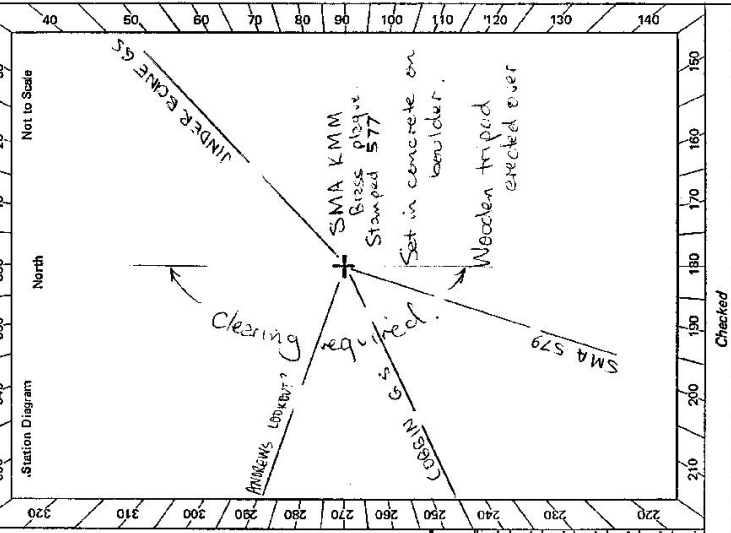

CENTRAL MAPPING AUTHORITY

GEODETTIC SURVEY OF N.S.W. GEODETTIC STATION RECONNAISSANCE and MAINTENANCE REPORT

- Description: *Note: Cross out word or words which do not apply*
- Cleared by lanes bearing. *Requires light clearing (possibly from Trig. Mast)*
  - Mast & Vanes have been painted white & black *respectively*. *Need repainting (the tower with bawshwool)*
  - The station/pillar was unpiled/not unpiled/constructed on.....19....., dimensions now being:
  - Description of mark. *Brass plate* should be explicit, e.g., S/Steel Pillar Plate, Steel plug, Brass plug, Bolt, G.I. Pipe
  - Height of mark.....0.85.....m. *above rock/concrete*; Mark is *set* 0.3 m. *above* G.L.
  - Height of Top Vanes to Top Mark/Pillar plate.....3.795.....m. Diameter of Vanes (vertical).....m.
  - Height of Cairn.....m. Diameter of Cairn.....m. Name Plate found/~~not found~~/placed.
  - Length of Mast.....m. (approximate if not unpiled)
  - A..... set in conc/rock has been placed/found, bearing.....°M from Mast/Plug/Pillar
  - A..... set in conc/rock has been placed/found, bearing.....°M from Mast/Plug/Pillar
  - A..... set in conc/rock has been placed/found, bearing.....°M from Mast/Plug/Pillar
  - A..... set in conc/rock has been placed/found, bearing.....°M from Mast/Plug/Pillar
  - Action required: *light clearing 360°; repainting*

STANDPOINT:				STANDPOINT:			
Mark	Direction	Horiz. Distance	Height Difference	Mark	Direction	Horiz. Distance	Height Difference
			above standpt.				above standpt.
			below				below
			above standpt.				above standpt.
			below				below
			above standpt.				above standpt.
			below				below
			above standpt.				above standpt.
			below				below
			above standpt.				above standpt.
			below				below
			above standpt.				above standpt.
			below				below

Prepared by: I. Robins July 82 checked:

Noted on U.T.M. Card

GS 24

ST 2733-2 D. West, Government Printer Beacon Diagram	Not to Scale <p>Wooden Tripod (0.106 x 0.108 section) height</p>	STATION SMA KMM <sup>TS</sup> 7370 Owner's Name: ..... Address: ..... Phone: ..... Current Occupant: ..... Address: ..... Phone: ..... ACCESS Access Report of 12/1/1988 was found suitable/unsuitable. 0-0 Jindabyne Post Office head east towards Cooma 2-32 Cross spillway Jindabyne Dam. 5-38 Turn off Hwy at Nead cutting follow track back to south along fence above cutting 5-45 Turn right through gate & follow track downhill then bear left to small saddle. 5-73 Park vehicle (4WD desirable). Possible to drive to within 10m of Trig.
		Record of Station
Date		

This section to be completed by officer constructing pillar.

Original station mark found/not found.

Description of mark: .....

Original beacon found/not found.

Description of beacon: .....

Height Top of Vanes to Top Mark.....m.

Height of mark.....m. above rock/conc.....m. above G.L.  
 below below

Diameter of Vanes.....m. Height of Cairn.....m.

Original Beacon has/has not been destroyed by me.

see SNOWY

GEODETTIC SURVEY OF NSW

CENTRAL MAPPING AUTHORITY

GEODETTIC STATION RECONNAISSANCE and MAINTENANCE REPORT

Description:

1. Cleared by lanes bearing..... Note: Cross out word or words which do not apply
2. Mast & Vanes have been painted white & black respectively.
3. The station/pillar was unpiled/hot unpiled/constructed on..... 19..... dimensions now being:  
Description of mark..... should be explicit, e.g., S/Steel Pillar Plate-Steel plug, Brass plug, Bolt, G.I. Pipe
- Height of mark..... above below rock/concrete; Mark is..... above below G.L.
- Height of Top Vanes to Top Mark/Pillar plate..... m. Diameter of Vanes (vertical)..... m.
- Height of Cairn..... m. Diameter of Cairn..... m. Name Plate found/not found/placed.
- Length of Mast..... m. (approximate if not unpiled)
4. A..... set in conc/rock has been placed/found, bearing.....° M from Mast/Plug/Pillar
5. A..... set in conc/rock has been placed/found, bearing.....° M from Mast/Plug/Pillar
6. A..... set in conc/rock has been placed/found, bearing.....° M from Mast/Plug/Pillar
7. A..... set in conc/rock has been placed/found, bearing.....° M from Mast/Plug/Pillar
8. Action required:.....

STANDPOINT:

Mark	Direction	Horiz. Distance	Height Difference	Mark	Direction	Horiz. Distance	Height Difference
			above standpt.				above standpt.
			below standpt.				below standpt.
			above standpt.				above standpt.
			below standpt.				below standpt.
			above standpt.				above standpt.
			below standpt.				below standpt.
			above standpt.				above standpt.
			below standpt.				below standpt.

Prepared by: *P.B. 25-9-89*

Checked: *[Signature]*

Noted on U.T.M. Card

SI 2733-1

STATION: S.M.A. 577 (Snowy Mountains) No.: 157370  
 MAP SHEET SCALE 1:250,000  
 INSPECTED BY: P.B. DATE: 23-8-89  
 AUTHORITY: NSW INFORMATION SERVICE FIELD BOOK: Nil  
 Station Diagram: [Diagram showing a grid from 320 to 340 on the y-axis and 170 to 190 on the x-axis. A crosshair is at the center (330, 180). The text 'North' is written vertically. 'Not to Scale' is written at the bottom right of the diagram.]

# 2733-2 D. West, Government Printer Beacon Diagram Not to Scale	STATION <b>500 SNOWY</b> <b>S.M.A. 577</b> TS <b>7370</b>	Owner's Name: <u>Snowy Mountains</u> Address: <u>ANONYMOUS</u> Phone: ..... Current Occupant: ..... Address: ..... Phone: ..... ACCESS Access Report of 23.1.8./1988 was found suitable/unsuitable. FEATURE 0.800 ENTRANCE TO SNOWY MOUNTAINS HOTEL - HEAD TOWARDS JINDABYNE 1.00 PASS ROAD ON RIGHT TO EAST JINDABYNE 3.00 PASS RAINBOW DRIVE ON RIGHT 3.27 TURN RIGHT ONTO TRACK UP EMBANKMENT 3.34 THROUGH GATE WAY - NO GATE FOLLOW TRACK LEFT 3.45 TAKE LEFT TRACK. 3.59 STOP VEHICLE AND WALK UP SAUR TO S.M.A 577 1 MINUTE WALK.
		This section to be completed by officer constructing pillar. Original station mark found/not found. Description of mark: ..... Original beacon found/not found. Description of beacon: ..... Height Top of Vanes to Top Mark: .....ft. Height of mark: .....m. above G.L. below rock/core .....m. below Diameter of Vanes: .....m. Height of Cairn .....m. Original Beacon has/not been destroyed by me.
		Date ..... Record of Station .....

**SNOWY**

**7370**

GEODETIC SURVEY OF N.S.W.

LAND INFORMATION CENTRE

GEODETIC STATION RECONNAISSANCE and MAINTENANCE REPORT

STATION: SMA KMM (SMA 577) No.:  
 MAP SHEET: BESA SCALE 1:250 000 BERRIDALE 1:250 000  
 INSPECTED BY: A. Sivertsen DATE: 3 Feb 1992  
 AUTHORITY: LIC FIELD BOOK: 2110

- Description:
- Cleared by lanes bearing..... Note: Cross out word or words which do not apply
  - Mast & Vanes have been painted white & black respectively. **OLD WOODEN TRIPOD**
  - The station/pillar was unpiled/not unpiled/constructed on..... 19....., dimensions now being:  
**SMA 577**
- Description of mark..... should be explicit, e.g., S/Steel Pillar Plate, Steel plug, Brass plug, Bolt, G.I. Pipe
- Height of mark.....m. <sup>above</sup> rock/concrete; Mark is.....m. <sup>above</sup> G.L.
- Height of Top Vanes to Top Mark/Pillar plate .....m. Diameter of Vanes (vertical!).....m.
- Height of Cairn.....m. Diameter of Cairn.....m. Name Plate found/not found/placed.
- Length of Mast .....m. (approximate if not unpiled)
- A.....set in conc/rock has been placed/found, bearing.....° M from Mast/Plug/Pillar
  - A.....set in conc/rock has been placed/found, bearing.....° M from Mast/Plug/Pillar
  - A.....set in conc/rock has been placed/found, bearing.....° M from Mast/Plug/Pillar
  - A.....set in conc/rock has been placed/found, bearing.....° M from Mast/Plug/Pillar

8. Action required: **Place eccs & concentric (P)**

STANDPOINT:			
Mark	Direction	Horiz. Distance	Height Difference
			above standpt.
			below standpt.
			above standpt.
			below standpt.
			above standpt.
			below standpt.
			above standpt.
			below standpt.
			above standpt.
			below standpt.
			above standpt.
			below standpt.
			above standpt.
			below standpt.
			above standpt.
			below standpt.
			above standpt.
			below standpt.

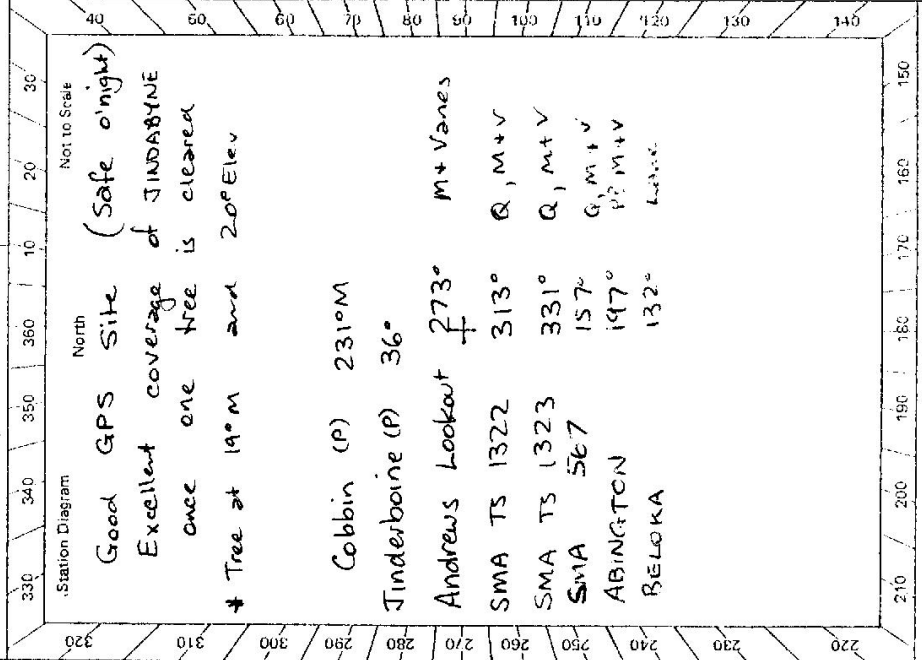

Prepared by: *[Signature]* Checked: *[Signature]* Noted on U.T.M. Card

TS 7370

STATION SMA KMM (SMA 577)

St: 2733-2 D. West, Government Printer

<p>Beacon Diagram</p> <div style="border: 1px solid black; width: 100%; height: 150px; margin-bottom: 5px;"></div> <p style="text-align: right; margin-right: 5px;">Not to Scale</p>	<p>Owner's Name: SMA                  Address: Contact STEVE DONKERS                  COOMA                  Phone: .....</p> <p>Current Occupant: .....</p> <p>Address: .....</p> <p>Phone: .....</p> <p>DATE: Feb 1992 ACCESS 4WD                  Access Report of...../...../19..... was found suitable/unsuitable.</p> <p>0.0 JINDABYNE PO. Head towards COOMA                  2.8 Bridge / Dam over SNOWY R                  5.27 Turn hard L at end of cutting                  5.33 Go through old gate on R                  5.57 Turn R to top of hill                  5.60 10 metre walk to SMA 577</p>
<p>This section to be completed by officer constructing pillar.</p>	
<p>Original station mark found/not found.</p> <p>Description of mark: .....</p> <p>Original beacon found/not found.</p> <p>Description of beacon: .....</p> <p>Height Top of Vanes to Top Mark.....m.                  above G.L.                  Height of mark.....m. rock/conc.....m. below                  Diameter of Vanes.....m. Height of Cairn.....m.                  Original Beacon has/has not been destroyed by me.</p>	
<p>Date</p>	<p>Record of Station</p>

LAND INFORMATION CENTRE

GEODETIC STATION RECONNAISSANCE and MAINTENANCE REPORT

Card No 1 of 2 cards

STATION: SNOWY PILLAR No.: 7370

MAP SHEET SCALE 1:250 000

BEGA.

INSPECTED BY: D.J. Kain DATE: 24.2.1992

AUTHORITY: L.I.C. FIELD BOOK: 623

Description: Note: Cross out word or words which do not apply

1. Cleared by ~~the bearing~~ To Permit 360° vision from Trig. Mast
2. Mast & Vanes have been painted white & black respectively. ✓
3. The ~~station~~ pillar was ~~not~~ re-erected / constructed on 22 February 1992, dimensions now being: Galvanised Steel  
Description of mark: Rivet Plate should be explicit, e.g., S/Steel Pillar Plate, Steel plug, Brass plug, Bolt, G.I. Pipe  
Height of mark: 1.285 m. above ~~rock~~ concrete; Mark is 1.535 m. above G.L.  
Height of Top Vanes to Top ~~mark~~ Pillar plate 1.445 m. Diameter of Vanes (vertical) 0.75 m.  
Height of Cairn:          m. Diameter of Cairn:          m. ~~Name Plate found/not found/placed.~~  
Length of Mast 1.545 m. (~~approximate if not measured~~)
4. A. Copper Nail set in conc/~~rock~~ has been placed/~~found~~, bearing 124° M from ~~the~~ Copper Pillar
5. A. G.I. Pipe set in conc/~~rock~~ has been placed/~~found~~, bearing 314° M from ~~the~~ Meeting Pillar
6. A. Steel Rod set in conc/~~rock~~ has been placed/~~found~~, bearing 314° M from ~~the~~ Meeting Pillar
7. A. Wagon Dump set in conc/~~rock~~ has been placed/~~found~~, bearing 124° M from ~~the~~ Meeting Pillar
8. Action required:

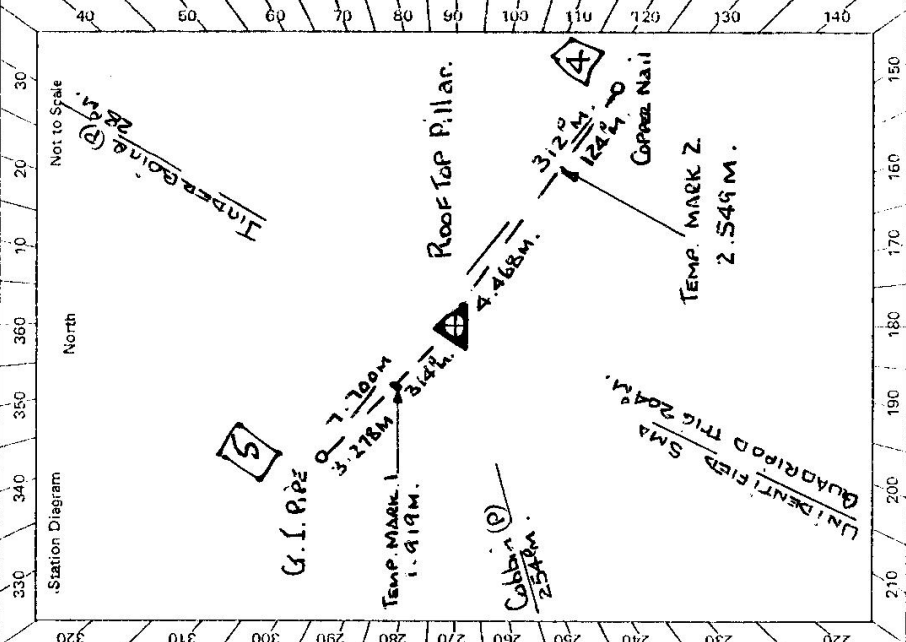

Mark	Direction	Horiz. Distance	Height Difference	Mark	Direction	Horiz. Distance	Height Difference
Cobbin (P)	0° 00' 00"	✓	above standpt.	Copper Nail	0° 00' 00"	✓	above standpt.
Steel Rod TM 1	71 54 47	1.919	1.715 below standpt.	G.I. Pipe	19 18 24	1.700	0.140 above standpt.
G.I. Pipe	71 53 59	3.277	1.809 below standpt.	Steel Rod TM 1	80 54 05	6.357	0.236 above standpt.
Jinder Boine (P)	164 35 42	✓	above standpt.	Roof Top Pillar	84 46 21	4.469	1.951 above standpt.
Dumpy TM 2	264 48 25	2.549	1.774 below standpt.	Dumpy TM 2	84 46 32	1.917	0.177 above standpt.
Copper Nail	264 49 12	4.467	1.949 below standpt.	Jinder Boine (P)	164 27 42	✓	above standpt.
Abington GS	326 09 39	✓	above standpt.	Abington GS	326 07 51	✓	above standpt.

STANDPOINT: Roof Top Pillar ✓ STANDPOINT: Copper Nail 4

Prepared by: D. Kain. Checked: Noted on U.T.M. Card



TS 7370  
No.: 5345

STATION: SNOWY G.S.  
MAP SHEET SCALE 1:250 000  
INSPECTED BY: D.J. Kain  
DATE: 20.2.92  
AUTHORITY: I.I.C.  
FIELD BOOK: 673

Land Information Centre,  
GEODETTIC SURVEY OF N.S.W.  
Card No. 2 of 2 CASE

GEODETTIC STATION RECONNAISSANCE and MAINTENANCE REPORT

- Description: *Note: Cross out word or words which do not apply*
- Cleared ~~by~~ ~~to~~ ~~bearing~~ ~~to~~ ~~Permit~~ ~~at~~ ~~Station~~ ~~from~~ ~~Trig. Mast~~
  - Mast ~~Van~~ ~~has~~ ~~been~~ ~~removed~~ ~~at~~ ~~station~~ ~~respectively~~.
  - The station/~~plate~~ was ~~unplanned~~ ~~removed~~ ~~on~~ ~~20.2.1992~~, dimensions now being: **Note - Root Top Pillar WAS PLACED CONCENTRIC TO ORIGINAL MARK ON 22.2.92**  
Description of mark: **SMA BRASS PLATE NO. 577** should be explicit, e.g., S/Steel Pillar Plate, Steel plug, Brass plug, Bolt, G.I. Pipe  
Height of mark: ~~LEVEL~~ ~~m.~~ ~~above~~ ~~ROCK~~ ~~concrete~~; Mark is ~~AT~~ ~~m.~~ ~~above~~ ~~G.L.~~
  - Height of Top Vanes to Top Mark/~~Plate~~ ~~is~~ ~~3.805~~ ~~m.~~ Diameter of Vanes (vertical) ~~0.5~~ ~~m.~~
  - Height of Cairn ~~is~~ ~~2.14~~ ~~m.~~ Diameter of Cairn ~~is~~ ~~0.5~~ ~~m.~~ Name/~~Plate~~ ~~found~~/~~not found~~/~~placed~~.
  - Length of Mast ~~is~~ ~~2.14~~ ~~m.~~ (approximate if not complete)
  - A ~~Copper Nail~~ ~~set~~ in conc/~~reek~~ has been placed/~~found~~, bearing ~~124~~ ~~°~~ ~~M~~ from ~~Mast~~/~~Plug~~/~~Plate~~
  - A ~~G.I. Pipe~~ ~~set~~ in conc/~~reek~~ has been placed/~~found~~, bearing ~~314~~ ~~°~~ ~~M~~ from ~~Mast~~/~~Plug~~/~~Plate~~
  - A ~~Steel Rod~~ ~~set~~ in conc/~~reek~~ has been placed/~~found~~, bearing ~~314~~ ~~°~~ ~~M~~ from ~~Mast~~/~~Plug~~/~~Plate~~
  - A ~~Wash~~ ~~set~~ in ~~concrete~~ ~~block~~ has been placed/~~found~~, bearing ~~124~~ ~~°~~ ~~M~~ from ~~Mast~~/~~Plug~~/~~Plate~~

8. Action required: ~~6~~ ~~Copper Nail~~ ~~4~~ ~~21/2/92~~

Mark	Direction	Horiz. Distance	Height Difference	Mark	Direction	Horiz. Distance	Height Difference
Cobbin (P)	0 00 00	✓	above standpt.	Cobbin (P)	0 00 00	✓	above standpt.
Steel Rod TM1	71 54 37	1.919	0.326 above standpt.	G.I. Pipe	79 18 19	7.698	0.146 below standpt.
G.I. Pipe	71 54 31	3.277	0.471 above standpt.	Steel Rod TM1	80 53 37	6.353	0.235 above standpt.
Junderbaine (P)	164 35 36	✓	above standpt.	SMA 577	84 45 32	4.465	0.565 above standpt.
Dumby TM2	264 48 46	2.547	0.386 above standpt.	Dumby TM2	84 45 14	1.917	0.176 above standpt.
Copper Nail	264 48 49	4.464	0.561 above standpt.	Junderbaine (P)	164 37 42	✓	above standpt.
Abington GS	326 09 28	✓	above standpt.	Abington GS	326 07 53	✓	above standpt.

Prepared by: D. Kain. Checked: AK  
Noted on U.T.M. Card

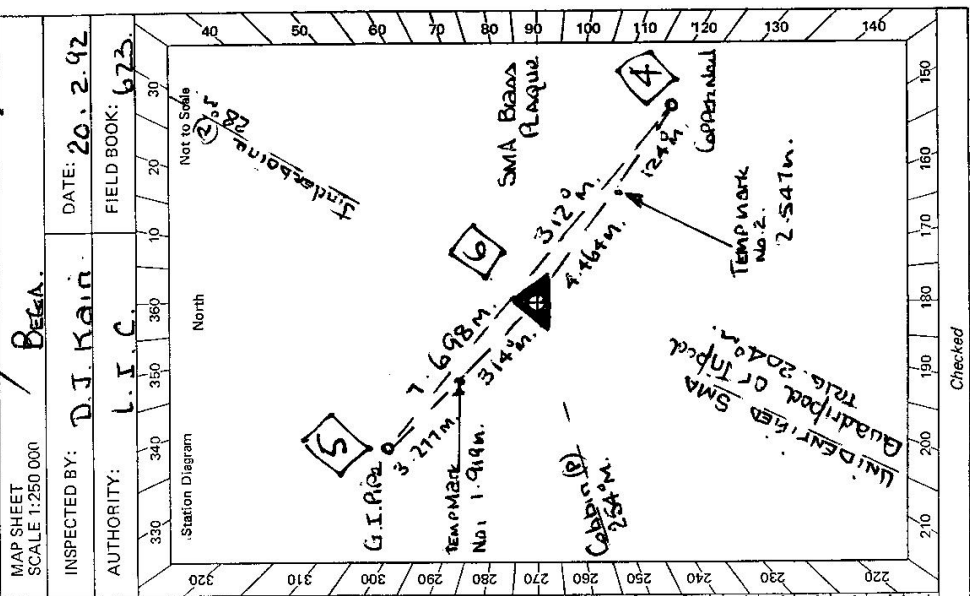

Checked: \_\_\_\_\_  
S: 2733-1

GEODETIC STATION RECONNAISSANCE and MAINTENANCE REPORT

STATION: SNOWY G.S. TS 7370  
 No: 5345  
 MAP SHEETS SCALE 1:250 000  
 SCALE 1:100 000  
 INSPECTED BY: DATE:  
 AUTHORITY: FIELD BOOK:

Not to Scale  
 Station Diagram  
 North

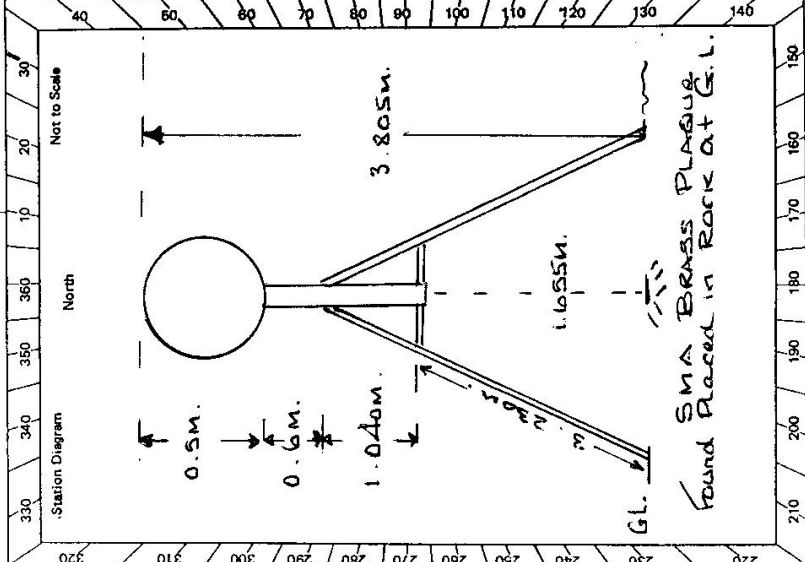

STANDPOINT: G.I. Pipe. S

Mark	Direction	Horiz. Distance	Height Difference	Mark	Direction	Horiz. Distance	Height Difference
Cobbin (P)	0 00 00 ✓		above standpt.				above standpt.
Jindera (P)	164 41 28 ✓		above standpt.				above standpt.
Steel Rod Tm 1	251 56 57	1.359	0.045				below standpt.
SMA 5 77	251 56 47	3.217	0.425				below standpt.
Dumpy Tm 2	257 34 48	5.790	0.035				below standpt.
Copper Nail	259 23 22	7.697	0.146				above standpt.
Abington G.S	326 10 33 ✓		above standpt.				below standpt.

STANDPOINT:

Mark	Direction	Horiz. Distance	Height Difference	Mark	Direction	Horiz. Distance	Height Difference
			above standpt.				above standpt.
			below				below
			above standpt.				above standpt.
			below				below
			above standpt.				above standpt.
			below				below
			above standpt.				above standpt.
			below				below
			above standpt.				above standpt.
			below				below

Prepared by: \_\_\_\_\_ Checked: \_\_\_\_\_  
 Noted on U.T.M. Card



ST 2730-2 B. West, Government Printer

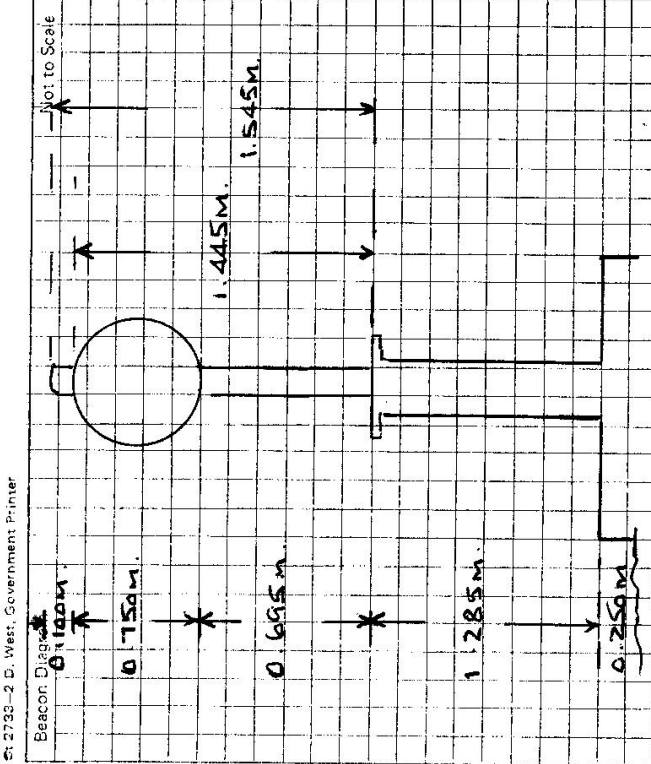

STATION **SNOWY PILLAR TS 7370**

Owner's Name: **SNOWY MOUNTAINS HYDRO ELECTRIC AUTHORITY**  
 Address: **HYDRO ELECTRIC AUTHORITY**  
 Current Occupant: .....  
 Address: .....  
 Contact: **STEVE DONKERS - Cooma Office**  
 Phone: **(0664) 532908**  
 Phone: .....  
 FAX: **(064) 523794**  
 Phone: **24-2-1992**  
 Phone: .....  
 Access Report of: **146 - was found suitable/unsuitable.**

**KMS**  
 0.00. **AT Jindabyne Post Office Travel Toward Cooma.**  
 2.76. **CROSS ROAD BRIDGE AND DAM WALL OVER SNOWY RIVER.**  
 5.36. **TURN HARD LEFT JUST OUT OF CUTTING.**  
 5.42. **THROUGH OLD GATE OPENING ON YOUR R.H.S.**  
 5.65. **LEAVE MAIN TRACK TO YOUR RIGHT**  
 5.70. **VEHICLE STOP ABOUT 30 METRE WALK TO ROOF TOP PILLAR ON YOUR R.H.S.**  
**ACCESS DRIVING TIME: 20 MINUTES FROM Jindabyne - 50 MINUTES FROM Cooma.**

STANDPOINT: **G.I. PIPE IN CONC 5**

Mark	Direction	Horiz. Distance	Height Difference
Cobbin (P)	0 00 00	✓	above standpt
Jindabyne (P)	164 41 28	✓	above standpt
Roof - TOP (P)	251 56 07	3.285	1.813 below
STEEL ROD TM1	251 56 52	1.365	0.097 above standpt
DUMPY TM2	257 34 59	5.194	0.03 below
COPPER NAIL	259 23 24	7.699	0.139 above standpt
ANVINGTON GS	326 10 39	✓	above standpt

Date ..... Record of Station .....

This section to be completed by officer constructing pillar.

Original station mark found/~~not found~~.  
 Description of mark: **S.M.A BRASS PLAQUE No. 577**  
 Original beacon found/~~not found~~.  
 Description of beacon: **Wooden Tripod**  
 Height Top of Vanes to Top Mark: **3.795** m.  
 Height of mark: **Level in rock/conc. AT** m. ~~stone~~ G.L.  
 Diameter of Vanes: **0.5** m. Height of Cairn: **---** m.  
 Original Beacon has/~~has not~~ been destroyed by me.