

CENTRAL MAPPING AUTHORITY

GEODETIC STATION RECONNAISSANCE and MAINTENANCE REPORT

Description:

1. Cleared by lanes bearing clear for gas from Trig. Mast
2. Mast & Vanes have been painted white & black respectively. No bearings
3. The station/pillar was unpiled/not unpiled/constructed on 19 dimensions now being:

Description of mark steel plate should be explicit, e.g., S/Steel Pillar Plate, Steel plug, Brass plug, Bolt, G.I. Pipe

Height of mark 0.0 m. above concrete below concrete Mark is 2.2 m. above G.L. below below **Mag Decl 8°30'**

Height of Top Vanes to Top Mark/Pillar plate 0.0 m. Diameter of Vanes (vertical) 0.0 m.

Height of Cairn 0.0 m. Diameter of Cairn 0.0 m. Name Plate found/not found/placed.

Length of Mast 0.0 m. (approximate if not unpiled)

4. A FANO MARK set in concrete has been placed found bearing 333 °M from Mast/Plug/Pillar SSM

5. A FANO MARK set in concrete has been placed found bearing 133 °M from Mast/Plug/Pillar SSM

6. A 0.0 set in conc./rock has been placed found bearing 0.0 °M from Mast/Plug/Pillar

7. A 0.0 set in conc./rock has been placed found bearing 0.0 °M from Mast/Plug/Pillar

8. Action required: 160

| Mark | Direction | Horiz. Distance | Height Difference | Mark | Direction | Horiz. Distance | Height Difference |
|----------------------------|------------|-----------------|---------------------|------------------|------------|-----------------|---------------------|
| SSM 3993 | 0°00'00" | 0.0000 | above standpt | SSM 3993 | 0°00'00" | 0.0000 | above standpt |
| MILPARINKA HOTEL | 102°19'41" | 1.278 | below standpt | MILPARINKA HOTEL | 102°16'48" | 1.278 | below standpt |
| 1 (FANO MARK) | 282°31'56" | 3.422 | 0.374 above standpt | 2 (FANO MARK) | 65°14'58" | 4.067 | 0.067 above standpt |
| 3 (TOP NEW CIVIL MONUMENT) | 330°56' | 1.278 | 1.050 above standpt | MILPARINKA HOTEL | 102°32'49" | 3.420 | 0.376 above standpt |
| 4 (TOP NEW CIVIL MONUMENT) | 4°18' | 1.275 | 1.065 above standpt | SSM 3993 | 102°32'49" | 3.420 | 0.376 above standpt |
| 2 (FANO MARK) | 74°10' | 2.808 | 0.307 below standpt | | | | |

STANDPOINT: MILPARINKA SSM 3996 (18/1/19) 160 **Fano Mark (18/4/19)**

Prepared by: P. K. BARNOLA 4/6/19/1 Checked

batch 1511

STATION: MILPARINKA SSM 3996 No: 7317
 MAP SHEETS SCALE 1:100 000
SCALE 1:250 000 MILPARINKA MILPARINKA
 INSPECTED BY: P. K. BARNOLA DATE: 18/1/19
 AUTHORITY: LIC FIELD BOOK: 628

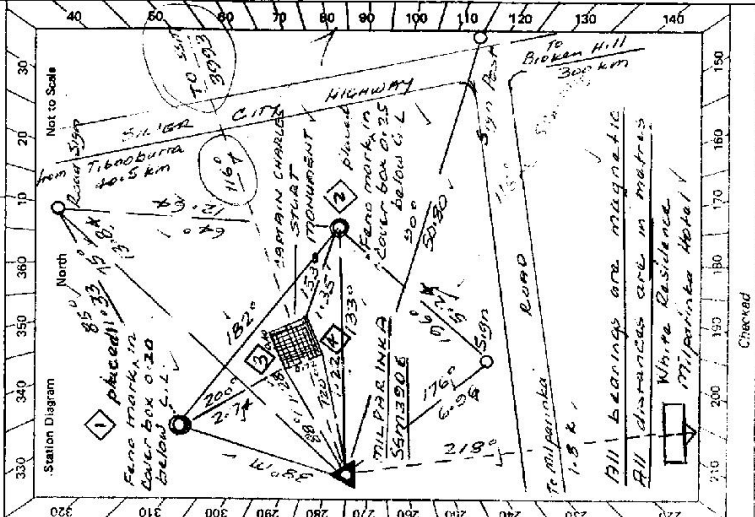

GS 24

STATION **MILPARINKA** **TS 7317**
5500 39 06

Owner's Name:
Address:
Phone:

Current Occupant:
Address:
Phone:

Public:

Access Report of **10/9/1990** was found suitable/unsuitable.
SEE SKETCH ON REVERSE SIDE

Not to Scale

| MARK | DIRECTION | HOR DIST | HT DIFF |
|---------------------------|--------------|----------|-----------------|
| 5500 3993 (10) | 0° 00' 00" | | |
| MILPARINKA HOTEL | 102° 37' 53" | | |
| MILPARINKA 5500 3906 (10) | 191° 41' 46" | 2.80' | 0.315' Standard |
| 1 FENO MARK | 245° 17' 36" | 4.615' | 0.063' Standard |

Beacon Diagram:

Date:

Record of Station: