

CARDS / of 2

GEODETIC SURVEY OF NSM

CENTRAL MAPPING AUTHORITY

GEODETIC STATION RECONNAISSANCE and MAINTENANCE REPORT

STATION: HILLCLIMB (P) No.: 7294

MAP SHEET SCALE 1:250 000 60865

INSPECTED BY: P.BT DATE: 13/10/89

AUTHORITY: LAND INFORMATION CENTRE FIELD BOOK: C583

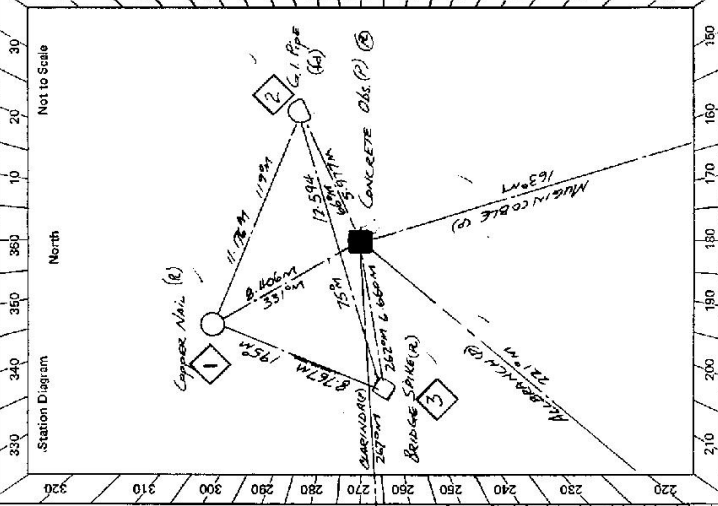

- Description:
- Cleared by lanes bearing 155° 24' 44" N 18° 34' 35" W 50m from Trig. Mast. Close to base at 12.04m - 14.10m
 - Mast & Vanes have been painted white & black respectively.
 - The station/pillar was replaced/reconstructed on 10th October 1989, dimensions now being: Description of mark 1/2 Bare Stone should be explicit, e.g., S/Steel Pillar Plate, Steel plug, Brass plug, Bolt, G.I. Pipe
 - Height of mark 1.380 m. above concrete mark is 1.530 m. above below G.L.
 - Height of Top Vanes to Top Mark/Pillar plate 1.445 m. Diameter of Vanes (vertical) 2.750 m.
 - Height of Cairn 0.000 m. Diameter of Cairn 0.000 m. Name Plate found/not found/placed.
 - Length of Mast 0.000 m. (approximate if not unipled)
 - A G.I. Pipe set in conc/rock has been found/found, bearing 6.6° M from Mark/Pillar
 - A BRIDGE SPIKE set in conc/rock has been placed found, bearing 36.2° M from Mark/Pillar
 - A Copper Nail set in conc/rock has been placed found, bearing 33.1° M from Mark/Pillar
 - A CONCRETE OBS (P) set in conc/rock has been placed found, bearing 0.0° M from Mast/Plug/Pillar

Action required: REPLACE NUDGE PLATE

STANDPOINT: CONCRETE OBSERVING PILLAR TIA (1 one) STANDPOINT: COPPER NAIL

Mark	Direction	Horiz. Distance	Height Difference	Mark	Direction	Horiz. Distance	Height Difference
<u>CLARINDA (P)</u>	<u>0 00 00</u>		<u>above</u> <u>standpt.</u>	<u>CLARINDA (P)</u>	<u>0 00 00</u>		<u>above</u> <u>standpt.</u>
<u>Copper Nail</u>	<u>83 55 10</u>	<u>8.406</u>	<u>below</u> <u>standpt.</u>	<u>G.I. PIPE</u>	<u>212 26 55</u>	<u>11.176</u>	<u>above</u> <u>standpt.</u>
<u>G.I. PIPE</u>	<u>144 32 10</u>	<u>15.978</u>	<u>below</u> <u>standpt.</u>	<u>HILLCLIMB (P) STAKE</u>	<u>244 08 50</u>	<u>8.406</u>	<u>above</u> <u>standpt.</u>
<u>MUGINGOBBLE (P)</u>	<u>256 34 50</u>		<u>above</u> <u>standpt.</u>	<u>MUGINGOBBLE (P)</u>	<u>256 47 35</u>		<u>above</u> <u>standpt.</u>
<u>ALBRANCU (P)</u>	<u>314 27 50</u>		<u>below</u> <u>standpt.</u>	<u>BRIDGE SPIKE</u>	<u>289 43 40</u>	<u>8.768</u>	<u>above</u> <u>standpt.</u>
<u>BRIDGE SPIKE</u>	<u>353 51 30</u>	<u>6.660</u>	<u>below</u> <u>standpt.</u>	<u>ALBRANCU (P)</u>	<u>314 37 40</u>		<u>above</u> <u>standpt.</u>

Prepared by: P.BT 27/10/89

Checked: AS 16/3/90

Noted on U.T.M. Card

GS24

STATION *HILLCLIMB (P) TS 7294*

Owner's Name: *MR BERT LITTLE*
 Address: *142A W. 70th St*
 Phone: *(688) 62 1045*

Current Occupant:
 Address:
 Phone:

ACCESS
 DATE: *OCT 1989 (See below)*
 * *CMA LOCK #*
2nd to within 200m

Access Report of *12/10/1989* was found suitable/unavailable.

LEAVE
 EAST OFFICE PARKES TRAVEL NORTH ALONG CURVED JUNG STREET
 STRAIGHT AHEAD
 TURN RIGHT INTO WEBB STREET
 TURN LEFT ONTO GRAVEL ROAD
 STRAIGHT AHEAD THROUGH RIFLE RANGE GATEWAY
 TAKE RIGHT FORK
 TAKE RIGHT FORK
 THROUGH IRON GATE CMA LOCK FITTED AND FOLLOW
 TURN RIGHT AND MAKE OWN WAY TO TRIG
 HILLCLIMB (P)

DATE *14/11/91*
 Mr Little advises the CMA lock was
 been stolen

- 0.00*
- 1.14*
- 1.55*
- 2.15*
- 2.27*
- 2.37*
- 2.48*
- 2.78*
- 3.66*
- 3.90*

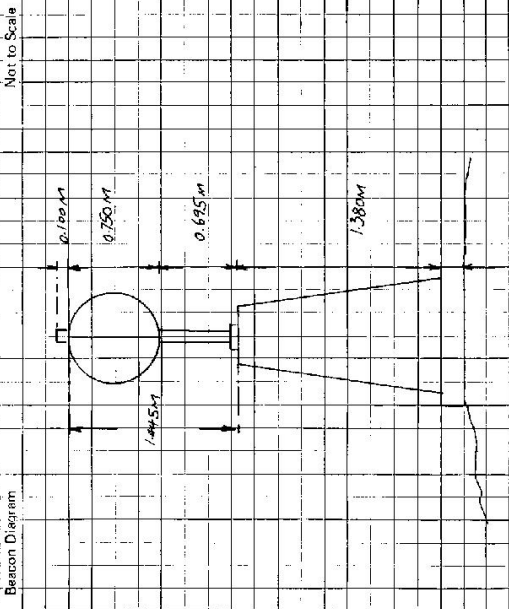

This section to be completed by officer constructing pillar.

Original station mark found/not found.

Description of mark:

Original beacon found/not found.

Description of beacon: *NO MARKS*

Height Top of Vanes to Top Markm.

Height of mark.....m above G.L.
 below rock/conc.....m below

Diameter of Vanesm. Height of Cairnm.

Original Beacon has/has not been destroyed by me.

Date	Record of Station
<i>12/10/89</i>	<i>S.M. MISHNER, MESSRS. MARINA PROMOTER, NEW L.F.S. LOCK, PLACED AT 2.98 KEYS</i>
	<i>ACCESS STILL OK (D.K.S.M.)</i>

CENTRAL MAPPING AUTHORITY

GEODETIC SURVEY OF N.S.W.

GEODETIC STATION RECONNAISSANCE and MAINTENANCE REPORT

Description:

1. Cleared by lanus bearing..... Note: Cross out word or words which do not apply
2. Mast & Vanes have been painted white & black respectively.
3. The station/pillar was unpiled/not unpiled/constructed on..... 19....., dimensions now being: Description of mark..... should be explicit, e.g., S/Steel Pillar Plate, Steel plug, Brass plug, Bolt, G.I. Pipe
 Height of mark.....m.....^{above} rock/concrete; Mark is.....m.....^{above} G.L.
 Height of Top Vanes to Top Mark/Pillar platem..... Diameter of Vanes (vertical).....m.....
 Height of Cairn.....m..... Diameter of Cairn.....m..... Name Plate found/not found/placed.
 Length of Mastm..... (approximate if not unpiled)
4. A.....set in conc/rock has been placed/found, bearing.....°M from Mast/Plug/Pillar
5. A.....set in conc/rock has been placed/found, bearing.....°M from Mast/Plug/Pillar
6. A.....set in conc/rock has been placed/found, bearing.....°M from Mast/Plug/Pillar
7. A.....set in conc/rock has been placed/found, bearing.....°M from Mast/Plug/Pillar

8. Action required:.....

STANDPOINT: BRIDGE SPIKE

Mark	Direction	Horiz. Distance	Height Difference	Mark	Direction	Horiz. Distance	Height Difference
CEARINA (P)	0 00 00		above standpt.	CEARINA (P)	0 00 00		above standpt.
COPPER NAIL	109 28 50	8.766	below standpt.	COPPER NAIL	32 15 50	11.77	below standpt.
G.I. PIPE	169 26 00	12.596	above standpt.	MUSKIGOLE (P)	256 39 20		above standpt.
HULLMOR (P) SPIGOT	173 51 00	16.660	above standpt.	ALBRANCH (P)	314 31 50		above standpt.
MUSKIGOLE (P)	256 31 00		above standpt.	HULLMOR (P) SPIGOT	344 33 20	5.976	above standpt.
ALBRANCH (P)	314 24 00		above standpt.	BRIDGE SPIKE	349 30 00	12.592	below standpt.

STANDPOINT: G.I. PIPE

Mark	Direction	Horiz. Distance	Height Difference
CEARINA (P)	0 00 00		above standpt.
COPPER NAIL	32 15 50	11.77	below standpt.
MUSKIGOLE (P)	256 39 20		above standpt.
ALBRANCH (P)	314 31 50		above standpt.
HULLMOR (P) SPIGOT	344 33 20	5.976	above standpt.
BRIDGE SPIKE	349 30 00	12.592	below standpt.

Prepared by: P.BRS 27/10/13

Checked: AS 16/3/13

Noted on U.T.M. Card

Checked

91:2793-1

STATION: *WILLIAMSBURG (P)* TS No.: *7294*

MAP SHEET SCALE 1:250 000

INSPECTED BY: *P.BRS* DATE: *13/10/13*

AUTHORITY: *LAND INFORMATION CENTRE* FIELD BOOK: *C.583*

Station Diagram

Not to Scale