

GEODETIC SURVEY OF N.S.W.

CENTRAL MAPPING AUTHORITY

GEODETIC STATION RECONNAISSANCE and MAINTENANCE REPORT

Description:

1. Cleared by lanes bearing *Hill COVERED Hill SMALL TREES* from Trig. Mast

2. Mast & Vanes have been painted white & black respectively

3. The *5/8" Pillar Plate* constructed on *10" MAX* dimensions now being:

Description of mark: *5/8" Pillar Plate* should be explicit, e.g., S/Steel Pillar Plate, Steel plug, Brass plug, Bolt, G.I. Pipe

Height of mark: *1.375* m above *concrete* Mark is *1.525* m above G.L.

Height of Top Vanes to Top Mark/Pillar plate: *1.445* m Diameter of Vanes (vertical): *0.750* m.

Height of Cairn: *0* m. Diameter of Cairn: *0* m. Name Plate *not* placed.

Length of Mast: *0* m. (approximate if not unplied)

4. A *G.I. Pipe* set in conc/*concrete* has been placed; bearing *111*° M from *concrete* Pillar

5. A *Copper Nail* set in conc/*concrete* has been placed; bearing *103*° M from *concrete* Pillar

6. A *concrete observing pillar* set in conc/rock has been placed/ found; bearing *103*° M from Mast/Plug/Pillar

7. A *concrete observing pillar* set in conc/rock has been placed/ found; bearing *103*° M from Mast/Plug/Pillar

8. Action required: *Station connection and placement of name plate: Connection done 11/5/18*

STANDPOINT: *Pillar Plate*

STANDPOINT: *G.I. Pipe*

Mark	Direction	Horiz. Distance	Height Difference	Mark	Direction	Horiz. Distance	Height Difference
<i>BOGGABILLA SILO</i>	<i>090° 00' 00"</i>		<i>above</i> standpt.	<i>Cu nail</i>	<i>S 663</i>		<i>below</i> standpt.
<i>WYOMING GS</i>	<i>094° 03' 30"</i>		<i>above</i> standpt.				<i>below</i> standpt.
<i>Cu nail in conc</i>	<i>90° 06' 30" ± 10"</i>	<i>1.76</i>	<i>above</i> standpt.				<i>above</i> standpt.
<i>G.I. Pipe in conc</i>	<i>104° 24' 00" ± 10"</i>	<i>1.48</i>	<i>above</i> standpt.				<i>below</i> standpt.
			<i>above</i> standpt.				<i>above</i> standpt.
			<i>below</i> standpt.				<i>below</i> standpt.
			<i>below</i> standpt.				<i>below</i> standpt.

Prepared by: *P. Bors* 11/5/18

Checked: *P. Bors* 11/5/18

Noted on U.T.M. Card

S.O. 1407

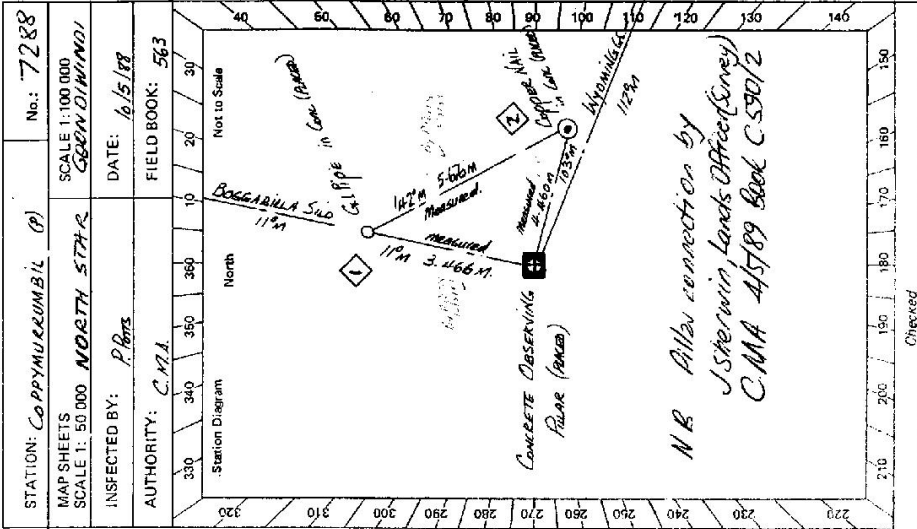

N.B. Allow connection by J. Spervin, Lands Office (Survey) C.M.A. 415189 Book C.53012

GS 24

STATION COPPIWURUMBIL (P) TS 7288

Owner's Name Mr JOHN LITTLEWOOD
 Address Buerriabar
 Phone (078) 742822
 Current Occupant:
 Address:
 Phone:

DRY WEATHER ACCESS ONLY.

Access Report of 10/5/1988 was found suitable/unsuitable.

- FEATURES
- 20.00 Post office Baggabilla trail towards 'Yerman'
 - 20.33 Turn right onto NEWELL HIGHWAY at Hobble Post Hotel
 - 20.24 Bridge over 'HIMALAN CREEK'
 - 20.02 Bus road on left to 'DORCELY BOES'
 - 20.42 Turn left slip 'BUEERRIABAR'
 - 20.50 Cross Grid - white mail box and double iron gates on right
 - 20.56 Take right fork
 - 20.87 Bus track on right
 - 20.96 Bus entrance to owner's house on right (?)
 - 21.18 Weather board house on right
 - 21.24 Turn right - follow track
 - 21.33 Concrete tank on left
 - 21.49 Turn left at Aircraft tanger and small slip on right towards Manell Highway
 - 22.24 Turn left off airstrip and follow track through cultivation to small knob RR. This track may not be here for long due to paddock cultivation being carried out
 - 22.98 At edge of small knob - follow faint track or make own way to ring
 - 23.24 COPPIWURUMBIL (GSIC).

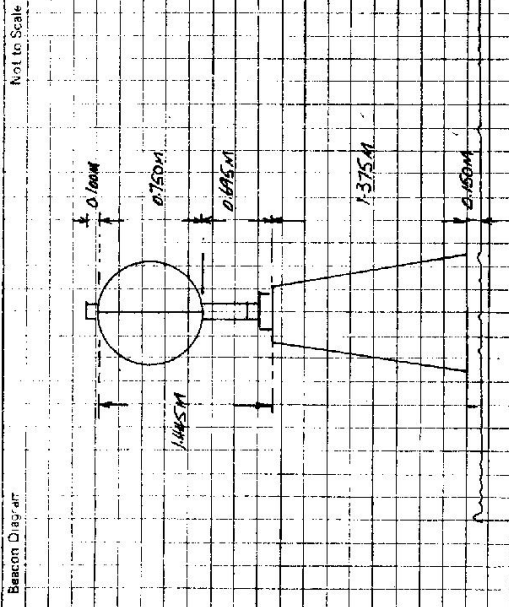

This section to be completed by officer constructing pillar.

Original station mark found/not found. New Station

Description of mark:

Original beacon found/not found.

Description of beacon:

Height Top of Vanes to Top Markm.

Height of markm. above G.L. below

Diameter of Vanesm. Height of Cairnm.

Original Beacon has/has not been destroyed by me.

Date	Record of Station

CENTRAL MAPPING AUTHORITY

GEODETTIC STATION RECONNAISSANCE and MAINTENANCE REPORT

GEODETTIC SURVEY OF N.S.W.

STATION: *COPYMILL RUMBIL (P)* No: *7288*
 MAP SHEET SCALE 1:250 000 *Geonidin NDI* *54/58 1*
 INSPECTED BY: *G. DICKSON* DATE: *21-5-88*
 AUTHORITY: *C.M.A.P.* FIELD BOOK: *C559*

Description:
 Cleared by lanes bearing..... from Trig. Mast

- Note: Cross out word or words which do not apply
- Mast & Vanes have been painted white & black respectively.
 - The station pillar was unpiled/not unpiled/constructed on..... dimensions now being:.....
 - Description of mark..... should be explicit, eg. Steel Pillar Plate, Steel plug, Brass plug, Bolt, G.I. Pipe
 - Height of mark..... m. above rock/concrete; *ON G.L.* Mark is..... m. above below G.L.
 - Height of Top Vanes to Top Mark/Pillar/plate..... m. Diameter of Vanes (vertical)..... m.
 - Height of Cairn..... m. Diameter of Cairn..... m. Name Plate found/not found/placed.
 - Length of Mast..... m. (approximate if not unpiled)
 - A..... set in conc/rock has been placed/found, bearing..... °M from Mast/Plug/Pillar
 - A..... set in conc/rock has been placed/found, bearing..... °M from Mast/Plug/Pillar
 - A..... set in conc/rock has been placed/found, bearing..... °M from Mast/Plug/Pillar
 - A..... set in conc/rock has been placed/found, bearing..... °M from Mast/Plug/Pillar

8. Action required:.....

STANDPOINT: <i>PILLAR PLATE</i>		STANDPOINT: <i>GI RR IN CONC</i>	
Mark	Direction	Horiz. Distance	Height Difference
<i>BENCHMILL SILE GS</i>	<i>0 00 00</i>		<i>above standpt.</i>
<i>GI RR IN CONC</i>	<i>1 46 25</i>	<i>3.473</i>	<i>above standpt.</i>
<i>C. MAIL IN CONC</i>	<i>92 11 15</i>	<i>4.458</i>	<i>above standpt.</i>
<i>WYOMING GS</i>	<i>104 03 27</i>		<i>above standpt.</i>
			<i>below standpt.</i>
			<i>above standpt.</i>
			<i>below standpt.</i>
			<i>above standpt.</i>
			<i>below standpt.</i>

Prepared by: *[Signature]* 19/89
 Checked: *[Signature]*
 Noted on U.T.M. Card