

GEODETTIC SURVEY OF A.S.W.

CENTRAL MAPPING AUTHORITY

GEODETTIC STATION RECONNAISSANCE and MAINTENANCE REPORT

STATION: **HOLLYWOOD** No.: **7268**
 MAP SHEETS SCALE 1:250 000 SCALE 1:100 000
 INSPECTED BY: **M. CLARK** DATE: **16 Sept 87**
 AUTHORITY: **CMA** FIELD BOOK: **?**

Description: *Note: Cross out word or words which do not apply*
 1. ~~Concrete~~ ~~stone~~ ~~bearing~~ from Trig. Mast
 2. ~~Mark~~ ~~on~~ ~~stone~~ ~~has~~ ~~been~~ ~~placed~~ ~~on~~ ~~top~~ ~~of~~ ~~concrete~~
 3. ~~Top~~ ~~of~~ ~~stone~~ ~~has~~ ~~been~~ ~~placed~~ ~~on~~ ~~top~~ ~~of~~ ~~concrete~~ 19 dimensions now being:
 Description of mark: ~~Steel~~ ~~rod~~ should be explicit, e.g., S/Steel Pillar Plate, Steel plug, Brass plug, Bolt, G.I. Pipe
 Height of mark: ~~0.5~~ ~~5~~ ~~m~~ above ~~concrete~~ m. above G.L.
 Height of ~~stone~~ ~~top~~ ~~of~~ ~~mark~~ ~~plate~~ m. Diameter of ~~stone~~ ~~mark~~ ~~plate~~ m.
 Height of ~~stone~~ ~~mark~~ ~~plate~~ m. (approximate if not uplied)
 4. A. ~~Cu~~ ~~Nail~~ set in conc/ ~~stone~~ has been placed/ ~~stone~~ bearing M from Mast/Plug/Pillar
 5. A. ~~Cu~~ ~~Nail~~ set in conc/ ~~stone~~ has been placed/ ~~stone~~ bearing M from Mast/Plug/Pillar
 6. A. ~~Cu~~ ~~Nail~~ set in conc/ ~~stone~~ has been placed/ ~~stone~~ bearing M from Mast/Plug/Pillar
 7. A. ~~Cu~~ ~~Nail~~ set in conc/ ~~stone~~ has been placed/ ~~stone~~ bearing M from Mast/Plug/Pillar
 8. Action required:

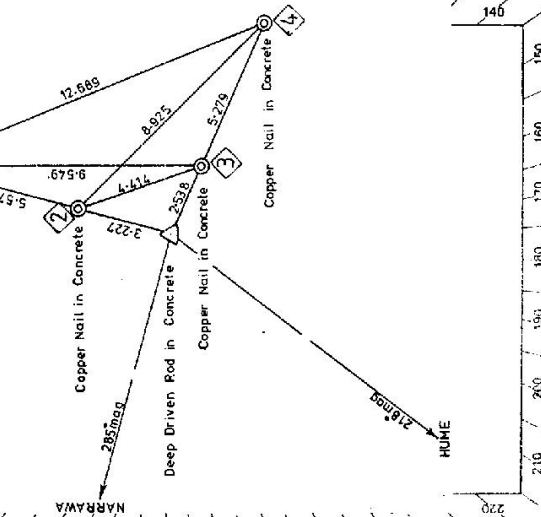

STANDPOINT: STEEL ROD				STANDPOINT: COPPER NAIL			
Mark	Direction	Horiz. Distance	Height Difference	Mark	Direction	Horiz. Distance	Height Difference
Hume (P)	0° 00' 00"		above standpt.	Denbigh (P)	0° 00' 00"		above standpt.
Narrawa (P)	71 33 54		above standpt.	Hume (P)	34 16 26		above standpt.
Cu Nail 1	156 12 38	0.267	below standpt.	Narrawa (P)	105 49 42		below standpt.
Cu Nail 2	156 14 02	0.104	below standpt.	Cu Nail 1	153 01 48	0.077	below standpt.
Cu Nail 3	255 33 32	0.033	below standpt.	Cu Nail 2	130 42 52	0.086	below standpt.
Cu Nail 4	255 36 45	0.188	below standpt.	Cu Nail 3	109 49 58	0.224	above standpt.
				S/Steel Rod	109 49 58	0.101	above standpt.

Prepared by: **Michael Clark** Checked: **Michael Clark**
 Noted on U.T.M. Card

GS 24

en 2733-2 D. West, Government Printer Beacon Diagram Not to Scale	STATION HOLLYWOOD IS 7268	Owner's Name Address Phone ACCESS: Access Report of 16.9.1987 was found suitable/unsuitable.	Current Occupant: ALAN HOPPE Address: "Hollywood" (NARRAWA) Phone: 048 365 235 (23/6/92)																					
<table border="1" style="width: 100%; height: 100%;"> <tr><td style="width: 5%;"> </td><td style="width: 5%;"> </td><td style="width: 5%;"> </td><td style="width: 5%;"> </td><td style="width: 5%;"> </td><td style="width: 5%;"> </td><td style="width: 5%;"> </td><td style="width: 5%;"> </td><td style="width: 5%;"> </td><td style="width: 5%;"> </td><td style="width: 5%;"> </td><td style="width: 5%;"> </td><td style="width: 5%;"> </td><td style="width: 5%;"> </td><td style="width: 5%;"> </td><td style="width: 5%;"> </td><td style="width: 5%;"> </td><td style="width: 5%;"> </td><td style="width: 5%;"> </td><td style="width: 5%;"> </td><td style="width: 5%;"> </td></tr> <!-- Additional rows omitted for brevity, representing the grid structure --> </table>																							0.00 Crookwell PO travel towards Bathurst then take Boorawa road towards Boorawa for 37kms. 37.53 Turn right off Boorawa road sign "Hollywood; Crookwell 37, Boorawa 49". Follow Hollywood road cross grid. 38.48 Turn right through iron gate. Road to left to Hollywood (Narra G5P). 38.68 Dam on left. 39.56 Turn left off gravel road on to track just after tree line. 39.61 Small dam on right. Follow faint track marked with yellow blazes through timber. 40.29 At Hollywood GS, marked by star picket and white post.	
		Date	Record of Station																					
This section to be completed by officer constructing pillar. Original station mark found/not found. Description of mark: Original beacon found/not found. Description of beacon: Height Top of Vanes to Top Markm. Height of markm. above G.L. Below Diameter of Vanesm. Height of Cairnm. Original Beacon has/has not been destroyed by me.																								

1 of 2

GEODETTIC SURVEY OF A.S.W.

CENTRAL MAPPING AUTHORITY

GEODETTIC STATION RECONNAISSANCE and MAINTENANCE REPORT

STATION: **HOLLYWOOD** No.: **7268**
 MAP SHEETS SCALE 1:100 000
 INSPECTED BY: **P POTTS** DATE: **4.3.88**
 AUTHORITY: **QVA** FIELD BOOK: **C446**

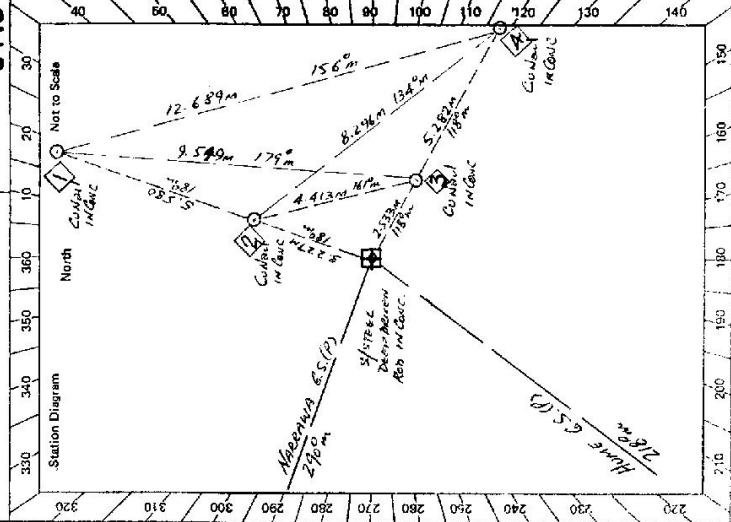

- Description: 191.8202° 205°-255° 250°-101°
 Note: *Cross out word or words which do not apply*
 1. Cleared by lanes bearing..... from Trig. Mast
 2. Mast & Vanes have been painted white & black respectively.
 3. The station pillar was ~~unplaced~~ ~~not supplied~~ ~~constructed on~~..... dimensions now being:
 Description of mark: S/Steel Rod..... should be explicit, e.g., S/Steel Pillar Plate, Steel plug, Brass plug, Bolt, G.I. Pipe
 Height of mark..... m. above below G.L. Mark is..... m. above below
 Height of Top Vanes to Top Mark/Pillar plate..... m. Diameter of Vanes (vertical)..... m.
 Height of Cairn..... m. Diameter of Cairn..... m. Name Plate found/not found/placed.
 Length of Mast..... m. (approximate if not unplaced)
1. Cu Nail 1 set in conc/rock has been placed/found, bearing..... 18.0 M from Mast/Plug/Pillar.....
 2. Cu Nail 2 set in conc/rock has been placed/found, bearing..... 18.0 M from Mast/Plug/Pillar.....
 3. Cu Nail 3 set in conc/rock has been placed/found, bearing..... 118.0 M from Mast/Plug/Pillar.....
 4. Cu Nail 4 set in conc/rock has been placed/found, bearing..... 118.0 M from Mast/Plug/Pillar.....

Mark	Direction	Horiz. Distance	Height Difference	Mark	Direction	Horiz. Distance	Height Difference
Narrowa (P)	0 00 00		above standard	Narrowa (P)	0 00 00		above standard
Cu Nail 2	84 40 25	3.227	0.102 below standard	S/Steel Rod	4 00 05	2.532	0.03 below standard
Cu Nail 1	84 39 07	8.806	0.264 above standard	Cu Nail 2	50 10 03	4.413	0.136 below standard
Cu Nail 3	183 58 58	2.534	0.037 above standard	Cu Nail 1	69 28 14	9.549	0.298 below standard
Cu Nail 4	184 02 28	7.815	0.184 below standard	Cu Nail 4	184 03 46	5.282	0.219 below standard
Hume (P)	288 26 10		above standard	Hume (P)	288 26 20		above standard

STANDPOINT: STAINLESS STEEL ROD ✓
 Prepared by: **R. Shackleton** 17.3.88
 Checked: **15/4/88**
 Noted on U.T.M. Grid

S.O. 1407

2 of 2.

TS No.: 7268

STATION: **Hollywood**

MAP SHEETS SCALE 1:250 000

INSPECTED BY: **P. Potts**

DATE: **4-3-88**

AUTHORITY: **CMA**

FIELD BOOK: **CA46**

SCALE 1:100 000

Station Diagram

STANDPOINT: **CU NAIL 1**

Direction	Height Diff
NARRAWA (P) 0 00 00	10.082
CU NAIL 4 229° 24' 35"	12.690
CU NAIL 3 249° 38' 36"	9.550
CU NAIL 2 264° 48' 24"	10.164
S/STEEL ROD 264° 48' 50"	10.271
HUME (P) 288° 35' 29"	10.400 (H/A Above Standpoint)

GEODETTIC SURVEY OF N.S.W.

CENTRAL MAPPING AUTHORITY

GEODETTIC STATION RECONNAISSANCE and MAINTENANCE REPORT

Description: *Note: Cross out word or words which do not apply*

- Cleared by lanes bearing..... from Trig. Mast
- Mast & Vanes have been painted white & black respectively.
- The station/pillar was unpiled/not unpiled/constructed on.....19....., dimensions now being: Description of mark..... should be explicit, e.g., S/Steel Pillar Plate, Steel plug, Brass plug, Bolt, G.I. Pipe

Height of mark..... m. ^{above} rock/concrete; Mark is..... m. ^{above} G.L.

Height of Top Vanes to Top Mark/Pillar plate..... m. Diameter of Vanes (vertical)..... m.

Height of Cairn..... m. Diameter of Cairn..... m. Name Plate found/not found/placed.

Length of Mast..... m. (approximate if not unpiled)

- A..... set in conc./rock has been placed/found, bearing.....° M from Mast/Plug/Pillar
- A..... set in conc./rock has been placed/found, bearing.....° M from Mast/Plug/Pillar
- A..... set in conc./rock has been placed/found, bearing.....° M from Mast/Plug/Pillar
- A..... set in conc./rock has been placed/found, bearing.....° M from Mast/Plug/Pillar

8. Action required:.....

Mark	Direction	Horiz. Distance	Height Difference	Mark	Direction	Horiz. Distance	Height Difference
Narrawa (P)	0 00 00			Narrawa (P)	0 00 00		
Cu Nail 3	4 03 30	5.283	0.224	Cu Nail 1	84 41 43	5.579	0.161
S/Steel Rod	4 02 23	7.816	0.191	Cu Nail 4	204 59 50	8.926	0.080
Cu Nail 2	24 55 42	8.926	0.085	Cu Nail 3	230 13 44	4.413	0.140
Cu Nail 1	47 13 54	12.689	0.076	S/Steel Rod	264 43 43	3.227	0.107
Hume (P)	288 26 52			Hume (P)	288 29 34		

STANDPOINT: **CU NAIL 4** ✓

STANDPOINT: **CU NAIL 2** ✓

Prepared by: **Miss. J. C. O'Neil**

Checked by: **IS/MS**

Checked