

CARD No. 1 OF 2 CARDS

GEODETTIC SURVEY OF A.S.W.

CENTRAL MAPPING AUTHORITY

GEODETTIC STATION RECONNAISSANCE and MAINTENANCE REPORT

Description:

- Cleared by lanes bearing 162° 159° M. Note: Cross out word or words which do not apply
- Mast & Vanes have been painted white & black respectively. About $\frac{1}{2}$ kilometre distant blocks horizon in this direction.
- The station/pillar was ~~replaced~~/constructed on 19^{th} February 1987, dimensions now being: 150° 152° M. high timbered ridge from Trig. Mast
- Description of mark: ~~Steel Pillar Plate~~ should be explicit, e.g., S/Steel Pillar Plate, Steel plug, Brass plug, Bolt, G.I. Pipe
- Height of mark: 1.375 m. above rock/concrete; Mark is 1.495 m. above G.L.
- Height of Top Vanes to Top Mark/Pillar plate: 1.440 m. Diameter of Vanes (vertical): 7.500 m.
- Height of Cairn: 1.530 m. Diameter of Cairn: 1.530 m. Name Plate found/not found/placed.
- Length of Mast: 1.530 m. (approximate if not exact)
- A. ~~Bronze Pin~~ ^{Bronze} set in ~~stone~~/rock has been placed/found, bearing 359° M from Mast/Plug/Pillar
- A. ~~Copper Nail~~ set in conc./rock has been placed/found, bearing 47° M from Mast/Plug/Pillar
- A. ~~...~~ set in conc./rock has been placed/found, bearing $...$ M from Mast/Plug/Pillar
- A. ~~...~~ set in conc./rock has been placed/found, bearing $...$ M from Mast/Plug/Pillar
- Action required: ~~S.M. NAME~~ ^{S.M. NAME} ~~plate to be placed and pillar to be painted with white enamel~~

STANDPOINT: Concrete obs. Pillar

STANDPOINT: Bronze Iris. Plug.

Mark	Direction	Horiz. Distance	Height Difference	Mark	Direction	Horiz. Distance	Height Difference
Bronzing (P)	$0^{\circ} 00' 00''$	0.00	above standpt.	Bronzing (P)	$0^{\circ} 00' 00''$	0.00	above standpt.
Hume (P)	$80^{\circ} 31' 27''$	80.31	below standpt.	Hume (P)	$80^{\circ} 31' 33''$	80.31	below standpt.
Bronze Iris. Plug	$108^{\circ} 13' 12''$	2.587	below standpt.	Copper Nail	$198^{\circ} 36' 54''$	2.516	below standpt.
Copper Nail	$152^{\circ} 37' 21''$	3.597	below standpt.	Mundoonan (P)	$277^{\circ} 59' 42''$	1.604	above standpt.
Mundoonan (P)	$277^{\circ} 59' 05''$	1.555	below standpt.	Concrete Pillar	$288^{\circ} 13' 55''$	2.587	above standpt.
			below standpt.				below standpt.
			above standpt.				above standpt.
			below standpt.				below standpt.

Prepared by: D. KAIN

Checked: Peter 9/3/87

Noted on U.T.M. Card

Checked

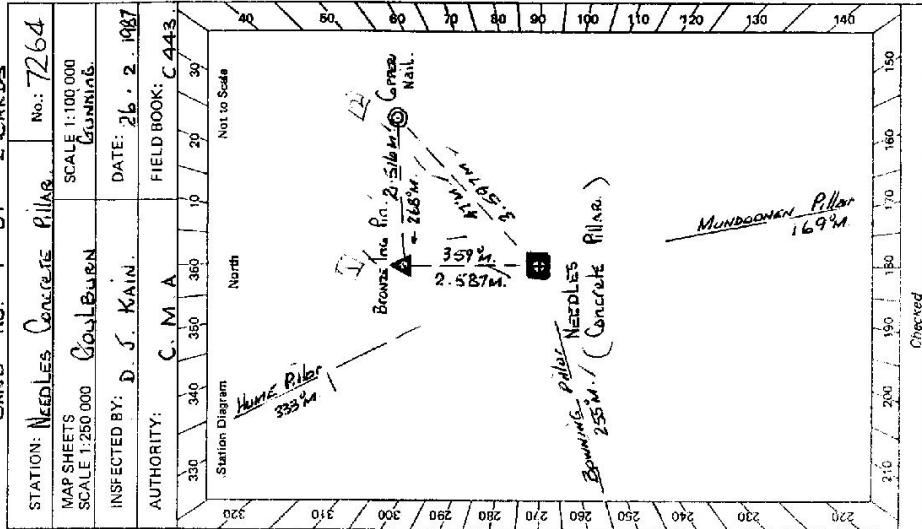

STATION: NEEDLES CONCRETE PILLAR No.: 7264
 MAP SHEETS SCALE 1:100 000
 SCALE 1:250 000
 INSPECTED BY: D. J. KAIN DATE: 26.2.1987
 AUTHORITY: C. M. A. FIELD BOOK: C.443

STATION **NEEDLES CONCRETE OBSERVATION PILLAR**
 TS 7264
 The Reserve is Surrounded by Crown Lands.

Owner's Name: **1816A RESERVE 18856**
 Address: **CROWN LANDS OFFICE**
 Phone: **(0427) 262289**
 ACCESS: **26-2-1987**

Reserve is not subject to any lease or occupancy.
 Photo: **GOULD BURN**
 Yes

Access Report of: **MR. J. JUDGE**
 15... was found suitable.

FEATURE:
 YASS POST OFFICE TRAVEL VIA HUME HIGHWAY TOWARD BUNDABERG.
 TURN RIGHT INTO POLLOUX STREET.
 END OF SENLED ROAD BENDS IN ROAD. TURN LEFT THROUGH IRON
 GATE AT RED SIGN "ECHO". GREEN DRUM MAIL BOX R.M.B. 247
 THROUGH IRON GATE AT RAILWAY LEVEL CROSSING. ALICE CROSSING.
 RAILWAY LINE TURN RIGHT.
 PASS OVER BRIDGE THEN TAKE LEFT FORK IN TROUDS.
 PASS OVER GRID.
 TAKE RIGHT FORK.
 PASS OVER GRID.
 TURN RIGHT AT SHEDS AND PARTLY BUILT BRICK HOUSE.
 TRUCK TURNS LEFT AT OLD TRACKS AND FOLLOWS ALONG EDGE
 OF TIMBER LINE.
 TRACK ENTERS TIMBER.
 LEAVE TIMBER LINE AND TURN INTO TIMBER ON RIGHT ONTO
 GRADED TRACK.
 TURN LEFT UP TRACK.
 NEEDLES CONCRETE PILLAR.

Kilms	Date	Record of Station
0.00		
1.67		
9.76		
13.65		
14.41		
14.99		
15.09		
16.60		
17.76		
18.12		
18.55		
18.72		
18.96		
19.32		
19.62		
19.69		

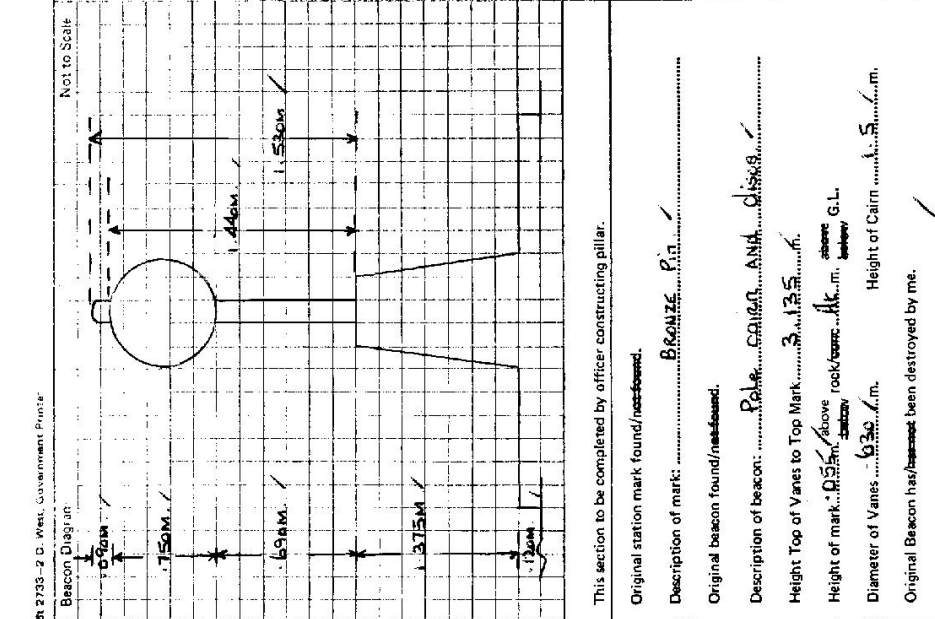

CENTRAL MAPPING AUTHORITY GEODETTIC SURVEY OF A.S.#.

GEODETTIC STATION RECONNAISSANCE and MAINTENANCE REPORT

STATION: Needles Concrete Pillar No.: 7264
 MAP SHEETS SCALE 1:250 000 CONTOUR
 SCALE 1:100 000
 INSPECTED BY: D.J. KALIN DATE: 26.2.1987
 AUTHORITY: C.M.A. FIELD BOOK: C.443

330 340 350 360 370 380 390 400 410 420 430 440 450
 Station Diagram North Not to Scale

1. Cleared by lanes bearing.....
 Note: Cross out word or words which do not apply
 from Trig. Mast

2. Mast & Vanes have been painted white & black respectively.

3. The station/pillar was unpiled/not unpiled/constructed on.....
 Description of mark..... should be explicit, e.g., S/Steel Pillar Plate, Steel plug, Brass plug, Bolt, G.I. Pipe
 Height of mark..... m. above rock/concrete; Mark is..... m. above below G.L.
 Height of Top Vanes to Top Mark/Pillar plate..... m. Diameter of Vanes (vertical)..... m.
 Height of Cairn..... m. Diameter of Cairn..... m. Name Plate found/not found/placed.
 Length of Mast..... m. (approximate if not unpiled)

4. A..... set in conc./rock has been placed/found, bearing.....°M from Mast/Plug/Pillar
 5. A..... set in conc./rock has been placed/found, bearing.....°M from Mast/Plug/Pillar
 6. A..... set in conc./rock has been placed/found, bearing.....°M from Mast/Plug/Pillar
 7. A..... set in conc./rock has been placed/found, bearing.....°M from Mast/Plug/Pillar
 8. Action required:.....

STANDPOINT: <u>CORNER NAIL</u>		STANDPOINT:		
Mark	Direction	Horiz. Distance	Height Difference	Horiz. Distance
<u>BALANCE (P)</u>	<u>0° 0' 00"</u>		above standpt.	
<u>TRIG. PLUG</u>	<u>18 37 02.2 517.046</u>		below standpt.	
<u>HUME (P)</u>	<u>Not Visible due to heat haze & smoke</u>		above standpt.	
<u>MUNDICAN (P)</u>	<u>278 00 41</u>		below standpt.	
<u>CONC. PILLAR</u>	<u>332 37 50.3 597.1 557</u>		above standpt.	
			below standpt.	
			above standpt.	
			below standpt.	

Prepared by: P. Kelly 9/3/87 Checked: U. T.M. Carr
 Noted on U.T.M. Cart