

CENTRAL MAPPING AUTHORITY

GEODETIC SURVEY OF M.S.W.

GEODETIC STATION RECONNAISSANCE and MAINTENANCE REPORT

Description:

1. Cleared by lanes bearing SCATTERED TREES *Note: Cross out word or words which do not apply*
 from 359 21 40 20 24 from Trig. Mast
2. Mast & Vanes have been painted white & black respectively!
 from 30 21 40 180 21
3. The ~~station~~/pillar was ~~constructed~~/constructed on 15 AUGUST 19 85, dimensions now being:
1 base plate
 Description of mark..... should be explicit, e.g., S/Steel Pillar Plate, Steel plug, Brass plug, Bolt, G.I. Pipe
 Height of mark..... 1370 m. ^{above} ~~below~~ concrete; Mark is 1530 m. ^{above} ~~below~~ G.L.
 Height of Top Vanes to Top 1445 Pillar plate m. Diameter of Vanes (vertical) 2.750 m.
 Height of Cairn..... m. Diameter of Cairn..... m. Name Plate found/not found/placed.
 Length of Mast..... m. (approximate if not unpiled)
4. A Bronze Trig Plug set in conc/rock has been ~~found~~/found, bearing..... 249 °M from ~~mark~~/Pillar
5. A G.I. Pipe set in conc/rock has been placed/~~found~~, bearing..... 149 °M from ~~mark~~/Pillar
6. A..... set in conc/rock has been placed/found, bearing..... °M from Mast/Plug/Pillar
7. A..... set in conc/rock has been placed/found, bearing..... °M from Mast/Plug/Pillar

8. Action required:

STANDPOINT: Concrete Observing Plate STANDPOINT: Bronze Trig Plug

Mark	Direction	HORIZ. Distance	Height Difference	Mark	Direction	HORIZ. Distance	Height
<u>BEARER (P)</u>	<u>0 00 00</u>		<u>above</u> below <u>standpt</u>	<u>BEARER (P)</u>	<u>0 00 00</u>		<u>above</u> below <u>standpt</u>
<u>MURDOCK (P)</u>	<u>129 42 00</u>		<u>above</u> below <u>standpt</u>	<u>MURDOCK (P)</u>	<u>129 42 40</u>		<u>above</u> below <u>standpt</u>
<u>DICK (P)</u>	<u>231 01 25</u>		<u>above</u> below <u>standpt</u>	<u>CONC OBS PLATE</u>	<u>179 12 00</u>	<u>4.509</u>	<u>15.44</u> <u>above</u> below <u>standpt</u>
<u>G.I. PIPE</u>	<u>272 24 55</u>	<u>5.073</u>	<u>above</u> below <u>standpt</u>	<u>G.I. PIPE</u>	<u>229 21 50</u>	<u>6.576</u>	<u>70.019</u> <u>above</u> below <u>standpt</u>
<u>MICKETY (P)</u>	<u>302 36 30</u>		<u>above</u> below <u>standpt</u>	<u>DICK (P)</u>	<u>231 00 00</u>		<u>above</u> below <u>standpt</u>
<u>Bronze Trig Plug</u>	<u>359 12 25</u>	<u>4.510</u>	<u>above</u> below <u>standpt</u>	<u>MICKETY (P)</u>	<u>302 35 30</u>		<u>above</u> below <u>standpt</u>

Prepared by: P.BATS 16.9.85. Checked: P.B. Noted on U.T.M. Card 4D

SI 2733-1

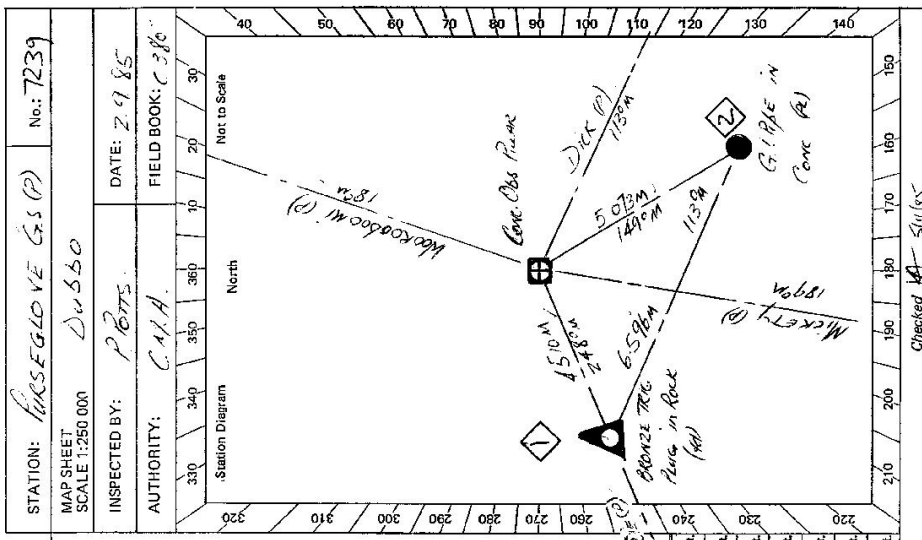

Checked P.B. 16.9.85

STATION: MURSELOVE GAS (P) No: 7239

MAP SHEET SCALE 1:250 000 DUBBO

INSPECTED BY: P.BATS DATE: 2.9.85

AUTHORITY: C.M.A. FIELD BOOK: C 376

8: 2733-2 D. West, Government Printer

STATION PURSE GLOVE IS 7239

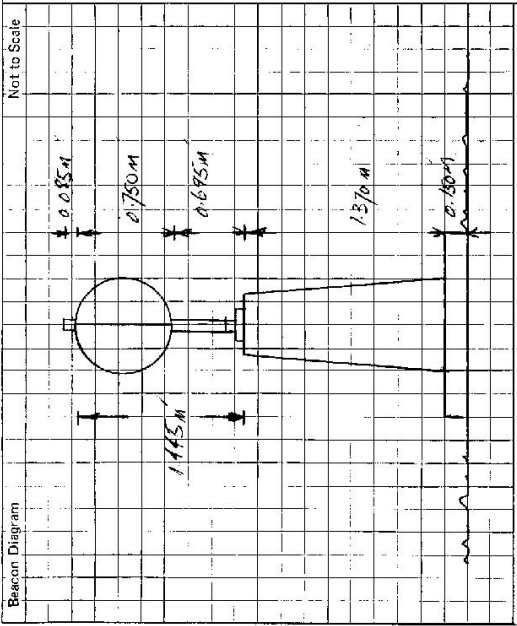

Owner's Name: TRIG RESERVE
 Address: 30 101 CARLETON
 Phone:
 Access Report of 1986 was found suitable/unsuitable.
 ACCESS
 0.00 AT MITCHELL AVE ABT 1/2 IN NITCHELL HIGHWAY RAIL TOWARDS NEWINGTON
 0.09 TURN LEFT SIGN DUNEDOO RD RM
 0.13 CROSS RAIL LINE
 0.17 TURN RIGHT TAYLOR STREET
 0.27 TURN LEFT
 4.02 ROAD AHEAD TO NESTLEA ON LEFT
 5.85 BUS ROAD & BALLIMORE ON LEFT
 7.49 TURN RIGHT INTO KALWIN PROPERTY & THROUGH DOUBLE IRON GATES
 8.03 DOUBLE IRON GATES. FOLLOW TRACK STRAIGHT AHEAD.
 8.20 IRON GATE
 8.36 TAKE TRACK ON LEFT ABOUT 100 YARDS ON LEFT
 8.65 END ON RIGHT
 8.98 END ON TRACK. TAKE TRACK ON FOR RAMP
 9.30 PASSENGER (RS (1))

This section to be completed by officer constructing pillar.
 Original station mark found/~~not found~~.
 Description of mark: BRONZE TRIG PILE
 Original beacon found/~~not found~~.
 Description of beacon: CHINA PIPE & DISC
 Height Top of Vane to Top Mark: 3.41 m.
 Height of mark: 3.685 m. above rock/case below G.L.
 Diameter of Vane: 0.275 m. Height of Cairn: 1.770 m.
 Original Beacon has ~~not~~ been destroyed by me.

Date	Record of Station