

CENTRAL MAPPING AUTHORITY

GEODETIC SURVEY OF N.S.W.

GEODETIC STATION RECONNAISSANCE and MAINTENANCE REPORT

STATION: *DICK G.S (P)* No.: *7237*

MAP SHEET SCALE 1:250 000  
INSPECTED BY: *P.BITS* DATE: *14/8/85*

AUTHORITY: *C.M.A.* FIELD BOOK: *C.380*

Description: *Scattered TREES* Note: *Cross out word or words which do not apply*  
1. Cleared by Janes bearing *95° 17' 170 on.* from Trig. Mast

2. Mast & Vanes have been painted white & black respectively

3. The *pillar* was *constructed on* *19.85*, dimensions now being: *1.530* m. *above* *concrete*; Mark is *1.530* m. *above* *G.L.*

Description of mark: *Steel Pillar Plate, Steel plug, Brass plug, Bolt, G.I. Pipe*

Height of Top Vanes to Top *Pillar plate* *1.450* m. Diameter of Vanes (vertical) *0.750* m.

Height of Cairn *1.450* m. Diameter of Cairn *0.750* m. Name Plate *found* *not placed*.

Length of Mast *1.450* m. (approximate if not unplied)

4. *Bronze Trig. Ring* set in *conc/rock* has been *found*, bearing *280°* M from *concrete* /Pillar

5. *G.I. Pipe* set in *conc/rock* has been placed, bearing *316°* M from *concrete* /Pillar

6. *Conc Obs Plate* set in *conc/rock* has been placed, bearing *274°* M from Mast/Plug/Pillar

7. *Conc Obs Plate* set in *conc/rock* has been placed, bearing *274°* M from Mast/Plug/Pillar

8. Action required: *REMOVAL OF NAME PLATE*

STANDPOINT: <i>Bronze Trig Ring</i>				STANDPOINT: <i>Conc Obs Plate</i>			
Mark	Direction	Horiz. Distance	Height Difference	Mark	Direction	Horiz. Distance	Height Difference
<i>GEURIE (P)</i>	<i>0 00 00</i>		above standpt.	<i>GEURIE (P)</i>	<i>0 00 00</i>		above standpt.
<i>BRISLOVE G.S.</i>	<i>23 48 30</i>		above standpt.	<i>BRONZE TRIG RING</i>	<i>01 32 50</i>	<i>4 155</i>	below standpt.
<i>G.I. PIPE</i>	<i>85 00 40</i>	<i>4 327</i>	below standpt.	<i>BRISLOVE G.S.</i>	<i>23 48 40</i>		below standpt.
<i>CONC OBS PLATE</i>	<i>181 33 50</i>	<i>4 155</i>	above standpt.	<i>G.I. PIPE</i>	<i>44 19 00</i>	<i>6 333</i>	below standpt.
<i>NELLESLEY (P)</i>	<i>288 30 20</i>		above standpt.	<i>NELLESLEY (P)</i>	<i>288 31 25</i>		above standpt.
			below standpt.				below standpt.
			above standpt.				above standpt.
			below standpt.				below standpt.

Prepared by: *P.BITS* 20.8.85 Checked: *P.BITS* 20.8.85

Noted on U.T.M. Card *40*

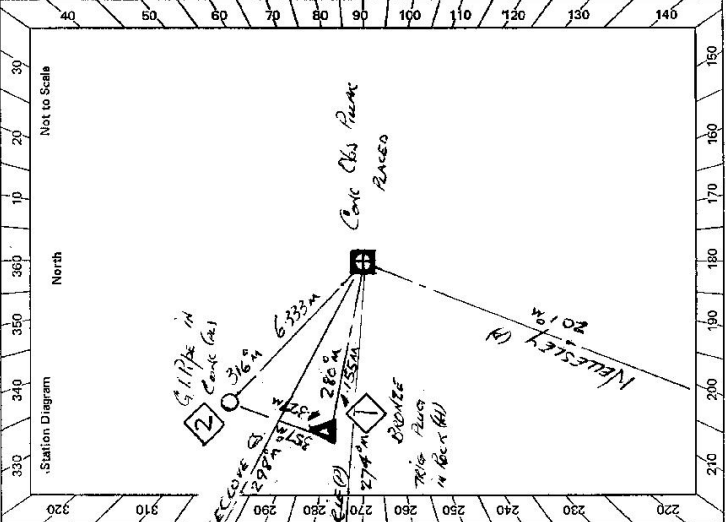

Checked: *P.BITS* 20.8.85

5: 2733-1

en: 2733 - 2 D. West, Government Printer

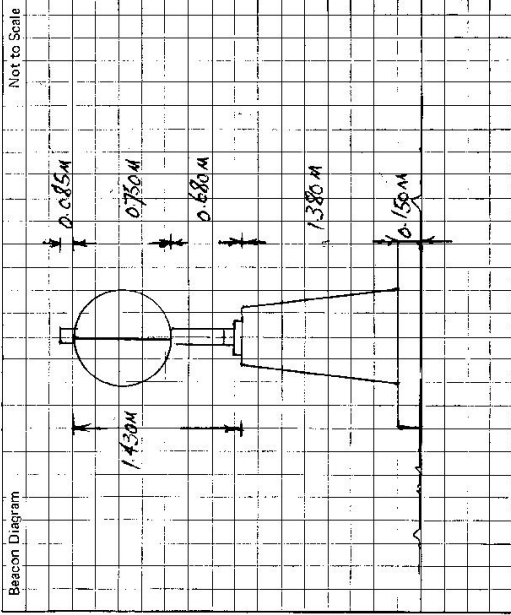

Not to Scale

Beacon Diagram

Owner's Name: Ms. G. J. Sullivan  
 Address: COLLEGE GREEN BOANINGORA  
 Phone: ZAMEEL  
 Current Occupant: DAVE  
 Address: 198  
 Phone: 198

STATION DICK G.S. (P) TS 7237

Access Report of 141, 18, 19 Vanes found suitable/unsuitable.

FEATURE: WELLINGTON HEAD TOWARDS DUNDAS ALONG MITCHELL HIGHWAY

0.00 TURN RIGHT ALONG MITCHELL HIGHWAY TOWARDS DUNDAS

0.12 BRIDGE OVER MURCHIE RIVER

1.89 TURN RIGHT SIGN GULBURNIA & MUDGE

2.13 CROSS RAN BRIDGE

5.13 TURN LEFT TOWARDS GUMBOYS & MUDGE

11.52 TURN LEFT SIGN BOANINGORA I & AERODROME

11.60 GRID

13.26 GRID

14.48 PASS STONE CHURCH ON RIGHT (BOANINGORA TOWNSHIP)

15.74 TURN LEFT THROUGH DOUBLE IRON GATES OPPOSITE DIRT ROAD

16.85 TURN LEFT OFF MAIN TRACK

17.04 DICK G.S. (P)

This section to be completed by officer constructing pillar.

Original station mark found/~~not found~~.  
 Description of mark: BRONZE TRIG RING  
 Original beacon found/~~not found~~.  
 Description of beacon: CAIRN ROBE & DISC  
 Height Top of Vanes to Top Mark: 3.570 m.  
 Height of mark: 0.070 m. above rock/~~below~~ stone G.L.  
 Diameter of Vanes: 0.765 m. Height of Cairn: 1.500 m.  
 Original Beacon has/~~has not~~ been destroyed by me.

Date	Record of Station