

Now known as APSLEY

GEODETTIC SURVEY OF N.S.W.

CENTRAL MAPPING AUTHORITY

GEODETTIC STATION RECONNAISSANCE and MAINTENANCE REPORT

Description:

1. Cleared by lances bearing..... *Scattered Small Trees* from Trig. Mast

2. Mast & Vanes have been painted white & black respectively.

3. The station/pillar was ~~erected~~ *erected* on 19....., dimensions now being:

Description of mark..... should be explicit, e.g., S/Steel Pillar Plate, Steel plug, Brass plug, Bolt, G.I. Pipe

Height of mark..... m..... above rock/concrete; Mark is..... m..... above G.L.

Height of Top Vanes to Top Mark/Pillar plate..... m..... Diameter of Vanes (vertical)..... m.

Height of Cairn..... m..... Diameter of Cairn..... m..... Name Plate found/not found/placed.

Length of Mast..... m..... (approximate if not unplied)

4. *Copper Nail*..... set in conc/rock has been placed/~~found~~, bearing..... ° M from Mast/Plug/Pillar

5. A..... set in conc/rock has been placed/found, bearing..... ° M from Mast/Plug/Pillar

6. A..... set in conc/rock has been placed/found, bearing..... ° M from Mast/Plug/Pillar

7. A..... set in conc/rock has been placed/found, bearing..... ° M from Mast/Plug/Pillar

8. Action required:..... *Construction of concrete base & bearings*

STANDPOINT: *Copper Nail*

STANDPOINT:

Mark	Direction	Horiz. Distance	Height Difference	Mark	Direction	Horiz. Distance	Height Difference
<i>WILLIAMS TRIG WEST</i>							
<i>HEZESLEY GCP</i>	0 00 00 ✓		above standpt.				above standpt.
<i>GRUE GCP</i>	33 52 10 ✓		above standpt.				above standpt.
<i>ROCK</i>	67 47 00 ✓	3.138	0.155				above standpt.
<i>ALLENBY G3</i>	99 42 40 ✓		above standpt.				above standpt.
<i>MURBIC G3</i>	20 39 00 ✓		above standpt.				above standpt.
<i>CHRISTIAN GCP</i>	280 52 00 ✓		above standpt.				above standpt.

Prepared by: *P.Potts* 23.8.1

Checked: *P.Potts* 5/6/8

Checked

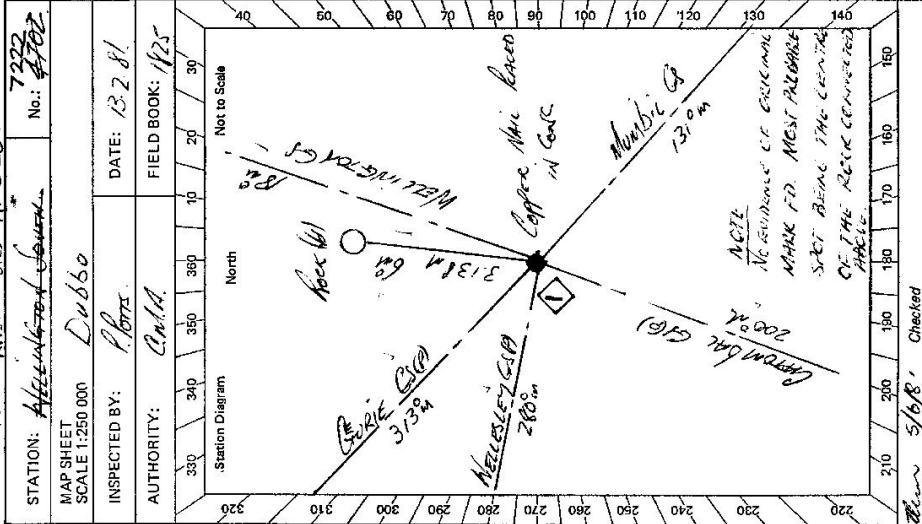

CENTRAL MAPPING AUTHORITY

GEODETIC SURVEY OF N.S.W.

GEODETIC STATION RECONNAISSANCE and MAINTENANCE REPORT

Description:

1. Cleared by lanes bearing 360° Note: Cross out word or words which do not apply from Trig. Mast
2. Mast & Vanes have been painted white & black respectively.
3. The station/pillar was ~~replaced~~ re-constructed on 18 MAY 1985, dimensions now being:

Description of mark Sk P. Plate should be explicit, e.g., S/Steel Pillar Plate, Steel plug, Brass plug, Bolt, G.I. Pipe

Height of mark 1.40 m. above rock/concrete; Mark is 1.58 m. above G.L.

Height of Top Vanes to Top Mast/Pillar plate 1.47 m. Diameter of Vanes (vertical) 0.50 m.

Height of Cairn 1.51 m. Diameter of Cairn 0.10 m. Name Plate found/not found/placed.

Length of Mast 1.51 m. (approximate if not compiled)

4. G.I. PIPE set in conc/rock has been placed/~~found~~, bearing 143° °M from ~~Mast/Plug/Pillar~~

5. Copper Spike set in conc/rock has been placed/~~found~~, bearing 233° °M from ~~Mast/Plug/Pillar~~

6. A set in conc/rock has been placed/~~found~~, bearing °M from Mast/Plug/Pillar

7. A set in conc/rock has been placed/~~found~~, bearing °M from Mast/Plug/Pillar

8. Action required: See F.B. 5446/02 for Station Summary

STANDPOINT: Conc Pillar

Mark	Direction	Horiz. Distance	Height Difference	Mark	Direction	Horiz. Distance	Height Difference
Wellesley (P)	273 00 00		standpt. above	Note			
Henry Werner (P)	309 20 30		standpt. above	There are NOT observations			
Wellington (Plug)	18 43 00		standpt. below	but is the summit			
G.I. PIPE	142 48 32	2.651	1.540 below	FB 01 is after adjustment			
COPPER SPIKE	231 39 57	3.136	1.643 below				
			standpt. above				
			standpt. below				
			standpt. above				
			standpt. below				
			standpt. above				
			standpt. below				

Prepared by: H.C. BORDER

Checked: H.C.

Noted on U.T.M. Card 1/1

Checked: H.C.

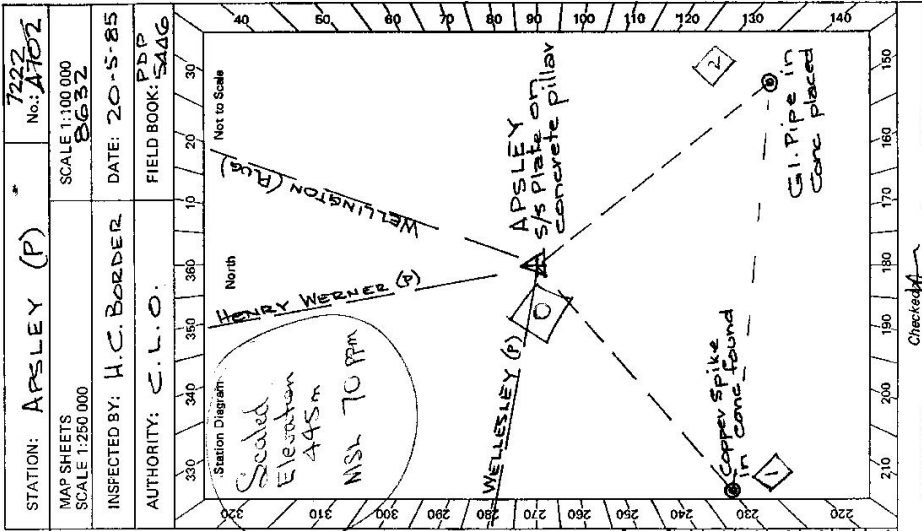

27233-2 D. West, Government Printer

STATION **APSLEY** * 7222

Owner's Name: **The Crown (Temporary Common)**
 Address:
 Phone:
 Current Occupant:
 Address:
 Phone:

ACCESS

Access Report of 20/5/1988 was found suitable/unsuitable.
 From Intc. Maxwell & Pierce Streets (0.0 km) travel south past Rabbit tip (1.5 km) and follow Naniima road to crest of ridge (3.0 km). Turn off on track to right and follow to fence into (3.8 km). 50m walk to TS. Conventional vehicle access.

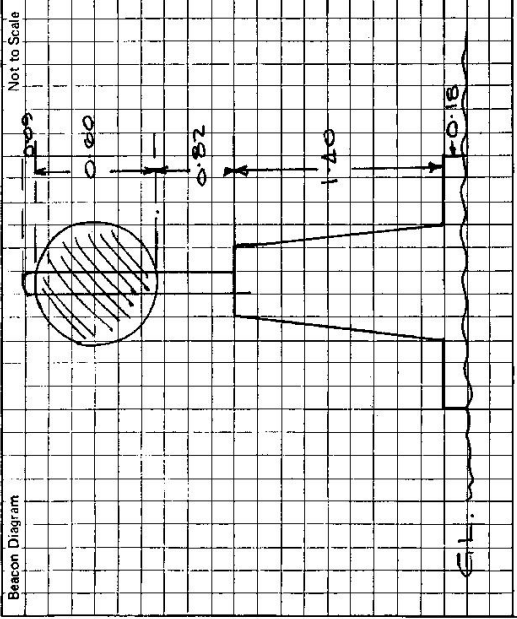
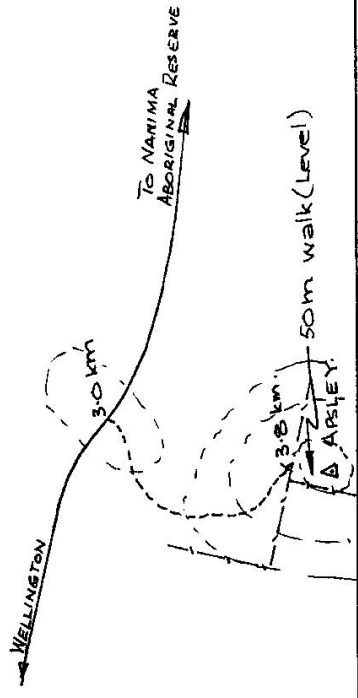

This section to be completed by officer constructing pillar.

Original station mark ~~found~~/not found.

Description of mark: **CONCRETE SPIKE IN CONC (Found)**

Original beacon ~~found~~/not found.

Description of beacon: **NONE**

Height Top of Vanes to Top Mark:m.

Height of mark:m. above below rock/concm. above below G.L.

Diameter of Vanes:m. Height of Cairn:m.

Original Beacon has/has not been destroyed by me. **Not Found.**

Date	Record of Station

LAND INFORMATION CENTRE

GEODETTIC SURVEY OF N.S.W.

GEODETTIC STATION RECONNAISSANCE and MAINTENANCE REPORT

STATION: *Apsley* No.: *7222*

MAP SHEET SCALE 1:250 000

INSPECTED BY: *C.Hels* DATE: *20/10/09*

AUTHORITY: *Lants* FIELD BOOK:

Station Diagram

Not to Scale

*Info. regarding.
Key for Locked
gate +*

Description:

1. Cleared by lanes bearing.....
 Note: *Cross out word or words which do not apply*
 from Trig. Mast

2. Mast & Vanes have been painted white & black respectively.

3. The station/pillar was unpiled/not unpiled/constructed on..... 19....., dimensions now being:

Description of mark.....should be explicit, e.g., S/Steel Pillar Plate, Steel plug, Brass plug, Bolt, G.I. Pipe

Height of mark.....m. ^{above} rock/concrete; Mark is.....m. ^{above} G.L. _{below}

Height of Top Vanes to Top Mark/Pillar plate.....m. Diameter of Vanes (vertical).....m.

Height of Cairn.....m. Diameter of Cairn.....m. Name Plate found/not found/placed.

Length of Mast.....m. (approximate if not unpiled)

4. A.....set in conc/rock has been placed/found, bearing.....°M from Mast/Plug/Pillar

5. A.....set in conc/rock has been placed/found, bearing.....°M from Mast/Plug/Pillar

6. A.....set in conc/rock has been placed/found, bearing.....°M from Mast/Plug/Pillar

7. A.....set in conc/rock has been placed/found, bearing.....°M from Mast/Plug/Pillar

8. Action required:.....

STANDPOINT:

STANDPOINT:

Mark	Direction	Horiz. Distance	Height Difference	Mark	Direction	Horiz. Distance	Height Difference
			above standpt below				above standpt below
			above standpt below				above standpt below
			above standpt below				above standpt below
			above standpt below				above standpt below
			above standpt below				above standpt below
			above standpt below				above standpt below
			above standpt below				above standpt below
			above standpt below				above standpt below

Prepared by:

Checked:

Noted on U.T.M. Card

Checked

GEODETIC SURVEY OF N.S.W.

CENTRAL MAPPING AUTHORITY

GEODETIC STATION RECONNAISSANCE and MAINTENANCE REPORT

STATION: **APSLEY (P)** No.: **7222**
 MAP SHEETS SCALE 1:100 000
 SCALE **1:250 000**
 INSPECTED BY: **H.C. BORDER** DATE: **20-5-85**
 AUTHORITY: **C.L.O.** FIELD BOOK: **PDP 5446**

Description: **360**
 Note: *Cross out word or words which do not apply*
 1. Cleared by lanes bearing..... from Trig, Mast
 2. Mast & Vanes have been painted white & black respectively. -
 3. The station/pillar was ~~unplaced~~ ~~not~~ ~~erected~~ ~~constructed~~ on **18 MAY 1985**, dimensions now being:

Description of mark: **3/4 P Plate** should be explicit, e.g., S/Steel Pillar Plate, Steel plug, Brass plug, Bolt, G.I. Pipe
 Height of mark: **1.40** m. above ~~rock~~ ~~concrete~~; Mark is **1.58** m. above G.L.
 Height of Top Vanes to Top Mast/Pillar plate **1.47** m. Diameter of Vanes (vertical) **0.60** m.
 Height of Cairn.....m. Diameter of Cairn.....m. Name Plate found/not found/placed.
 Length of Mast **1.51** m. (approximate if not omitted)
 4. **A.G.I. PIPE**..... set in conc/rock has been placed/~~found~~, bearing **143.2**°M from Mast/Plug/Pillar
 5. **A COPPER SPIKE**..... set in conc/rock has been placed/~~found~~, bearing **233.2**°M from Mast/Plug/Pillar
 6. **A**..... set in conc/rock has been placed/~~found~~, bearing.....°M from Mast/Plug/Pillar
 7. **A**..... set in conc/rock has been placed/~~found~~, bearing.....°M from Mast/Plug/Pillar

8. Action required: **SRR FB01 SAAG/07 for station summery**

Mark	Direction	Horiz. Distance	Height Difference	Mark	Direction	Horiz. Distance	Height Difference
Wellesley (P)	719 00 00			Nok			
Henry Werner (P)	349 20 30			These are NOT observations			
Wellington (Plug)	18 43 00			but is the summit			
G.I. PIPE	142 48 32	2.651	1.540	FB01 is other observation			
COPPER SPIKE	281 39 57	3.136	1.643				
							2.785

STANDPOINT: **Core Pillar**

Prepared by: **H.C. BORDER** Checked: **[Signature]**

Noted on U.T.M. Card **[Signature]**

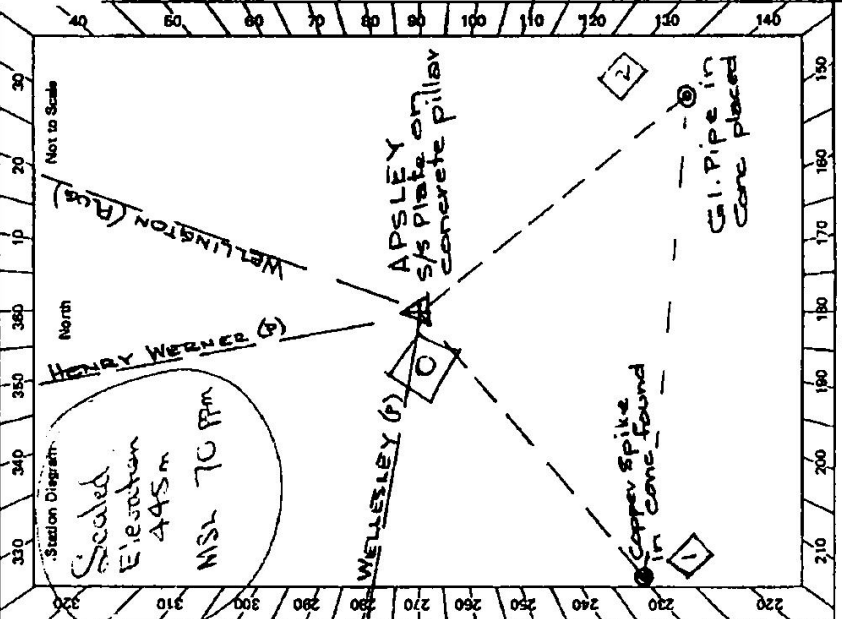

2723-3 D. West, Government Printer

STATION **APSLEY - 7222**

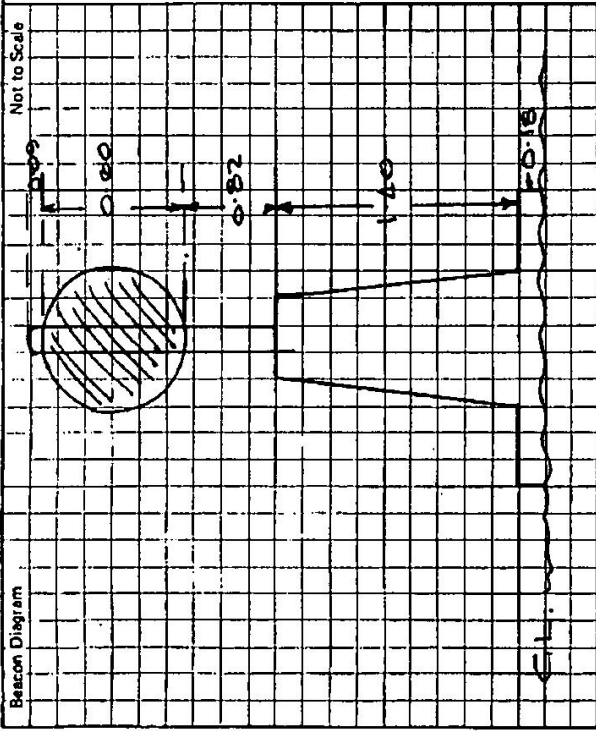

Owner's Name: **The Crown (Temporary Common)**
 Address:
 Phone:

Current Occupant:
 Address:
 Phone:

ACCESS

Access Report of 27/5/1985 was found suitable/unsuitable.
 From Intk. Maxwell & Pierce Streets (0.0 km) travel south past Robb's tip (1.5 km) and follow Naima road to crest of ridge (3.0 km). Turn off on track to right and follow to fence intk. (3.8 km). 50m walk to 75. Conventional vehicle access.

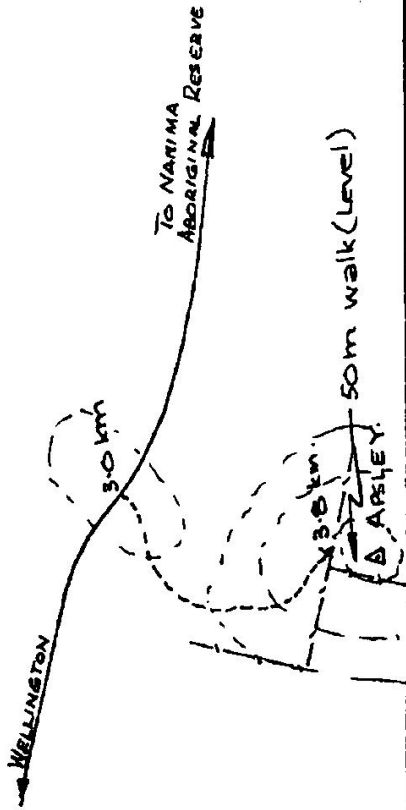

This section to be completed by officer constructing pillar.

Original station mark **found/not found.**
 Description of mark: **CONCRETE SPIKE IN CONC (FOUND)**
 Original beacon **found/not found.**
 Description of beacon: **NONE**
 Height Top of Vanes to Top Mark:m.
 Height of mark:m. above G.L. below
 Diameter of Vanes:m. Height of Cairn:m.
 Original Beacon has/has not been destroyed by ms. **Not found.**

Date	Record of Station

Now known as APSLEY

STATION: Affiliated Survey No.: 7222
#702

MAP SHEET SCALE 1:250 000 Dubbo
INSPECTED BY: P. Potts DATE: 13.2.81

AUTHORITY: C.M.A. FIELD BOOK: 1825

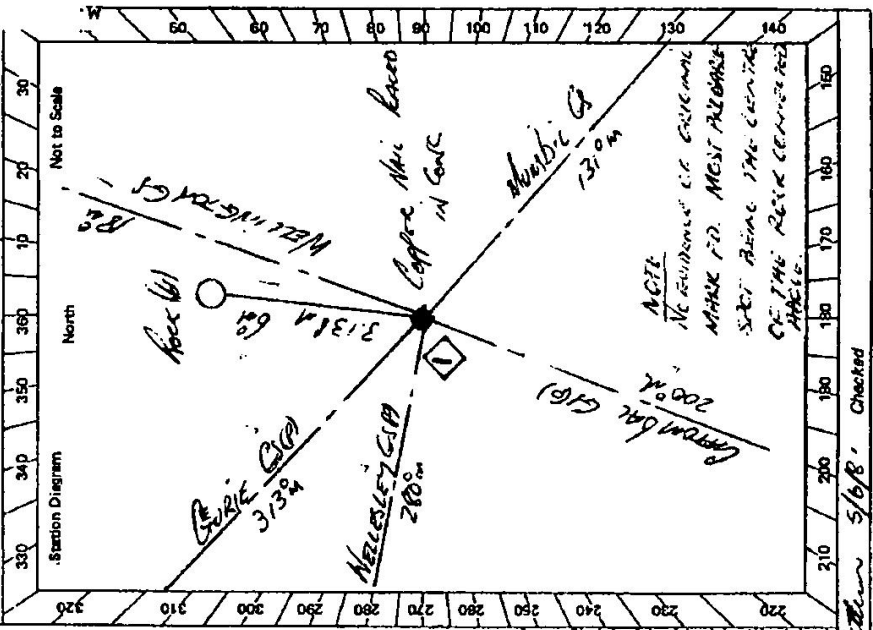

GEODETIC STATION RECONNAISSANCE and MAINTENANCE REPORT

GEODETIC SURVEY OF N.S.W.

CENTRAL MAPPING AUTHORITY

Description: Surveyed S.M.M. 7222 TRIG. TRIG.
1. Cleared by lanes bearing..... TRIG. from Trig. Mast

2. Mast & Vanes have been painted white & black respectively.

3. The station/pillar was unpiled/met unpiled/constructed on..... 19....., dimensions now being:

Description of mark:..... should be explicit, e.g., S/Steel Pillar Plate, Steel plug, Brass plug, Bolt, G.I. Pipe
Height of mark:..... m. above rock/concrete; Mark is..... m. above G.L.
Height of Top Vanes to Top Mark/Pillar plate..... m. Diameter of Vanes (vertical)..... m.
Height of Cairn..... m. Diameter of Cairn..... m. Name Plate found/met found/placed..... m.
Length of Mast..... m. (approximate if not unpiled)

4. A Copper Nail..... set in conc/rock has been placed/..... bearing..... °M from Mast/Plug/Pillar

5. A..... set in conc/rock has been placed/..... bearing..... °M from Mast/Plug/Pillar

6. A..... set in conc/rock has been placed/..... bearing..... °M from Mast/Plug/Pillar

7. A..... set in conc/rock has been placed/..... bearing..... °M from Mast/Plug/Pillar

8. Action required: CONSTRUCTION OF CONCRETE BASE & CLEARING

STANDPOINT: Copper Nail

Mark	Direction	Horiz. Distance	Height Difference	Mark	Direction	Horiz. Distance	Height Difference
<u>TRIG. MARK</u>	<u>0 00 00</u>	<u>1</u>	<u>above standpt.</u>				<u>above standpt.</u>
<u>GRABIE GCP</u>	<u>33 52 10</u>	<u>1</u>	<u>above standpt.</u>				<u>above standpt.</u>
<u>ROCK</u>	<u>67 07 00</u>	<u>3.138</u>	<u>0.15</u>				<u>above standpt.</u>
<u>NECLESLEY G3</u>	<u>99 02 40</u>	<u>1</u>	<u>above standpt.</u>				<u>above standpt.</u>
<u>MINIBIC G3</u>	<u>20 39 00</u>	<u>1</u>	<u>above standpt.</u>				<u>above standpt.</u>
<u>CONCRETE GCP</u>	<u>280 52 00</u>	<u>1</u>	<u>above standpt.</u>				<u>above standpt.</u>

Prepared by: P. Potts 2.3.81

Checked: P. Potts 5/6/81

Noted on U.T.M. Card 5/6/81 Checked

