

GEODETIC SURVEY OF N.S.W.

CENTRAL MAPPING AUTHORITY

GEODETIC STATION RECONNAISSANCE and MAINTENANCE REPORT

STATION: WELLINGTON G.S. No.: TS 7221

MAP SHEET SCALE 1:250 000 DUBBO

INSPECTED BY: A. WOODRUFF DATE: 23rd AUG 78

AUTHORITY: CENTRAL MAPPING FIELD BOOK: 16255

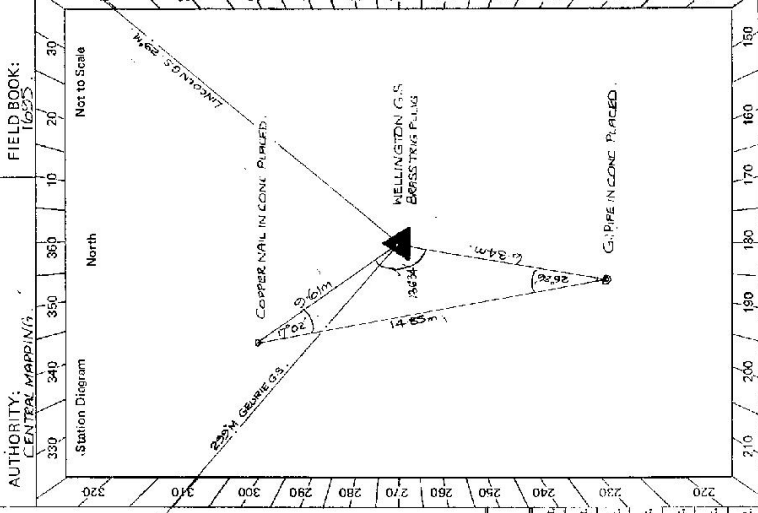

Description:	STANDPOINT: Brass Trig Plug found			STANDPOINT: GI PIPE IN CONC PLACED			
	Direction	Horiz. Distance	Height Difference	Mark	Direction	Horiz. Distance	Height Difference
1. Cleared by lanes bearing <u>360° VISION</u> ..... from Trig. Mast							
2. Mast & Vanes have been painted white & black respectively. ✓							
3. The station/pillar was <u>unplaced/not unplaced/constructed on</u> ..... <u>2.4m</u> <sup>above</sup> <u>CONCRETE</u> ....., dimensions now being: Description of mark <u>Brass Trig Plug</u> ..... should be explicit, e.g., S/Steel Pillar Plate, Steel plug, Brass plug, Bolt, G.I. Pipe							
Height of mark.....m. <sup>above</sup> rock/concrete; <sub>below</sub> G.L.							
Height of Top Vanes to Top Mark/ <u>Pillar-plate</u> .....m. Diameter of Vanes (vertical).....m.							
Height of Cairn.....m. Diameter of Cairn.....m. Name Plate found/not found/placed.							
Length of Mast.....m. (approximate if not unplaced)							
4. A. <u>COPPER NAIL</u> ..... set in conc/rock has been placed/ <u>found</u> , bearing.....° M from Mast/ <u>Plug/Pillar</u>							
5. A. <u>G.I. PIPE</u> ..... set in conc/rock has been placed/ <u>found</u> , bearing.....° M from Mast/ <u>Plug/Pillar</u>							
6. A. .... set in conc/rock has been placed/ <u>found</u> , bearing.....° M from Mast/ <u>Plug/Pillar</u>							
7. A. .... set in conc/rock has been placed/ <u>found</u> , bearing.....° M from Mast/ <u>Plug/Pillar</u>							
8. Action required:.....							

Prepared by: A. Woodruff. Checked: A. Woodruff. Noted on U.T.M. Card

STATION WELLINGTON GS TS 7221									
<p>Owner's Name: MICHAEL ELLEN                      Address: WELLINGTON, NZ                      Phone: WELLINGTON, NZ                      Current Occupant: .....                      Address: .....                      Phone: .....</p> <p style="text-align: center;"><b>ACCESS</b></p> <p>Access Report of 23.8.1972 was found suitable/unsuitable. N/A                      0.0 Km From Post-office Head West along Maughan St ✓                      0.1 Km Turn right towards Dubbo ✓                      Follow Mitchell Hwy through town ✓                      1.4 Km Cross bridge over Macquarie River ✓                      1.9 Km Turn right towards Gulgong ✓                      5.2 Km Take right fork towards Wuluman (1.4K) ✓                      8.2 Kms Turn right to property New red brick house ✓                      8.3 Kms Pass through yard between sheds ✓                      8.35 Kms Pass through gate follow track ✓                      8.45K Pass through gate follow track see hayshed on left ✓                      8.9K Pass through gate ✓                      9.4K Pass through gate ✓                      9.5K Take right fork in track ✓                      9.9K Follow track up hill and reach mg ✓</p>	<p>Not to Scale</p> <p>This section to be completed by officer constructing pillar.</p> <p>Original station mark found/not found.</p> <p>Description of mark: .....</p> <p>Original beacon found/not found.</p> <p>Description of beacon: .....</p> <p>Height Top of Vanes to Top Mark: .....m.                      above below                      Height of mark: .....m. rock/cone .....m. above below G.L.                      Diameter of Vanes: .....m. Height of Cairn: .....m.</p> <p>Original Beacon has/has not been destroyed by me.</p> <table border="1" style="width: 100%; margin-top: 10px;"> <thead> <tr> <th style="width: 50%;">Date</th> <th style="width: 50%;">Record of Station</th> </tr> </thead> <tbody> <tr> <td> </td> <td> </td> </tr> <tr> <td> </td> <td> </td> </tr> <tr> <td> </td> <td> </td> </tr> </tbody> </table>	Date	Record of Station						
Date	Record of Station								

CENTRAL MAPPING AUTHORITY

GEODETTIC SURVEY OF N.S.W.

GEODETTIC STATION RECONNAISSANCE and MAINTENANCE REPORT

Description:

1. Cleared by lanes bearing 360° Note: Cross out word or words which do not apply from Trig. Mast

2. Mast & Vanes have been painted white & black respectively.

3. The station/pillar was ~~re-erected~~ ~~re-constructed~~ ~~re-constructed~~ on 30<sup>th</sup> May, 1985, dimensions now being:

Description of mark S/S Pillar should be explicit, e.g., S/Steel Pillar Plate. Steel plug, Brass plug, Bolt, G.I. Pipe

Height of mark 1.41 m. above ~~below~~ ~~rock~~ ~~concrete~~; Mark is 1.51 m. above ~~below~~ G.L.

Height of Top Vanes to Top Mast/Pillar plate 1.46 m. Diameter of Vanes (vertical) 60 m.

Height of Cairn                      m. Diameter of Cairn                      m. Name Plate ~~found~~ ~~not found~~ / placed.

Length of Mast 1.55 m. (~~approximate if not supplied~~)

4. A Trig. Plug set in ~~stone~~ ~~rock~~ has been ~~placed~~ ~~found~~, bearing 218° M from Mast/Plug/Pillar

5. A G.I. Pipe set in conc/rock has been ~~placed~~ ~~found~~, bearing 188° M from Mast/Plug/Pillar

6. A Copper Spike set in conc/rock has been ~~placed~~ ~~found~~, bearing 230° M from Mast/Plug/Pillar

7. A                      set in conc/rock has been ~~placed~~ ~~found~~, bearing                      M from Mast/Plug/Pillar

8. Action required: See Form SA46/03 for Station Summary

STANDPOINT: Conc Pillar

Mark	Direction	Horiz. Distance	Height Difference	Mark	Direction	Horiz. Distance	Height Difference
			above standpt. below standpt.				above standpt. below standpt.
TS WELLESLEY (P)	238 00 00			Note			
Copper Spike	290 34 34	10.088	1.997	Not checked			
TS Lincoln (P)	27 13 02			This is summit of cone			
G.I. Pipe	188 09 05	0.929	1.773	10 m. above summit			
TS Apsley (P)	197 46 46			Cap to C.U. stand			
TS Henry Werner	208 14 32			Cap to Plug			
Trig Plug	218 36 59	3.275	1.450				

Prepared by: H. C. BORDER

Checked: [Signature]

Noted on U.T.M. Card [Signature]

TS 7221  
STATION: WELLINGTON (P)  
MAP SHEETS  
SCALE 1:250 000  
No.: 4561  
BG52

INSPECTED BY: H. C. BORDER  
DATE: 30-5-85

AUTHORITY: C.L.O.  
FIELD BOOK: 5446

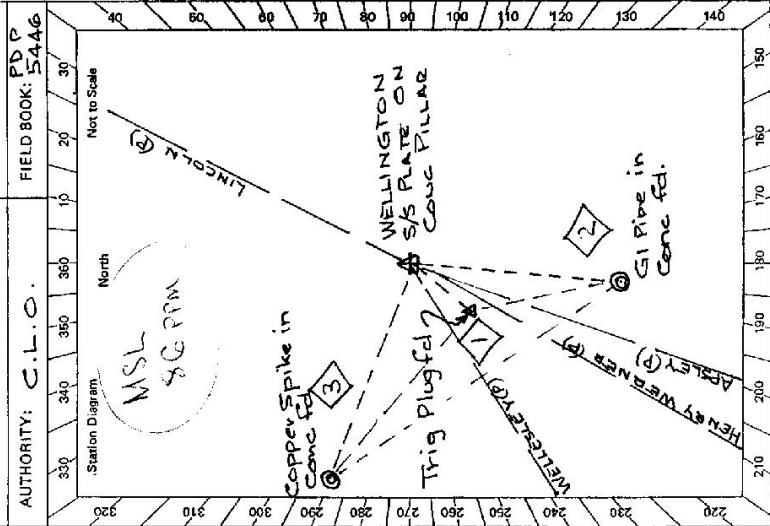

Checked: [Signature]

SI: 2733-2 D. West, Government Printer

STATION WELLINGTON TS 7221

Owner's Name: Michael Brien  
 Address: Hillandale, South Otago, Wellington  
 Phone: Wellington 45 32 93  
 Current Occupant: Same  
 Address: .....  
 Phone: .....

**ACCESS**

No Previous Report  
 Access Report of 27/5/1985 was found suitable/unsuitable.  
 From Wellington North (Evidge 0.0 km), take Gulgong road. Continue east past Gulgong turn-off (at 3.5 km) for 6.3 km to property "Hillandale". Travel south past homestead to gate at Hayshed (6.6 km) cross creek and take R/hand fork (7.0 km). Through gate (7.1 km) follow track to another gate (7.6 km). From here follow fence to Trig at 8.0 km.

Not to Scale

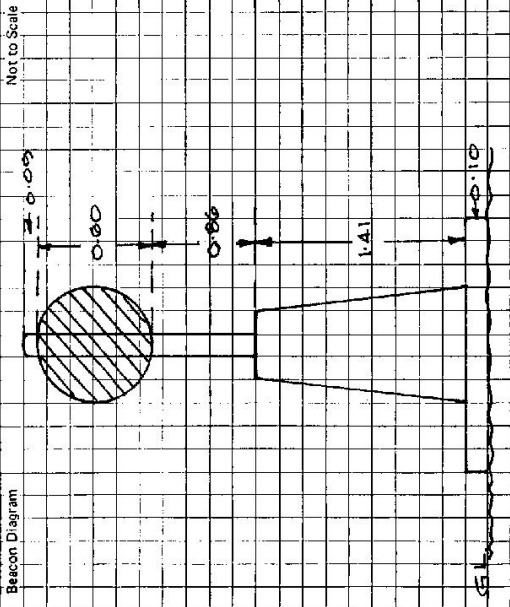

This section to be completed by officer constructing pillar.

Original station mark found/~~not found~~.

Description of mark: Bronze Plug in Rock

Original beacon found/~~not found~~.

Description of beacon: Cairn, Pole & Discs

Height Top of Vane to Top Mark ..... m.

Height of mark 0.7 m. <sup>above G.L.</sup> ~~below~~

Diameter of Vane ..... m.

Height of Cairn 1.5 m.

Original Beacon has/~~has not~~ been destroyed by me.

Date

Record of Station