

CENTRAL MAPPING AUTHORITY

GEODETIC SURVEY OF N.S.W.

GEODETIC STATION RECONNAISSANCE and MAINTENANCE REPORT

Description:

1. Cleared by lanes bearing REELS to 349, 464, 640 *Note: Cross out word or words which do not apply* from Trig. Mast

2. Mast & Vanes have been painted white & black respectively.

3. The ~~station~~ pillar was ~~replaced~~ *not replaced* / constructed on ZMP Mast 19.85 m, dimensions now being:

Description of mark Steel Plug should be explicit, e.g., S/Steel Pillar Plate. Steel plug, Brass plug, Bolt, G.I. Pipe

Height of mark 1.550 m, above rock/concrete; Mark is 1.550 m, above G.L.

Height of Top Vanes to Top Mark/Pillar plate 1.465 m. Diameter of Vanes (vertical) 0.750 m.

Height of Cairn ..... m. Diameter of Cairn ..... m. Name Plate found/not ~~found~~/placed.

Length of Mast ..... m. (approximate if not unspiled)

4. BRASS PIPE set in conc/rock has been placed/found, bearing 275.0°M from BRASS/STEEL Pillar

5. G.I. PIPE set in conc/rock has been placed/bearing 306.0°M from Mast/BRASS Pillar

6. G.I. PIPE set in conc/rock has been placed/found, bearing 119.0°M from Mast/BRASS Pillar

7. A set in conc/rock has been placed/found, bearing .....°M from Mast/Plug/Pillar

8. Action required: CONCRETE OBSERVANCE PILE STANDBY POINT: BRASS PIPE PILE

Mark	Direction	Horiz. Distance	Height Difference	Mark	Direction	Horiz. Distance	Height Difference
NARROW (P)	0 00 00		above standpt	NARROW (P)	0 00 00		above standpt
G.I. PIPE	1 02 25	4.815	above standpt	G.I. PIPE	1 46 30	2.520	above standpt
SPRING (P)	1 15 50		above standpt	CONC OLS PILE	1 46 30	2.303	above standpt
G.I. PIPE	1 18 30	6.828	above standpt	G.I. PIPE	1 24 40	1.915	above standpt
NUTTER (P)	2 15 44 29		above standpt	SPRING (P)	1 15 00		above standpt
BRASS PILE	3 41 46 40	3.202	above standpt	NUTTER (P)	2 15 42 40		above standpt

Prepared by: HELEN 25 5 85 Checked: ..... Noted on U.T.M. Card .....

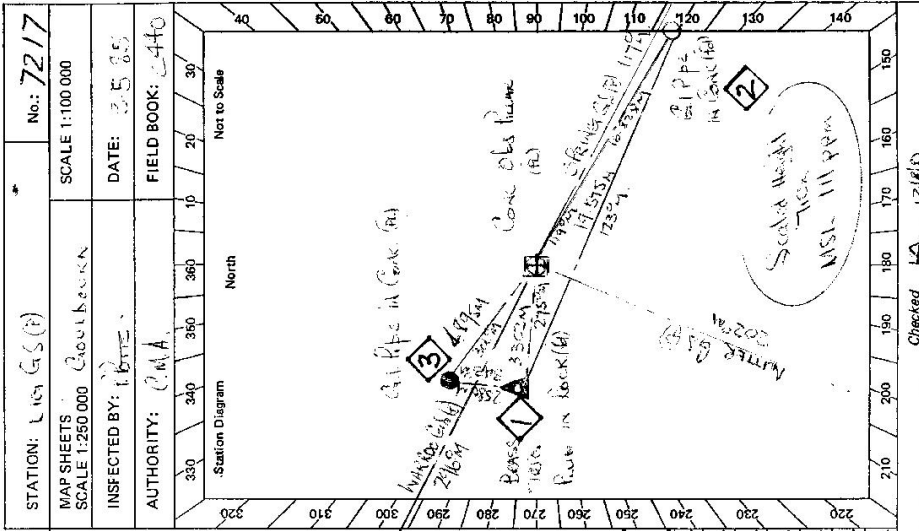

Checked KA 12/8/18

STATION 216.643 - 7217

Owner's Name: MR STAVE M. S. J. J. VAN  
 Address: RAMENSWORTH  
 Phone: 03 2715530  
 Current Occupant:  
 Address:  
 Phone:

**ACCESS**

Access Report of 3/5/19. was found suitable/unsuitable.

LEAVE  
 EAST SIDE VASS TAKE HOME HIGHWAY TOWARDS SWANBY  
 TURN LEFT ONTO BARTON HIGHWAY  
 TURN LEFT ONTO DEER TRACK ROAD  
 PASS CROSS RAILS OVER LONG RAIL GULLY ROAD  
 END STABLE ROAD  
 TURN RIGHT INTO RAMENSWORTH ROBERTS & THOMAS ROAD  
 PASS TRACK ON RIGHT  
 TURN LEFT ON MAIN STREET & FOLLOW TRACK ALONG LEAVE LANE  
 MAIN STREET GOES TO CHANDLER HOUSE.  
 (ON CORNER  
 TURN ON LEFT - TAKE STRAIGHT UP RIDGE TO TREE  
 END LANE)

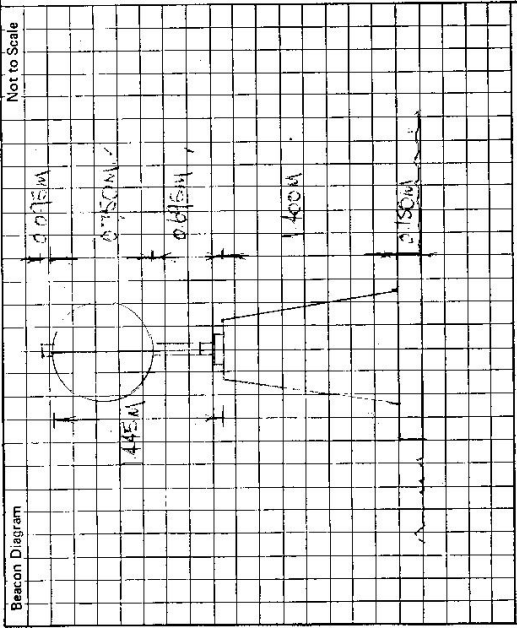

This section to be completed by officer constructing pillar.

Original station mark found/~~not found~~.  
 Description of mark: BRASS TRIP PILE  
 Original beacon found/~~not found~~.  
 Description of beacon: CALCA BOLL & DISC  
 Height Top of Vanes to Top Mark: 3.875 m.  
 Height of mark 0.65 m. above rock/stone.....m. below G.L.  
 Diameter of Vanes 0.60.....m. Height of Gaff 1.600.....m.  
 Original Beacon has/~~has not~~ been destroyed by me.

Date	Record of Station