

CENTRAL MAPPING AUTHORITY

GEODETIC SURVEY OF N.S.M.
 GEODETIC STATION RECONNAISSANCE and MAINTENANCE REPORT

- Description: **360°**
 Note: Cross out word or words which do not apply
- Cleared by ~~level bearing~~ **360°** from Trig. Mast
 - Mast & Vanes have been painted white & black respectively. **N/A**
 - The station ~~pillar was unplaced, not unplaced~~ **reconstructed** on **26/6/1982**, dimensions now being:
 Description of mark..... should be explicit, e.g., S/Steel Pillar Plate, Steel plug, Brass plug, Bolt, G.I. Pipe
 Height of mark.....^{above} m. ~~rock/concrete;~~ ^{above} m. ~~below~~ m. ^{above} G.L.
 Height of Top Vanes to Top Mark/Pillar plate m. Diameter of Vanes (vertical)..... m.
 Height of Cairn..... m. Diameter of Cairn..... m. Name Plate found/not found/placed.
 Length of Mast..... m. (approximate if not unplaced)
 - A..... set in conc/rock has been placed/found, bearing.....° M from Mast/Plug/Pillar
 - A..... set in conc/rock has been placed/found, bearing.....° M from Mast/Plug/Pillar
 - A..... set in conc/rock has been placed/found, bearing.....° M from Mast/Plug/Pillar
 - A..... set in conc/rock has been placed/found, bearing.....° M from Mast/Plug/Pillar
 - Action required: **Construction of Pillar (preferably where indicated)**

STANDPOINT:

Mark	Direction	Mark Distance	Height Difference	Direction	Horiz. Distance	Height Difference
Balfours Peaks	0° 00' 00"		above standpt.			above standpt.
GIRGIN G.S.P	30 15 50.8		below standpt.			below standpt.
TELECOM TOWER (Grom Dist)	149 59 53.2		above standpt.			above standpt.
STACK HILL?	245° 25'		below standpt.			below standpt.
ABERDEEN HILL?	285° 11'		above standpt.			above standpt.
			below standpt.			below standpt.

Prepared by: *J. Sherwin* 2/7/82 Checked: *[Signature]*

Noted on U.T.M. Card

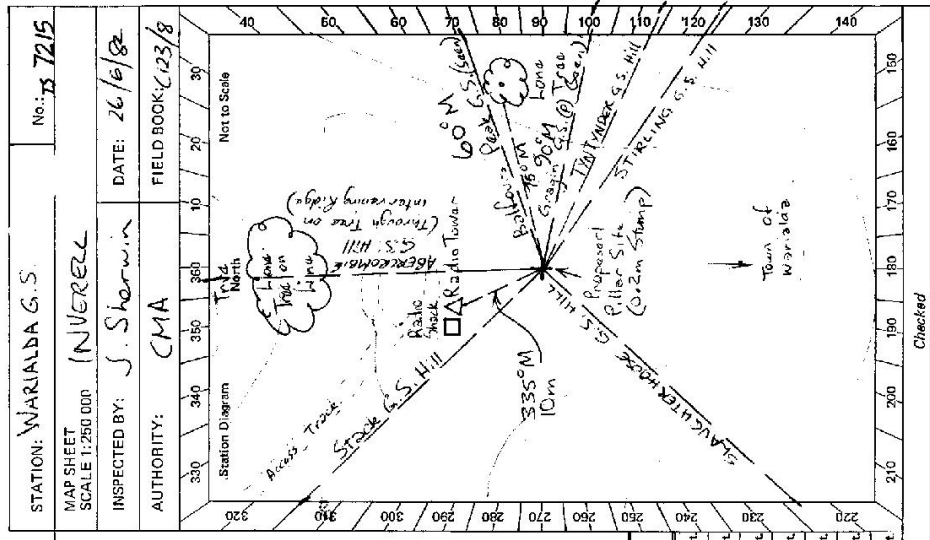

Checked: *[Signature]*

Station Diagram

North to Scale

FIELD BOOK: 203/8

DATE: 26/6/82

INSPECTED BY: J. Sherwin

MAP SHEET SCALE 1:250 000

STATION: WARIALDA G.S.

No.: 13 7215

Authority: CMA

STATION **WARUALDA G.S. TS 7215**

Owner's Name:
 Address:
 Phone:
 Current Occupant: **NOT EXISTING**
 Address: **PO BOX LOT 4 OF DP (SCHOOL REF) Ph. Beulah Co Burnett**
 Phone: **CL 69/9**
 Date: **26-6-1982**

Access Report of **26/6/1982** was found suitable for construction:
ACCESS
 00 Warualda PO head north to Yehman
 5.5 Keep Right
 5.75 Turn Right to gate South of Yards
 5.8 THROUGH GATE UP TRACK TO
 6.4 TOP OF HILL, RADIO TOWER AND
 Proposed Pillar Position.
 Approx Coords -29°30' Lat 150°35' Long
 on GROSSGRAMAN

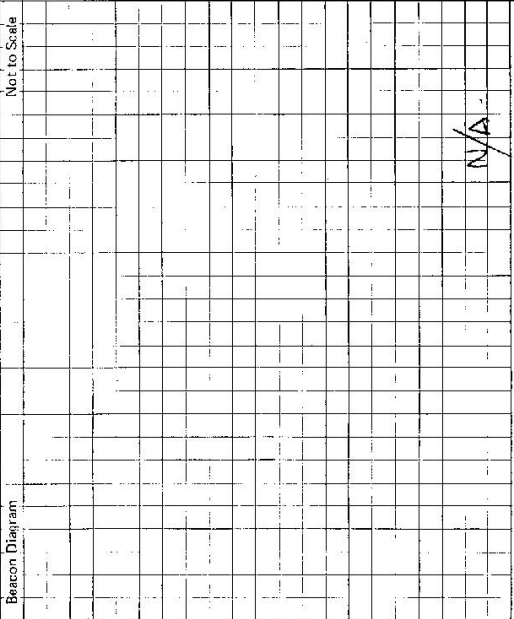
Beacon Diagram:  Not to Scale

This section to be completed by officer constructing pillar.
 Original station mark found/~~not found~~. **N/A**
 Description of mark:
 Original beacon found/not found.
 Description of beacon:
 Height Top of Vanes to Top Markm.
 Height of markm. above G.L. below
 Diameter of Vanesm. Height of Cairnm.
 Original Beacon has/had not been destroyed by me.

Date	Record of Station
26/6/82	Visited Hill observed other hills after trig

STATION: **WARIALDA (P)** No: **6550**

MAP SHEET SCALE 1:250 000

INSPECTED BY: **G FERR** DATE: **20-11-82**

AUTHORITY: **C.M.A.** FIELD BOOK: **1930**

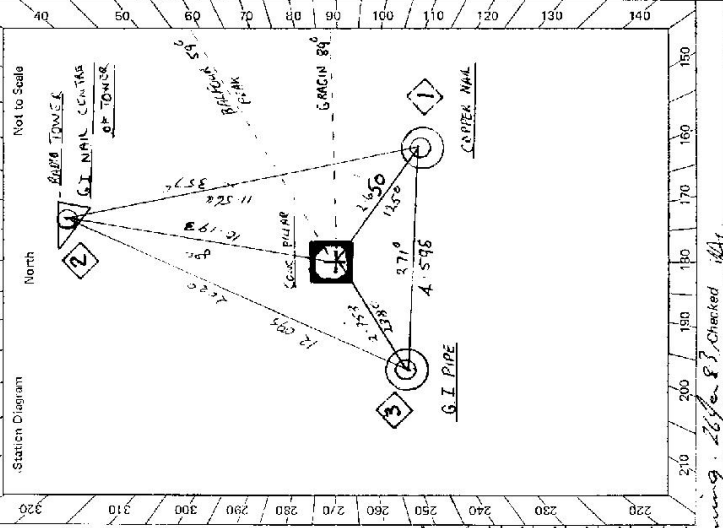

CENTRAL MAPPING AUTHORITY
 GEODETIC SURVEY OF N.S.W.
 GEODETIC STATION RECONNAISSANCE and MAINTENANCE REPORT

Description: *Note: Cross out word or words which do not apply*

1. Cleared by lances bearing $82^{\circ} 15' 15''$ $160^{\circ} 26' 29''$ $201^{\circ} 32' 30''$ $307^{\circ} 2' 6''$ from Trig. Mast
2. Mast & Vanes have been painted white & black respectively.
3. The station/pillar was ~~erected~~ ~~not erected~~ / constructed on $19-11-1982$, dimensions now being: Description of marks ~~MARKS~~ ~~MARK~~ ~~MARK~~ should be explicit, e.g., S/Steel Pillar Plate, Steel plate, Brass plate, Bolt, G.I. Pipe Height of mark 1.370 m. ^{above} ~~below~~ ~~concrete~~ Mark is 1.500 m. ^{above} ~~below~~ G.L. Height of Top Vanes to Top ~~Mark~~ Pillar plate 1.440 m. Diameter of Vanes (vertical) 0.250 m. Height of Cairn 0 m. Diameter of Cairn 0 m. Name Plate found/not found/placed. Length of Mast 0 m. (approximate if not unplied)
4. A...~~COPPER~~...~~NAIL~~ set in conc/~~rock~~ has been placed/~~found~~ bearing 125° M from Mast/~~Plug~~/~~Pillar~~
5. A...~~G.I.~~...~~PIPE~~ set in conc/~~rock~~ has been placed/~~found~~ bearing 238° M from Mast/~~Plug~~/~~Pillar~~
6. A...~~G.I.~~...~~NAIL~~ set in conc/~~rock~~ has been placed/~~found~~ bearing 8° M from Mast/~~Plug~~/~~Pillar~~
7. A... set in conc/~~rock~~ has been placed/~~found~~ bearing 0 M from Mast/~~Plug~~/~~Pillar~~
8. Action required:

STANDPOINT:		CONC PILLAR		STANDPOINT:		COPPER NAIL	
Mark	Direction	Horiz. Distance	Height Difference	Mark	Direction	Horiz. Distance	Height Difference
BALFOURS PEAK (CON)	0 00 00		above standpt	BALFOURS PEAK (CON)	0 00 00		above standpt
GARAGIN (P)	30 15 10		above standpt	GARAGIN (P)	30 15 00		above standpt
CROCKER NAIL	64 58 00	2 649	below standpt	GI PIPE	32 38 30	4 598	above standpt
GI PIPE	181 36 40	2 753	below standpt	CONC PILLAR	244 58 30	2 651	above standpt
GI NAIL	309 57 40	10 192	below standpt	GI NAIL	298 00 40	11 564	below standpt

Prepared by: *G Ferr* Checked: *L. J. ...* Based on U.T.M. Grid

WARD 1 of 2 CARDS IS 7215

STATION: **WARIALDA (P)** No: **6550**

MAP SHEET SCALE 1:250 000

INSPECTED BY: **G FERR** DATE: **20-11-82**

AUTHORITY: **C.M.A.** FIELD BOOK: **1930**



Prepared by: *G Ferr* Checked: *L. J. ...* Based on U.T.M. Grid

SI 27433-2 D. West, Government Printer

STATION **WARIALDA (P) IS 7215**

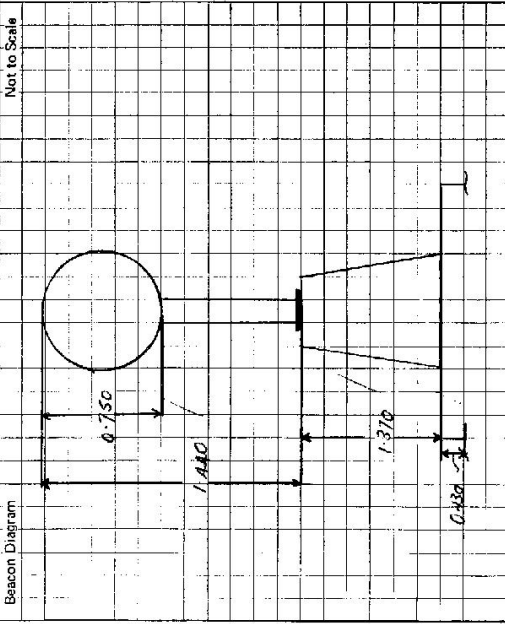

Owner's Name: **C.L. 96/19**
 Address:
 Phone:
20-11-1982
 Access Report of 26/11/1982 was found suitable/unsuitable.

Current Occupant: **L.A. & J.C. HUBBARD**
 Address: **TASMAN, WARIALDA**
 Phone: **WARIALDA 202 81 211**

- ACCESS**
- 0-00 WARIALDA P.C. HEND WEST THEN TURN RIGHT AND NORTH TOWARDS YETMAN
 - 5-5 KEEP RIGHT
 - 5-75 TURN RIGHT TO GATE SOUTH OF YARDS
 - 5-8 THROUGH GATE FOLLOW TRACK
 - 6-4 TOP OF HILL WARIALDA C.S. x RARE TOWER!

This section to be completed by officer constructing pillar.

Original station mark found/not found.
 Description of mark: **NEW STATION**
 Original beacon found/not found.
 Description of beacon:
 Height: Top of Vanes to Top Mark m.
 Height of mark: m. above rock/conc. m. below G.L.
 Diameter of Vanes m. Height of Cairn m.
 Original Beacon has/has not been destroyed by me.

Date	Record of Station

STATION: **WAKIALA** 19
 MAP SHEET SCALE 1:250 000
 INSPECTED BY: **G FORB**
 AUTHORITY: **C.M.A.**
 DATE: **20-11-82**
 FIELD BOOK: **1930**

CARD 2 of 2 CARDS
 No. **7215**

GEODETTIC STATION RECONNAISSANCE and MAINTENANCE REPORT

1. Cleared by lanes bearing..... from Trig. Mast
 Note: Cross out word or words which do not apply
2. Mast & Vanes have been painted white & black respectively.
3. The station/pillar was unpiled/not unpiled/constructed on..... 19....., dimensions now being:
 Description of mark..... should be explicit, e.g., S/Steel Pillar Plate, Steel plug, Brass plug, Bolt, G.I. Pipe
 Height of mark.....m. ^{above} rock/concrete; Mark is.....m. ^{above} _{below} G.L.
 Height of Top Vanes to Top Mark/Pillar plate.....m. Diameter of Vanes (vertical).....m.
 Height of Cairn.....m. Diameter of Cairn.....m. Name Plate found/not found/placed.
 Length of Mast.....m. (approximate if not unpiled)
4. A..... set in conc/rock has been placed/found, bearing.....°M from Mast/Plug/Pillar
5. A..... set in conc/rock has been placed/found, bearing.....°M from Mast/Plug/Pillar
6. A..... set in conc/rock has been placed/found, bearing.....°M from Mast/Plug/Pillar
7. A..... set in conc/rock has been placed/found, bearing.....°M from Mast/Plug/Pillar
8. Action required:.....

STANDPOINT: G.I. NAIL (CAIRN TOWER) STANDPOINT:

Mark	Direction	Horiz. Distance	Height Difference	Mark	Direction	Horiz. Distance	Height Difference
BALFOUR'S PEAK (NW)	0 00 00		above standpt.				above standpt.
GARAGIN (E)	30 15 50		above standpt.				above standpt.
COPPER NAIL	117 58 30	11-365	below standpt.				below standpt.
CONC PILLAR	139 57 30	10-194	above standpt.				above standpt.
G.I. PIPE	140 14 30	12-095	below standpt.				below standpt.

Prepared by: *G. Forb*

Checked: *G. Forb* Noted on U.T.M. Card

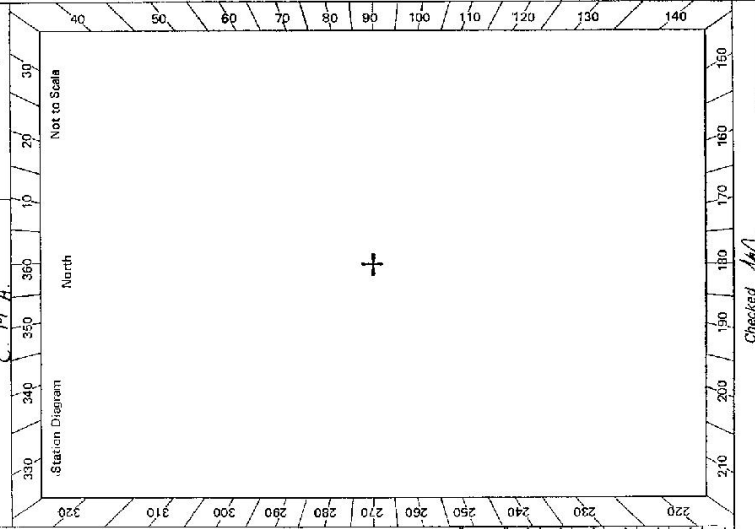

TS 7215

CENTRAL MAPPING AUTHORITY

GEODETIC SURVEY OF N.S.W.

GEODETIC STATION RECONNAISSANCE and MAINTENANCE REPORT

Description:

Note: Cross out word or words which do not apply

1. Cleared by lanes bearing..... from Trip. Mast
2. Mast & Vanes have been painted white & black respectively.
3. The station/pillar was unpiled/not unpiled/constructed on.....19....., dimensions now being:
Description of mark.....should be explicit, e.g., S/Steel Pillar Plate, Steel plug, Brass plug, Bolt, G.I. Pipe
Height of mark.....m. above below rock/concrete; Mark is.....m. above below G.L.
4. A.....set in conc/rock has been placed/found, bearing.....°M from Mast/Plug/Pillar
5. A.....set in conc/rock has been placed/found, bearing.....°M from Mast/Plug/Pillar
6. A.....set in conc/rock has been placed/found, bearing.....°M from Mast/Plug/Pillar
7. A.....set in conc/rock has been placed/found, bearing.....°M from Mast/Plug/Pillar
8. Action required:.....

STATION: **WARIALDA** No.: **6980**
 MAP SHEETS SCALE 1:250 000 **INVERELL** SCALE 1:100 000
 INSPECTED BY: **G. FORD** DATE: **6-5-85**
 AUTHORITY: **C.M.A.** FIELD BOOK: **C.378**

Station Diagram
 North
 320 310 300 290 280 270 260 250 240 230 220
 30 20 10 0 10 20 30
 Not to Scale

THIS PILLAR DESTROYED
6-5-85
+

270 260 250 240 230 220
 200 190 180 170 160 150 140
 Checked **GF 12/18/85**

Mark	Direction	Horiz. Distance	Height Difference	Mark	Direction	Horiz. Distance	Height Difference
CU NAIL		2.650 / 1.505 / below	above standpt.	CU NAIL		10.181 / 1.530 / below	above standpt.
GI PIPE		2.158 / 1.489 / below	above standpt.	GI NAIL		16.905 / 1.359 / below	above standpt.
NEW CONC PILLAR		8.637 / 0.024 / below	above standpt.	OLD CONC PILLAR		8.635 / 0.025 / below	above standpt.
GI NAIL		10.189 / 1.332 / below	above standpt.	GI PIPE		5.881 / 1.515 / below	above standpt.
			below				below
			above standpt.				above standpt.
			below				below
			above standpt.				above standpt.
			below				below

STANDPOINT: ORIGINAL OLD CONC PILLAR STANDPOINT: NEW CONC PILLAR

Prepared by: **J Ford 23/4/85** Checked: **T.....** Noted on U.T.M. Card

CENTRAL MAPPING AUTHORITY

GEODETIC SURVEY OF N.S.M.
 GEODETIC STATION RECONNAISSANCE and MAINTENANCE REPORT

Description:

1. Cleared by lanes bearing $40^{\circ} 72'$ $82^{\circ} 15'$ $158^{\circ} 27'$ $345^{\circ} 39'$ from Trig. Mast
 Note: *Cross out word or words which do not apply*

2. Mast & Vanes have been painted white & black respectively.

3. The station/pillar was ~~unplaced~~ ~~replaced~~ /constructed on $4-5-1985$, dimensions now being:

Description of mark ~~S/S MARK~~ ~~PLATE~~ should be explicit, e.g., S/Steel Pillar Plate, Steel Plug, Brass Plug, Bolt, G.I. Pipe

Height of mark 1.370 m. above ~~below~~ ~~reek~~/concrete; Mark is 470 m. above ~~below~~ G.L.

Height of Top Vanes to Top Mark/Pillar plate 1.435 m. Diameter of Vanes (vertical) 0.750 m.

Height of Cairn 0.000 m. Diameter of Cairn 0.000 m. Name Plate found/~~not found~~/placed.

Length of Mast 0.000 m. (approximate if not unplied)

4. ~~COPPER NAIL~~ set in conc/reck has been placed/found, bearing $74^{\circ} 0'$ from Mast/Plug/Pillar

5. ~~G.I. PIPE~~ set in conc/reck has been placed/found, bearing $61^{\circ} 0'$ from Mast/Plug/Pillar

6. ~~G.I. NAIL~~ set in conc/reck has been placed/found, bearing $32^{\circ} 0'$ from Mast/Plug/Pillar

7. ~~S/S PIN~~ set in conc/reck has been placed/found, bearing $61^{\circ} 0'$ from Mast/Plug/Pillar

8. Action required: ~~None~~

STANDPOINT: CONCRETE PILLAR				STANDPOINT: COPPER NAIL			
Mark	Direction	Horiz. Distance	Height Difference	Mark	Direction	Horiz. Distance	Height Difference
GRAGIN (P)	0 00 00		above standpt.	GRAGIN (P)	0 00 00		below standpt.
MONSOON (P)	132 23 40		above standpt.	MONSOON (P)	132 23 50		below standpt.
G.I. NAIL	308 37 00	16.905	above standpt.	CONC PILLAR	165 36 00	10.131	above standpt.
S/S PIN	331 40 40	66.5	above standpt.	G.I. PIPE	182 23 40	4.60	above standpt.
G.I. PIPE	332 31 40	5.88	above standpt.	S/S PIN	216 03 40	2.704	above standpt.
C.V. NAIL	345 30 00	10.131	above standpt.	G.I. NAIL	267 44 40	11.568	below standpt.

Prepared by: *J. Bond 22/5/85*

Checked: *J. Bond 22/5/85*

Noted on U.T.M. Card

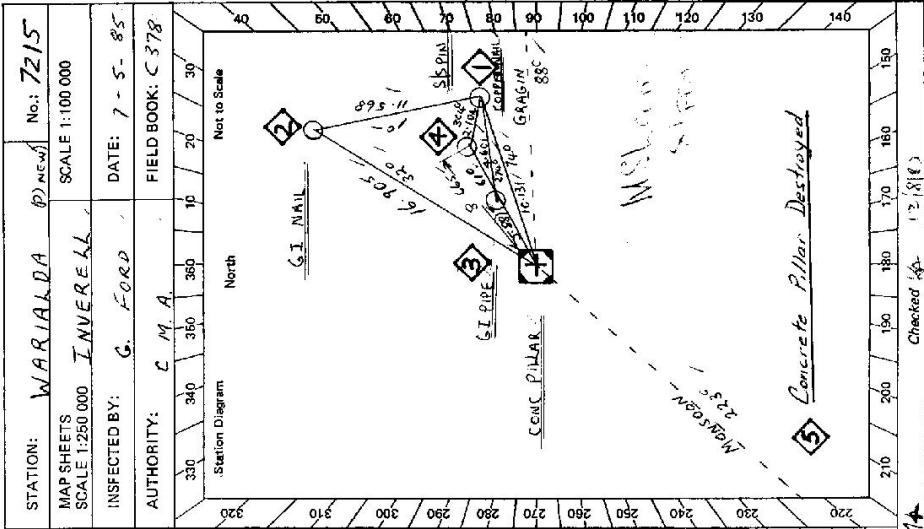

Checked by: *J. Bond 22/5/85*

STATION: *WARIALDA (D) NEW* No.: *7215*

MAP SHEETS SCALE 1:250 000 *INVERELL* SCALE 1:100 000

INSPECTED BY: *G. FORD* DATE: *7-5-85*

AUTHORITY: *C.M.A.* FIELD BOOK: *C 378*

STATION WARIALDA (B) TS 7215

Owner's Name: LA J.C. HUBBARD ✓
 Address: TARANA
 Phone: WARIALDA 349 88 2111
 Current Occupant:
 Address:
 Phone:

ACCESS
 Access Report of 15/10/85 was found suitable/unsuitable.

0 00 WARIALDA P.C. HEAD WEST THEN TURN RIGHT TOWARDS VETMAN
5 5 KEEP RIGHT
5 75 TURN RIGHT TO IRON GATE NEAR CATTLE YARDS
5 8 THROUGH GATE FOLLOW TRACK
6 4 WARIALDA GS x RADIO TOWER.

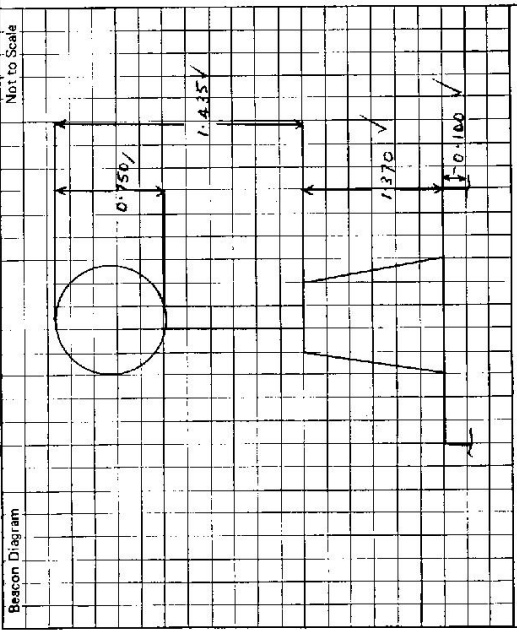

This section to be completed by officer constructing pillar.

Original station mark found/~~not found~~.
 Description of mark: S.E.N.S. Pillar (N.E.W. Pillars, Pillars)
 Original beacon found/~~not found~~.
 Description of beacon: CONC. PILLAR (MAST x V.A.N.E.S.)
 Height Top of Vanes to Top Mark: 1.425 m.
 Height of mark: 3.70 m. above G.L. below
 Diameter of Vanes: 0.75 m. Height of Cairn: --- m.
 Original Beacon has/~~has not been~~ destroyed by me.

Date	Record of Station