

CENTRAL MAPPING AUTHORITY

GEODETTIC SURVEY OF N.S.W.

GEODETTIC STATION RECONNAISSANCE AND MAINTENANCE REPORT

Description:

1. Cleared by lanes bearing: 260 BYELEG TREES AT ST-19-165 MAG from Trig. Mast

2. Mast & Vanes have been painted white & black respectively.

3. The station/pillar was re-erected/constructed on 27th MAR 1985, dimensions now being:

Description of mark: S/S Pillar Plate, Steel plug, Brass plug, Bolt, G.I. Pipe

Height of mark: 1.385 m. above rock/concrete; Mark is 1.505 m. above G.L.

Height of Top Vanes to Top Mast/Pillar plate 1.405 m. Diameter of Vanes (vertical) 0.750 m.

Height of Cairn Nil m. Diameter of Cairn Nil m. Name Plate found/not found/placed.

Length of Mast Nil m. (approximate if not unspiled)

4. BRASS PLUG set in conc/rock has been placed/found, bearing 178 °M from Mast/Plug/Pillar

5. COPPER NAIL set in conc/rock has been placed/found, bearing 179 °M from Mast/Plug/Pillar

6. Nil set in conc/rock has been placed/found, bearing Nil °M from Mast/Plug/Pillar

7. Nil set in conc/rock has been placed/found, bearing Nil °M from Mast/Plug/Pillar

8. Action required: Nil

STANDPOINT: S/S PILLAR PLATE STANDPOINT: BRASS PLUG

Mark	Direction	Horiz. Distance	Height Difference	Mark	Direction	Horiz. Distance	Height Difference
NIMBY GS(P)	0 00 00		above standpt.	NIMBY GS(P)	0 00 00		above standpt.
BOBBARA GS(P)	210 16 25		above standpt.	S/S PILLAR PLATE	108 19 20	4.638	above standpt.
BRASS PLUG	288 21 25	4.635	above standpt.	BOBBARA GS(P)	210 14 20		above standpt.
COPPER NAIL	289 24 30	4.64	above standpt.	COPPER NAIL	190 24 25	4.831	above standpt.
			below				below
			above standpt.				above standpt.
			below				below
			above standpt.				above standpt.
			below				below

Prepared by: [Signature] Checked: Peric 24.11.85 Noted on U.T.M. Card 40

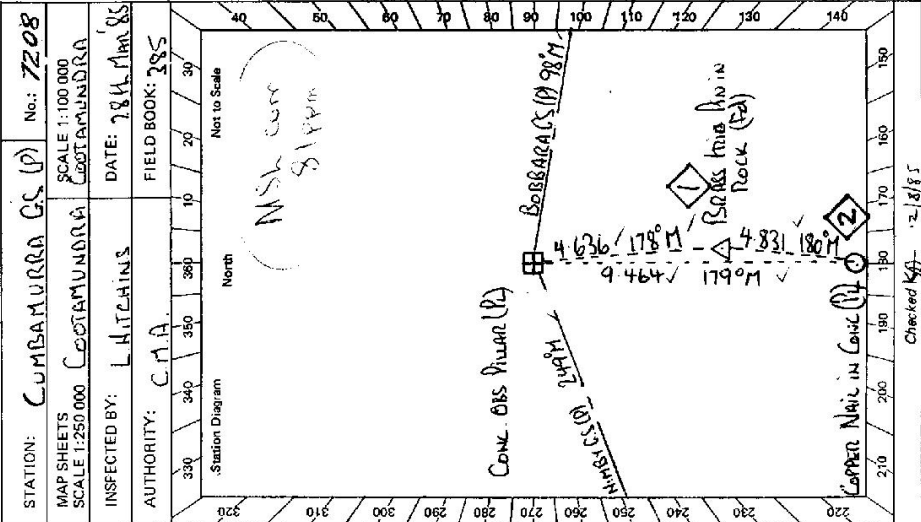

Checked: KA 21/8/85

STATION **COMBAMURRA GS (P) TS 7208**

Owner's Name: **NEVILLE J ALCOCK**
 Address: **"LANDEN VIEW" CUNNINGHAM (HARDEN)**
 Phone: **063-862157**

Current Occupant:
 Address:
 Phone:

ACCESS
A.B. for Access 2057 (S. JUDGE)

Access Report of 28/3/1986 was found suitable/unsuitable.

0-00 HARDEN PD HEAD EAST ALONG NEILL ST.
 0-11 TURN RIGHT
 0-24 TURN LEFT INTO ALBURY ST.
 4-75 PASS BOOROWA ROAD ON LEFT
 7-05 TURN RIGHT ONTO MC MAHONS REEF ROAD
 8-77 TURN RIGHT THROUGH IRON GATE THEN VEER LEFT
 9-01 COMBAMURRA G.S.G.P.
 IF PADDOCK IS UNDER GOOD FOLLOW ROAD TO
 CREST AND WALK TO TRIG.

OWNERS: AT 7-05 CONTINUE CLIMB AHEAD.
 7-33 TURN LEFT OVER CINDO
 7-60 OWNERS HOUSE.

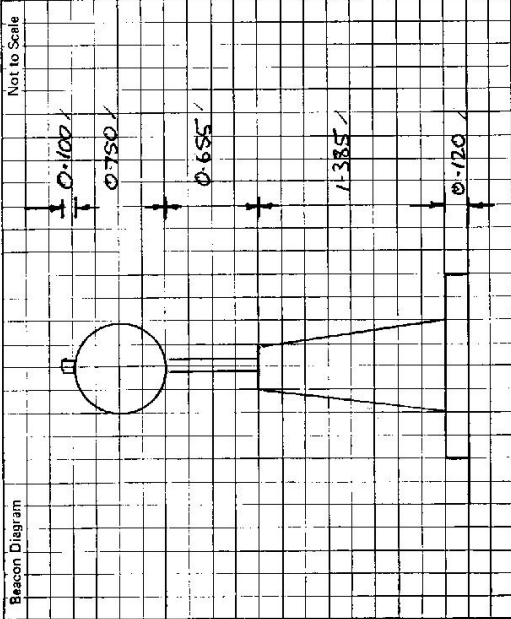

This section to be completed by officer constructing pillar.

Original station mark found/~~not found~~.

Description of mark: **ROCK PILE IN Paddock**

Original beacon found/~~not found~~.

Description of beacon: **CAIRN POLE + DISC**

Height Top of Varies to Top Mark **3.778** m.

Height of mark **0.022** above rock/stone **AT** m. above G.L. below

Diameter of Varies **0.770** m. Height of Cairn **1.320** m.

Original Beacon has ~~been~~ been destroyed by me.

Date	Record of Station