

CENTRAL MAPPING AUTHORITY

GEODETTIC SURVEY OF N.S.W.

GEODETTIC STATION RECONNAISSANCE and MAINTENANCE REPORT

Description:

1. Cleared by lanes bearing $10^{\circ} 19' M$, $105^{\circ} 10' S$, $112^{\circ} M$, $129^{\circ} 55' W$, $123^{\circ} 15' W$, $123^{\circ} 15' W$ from Trig. Mast $217^{\circ} - 223^{\circ} M$, $239^{\circ} - 242^{\circ} M$, $270^{\circ} - 273^{\circ} W$, $277^{\circ} - 306^{\circ} W$, $320^{\circ} - 346^{\circ} W$.
Note: Cross out words or figures which do not apply
2. Mast & Vanes have been painted white & black respectively. ✓
3. The ~~station~~ pillar was ~~used~~ constructed on 1.2 m. 1984 , dimensions now being:
Description of mark: ~~Steel~~ Steel Pillar Plate. ~~Steel~~ Steel plug, Bolt, G.I. Pipe
Height of mark 3.15 m. above ~~rock~~ rock/concrete; Mark is 1.5 m. above G.L.
Height of Top Vanes to Top ~~Mast~~ Mast /Pillar plate 4.45 m. Diameter of Vanes (vertical) 150 m.
Height of Cairn $.....$ m. Diameter of Cairn $.....$ m. Name Plate ~~found~~ /not found/placed.
Length of Mast 5.45 m. (~~approximate if not specified~~)
4. A. ~~Concrete~~ Concrete ~~Nail~~ set in conc/rock has been placed/~~found~~, bearing $115^{\circ} M$ from ~~Mast/Plug~~ Plug /Pillar
5. A. G.I. Pipe set in conc/rock has been placed/~~found~~, bearing $288^{\circ} M$ from ~~Mast/Plug~~ Plug /Pillar
6. A. ~~.....~~ set in conc/rock has been placed/~~found~~, bearing $.....^{\circ} M$ from Mast/Plug /Pillar
7. A. ~~.....~~ set in conc/rock has been placed/~~found~~, bearing $.....^{\circ} M$ from Mast/Plug /Pillar
8. Action required: ~~.....~~

STANDPOINT: Concrete Pillar			STANDPOINT: Copper Nail			
Mark	Direction	Horiz. Distance	Height Difference	Direction	Horiz. Distance	Height Difference
NAUMEA (P)	$0^{\circ} 00' 00''$		above standpt.	$0^{\circ} 00' 00''$		above standpt.
G.I. PIPE	$105^{\circ} 06' 57''$	3.54	below standpt.	$133^{\circ} 59' 13''$	5.42	below standpt.
MALROY G.S.	$190^{\circ} 12' 08''$		above standpt.	$170^{\circ} 30' 27''$	2.87	above standpt.
DINGGA G.S.	$287^{\circ} 43' 25''$		above standpt.	$190^{\circ} 11' 55''$		above standpt.
MALINTIRE (P)	$313^{\circ} 58' 18''$		below standpt.	$287^{\circ} 42' 34''$		below standpt.
COPPER NAIL	$350^{\circ} 29' 51''$	2.872	below standpt.	NO VISION STOPED!		below standpt.

Prepared by: D. J. KAIN Checked: AS 29/1/85 Noted on U.T.M. Card 198

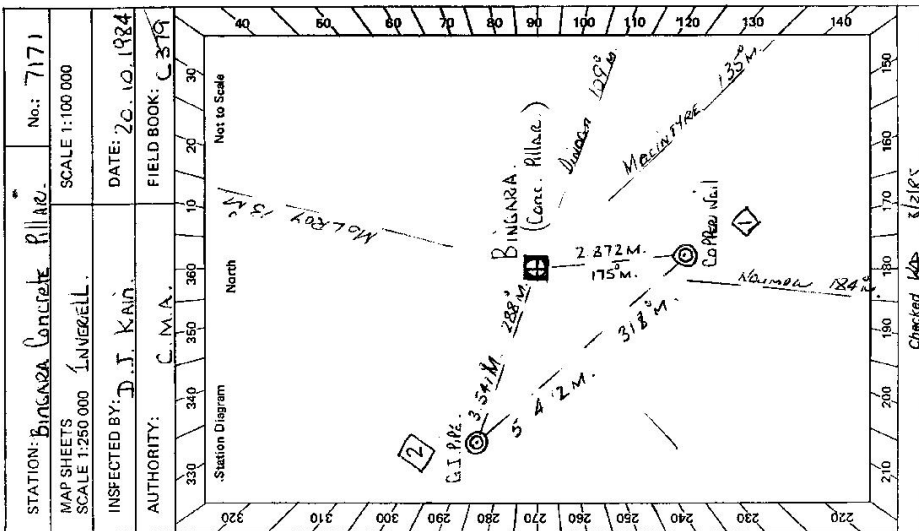

Checked HP 8/2/85

6: 2733-2 D. West, Government Printer

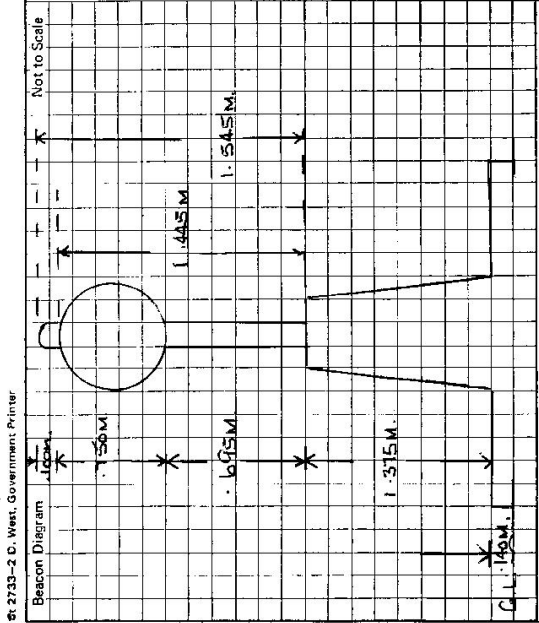

This section to be completed by officer constructing pillar.

Original station mark found/not found.

Description of mark: NEW

Original beacon found/not found.

Description of beacon: NEW

Height Top of Vanes to Top Mark NO m.

Height of mark NO m. above below G.L.

Diameter of Vanes NO m.

Original Beacon has/has not been destroyed by me.

FREE HOLD LAND MR. CAROL CLASER.
Owner's Name: MR. CAROL CLASER.
Address: AMAROO PARK.
ANIMATING ROAD, ANIMATING ROVER.
Phone: (02) 679 1251

STATION BINGARA Concrete Pillar 7171

Contact Manager MR. JOHN EDWARDS
Address: 78 Cunningham Street,
Phone: (067) 241 0357
"ZABA" (067) 241 376

ACCESS "ZABA" (067) 241 376

Access Report of 10/10/1984 was found suitable/unsuitable.

KLMS.

- 0.00 AT BINGARA POST OFFICE TRAVEL TOWARD BARRABA.
- 0.18 TURN RIGHT TO "NORABRI" (CUNNINGHAM STREET.)
- 8.76 PASS SAFETY RAMP ON L.H.S. "ZABA"
- 10.43 TURN LEFT THROUGH IRON GATE "Z"
- 10.65 THROUGH IRON GATE "Z"
- 11.03 PASS TRACK ON R.H.S.
- 11.38 TAKE TRACK ON REAR OF HOMESTEAD. (CALL IN)
- 11.51 PASS TRACK ON R.H.S AND PASS MACHINERY SHED ON R.H.S.
- 11.75 THROUGH DOUBLE IRON GATES.
- 12.12 THROUGH DOUBLE IRON GATES.
- 13.22 THROUGH DOUBLE IRON GATES.
- 14.10 THROUGH DOUBLE IRON GATES.
- 14.58 THROUGH DOUBLE IRON GATES.
- 15.27 TRACK GOES AROUND DAM AND BANK.
- 15.77 THROUGH DOUBLE IRON GATES, TURN LEFT AND FOLLOW
- 16.58 THROUGH DOUBLE IRON GATES, TRACK ALONG FENCE.

17.91 THROUGH IRON GATE AT FENCE CORNER THEN TRACK (CROSSES OLD FENCE.)

18.86 BINGARA Concrete Pillar.

{ 17.91 TO 18.86 KLMS. VARIABLE TRACK ROUGHLY FOLLOWS TO EAST OF OLD FENCE BEFORE MOVING INTO LONG GRASS AT TOP OF HILL.

Date

Record of Station

Batch Id: 1569

LAND INFORMATION CENTRE

GEODETIC SURVEY OF A.S.W.

GEODETIC STATION RECONNAISSANCE and MAINTENANCE REPORT

STATION: **BINGARA (Pillar)** No.: **7171**

MAP SHEET
SCALE 1:250 000

INSPECTED BY: **D. J. Kain**

DATE: **19.3.1991**

AUTHORITY: **L.I.C.**
FIELD BOOK: **NIL**

Description: *Note: Cross out word or words which do not apply*

1. Cleared by Janes bearing..... **Station was cleared for G.P.S. from Trig. Mast**
2. Mast & Vanes have been painted white & black respectively.
3. The station/pillar was unpiled/not unpiled/constructed on..... **19.....**, dimensions now being:
 - Description of mark..... should be explicit, e.g., S/Steel Pillar Plate, Steel plug, Brass plug, Bolt, G.I. Pipe
 - Height of mark.....m. ^{above} rock/concrete; Mark is.....m. ^{above} G.L.
 - Height of Top Vanes to Top Mark/Pillar platem. Diameter of Vanes (vertical).....m.
 - Height of Cairn.....m. Diameter of Cairn.....m. Name Plate found/not found/placed.
 - Length of Mastm. (approximate if not unpiled)
4. A.....set in conc/rock has been placed/found, bearing.....°M from Mast/Plug/Pillar
5. A.....set in conc/rock has been placed/found, bearing.....°M from Mast/Plug/Pillar
6. A.....set in conc/rock has been placed/found, bearing.....°M from Mast/Plug/Pillar
7. A.....set in conc/rock has been placed/found, bearing.....°M from Mast/Plug/Pillar
8. Action required:.....

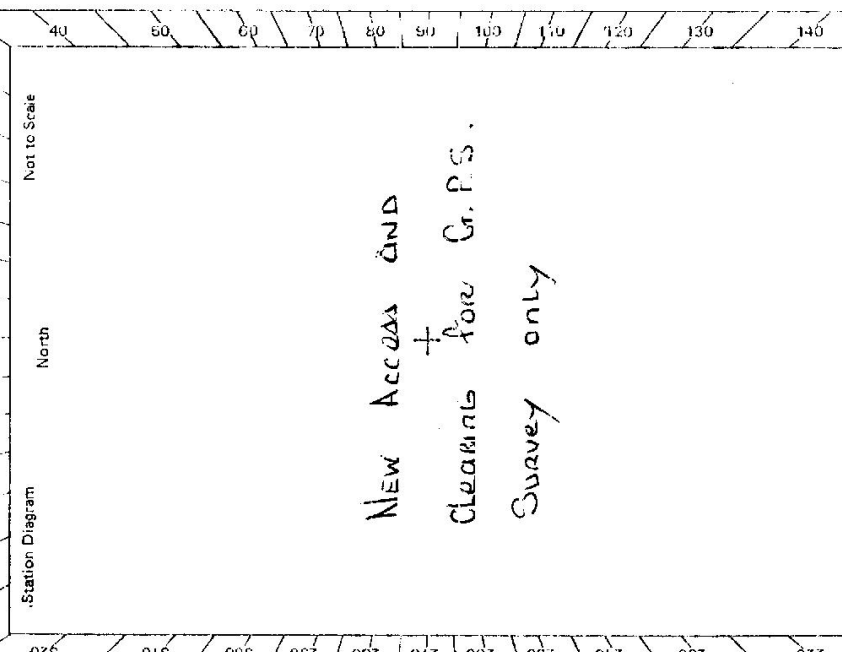

STANDPOINT:			
Mark	Direction	Horiz. Distance	Height Difference
			above standpt.
			below
			above standpt.
			below
			above standpt.
			below
			above standpt.
			below
			above standpt.
			below
			above standpt.
			below
			above standpt.
			below
			above standpt.
			below

Prepared by: **D. Kain** Checked: **Noted on U.T.M. Card**

