

SI 2733-2 D. West, Government Printer

Beacon Diagram

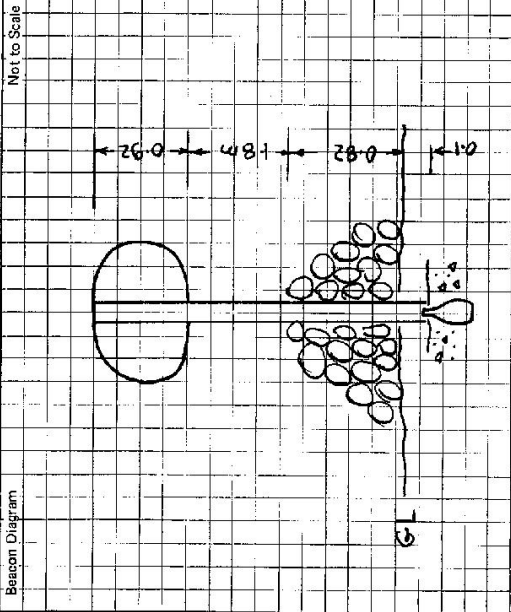

Not to Scale

STATION FLETCHER TS. 7169

Owner's Name: Mr. Fletcher
 Address:
 Phone:

Current Occupant: Mr. Ndongme
 Address:
 Phone:
 (access over this property the thing on Fletcher)

ACCESS
 Access Report of 14/3/1982 was found suitable/unsuitable.
 * No previous access

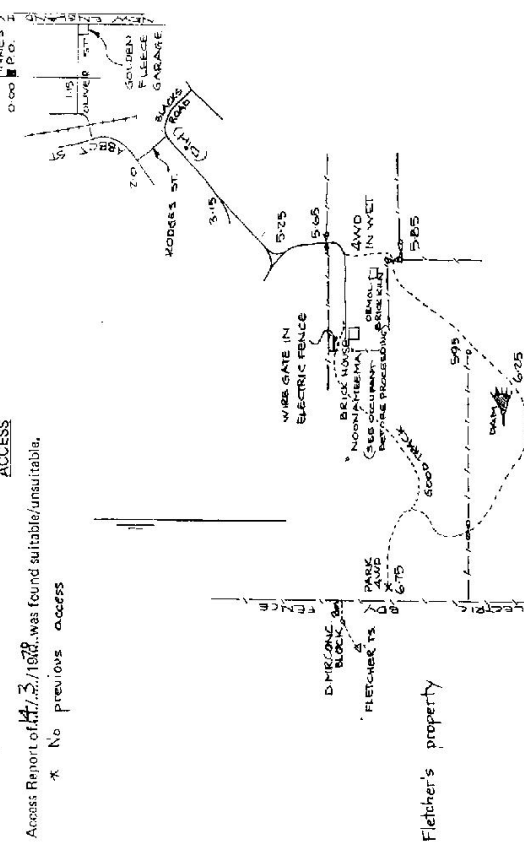

Date	Record of Station

This section to be completed by officer constructing pillar.

Original station mark found/not found.

Description of mark:

Original beacon found/not found.

Description of beacon:

Height Top of Vanes to Top Mark:m.

Height of mark:m. above GL
 below

Diameter of Vanesm. Height of Cairnm.

Original Beacon has/has not been destroyed by me.

CENTRAL MAPPING AUTHORITY

GEODETIC SURVEY OF M.S.W.

GEODETIC STATION RECONNAISSANCE and MAINTENANCE REPORT

Description:

1. Cleared by lanes bearing.....
 Note: Cross out word or words which do not apply
 from Trig. Mast

2. Mast & Vanes have been painted white & black respectively.

3. The station/~~pillar~~ was unpiled/~~not unpiled~~/constructed on ~~19.78~~ ^{19.78} m, dimensions now being:

Description of mark.....should be explicit. e.g., S/Steel Pillar Plate, Steel plug, Brass plug, Bolt, G.I. Pipe

Height of mark.....m. above/below rock/concrete; Mark is.....m. above/below G.L.

Height of Top Vanes to Top Mark/Pillar platem. Diameter of Vanes (vertical).....m.

Height of Cairn.....m. Diameter of Cairn.....m. Name Plate found/not found/placed.

Length of Mast.....m. (approximate if not unpiled)

4. A.....set in conc/rock/~~has been placed~~/found, bearing.....° M from Mast/Plug/Pillar

5. A.....set in conc/rock has been placed/found, bearing.....° M from Mast/Plug/Pillar

6. A.....set in conc/rock has been placed/found, bearing.....° M from Mast/Plug/Pillar

7. A.....set in conc/rock has been placed/found, bearing.....° M from Mast/Plug/Pillar

8. Action required:.....
 (e.g., New. Alter. Clearing. etc.)

STANDPOINT: *Bottle in ground pit*

Mark	Direction	Horiz. Distance	Height Difference	Mark	Direction	Horiz. Distance	Height Difference
<i>S.S.77 in conc</i>	<i>40° M</i>	<i>2.51</i>	above standpt. below				above standpt. below
			above standpt. below				above standpt. below
			above standpt. below				above standpt. below
			above standpt. below				above standpt. below
			above standpt. below				above standpt. below
			above standpt. below				above standpt. below
			above standpt. below				above standpt. below

Prepared by: *J. Fanning 1/7/11* Checked: *H. P. ... 2/1/11* *Not on U.T.M. Card*

SI 2738-1

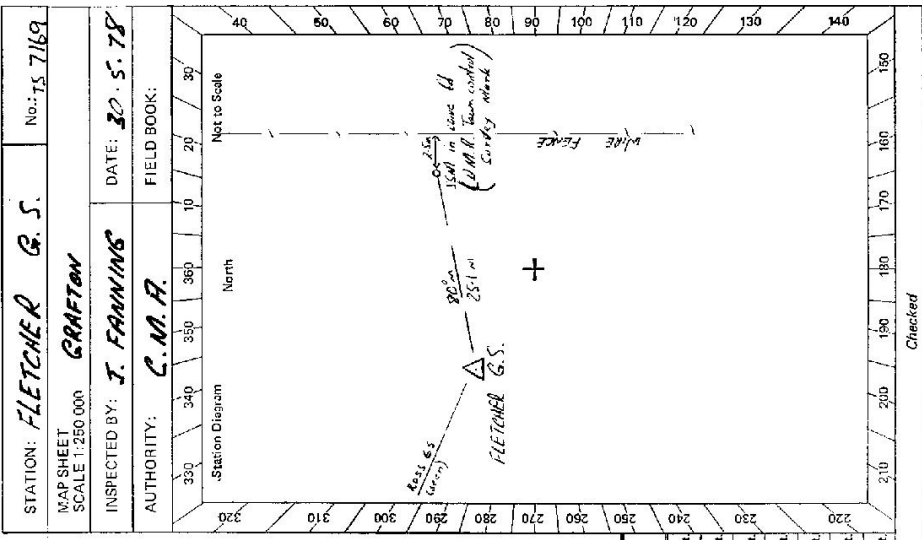

CENTRAL MAPPING AUTHORITY

GEODETIC SURVEY OF N.S.W.

GEODETIC STATION RECONNAISSANCE and MAINTENANCE REPORT

Description:

1. Cleared by lanes bearing..... Note: Cross out word or words which do not apply from Trig. Mast

2. Mast & Vanes have been painted white & black respectively.

3. The station/pillar was unpainted/not unpainted/constructed on..... 19....., dimensions now being:

Description of mark..... could be explicit, e.g., S/Steel Bolt/Plate, Steel plug, Brass plug, Bolt, G.I. Pipe

Height of mark..... m. above below rock/concrete; Mark is..... above below G.L.

Height of Top Vanes to Top Mark/Pillar plate..... m. ~~ON-1~~ Diameter of Vane (vertical)..... m.

Height of Cairn..... m. Diameter of ~~Cap~~ ~~Plate~~ ~~not found/placed~~.

Length of Mast..... m. (approximate not unplied)

4. A..... set in conc/rock has been placed/found, bearing..... ° M from Mast/Plug/Pillar

5. A..... set in conc/rock has been placed/found, bearing..... ° M from Mast/Plug/Pillar

6. A..... set in conc/rock has been placed/found, bearing..... ° M from Mast/Plug/Pillar

7. A..... set in conc/rock has been placed/found, bearing..... ° M from Mast/Plug/Pillar

8. Action required..... See 55/11/1045

STANDPOINT:

Mark	Direction	Horiz. Distance	Height Difference	Mark	Direction	Horiz. Distance	Height Difference
			above standpt				above standpt
			below				below
			above standpt				above standpt
			below				below
			above standpt				above standpt
			below				below
			above standpt				above standpt
			below				below
			above standpt				above standpt
			below				below
			above standpt				above standpt
			below				below

Prepared by: *GLF*

Checked:

Noted on U.T.M. Card *MC 55/11/1045*

Ss 2734-1

STATION: *FLETCHER*
 MAP SHEET
 SCALE: 1:250 000
 INSPECTED BY: *A. GARSIDE*
 AUTHORITY: *CMA*
 DATE: *3.9.82*
 FIELD BOOK: *2011*

IS: 7169
 No.: *2077*

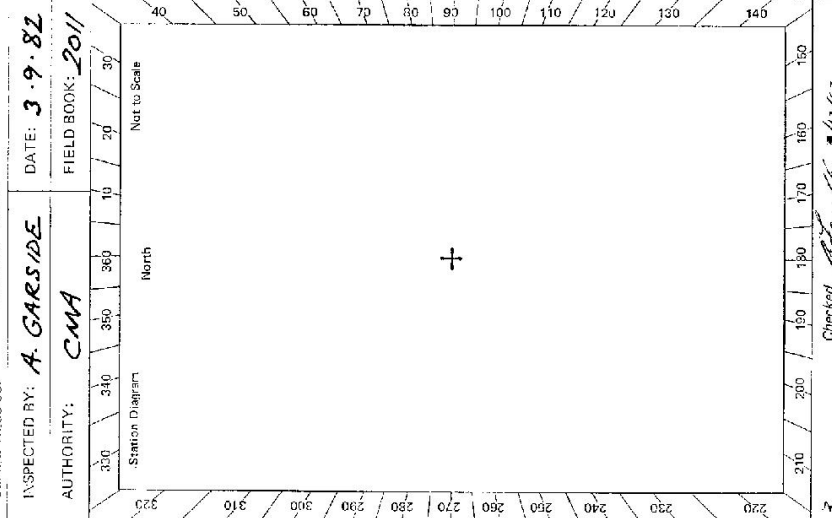

Checked: *[Signature]*

Sr 2703-2 D. West, Government Printer

STATION **FLETCHER** IS **7169**

Owner's Name: **Mr J S (Barbara) FLETCHER** Current Occupant:
 Address: **Glenroy** Address:
Furacabod Rd Glen Innes. Phone:
 Phone: **057 322638** Phone: **057 1982**

Access Report of road found suitable for construction

- 0.0 Glen Innes RD heading south in Grey St.
- 1.1 Turn right into Oliver St.
- 1.6 Turn left.
- 1.7 Cross railway line then left into Abbot St.
- 2.3 Turn left towards tip.
- 2.9 Pass tip on left.
- 3.5 Pass & road on right.
- 5.15 Take left fork. Track straight ahead leads to possible "drive to" access. See Mr Fletcher for key.
- 5.45 Take track to right.
- 5.7 Iron gate
- 5.8 House on left. Veer right towards fence corner.
- 5.85 Wire gate on left.
- 6.1 Turn right off track and head up to fence.
- 6.2 Fence.

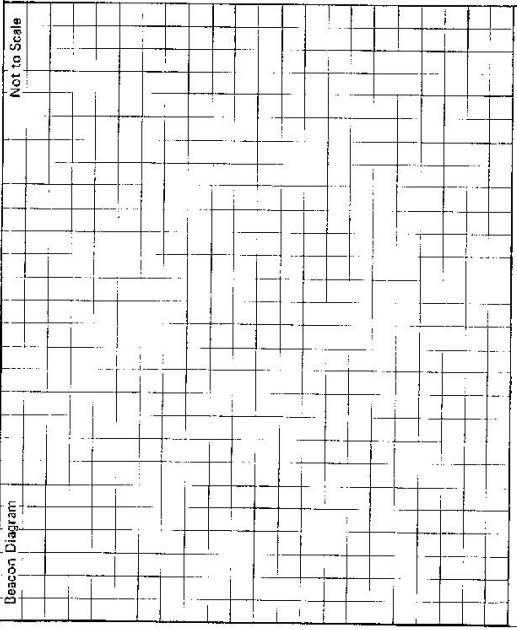

This section to be completed by officer constructing pillar.

Original station mark found/not found.

Description of mark:

Original beacon found/not found.

Description of beacon:

Height Top of Vanes to Top Markm.

Height of markm above G.L. below G.L.

Diameter of Vanem. Height of Cairnm.

Original beacon has/has not been destroyed by me.

Date	Record of Station

Dr 2732-2 D. West, Government Printer

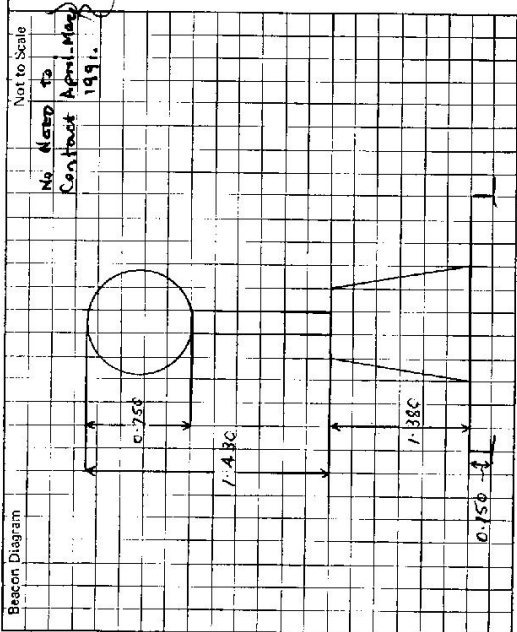

This section to be completed by officer constructing pillar.

Original station mark found/~~not found~~.
 Description of mark: BOTTLE IN CON. ✓
 Original beacon found/~~not found~~.
 Description of beacon: CAIRN POLE & DISC ✓
 Height Top of Vanes to Top Mark 3.600 m. ✓
 Height of mark 0.430 m. above below rock/conc. ✓
 Diameter of Vanes 0.430 m. ✓ Height of Cairn 0.900 m.
 Original Beacon has/~~has not~~ been destroyed by me.

STATION FLETCHER (P) TS7169

Owner's Name: MR. I. G. FLETCHER
 EAST SIDE OF FENCE
 Current Occupant: MR. BRUCE DUNCAN

Address: GLENROY
4, BARRACARRA RD. GLEN INNES

Phone: 067 323638
067 321379

ACCESS

Access Report of 17/10/1988 was found suitable/unsuitable.

0.00 GLEN INNES R.O. HEAD SOUTH ALONG GREY ST.
 0.70 TURN RIGHT INTO LANG ST.
 1.53 CROSS RAILWAY BRIDGE
 1.62 TURN LEFT INTO ABOOTT ST.
 2.74 TURN LEFT SIGN RUBBISH TIP
 3.36 PASS GARBAGE TIP ENTRANCE ON LEFT
 4.10 END OF BITUMEN
 5.57 HEAD STRAIGHT AHEAD THROUGH WIRE GATE
 6.00 IRON GATE C.M.A. LOCK
 6.18 IRON GATE TAKE LEFT FURK OR FAINT TRACK
 6.47 AND HEAD TOWARDS L.H.S OF SHEEP YARDS
 6.79 THEN UP TO SADDLE AND LEFT TO TRIG
FLETCHER GEODETIC STATION

Date: 28.2.91
 Record of Station
Re: existing trees at station older was not approached as
existing trees are permanent shade trees. P.K.

Time: Glen Innes to A 45 minutes.