

TS-7158
No: 2921

CENTRAL MAPPING AUTHORITY
GEODETTIC SURVEY OF N.S.W.
GEODETTIC STATION RECONNAISSANCE and MAINTENANCE REPORT

STATION: MACINTYRE
MAP SHEET SCALE 1:250 000
INSPECTED BY: G. KEEP
AUTHORITY: C.M.A.
DATE: 12/3/81
FIELD BOOK:

MANILLA
G. KEEP
C.M.A.
Not to Scale

Station Diagram

North

320 310 300 290 280 270 260 250 240 230 220 210 200 190 180 170 160 150 140

330 340 350 360 370 380 390 400

30 20 10 0 10 20 30 40

+

Description:

1. Cleared by lanes bearing..... Note: Cross out word or words which do not apply

2. Mast & Vanes have been painted white & black respectively.

3. The station/pillar was unpiled/not unpiled/constructed on..... 19....., dimensions now being:

Description of mark..... should be explicit, e.g., S/Steel Pillar Plate, Steel plug, Brass plug, Bolt, G.I. Pipe

Height of mark.....m. above below rock/concrete; Mark is.....m. above below G.L.

Height of Top Vanes to Top Mark/Pillar plate.....m. Diameter of Vanes (vertical).....m.

Height of Cairn.....m. Diameter of Cairn.....m. Name Plate found/not found/placed.

Length of Mast.....m. (approximate if not unpiled)

4. A..... S.S.M..... set in conc/rock has been placed/found, bearing..... 127.....° M from Mast/Plug/Pillar @ 2.7 m. to

5. A..... set in conc/rock has been placed/found, bearing.....° M from Mast/Plug/Pillar

6. A..... set in conc/rock has been placed/found, bearing.....° M from Mast/Plug/Pillar

7. A..... set in conc/rock has been placed/found, bearing.....° M from Mast/Plug/Pillar

8. Action required:..... Minimal clearing necessary, needs painting black & white, cairn needs restacking.....

STANDPOINT:

Mark	Direction	Horiz. Distance	Height Difference	Mark	Direction	Horiz. Distance	Height Difference
			above standpt				above standpt
			below				below
			above standpt				above standpt
			below				below
			above standpt				above standpt
			below				below
			above standpt				above standpt
			below				below
			above standpt				above standpt
			below				below
			above standpt				above standpt
			below				below
			above standpt				above standpt
			below				below

Prepared by: G. Keep
Checked: 18/3/81 144
Noted on U.T.M. Card

S: 2733-1

S: 2733-2 D. West, Government Printer

STATION		MACINTYRE		TS-7158	
Beacon Diagram		<p>Owner's Name: Address: Phone: Current Occupant: Address: Phone:</p> <p>ACCESS Access Report of 12.2.1981 was found suitable/unsuitable.</p> <p>Mast and vanes in good condition (mast leaning to one side) Cairn needs restacking. 10 min walk from vehicle unladen. Reference map Upper Bingara 1:25000</p>			
		<p>This section to be completed by officer constructing pillar.</p> <p>Original station mark found/not found.</p> <p>Description of mark:</p> <p>Original beacon found/not found.</p> <p>Description of beacon:</p> <p>Height Top of Vanes to Top Mark:m.</p> <p>Height of mark:m. above G.L. below G.L.</p> <p>Diameter of Vanes:m. Height of Cairn:m.</p> <p>Original Beacon has/has not been destroyed by me.</p>			
		<p>Date</p> <p>Record of Station</p>			

CENTRAL MAPPING AUTHORITY

GEODETIC SURVEY OF M.S.W.

GEODETIC STATION RECONNAISSANCE and MAINTENANCE REPORT

Description:

1. Cleared by lanes bearing $10^{\circ} 17' 0'' + 180^{\circ} 340''$ ~~0 has been~~ *by accident* from Trig. Mast *replaced*.
2. Mast & Vanes have been painted white & black respectively.
3. The station/pillar was unpiled/not unpiled/constructed on $6-7-82$ dimensions now being:

Description of mark.....should be explicit, e.g., S/Steel Pillar Plate, Steel plug, Brass plug, Bolt, G.I. Pipe

Height of mark.....m. above rock/concrete; Mark is.....m. above G.L.

Height of Top Vanes to Top Mark/Pillar plate.....m. Diameter of Vanes (vertical).....10.....m.

Height of Cairn.....m. Diameter of Cairn.....m. Name Plate found/not found/placed.

Length of Mast.....m. (approximate if not unpiled)

4. A.....SSM.....set in conc/rock has been placed/found, bearing.....°M from Mast/Plug/Pillar

5. A.....set in conc/rock has been placed/found, bearing.....°M from Mast/Plug/Pillar

6. A.....set in conc/rock has been placed/found, bearing.....°M from Mast/Plug/Pillar

7. A.....set in conc/rock has been placed/found, bearing.....°M from Mast/Plug/Pillar

8. Action required: *Construct new pillar and clear 10°-170° + 180° 340°*
number as 8-10m + 10-15m etc except for 2-3m poles at 40° + 45°

STANDPOINT:

STANDPOINT:

Mark	Direction	Horiz. Distance	Height Difference	Mark	Direction	Horiz. Distance	Height Difference
			above standpt.				above standpt.
			below standpt.				below standpt.
			above standpt.				above standpt.
			below standpt.				below standpt.
			above standpt.				above standpt.
			below standpt.				below standpt.
			above standpt.				above standpt.
			below standpt.				below standpt.
			above standpt.				above standpt.
			below standpt.				below standpt.
			above standpt.				above standpt.
			below standpt.				below standpt.

Prepared by:

22/4/92

Checked:

Noted on U.T.M. Card

St 2733-1

IS-7158

STATION: MACINTYRE

MAP SHEET

SCALE 1:250 000

MAINTILLA

INSPECTED BY: P. GARSIDE

DATE: 6-7-82

AUTHORITY: CMA

FIELD BOOK: 2007

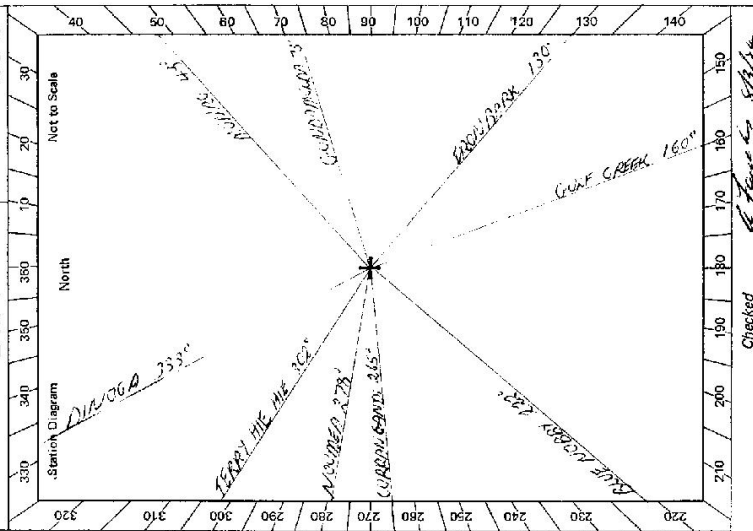

Checked

22/4/92

St 2738 - 2 D. West, Government Printer

STATION		MACINTYRE TS 7158	
Owner's Name: <u>D. & D. M'NURTRE</u>	Current Occupant:	<p>Address: <u>VARANANARIE</u></p> <p>Phone: <u>COBARRAH 130</u></p> <p>Phone: <u>6-7-82</u></p> <p>ACCESS <u>6-7-82</u></p> <p>Access Report of <u>19</u> was found suitable/unsuitable.</p> <p><u>Feature</u></p> <p><u>0.0</u> <u>ANGARA - BARBARA RD. ANGARA 34 BARBARA 27</u></p> <p><u>0.45</u> <u>TAKE ROAD EAST TO UPPER ANGARA 15</u></p> <p><u>1.15</u> <u>GRID + GATE</u></p> <p><u>5.15</u> <u>2.9 + 4.2. GRID + GATE</u></p> <p><u>5.4</u> <u>PASS YAKKAW ON RIGHT</u></p> <p><u>6.05</u> <u>GRID AND GATE</u></p> <p><u>7.15</u> <u>CAUSEWAY</u></p> <p><u>7.2</u> <u>GRID + GATE TAKE TRACK TO VARRANANARIE ON RIGHT</u></p> <p><u>7.35</u> <u>TAKE TRACK TO LEFT JUST BEFORE GATE</u></p> <p><u>8.05</u> <u>OWNER LIVES ALONG TRACK TO RIGHT OVER GATE</u></p> <p><u>9.0</u> <u>CROSS GULLY</u></p> <p><u>9.3</u> <u>IRON GATE PASS TRACK ON RIGHT</u></p> <p><u>9.3</u> <u>TURN RIGHT JUST BEFORE GATE AND FOLLOW FENCE UP RIDGE</u></p> <p><u>9.3</u> <u>STOP VEHICLE AT ROCKS. 5 MIN WALK UP RIDGE TO TRC</u></p>	
Address:	Address:		
Phone:	Phone:		
Phone:	Phone:		
<p>Access Report of <u>19</u> was found suitable/unsuitable.</p> <p><u>Feature</u></p> <p><u>0.0</u> <u>ANGARA - BARBARA RD. ANGARA 34 BARBARA 27</u></p> <p><u>0.45</u> <u>TAKE ROAD EAST TO UPPER ANGARA 15</u></p> <p><u>1.15</u> <u>GRID + GATE</u></p> <p><u>5.15</u> <u>2.9 + 4.2. GRID + GATE</u></p> <p><u>5.4</u> <u>PASS YAKKAW ON RIGHT</u></p> <p><u>6.05</u> <u>GRID AND GATE</u></p> <p><u>7.15</u> <u>CAUSEWAY</u></p> <p><u>7.2</u> <u>GRID + GATE TAKE TRACK TO VARRANANARIE ON RIGHT</u></p> <p><u>7.35</u> <u>TAKE TRACK TO LEFT JUST BEFORE GATE</u></p> <p><u>8.05</u> <u>OWNER LIVES ALONG TRACK TO RIGHT OVER GATE</u></p> <p><u>9.0</u> <u>CROSS GULLY</u></p> <p><u>9.3</u> <u>IRON GATE PASS TRACK ON RIGHT</u></p> <p><u>9.3</u> <u>TURN RIGHT JUST BEFORE GATE AND FOLLOW FENCE UP RIDGE</u></p> <p><u>9.3</u> <u>STOP VEHICLE AT ROCKS. 5 MIN WALK UP RIDGE TO TRC</u></p>			
<p>This section to be completed by officer constructing pillar.</p> <p>Original station mark found/not found.</p> <p>Description of mark:</p> <p>Original beacon found/not found.</p> <p>Description of beacon:</p> <p>Height Top of Varies to Top Mark.....m.</p> <p>Height of mark.....m. above rock/conc.....m. above G.L. below</p> <p>Diameter of Varies.....m. Height of Cairn.....m.</p> <p>Original Beacon has/has not been destroyed by me.</p>			
<p>Beacon Diagram</p> <p>Not to Scale</p>			
<p>Date</p>		<p>Record of Station</p>	

CENTRAL MAPPING AUTHORITY

GEODETTIC SURVEY OF A.S.M.

GEODETTIC STATION RECONNAISSANCE and MAINTENANCE REPORT

Description:

1. Cleared by lanes bearing $116^{\circ} 138' M$, $164^{\circ} 167' M$, $178^{\circ} 14' M$ from Trig. Mast

2. Mast & Vanes have been painted white & black respectively, ✓

3. The station/pillar was ~~unplaced/constructed~~ on $10^{\circ} 58' M$ bearing 84° , dimensions now being:

Description of mark $84^{\circ} 112' M$ should be explicit, e.g. S/Steel Pillar Plate, Steel plug, Brass plug, Bolt, G.I. Pipe

Height of mark 1.37 m. ^{above} ~~below~~ rock/concrete; Mark is 1.51 m. ^{above} ~~below~~ G.L.

Height of Top Vanes to Top ~~Mast~~/Pillar plate 1.46 m. Diameter of Vanes (vertical) 75 m.

Height of Cairn 1.51 m. Diameter of Cairn 1.51 m. Name Plate ~~found~~/not ~~found~~/placed.

Length of Mast 1.51 m. (approximate if not supplied)

4. A $51/1616$ ~~Pia~~ set in conc/rock has been ~~placed~~/found, bearing $348^{\circ} M$ from Mast/~~Plug~~/Pillar

5. A $5.5 M$ set in conc/rock has been ~~placed~~/found, bearing $334^{\circ} M$ from Mast/~~Plug~~/Pillar

6. A set in conc/rock has been placed/found, bearing $^{\circ} M$ from Mast/~~Plug~~/Pillar

7. A set in conc/rock has been placed/found, bearing $^{\circ} M$ from Mast/~~Plug~~/Pillar

8. Action required:

STANDPOINT: CONCRETE PILLAR. STANDPOINT: Sr. Sr. Tail. Pia.

Mark	Direction	Horiz. Distance	Height Difference	Mark	Direction	Horiz. Distance	Height Difference
Blue Nobby (P)	$0^{\circ} 00' 00''$		above standpt.	Blue Nobby (P)	$0^{\circ} 00' 00''$		above standpt.
S.S.M.	$112^{\circ} 14' 26''$	4.464	above standpt.	S.S.M.	$095^{\circ} 33' 30''$	2.064	above standpt.
Sr/Sr Trig. Pia	$125^{\circ} 22' 20''$	2.575	above standpt.	Gundamulda	$G.S. 210^{\circ} 51' 04''$		above standpt.
Gundamulda G.S.	$210^{\circ} 49' 41''$		above standpt.	Green Bank	$(P) 268^{\circ} 24' 28''$		above standpt.
Green Bank	$(P) 268^{\circ} 23' 57''$		above standpt.	Gulf Pass	$(P) 289^{\circ} 15' 16''$		above standpt.
Gulf Pass	$(P) 249^{\circ} 14' 44''$		above standpt.	McIntyre	$(P) 305^{\circ} 22' 16''$	2.575	above standpt.
			below				below

Prepared by: D. J. KAIN.

Checked: *[Signature]* Noted on U.T.M. Card

Checked: *[Signature]*

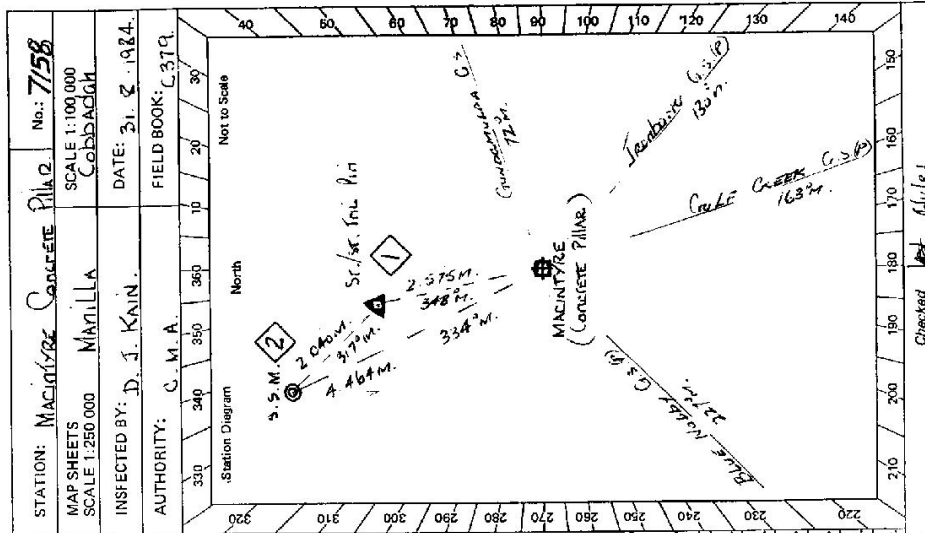

STATION MACINTYRE CONCRETE PILLAR TS 7158	
<p>Owner's Name: <u>MR. DAVID MC MURTRY</u></p> <p>Address: <u>YARRANDABIE</u></p> <p>Phone: <u>COBBADAH 18 D</u></p>	<p>Current Occupant: <u>MR. DAVID MC MURTRY</u></p> <p>Address:</p> <p>Phone:</p> <p>ACCESS <u>31-8-1984</u></p>
<p>Access Report of <u>16/7/1984</u> was found <u>unsuitable</u>.</p>	
<p>FEATURE:</p> <p>0.00 BINGARA - BARRABA ROAD, SIGNS, BINGARA EX, BARRABA 27.</p> <p>0.45 TAKE ROAD EAST TO UPPER BINGARA IS.</p> <p>1.15 GRID AND GATE.</p> <p>5.15 2 4 AND 4 2 OVER GRIDS.</p> <p>5.40 PASS TARRANON R.H.S.</p> <p>6.05 OVER GRID.</p> <p>7.15 CAUSEWAY.</p> <p>7.35 OVER GRID AND TAKE TRACK TO YARRANDABIE ON RIGHT.</p> <p>8.05 TAKE TRACK TO LEFT JUST BEFORE GRID, OTHER LINES STRAIGHT AHEAD.</p> <p>9.00 CROSS GULLY.</p> <p>9.67 IRON GATE, PASS TRACK ON RIGHT.</p> <p>TURN RIGHT JUST BEFORE IRON GATE AND FOLLOW LOW RANGE TRACK UP RIDGE ALONG FENCE.</p> <p>MACINTYRE CONCRETE PILLAR.</p>	
Date	Record of Station

Beacon Diagram	
	<p>This section to be completed by officer constructing pillar.</p> <p>Original station mark found/not found.</p> <p>Description of mark: <u>SMALLER STEEL P</u></p> <p>Original beacon found/not found.</p> <p>Description of beacon: <u>CAIRN, MAST AND VANES</u></p> <p>Height Top of Vanes to Top Mark <u>3.765</u> m.</p> <p>Height of mark <u>0.45</u> m. <u>above</u> <u>sea level</u> <u>G.L.</u></p> <p>Diameter of Vanes <u>1.02</u> m. Height of Cairn <u>1.13</u> m.</p> <p>Original Beacon has/has not been destroyed by me.</p>