

CENTRAL MAPPING AUTHORITY

GEODETIC SURVEY OF N.S.W.

GEODETIC STATION RECONNAISSANCE and MAINTENANCE REPORT

Description:

1. Cleared by lanes bearing: *Suez's block view 135° 46' 20" 16232°* from Trig. Mast
 Note: *Cross out word or words which do not apply*

2. Mast & Vanes have been painted white & black respectively. ✓
 The station/pillar was *unrepaired/reconstructed*/constructed on *20 vs Access 19*, dimensions now being:

Description of mark: *Root Top Pipe* should be explicit, e.g., S/Steel Pillar Plate, Steel plug, Brass plug, Bolt, G.I. Pipe
 Height of mark: *1355* m. above *rock/concrete*; Mark is: *1355* m. above *rock/concrete*. *CONCRETE FOOT.*

Height of Top Vanes to Top *CONCRETE*/Pillar plate *0.910* m. Diameter of Vanes (vertical) *0.750* m.

Height of Cairn: m. Diameter of Cairn: m. Name Plate found/not ~~found~~/placed.

Length of Mast m. (approximate if not unplied)

4. A. *Copper Nail* set in conc/~~rock~~ has been placed/~~found~~, bearing: *131° M* from ~~North~~/~~Mag~~/Pillar

5. A. *G.I. Nail* set in conc/~~rock~~ has been placed/~~found~~, bearing: *223° M* from ~~North~~/~~Mag~~/Pillar

6. A. set in conc/~~rock~~ has been placed/~~found~~, bearing:° M from Mast/Plug/Pillar

7. A. set in conc/~~rock~~ has been placed/~~found~~, bearing:° M from Mast/Plug/Pillar

8. Action required:

STANDPOINT: *Root Top Pillar.*

STANDPOINT: *Copper Nail*

Mark	Direction	Horiz. Distance	Height Difference	Mark	Direction	Horiz. Distance	Height Difference
<i>Silverwaterhouse</i>	<i>0 40 00</i>		<i>above</i> standpt.	<i>Silverwaterhouse (P)</i>	<i>0 40 00</i>		<i>above</i> standpt.
<i>Copper Nail</i>	<i>12 35 20</i>	<i>2434</i>	<i>below</i> standpt.	<i>G.I. Nail</i>	<i>139 27 00</i>	<i>8591</i>	<i>above</i> standpt.
<i>Curley Stone (P)</i>	<i>69 27 35</i>	<i>7450</i>	<i>below</i> standpt.	<i>Root Top Pillar</i>	<i>192 34 20</i>	<i>2435</i>	<i>below</i> standpt.
<i>G.I. Nail</i>	<i>124 08 50</i>	<i>7391</i>	<i>below</i> standpt.	<i>MOORE</i>	<i>202 56 60</i>		<i>below</i> standpt.
<i>MOORE</i>	<i>202 56 46</i>		<i>above</i> standpt.	<i>Stone (P)</i>	<i>297 08 20</i>		<i>above</i> standpt.
<i>Stone (P)</i>	<i>299 08 00</i>		<i>above</i> standpt.				<i>above</i> standpt.

Prepared by: *P. BOTT* 15.9.84

Checked: *P. BOTT*

Noted on U.T.M. Card *1441 2012 KC*

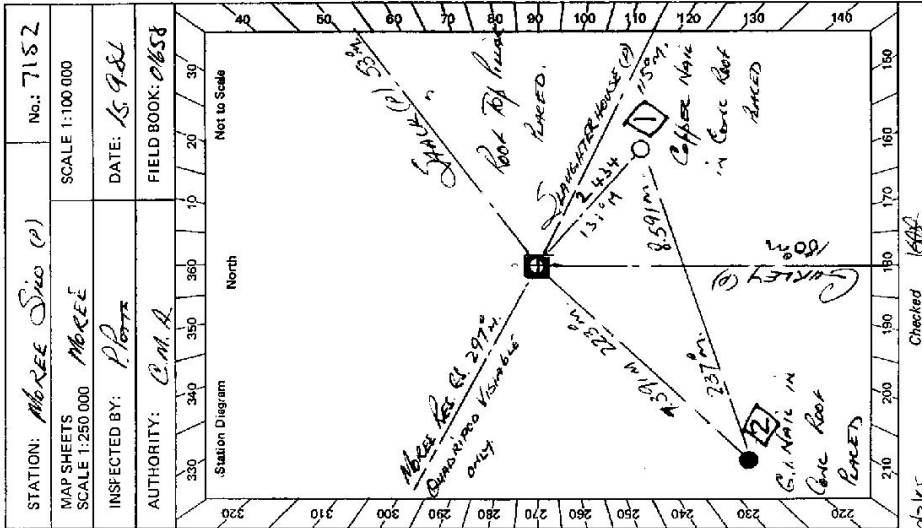

Checked: *P. BOTT*

2012 KC

STATION MOREE JILLO (P) IS 7152

Owner's Name: Chania Housing Authority
 Address: Ms Winston Prinsloo
Mansourah Drive Moree
 Phone: 087 52 1110

Current Occupant: Key Obtainable
 Address: From Moree Office
 Phone:

ACCESS

Access Report of 15/9/1984 was found suitable/unsuitable.
LETTING
157 DRIVE MOREE NEAR SOUTH TOWNS MANSOURAH
TURN LEFT AND NEWELL HIGHWAY
TURN LEFT AND BIRNIE'S LANE
TURN RIGHT & FOLLOW THIS ROAD TO JILLO
JILLO TRIG SITUATED ON TOP OF JILLO

LIC LOCK ON DOOR TO ROOF.

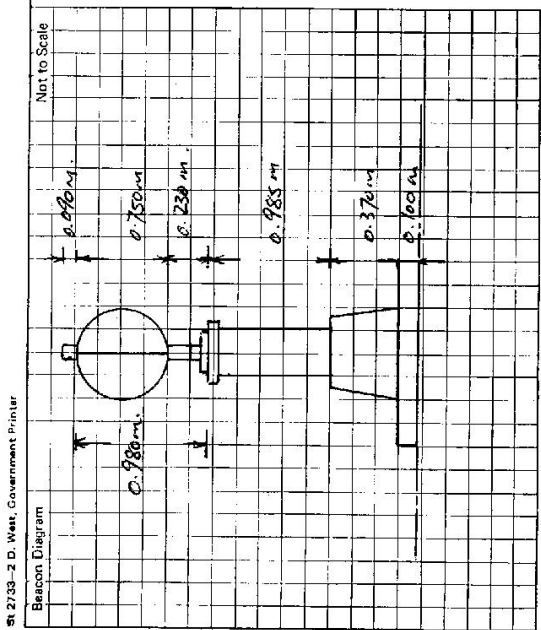

This section to be completed by officer constructing pillar.

Original station mark found/not found.

Description of mark: As New Station

Original beacon found/not found.

Description of beacon:

Height Top of Vane to Top Mark:m.
 above below

Height of mark:m. above below G.L.
 rock/conc

Diameter of Vane:m. Height of Cairn:m.

Original Beacon has/has not been destroyed by me.

Date	Record of Station