



8: 2733 - 2 D. West, Government Printer Beacon Diagram Not to Scale	STATION <b>CURRAMULANDI TS 7133</b>	ACCESS THROUGH ROP + IRON GATES Current Occupant: HIGH VALLEY Address: HIGH VALLEY Phone: C. RADONS 12.0 Phone: 5-7-1882 42.4 DOUBLE IRON GATES 42.7 TURN RIGHT AT TREE JUST BEFORE FENCE INTERSECTION AND PICK UP RAINY TRACK OVER HILL 43.6 FOLLOW TRACK AROUND TO LEFT 43.9 USE RIVER DOWN TOWARDS FENCE AND FOLLOW NORTH TO GATEWAY 44.3 GATEWAY FOLLOW TRACK BACK TO SOUTH 44.8 GULLY 45.15 PASS FENCE ON RIGHT 45.2 CROSS SMALL CREEK 45.45 CROSS HELL HOLE CREEK 45.9 GULLY 46.3 PASS DAM ON LEFT 46.6 GULLY 47.1 GATEWAY 47.3, 48.1, 48.2, 48.6, 48.8 + 49.0 GULLIES 49.2 TURN LEFT AT TOP OF RISE AND DARE AS FAR AS POSSIBLE THROUGH CLEARED SPUR TO FARELINE WALK OVER TO TOP OF RISE AND THEN EAST UP TO TOP OF RINGE TURN LEFT AT FENCE AND AGAIN TOP TO TRAIL 1 HOUR LIGHT ROAD
Owner's Name: MR. JIM MACDONALD Address: "LUMABELLA" Phone: WALTER HORTON RD Access Report of 1/11/18 was found suitable/unavailable. Easement: 40.0 BINGARA RD HEADING SOUTH 0.2 TURN RIGHT TOWARDS WAKARARI 19.4 GATEWAY AND NEW BRIDGE 20.2 PASS BOUNDARY CREEK RD ON LEFT 21.7 GRAD 26.3 CROSS ROADS 30.4 CONK BRIDGE OVER HORTON RIVER 33.5 GRAD 33.7 PAYS ROAD TO BARRABA AND HORTON ON LEFT MR MACDONALD LIVES ALONG THIS ROAD 39.1 CAUSEWAY HELL HOLE CREEK 39.1 " RACK CREEK 37.3 TURN LEFT ONTO RACK CREEK ROAD 40.5 GRAD 41.0 CAUSEWAY 41.15 DOUBLE IRON GATES 41.3 TURN LEFT TOWARDS HOUSE 41.45 PAYS MR MACDONALD'S HOUSE ON LEFT 41.75 DOUBLE IRON GATES SHEDS ON RIGHT SHARPLY ON LEFT TRAVEL STRAIGHT AHEAD 42.05 IRON GATE HEAD TOWARDS DOUBLE IRON GATES	Date * NOTE May be able to finish track further up hill to base of steep valley. Perhaps him and the wood could walk down to about 15 minutes.	
This section to be completed by officer constructing pillar. Original station mark found/not found. Description of mark: Original beacon found/not found. Description of beacon: Height Top of Vanes to Top Mark .....m. Height of mark .....m. above G.L. Diameter of Vanes .....m. below rock/conc. Original Beacon has/has not been destroyed by me. Height of Cairn .....m.		

CENTRAL MAPPING AUTHORITY

GEODETIC SURVEY OF M.S.W.

GEODETIC STATION RECONNAISSANCE and MAINTENANCE REPORT

Description:

- Note: Cross out word or words which do not apply
- Cleared by lanes bearing..... 6.7 to 11.0, 21.5 to 24.5° from Trig. Mast
  - Mast & Vanes have been painted white & black respectively. ✓
  - The station/pillar was ~~unplaced~~/set ~~unplaced~~/constructed on 5<sup>th</sup> Floor. ✓, dimensions now being: 19.84m, dimensions now being: 19.84m, dimensions now being: 19.84m
  - Description of mark. ~~None~~ should be explicit, e.g., S/Steel Pillar Plate, Steel plug, Brass plug, Bolt, G.I. Pipe
  - Height of mark. 1.375 m. ✓ above ~~rock~~/concrete; Mark is 1.375 m. ✓ above G.L.
  - Height of Top Vanes to Top ~~Mark~~/Pillar plate 1.423 m. ✓ Diameter of Vanes (vertical) 7.55 m. ✓
  - Height of Cairn..... m. Diameter of Cairn..... m. Name Plate ~~found~~/not ~~found~~/placed.
  - Length of Mast..... m. (approximate if not unplaced)
  - A. ~~Stainless Steel~~ Pin set in conc/~~rock~~ has been ~~placed~~/found, bearing 136° M from ~~Mast~~/Pillar
  - A. ~~Copper~~ Nail set in conc/~~rock~~ has been ~~placed~~/found, bearing 168° M from ~~Mast~~/Pillar
  - A..... set in conc/~~rock~~ has been ~~placed~~/found, bearing.....° M from Mast/Plug/Pillar
  - A..... set in conc/~~rock~~ has been ~~placed~~/found, bearing.....° M from Mast/Plug/Pillar
  - Action required: ~~None~~ to be ~~replaced~~ & ~~replaced~~.

STANDPOINT: ~~None~~ Pin

STANDPOINT: ~~None~~ Pin

Mark	Direction	Horiz. Distance	Height Difference	Mark	Direction	Horiz. Distance	Height Difference
BULE MOBBY (I)	0 00 00	✓	above standpt. ✓	BULE MOBBY (I)	0 00 00	✓	above standpt. ✓
S/S TRIG PIN	6 56 50	1650	below standpt. ✓	COPPER NAIL	48 09 20	5643	below standpt. ✓
COPPER NAIL	39 11 40	6974	below standpt. ✓	HOOK (I)	93 10 30	✓	below standpt. ✓
HOOK (I)	93 10 16	✓	above standpt. ✓	PINAR PLATE	186 53 40	1647	above standpt. ✓
NOUMEA (I)	308 03 00	✓	below standpt. ✓	NOUMEA (I)	308 02 30	✓	below standpt. ✓

Prepared by: L. R. HOLLIS

Checked: A. J. 1/1/24

Noted on U.T.M. Card

Sr 2733-1

Checked

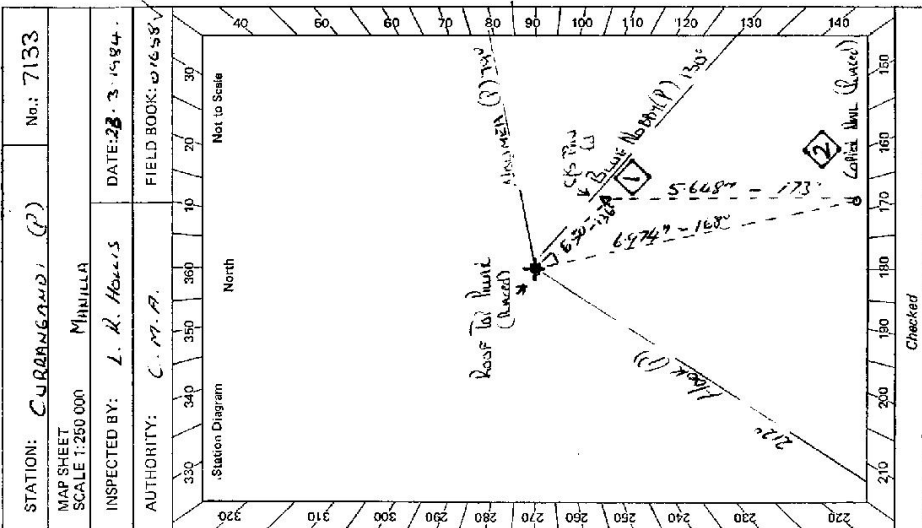

STATION: CURBANGA (P) No.: 7133

MAP SHEET SCALE 1:250 000 MANILLA

INSPECTED BY: L. R. HOLLIS DATE: 28-3-1984

AUTHORITY: C. M. A. FIELD BOOK: 01258

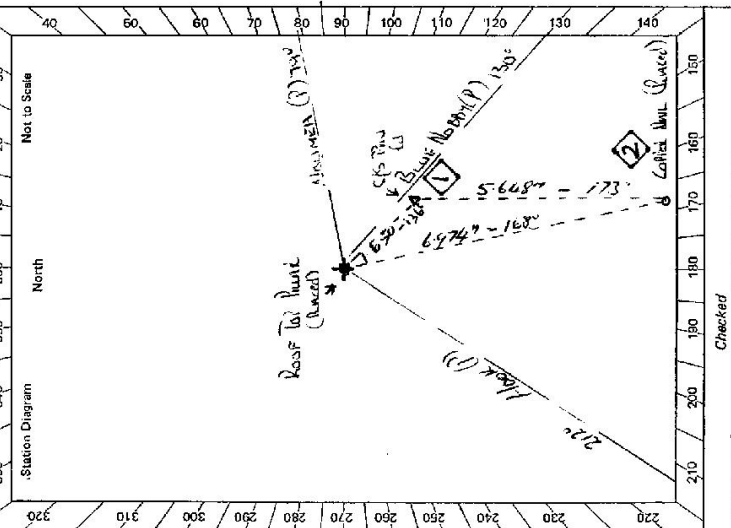

6

<p>St 2738 - 2 D. West, Government Printer</p> <p>Beacon Diagram</p> <p>Not to Scale</p> <p>1425</p> <p>1375</p> <p>1120</p> <p>ROOF TOP PILLAR</p>	<p>STATION <u>CURRANGRADI (0) TS 7133</u></p> <p>Owner's Name: <u>M. L. McRae</u></p> <p>Address: <u>1000 BARRELLA RD</u></p> <p>Phone: <u>9272 2222</u></p> <p>Current Occupant: .....</p> <p>Address: .....</p> <p>Phone: .....</p> <p>ACCESS</p> <p>Access Report of 27/3/19 was found suitable/unavailable.</p> <p><u>Feature</u></p> <p>UNRAIL NATIONAL P.D. TUNNEL WEST</p> <p>BRIDGE</p> <p>PASS CURRANGRADI RD ON LEFT</p> <p>PASS ALTERNATE ACCESS TO UMM BARRELLA HONEYBREAD</p> <p>BRIDGE</p> <p>TUNNEL LEFT SIGN UMM BARRELLA</p> <p>RAMP</p> <p>BRIDGE</p> <p>ALTERNATE ACCESS COMES IN ON L.H.S.</p> <p>PASS OWNERS HOUSE AND L.H.S.</p> <p>TUNNEL LEFT. ORIGINAL COMED ON R.H.S.</p> <p>TUNNEL</p> <p>DOUBLE ROAD BRIDGE</p> <p>CROSS DRY CREEK</p> <p>CROSS GULLY</p> <p>TUNNEL BRIDGE &amp; BRIDGE MILL FOLLOWING FURTHER TO LEFT ✓</p> <p>CROSS BRIDGE</p> <p>15:20 LEAVE VEHICLE WEST HORIZONTAL</p> <p>16:25 BRIDGE SECTION</p> <p>16:55 BRIDGE SECTION</p> <p>17:55 LEAVE VEHICLE - see metric table to table</p>
<p>Time</p> <p>0:00</p> <p>0:35</p> <p>2:10</p> <p>6:00</p> <p>10:50</p> <p>10:57</p> <p>10:58</p> <p>11:05</p> <p>11:05</p> <p>11:50</p> <p>12:00</p> <p>12:30</p> <p>12:45</p> <p>13:05</p> <p>13:18</p> <p>13:44</p> <p>14:30</p> <p>14:55</p> <p>15:20</p> <p>16:25</p> <p>16:55</p> <p>17:55</p>	<p>Date</p> <p>Record of Station</p>
<p>This section to be completed by officer constructing pillar.</p> <p>Original station mark found/<del>not found</del>.....</p> <p>Description of mark: <u>Stainless Steel Tall Pillar</u>.....</p> <p>Original beacon found/<del>not found</del>.....</p> <p>Description of beacon: <u>Galvalume Pole &amp; Disc</u>.....</p> <p>Height Top of Vane to Top Mark... <u>3.225</u>.....m.</p> <p>Height of mark <u>600</u>.....m. above rock/cone below</p> <p>Diameter of Vane <u>100</u>.....m. Height of Cairn <u>1150</u>.....m.</p> <p>Original Beacon has/has not been destroyed by me. <input checked="" type="checkbox"/></p>	



TS-7133

TS 2733-2 D. West, Government Printer

Beacon Diagram  
Not to Scale

STATION **CORRANGANDI PILLAR RA**

Owner's Name: **MR GARY MCDONALL**  
 Address: **YARRAMBA, BUNBURY**  
 Phone: **(067) 234221**

Current Occupant: **Mrs MCDONALL**  
 Address: .....  
 Phone: .....  
 ACCESS: **20-3-1981**

Access Report of 23.3.1981 was found ~~at~~ **unsuitable**.  
 KM  
 0.00 **UPPER HORIZON**  
 0.35 **OVER BRIDGE**  
 3.10 **PASS CORRANGANDI ROAD ON YOUR LEFT.**  
 10.50 **OVER BRIDGE**  
 10.71 **TURN LEFT "LUMBARELLA"**  
 11.44 **OVER GRID**  
 12.49 **PASS OWNERS HOUSE ON L.H.S. AND GARAGE ON R.H.S.**  
 12.71 **PASS MACHINERY SHED ON YOUR R.H.S.**  
 12.86 **THROUGH IRON GATE**  
 13.06 **THROUGH DOUBLE IRON GATES.**  
 13.17 **GULLY CROSSING.**  
 13.28 **TURN RIGHT OFF MAIN TRACK ONTO DEFINITE TRACK**  
 13.99 **THROUGH LONG GRASS 20.3.91 (NENLY OPPOSITE**  
 14.44 **REMAINS OF RUINS OF GALVANISED IRON ROOF.)**  
 14.54 **GULLY CROSSING. KEEP FOLLOWING TRACK**  
**TURN OFF TRACK TO YOUR RIGHT AND FOLLOW PAINT WHEEL**  
**MARKS ONLY.**  
**THROUGH IRON GATE, AND INTO Paddock with WINDPUMP AND**  
**TOWER. MAKE OWN WAY UP EASTERN SIDE OF GULLY**  
**BEARING 269M. TOWARD OBVIOUS STAND OF PINE TREES**  
**JUST ABOVE TIMBER LINE. 15.43. THIS VEHICLE STOP**  
**MARK IS INITIAL WEST UP STAIR TO WASHED OUT VEHICLE MET**  
**CONTAINING ON YOUR LEFT. FOLLOW THIS WITH OBSERVATION TO WITHIN 50 METERS OF TOP**  
**WATER TOWER. HAS BEEN PERIODICALLY RECOVER WITH YELLOW MARKING PAINT.**

15.43 **15 MINUTES TO GO MINUTE MARKING**  
**WATER TOWER HAS BEEN PERIODICALLY RECOVER WITH YELLOW MARKING PAINT.**

Time: **BUNBURY TO BASE OF HILL. 40 MINUTES**

This section to be completed by officer conducting pillar.  
 Original station mark found/not found.  
 Description of mark: .....  
 Original beacon found/not found.  
 Description of beacon: .....  
 Height of Top of Varies to Top Mark: .....ft.  
 Height of mark: .....m. above rock/cont. above G.L.  
 Diameter of Varies: .....ft. Height of Cairn: .....ft.  
 Original Beacon has/no. been destroyed by me.