

CENTRAL MAPPING AUTHORITY
Department of Lands

Trigonometrical Survey of N.S.W.

RECONNAISSANCE and MAINTENANCE REPORT

STATION GRATTAI G.S. TS 7121

This Trig. Station has been:-

1. Completely cleared to permit 360° vision to surrounding Trigs.
2. Cleared by lanes bearing..... from Trig. Mast
3. Trig. Mast & Vanes have been painted white & black respectively.
4. The Trig. was unpiled/~~set-emptied~~, dimensions now being:
 - Description of mark..... ~~steel~~ ^{steel} Trig. ~~plug~~ ^{plug} ~~concrete~~ ^{concrete} should be explicit, e.g. Steel plug, Brass plug, Bolt, G.I. Pipe
 - Height of mark..... ~~0.045~~ ^{0.045} m above ~~rock~~ ^{rock}/~~concrete~~ ^{concrete} m above ~~G.L.~~ ^{G.L.}
 - Height of Top Vanes to Top Mark, ~~3.230~~ ^{3.230} m. Diameter of Vanes (vertical) ~~0.215~~ ^{0.215} m.
 - Height of Cairn ~~1.1~~ ^{1.1} m. Diameter of Cairn ~~2.2~~ ^{2.2} m.
 - Length of Mast ~~3.342~~ ^{3.342} m. (approximate if not unpiled)
5. A. ~~S.S.M.~~ ^{S.S.M.} set in conc/~~rock~~ ^{rock} has been placed ~~2.122~~ ^{2.122} m. bearing ~~328~~ ³²⁸ °M from Trig. Mast
6. A. ~~Asstg. R.W.~~ ^{Asstg. R.W.} set in conc/~~soil~~ ^{soil} has been placed ~~2.775~~ ^{2.775} m. bearing ~~148~~ ¹⁴⁸ °M from Trig. Mast
7. A. ~~set in conc/soil~~ ^{set in conc/soil} has been placed m. bearing °M from Trig. Mast
8. A. ~~set in conc/rock~~ ^{set in conc/rock} has been placed m. bearing °M from Trig. Mast
9. Connection to m. bearing °M
10. Connection to m. bearing °M
11. Connection to m. bearing °M
12. Connection to m. bearing °M
13. Diff. Ht. ~~S.S.M.~~ ^{S.S.M.} is ~~0.277~~ ^{0.277} m. ~~above~~ ^{below} ~~slightly pin~~ ^{slightly pin}
14. Diff. Ht. ~~our Astro. P.M.~~ ^{our Astro. P.M.} is ~~1.207~~ ^{1.207} m. ~~above~~ ^{below} ~~slightly pin~~ ^{slightly pin}
15. Diff. Ht. is m. ~~above~~ ^{below}
16. Diff. Ht. is m. ~~above~~ ^{below}

Note: Cross out word or words which do not apply

Co: Jamison Ph: Cowmangah
Map Sheet: HORTON No: 8937
Inspected by: D. FREDRIKSEN Date: 12.5.77
Authority: C.M.A. Field Book: 1557
Beacon Diagram Not to Scale

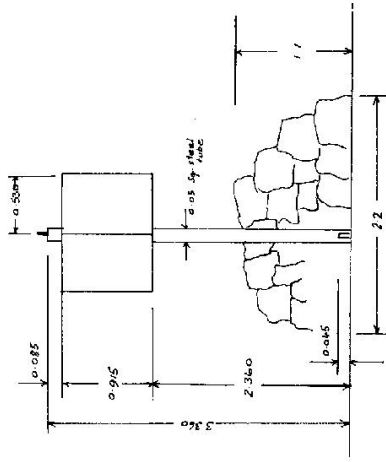

Date _____ Record of Station _____

Prepared by: D. Fredrikson Checked: A. V. 14/4/18
Noted on U.T.M. Card

TS 7121
No: 2683

STATION: *Geometric C.S.*
MAP SHEET
SCALE 1:250 000
INSPECTED BY: *P. Berts*
DATE: *26.83*
AUTHORITY: *C.I.A.A.*
FIELD BOOK: *1933*

GEODETTIC STATION RECONNAISSANCE and MAINTENANCE REPORT

Description:
1. Cleared by lanes bearing..... *32.3° to 33.2°* *250 m* *to 359°* *60 m* *to 79°* *10 m* *to 161 m* *282 m* *to 210 m* *300 m* *to 304 m*
2. Mast & Vanes have been painted white & black respectively
3. The station/~~pillar~~ was unpiled/~~concreted~~ on..... *conc. base*..... *19.83*..... dimensions now being:
Description of mark *3.365*..... m. above *rock*/~~concrete~~;
Height of mark..... m. above *rock*/~~concrete~~;
Height of Top Vanes to Top Mark/~~to base~~..... m. Diameter of Vanes (vertical)..... m.
Height of Cairn..... m. Diameter of Cairn..... m. Name Plate ~~found~~/~~replaced~~/~~placed~~.
Length of Mast..... m. (approximate if not unpiled)
4. *S.S.M. 1607*..... set in conc/~~rock~~ has been ~~placed~~/~~found~~, bearing..... *320°* M from ~~Mast~~/~~Plug~~/~~Pillar~~
5. *Astko Pillar*..... set in conc/~~rock~~ has been ~~placed~~/~~found~~, bearing..... *141°* M from ~~Mast~~/~~Plug~~/~~Pillar~~
6. *Copper Pipe*..... set in ~~conc~~/~~rock~~ has been ~~placed~~/~~found~~, bearing..... *187°* M from ~~Mast~~/~~Plug~~/~~Pillar~~
7. A..... set in conc/~~rock~~ has been placed/~~found~~, bearing..... M from Mast/~~Plug~~/~~Pillar~~
8. Action required:.....

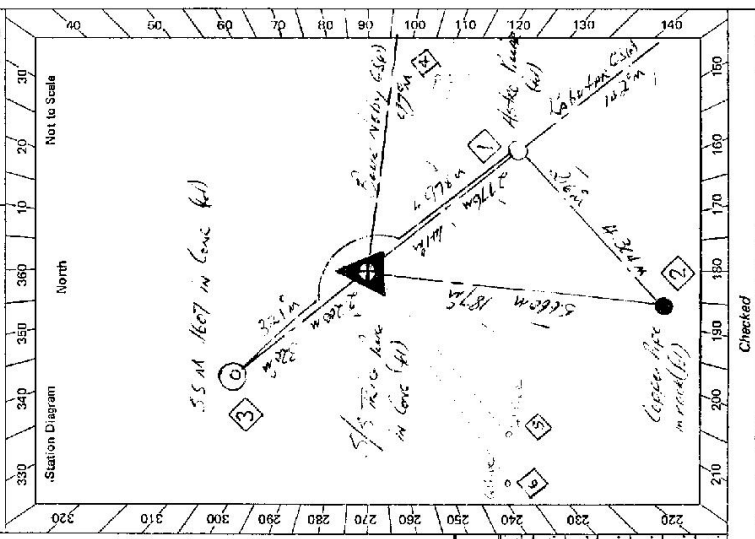

Mark	Direction	Horiz. Distance	Height Difference	Mark	Direction	Horiz. Distance	Height Difference
<i>Rapier (50)</i>	<i>0 00 00</i>		<i>above standpt.</i>	<i>Rapier (50)</i>	<i>0 00 00</i>		<i>above standpt.</i>
<i>Copper Pipe</i>	<i>07 25 10</i>	<i>5.660</i>	<i>below standpt.</i>	<i>Copper Pipe</i>	<i>75 51 16</i>	<i>4.304</i>	<i>below standpt.</i>
<i>S.S.M. 1607</i>	<i>18 05 26</i>	<i>2.383</i>	<i>above standpt.</i>	<i>S.S.M. 1607</i>	<i>179 58 06</i>	<i>2.777</i>	<i>below standpt.</i>
<i>Blue Nobby (50)</i>	<i>314 55 00</i>		<i>above standpt.</i>	<i>Blue Nobby (50)</i>	<i>179 58 16</i>	<i>4.978</i>	<i>below standpt.</i>
<i>Astko Pillar</i>	<i>359 52 36</i>	<i>2.775</i>	<i>below standpt.</i>	<i>Blue Nobby (50)</i>	<i>314 55 00</i>		<i>above standpt.</i>
			<i>below standpt.</i>				<i>below standpt.</i>

STANDPOINT: *Stainless Steel Pipe* STANDPOINT: *Astko Pillar*
Prepared by: *P. Berts* 6th June 1983 Checked: *P. Berts* Noted on U.T.M. Card

St 2733-2 D. West, Government Printer

STATION *CIRATTAI ES / TS 7121*

Owner's Name: *TRIG BEERIE 62778*
Address: *Miyana, Girattai, Nilgiris*
of Mount Kappila National Park
Phone: *Ravages, P. Davies, Mookkel, 922788*

Current Occupant:
Address:
Phone:

Access Report of 27/6/19 *was found suitable/unavailable.*

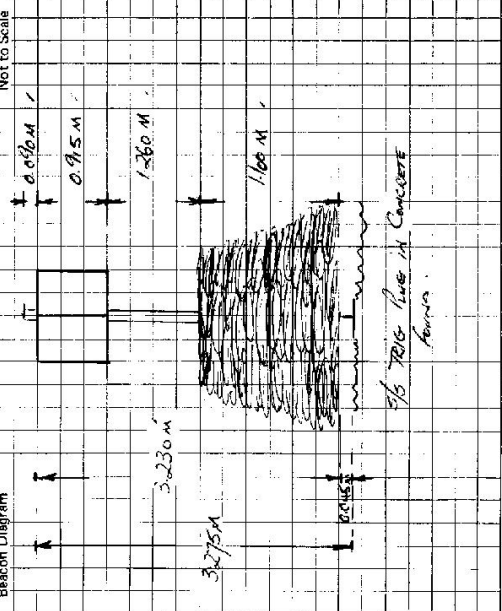

This section to be completed by officer constructing pillar.

Original station mark found/not found.
Description of mark: *1/2 TRIG LINE*
Original beacon found/not found. *CAIRN POLE & DISC*
Description of beacon:
Height Top of Vanes to Top Mark: *3.275* m.
Height of mark: *0.95* m. above rock/conc. m. below G.L.
Diameter of Vanes: *0.95* m. Height of Cairn: *1.60* m.
Original Beacon has/not been destroyed by me.

FEATURE
800 Post OFFICE NEARBY! Head NORTH towards ANCOE!
81 CROSS RAILWAY LINE!
82 TRAIL RIGHT SIGN (SINGAPORE)
143 SIGN OF SPIDER HEAD
147 LESS CHATELAIN 'SPRING CREEK'
155 LESS (GREEN)
156 LESS (GREEN)
157 LESS (GREEN)
158 TRAIL LEFT ROCK!
161 TRAIL (GREEN)
162 TRAIL (GREEN)
163 TRAIL (GREEN)
164 TRAIL (GREEN)
165 TRAIL (GREEN)
166 TRAIL (GREEN)
167 TRAIL (GREEN)
168 TRAIL (GREEN)
169 TRAIL (GREEN)
170 TRAIL (GREEN)
171 TRAIL (GREEN)
172 TRAIL (GREEN)
173 TRAIL (GREEN)
174 TRAIL (GREEN)
175 TRAIL (GREEN)
176 TRAIL (GREEN)
177 TRAIL (GREEN)
178 TRAIL (GREEN)
179 TRAIL (GREEN)
180 TRAIL (GREEN)
181 TRAIL (GREEN)
182 TRAIL (GREEN)
183 TRAIL (GREEN)
184 TRAIL (GREEN)
185 TRAIL (GREEN)
186 TRAIL (GREEN)
187 TRAIL (GREEN)
188 TRAIL (GREEN)
189 TRAIL (GREEN)
190 TRAIL (GREEN)
191 TRAIL (GREEN)
192 TRAIL (GREEN)
193 TRAIL (GREEN)
194 TRAIL (GREEN)
195 TRAIL (GREEN)
196 TRAIL (GREEN)
197 TRAIL (GREEN)
198 TRAIL (GREEN)
199 TRAIL (GREEN)
200 TRAIL (GREEN)
201 TRAIL (GREEN)
202 TRAIL (GREEN)
203 TRAIL (GREEN)
204 TRAIL (GREEN)
205 TRAIL (GREEN)
206 TRAIL (GREEN)
207 TRAIL (GREEN)
208 TRAIL (GREEN)
209 TRAIL (GREEN)
210 TRAIL (GREEN)
211 TRAIL (GREEN)
212 TRAIL (GREEN)
213 TRAIL (GREEN)
214 TRAIL (GREEN)
215 TRAIL (GREEN)
216 TRAIL (GREEN)
217 TRAIL (GREEN)
218 TRAIL (GREEN)
219 TRAIL (GREEN)
220 TRAIL (GREEN)
221 TRAIL (GREEN)
222 TRAIL (GREEN)
223 TRAIL (GREEN)
224 TRAIL (GREEN)
225 TRAIL (GREEN)
226 TRAIL (GREEN)
227 TRAIL (GREEN)
228 TRAIL (GREEN)
229 TRAIL (GREEN)
230 TRAIL (GREEN)
231 TRAIL (GREEN)
232 TRAIL (GREEN)
233 TRAIL (GREEN)
234 TRAIL (GREEN)
235 TRAIL (GREEN)
236 TRAIL (GREEN)
237 TRAIL (GREEN)
238 TRAIL (GREEN)
239 TRAIL (GREEN)
240 TRAIL (GREEN)
241 TRAIL (GREEN)
242 TRAIL (GREEN)
243 TRAIL (GREEN)
244 TRAIL (GREEN)
245 TRAIL (GREEN)
246 TRAIL (GREEN)
247 TRAIL (GREEN)
248 TRAIL (GREEN)
249 TRAIL (GREEN)
250 TRAIL (GREEN)
251 TRAIL (GREEN)
252 TRAIL (GREEN)
253 TRAIL (GREEN)
254 TRAIL (GREEN)
255 TRAIL (GREEN)
256 TRAIL (GREEN)
257 TRAIL (GREEN)
258 TRAIL (GREEN)
259 TRAIL (GREEN)
260 TRAIL (GREEN)
261 TRAIL (GREEN)
262 TRAIL (GREEN)
263 TRAIL (GREEN)
264 TRAIL (GREEN)
265 TRAIL (GREEN)
266 TRAIL (GREEN)
267 TRAIL (GREEN)
268 TRAIL (GREEN)
269 TRAIL (GREEN)
270 TRAIL (GREEN)
271 TRAIL (GREEN)
272 TRAIL (GREEN)
273 TRAIL (GREEN)
274 TRAIL (GREEN)
275 TRAIL (GREEN)
276 TRAIL (GREEN)
277 TRAIL (GREEN)
278 TRAIL (GREEN)
279 TRAIL (GREEN)
280 TRAIL (GREEN)
281 TRAIL (GREEN)
282 TRAIL (GREEN)
283 TRAIL (GREEN)
284 TRAIL (GREEN)
285 TRAIL (GREEN)
286 TRAIL (GREEN)
287 TRAIL (GREEN)
288 TRAIL (GREEN)
289 TRAIL (GREEN)
290 TRAIL (GREEN)
291 TRAIL (GREEN)
292 TRAIL (GREEN)
293 TRAIL (GREEN)
294 TRAIL (GREEN)
295 TRAIL (GREEN)
296 TRAIL (GREEN)
297 TRAIL (GREEN)
298 TRAIL (GREEN)
299 TRAIL (GREEN)
300 TRAIL (GREEN)

GEODETTIC SURVEY OF N.S.W.

CENTRAL MAPPING AUTHORITY

GEODETTIC STATION RECONNAISSANCE and MAINTENANCE REPORT

Description:

1. Cleared by lanes bearing $64^{\circ} 79'$, $90^{\circ} 16'$, $310^{\circ} 22'$, $250^{\circ} 27'$, $300^{\circ} 30'$, $223^{\circ} 52'$, $350^{\circ} 35'$ from Trig. Mast
2. Mast & Vanes have been painted white & black respectively.
3. The station/pillar was ~~reconstructed~~ constructed on **28 February 1984**, dimensions now being: **Roof top pillar**

Description of mark should be explicit, e.g., S/Steel Pillar Plate, Steel plug, Brass plug, Bolt, G.I. Pipe
 Height of mark 1.35 m. above rock/concrete; Mark is 0.75 m. above G.L.
 Height of Top Vanes to Top Mast/Pillar plate 1.41 m. Diameter of Vanes (vertical) 0.75 m.
 Height of Cairn 0.75 m. Diameter of Cairn 0.75 m. Name Plate found/~~not found~~/present.

Length of Mast 1.5 m. (approximate if not unspiled)

4. A. S.S.M. 1607 set in conc/rock has been ~~planned~~/found, bearing $318^{\circ} 0'$ from Mast/Plug/Pillar
5. A. Cu. Tube set in conc/rock has been ~~planned~~/found, bearing $191^{\circ} 0'$ from Mast/Plug/Pillar
6. A. G.I. Pipe set in ~~conc/rock~~ soil has been ~~planned~~/found, bearing $223^{\circ} 0'$ from Mast/Plug/Pillar
7. A. Astro pillar (beneath) in conc/rock has been ~~planned~~/found, bearing $145^{\circ} 0'$ from Mast/Plug/Pillar

8. Action required: ~~Original 315° SW PLUG DESTROYED~~ **Other G.I. Pipe in soil found DESTROYED**
~~Original 315° SW PLUG DESTROYED~~ **Original 315° SW PLUG DESTROYED**
~~Original 315° SW PLUG DESTROYED~~ **Original 315° SW PLUG DESTROYED**
 STANDPOINT: ~~Roof top Pillar~~ **Astro Pillar (later DESTROYED)**

Mark	Direction	Horiz. Distance	Height Difference	Mark	Direction	Horiz. Distance	Height Difference
BEELERA (P)	0 00 00		above standpt.	BEELERA (P)	0 00 00		above standpt.
G.I. Pipe in soil	16 44 06	71.677	2.832	Cu. Tube	5 46 04	4.303	1.094
SSM 1607	106 39 55	2.318	1.758	G.I. Pipe	18 51 25	71.451	2.379
GURLEY (P)	117 23 44		above standpt.	SSM 1607	109 51 07	4.977	1.304
KARUTAR (P)	249 54 39		above standpt.	Pillar spigot	112 40 23	2.666	0.454
Astro pillar	292 41 02	2.467	0.455	GURLEY (P)	117 23 19		above standpt.
Cu. Tube	339 06 12	5.683	1.549				below

Prepared by: A. Sherben

Checked: D. King

Noted on U.T.M. Card

Checked

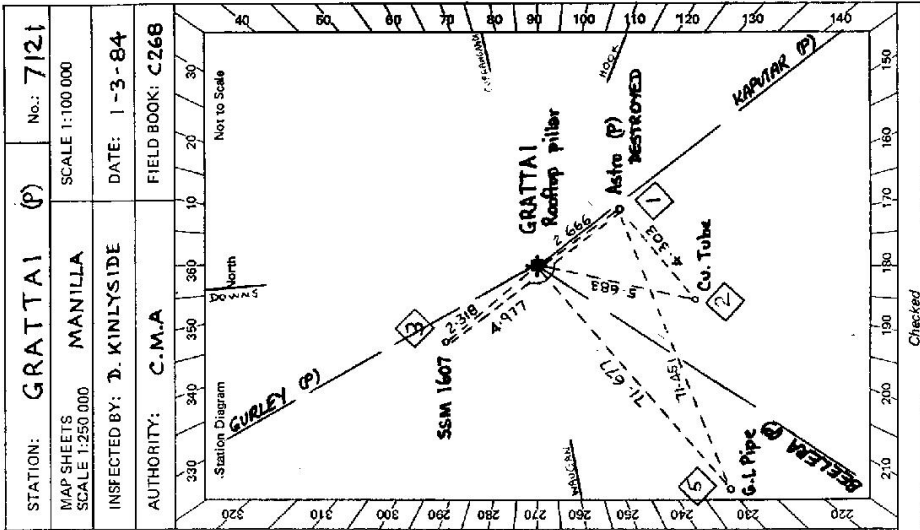

1407

SI 2733-2 D. West, Government Printer

STATION **GRATTAI (P) TS 7121**

Owner's Name: **TR 62778**
 Address: **MITHIN GRATTAI WILDERNESS of Kaputar National Park**
 Phone: **NP 8745 Narrabri 92-2788**

Current Occupant:
 Address:
 Phone:

ACCESS

Access Report of **11/11/1981** was found suitable/unsuitable. **WALKING TIME 2 1/2 - 3 HOURS**

NARRABRI P.O. Head north towards MOREE

0.0 Cross railway line
 0.8 Turn RIGHT. Sign BINGARA
 3.8 End of bitumen
 11.8 Causeway "SPRING CREEK"
 23.4 Take LEFT fork towards TERRY HIE HIE
 25.61 Cross creek
 29.76 Grid
 32.88 Grid
 40.55 Cross creek
 40.77 Turn RIGHT into "COURADDA" property
 41.89 Grid
 41.93 Take LEFT fork
 42.31 Double iron gates
 " "
 43.22 Cross creek
 43.41 Double iron gates
 " "
 44.92 Pass dam on LEFT
 44.96 Double iron gates
 45.07 " "
 45.50 " "
 45.68 CAMERONS Homestead on RHS. CALL IN

45-72 Turn RIGHT through wire gate & follow track between house and shed.
 45.81 Pass dam on RIGHT
 45.95 Turn left through iron gate & then year left through temporary fence & gate -- follow contour bank across paddock
 46.4 Iron gate
 46.48 Pass track on left
 46.94 Pass hut on right
 47.03 Dam on left.
 47.04 Take LEFT track
 47.23 Cross creek
 47.30 Take LEFT track - just before creek crossing
 49.86 Stop vehicle & walk. From this point walk down walking track to creek on left where you will come to a creek intersection and then follow creek on your right to top of range. At top of range year left and keep heading to highest point. Abt 1 hour walk from top of range to trig.

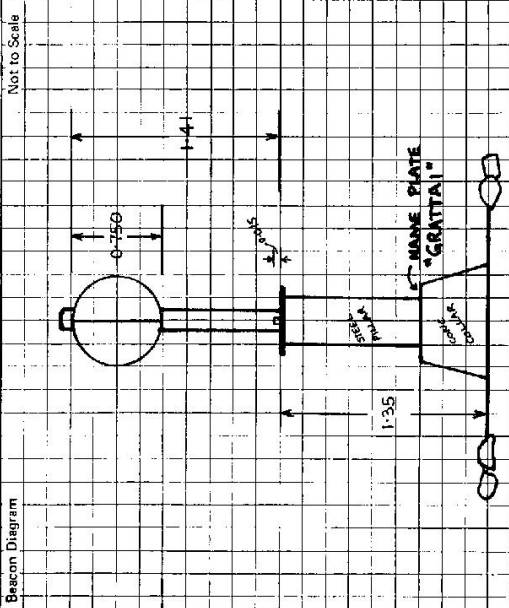

This section to be completed by officer constructing pillar.

Original station mark found/used: ~~.....~~

Description of mark: **S/S pin in cone**.....

Original beacon found/used: ~~.....~~

Description of beacon: **Steel mast 8 vanes + cairn**.....

Height Top of Vanes to Top Mark: **3.230**.....m.
 above below
 Height of mark: **0.045**.....m. above below
 G.L. vanes/conc
 Diameter of Vanes: **0.915**.....m. Height of Cairn: **1.10**.....m.

Original Beacon has/has not been destroyed by int. & stacked near trig

Date: Record of Station: