

CENTRAL MAPPING AUTHORITY

GEODETIC SURVEY OF N.S.W.

GEODETIC STATION RECONNAISSANCE and MAINTENANCE REPORT

- Description:
- Cleared by lense bearing..... 360° / 360° Note: Cross out word or words which do not apply from Trig. Mast
  - Mast & Vanes have been painted white & black respectively. /
  - The station/~~pillar~~ was unpiled/~~replaced~~/~~consolidated~~ on..... 19.83 / 19.83 dimensions now being: Description of mark Brass Pipe should be explicit, e.g., S/Steel Pillar Plate, Steel plug, Brass plug, Bolt, G.I. Pipe  
Height of mark..... 0.08 m. above rock/concrete; Mark is..... m. above G.L.  
Height of Top Vanes to Top Mark/~~to top of pillar~~..... 3.360 / 3.360 m. Diameter of Vanes (vertical)..... 0.75 / 0.75 m.  
Height of Cairn..... 1.375 / 1.375 m. Diameter of Cairn..... m. Name Plate ~~found~~/~~replaced~~/~~placed~~.  
Length of Mast..... 3.440 / 3.440 m. (approximate if not unpiled)
  - A..... G.I. Pipe set in conc/~~rock~~ has been placed/~~found~~, bearing..... 291 °M from Mast/Plug/~~Pillar~~
  - A..... Copper Nail set in conc/rock has been placed/~~found~~, bearing..... 349 °M from Mast/Plug/~~Pillar~~
  - A..... set in conc/rock has been placed/~~found~~, bearing..... °M from Mast/Plug/~~Pillar~~
  - A..... set in conc/rock has been placed/~~found~~, bearing..... °M from Mast/Plug/~~Pillar~~
  - Action required:.....

STANDPOINT: Bones Trig Rover

STANDPOINT: G.I. Pipe

Mark	Direction	Horiz. Distance	Height Difference	Mark	Direction	Horiz. Distance	Height Difference
<u>TERCIBLE (P)</u>	<u>0 00 00</u>	<u>0 00 00</u>	<u>above standpt</u>	<u>TERCIBLE (P)</u>	<u>0 00 00</u>	<u>0 00 00</u>	<u>above standpt</u>
<u>GREEN FELL (P)</u>	<u>R 53 04</u>	<u>0 00 00</u>	<u>above standpt</u>	<u>GREEN FELL (P)</u>	<u>12 53 38</u>	<u>0 00 00</u>	<u>above standpt</u>
<u>CANA (P)</u>	<u>42 40 40</u>	<u>0 00 00</u>	<u>above standpt</u>	<u>CANA (P)</u>	<u>42 40 50</u>	<u>0 00 00</u>	<u>above standpt</u>
<u>G.I. PIPE</u>	<u>111 00 30</u>	<u>3.921</u>	<u>above standpt</u>	<u>TAMMORATH (P)</u>	<u>223 03 30</u>	<u>0 00 00</u>	<u>above standpt</u>
<u>COPPER NAIL</u>	<u>165 31 10</u>	<u>3.261</u>	<u>above standpt</u>	<u>COPPER NAIL</u>	<u>238 22 00</u>	<u>3.339</u>	<u>above standpt</u>
<u>TAMMORATH (P)</u>	<u>223 02 00</u>	<u>0 00 00</u>	<u>above standpt</u>	<u>BONES TRIG LINE</u>	<u>291 01 50</u>	<u>3.426</u>	<u>above standpt</u>
			<u>below</u>				<u>below</u>

Prepared by: P. Batts 20.7.83

Checked: P. Batts 12/8/83

Noted on U.T.M. Card 190

STATION: Duci Cs. No.: 1914

MAP SHEET SCALE 1:250 000

INSPECTED BY: P. Batts DATE: 20.7.83

AUTHORITY: C.M.A. FIELD BOOK: 1947

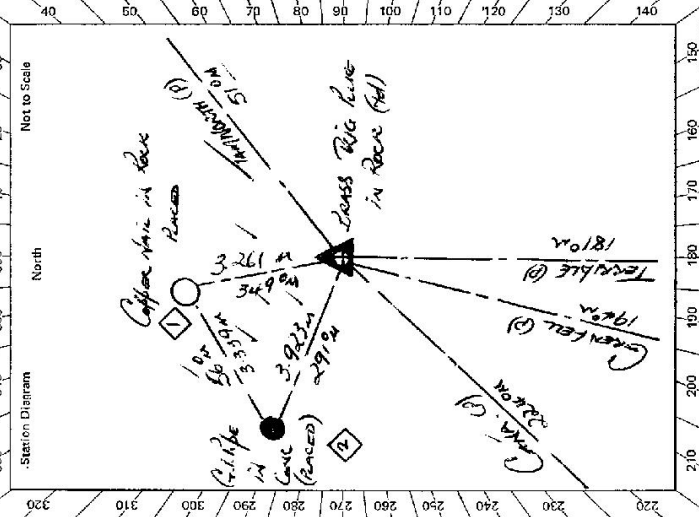

Checked P. Batts 20/8/84

TS-7118

SF 2733-1

Sc 2733-2 D. West, Government Printer

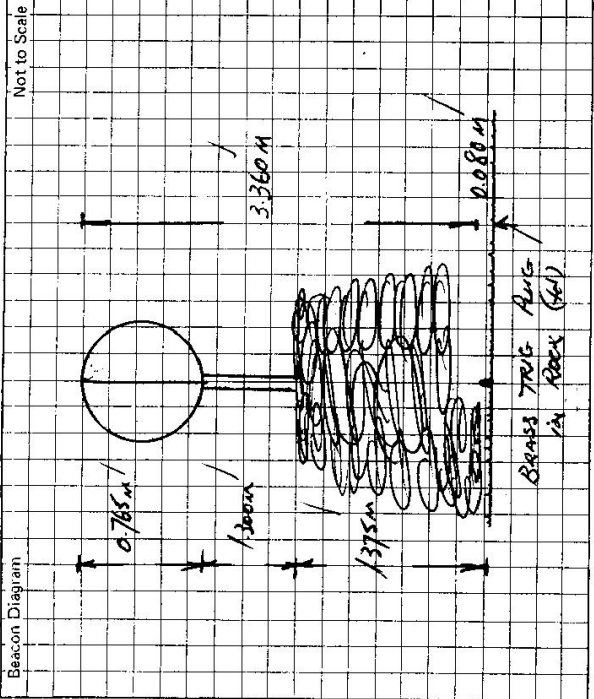

This section to be completed by officer constructing pillar.

Original station mark found/~~not found~~:  
 Description of mark: Brass Trig Pole  
 Original beacon found/~~not found~~:  
 Description of beacon: Cairn Pole & Disc  
 Height Top of Vanes to Top Mark 3.595m m.  
 Height of mark: 0.006 m. above rock/ceas. m. below G.L.  
 Diameter of Vanes 0.765 m. Height of Cairn 1.810 m.  
 Original Beacon ~~was~~/has not been destroyed by me.

STATION Durai G.S. TS-7118  
 Owner's Name: Mr. E. Payne  
 Address: 1 Hallacres Road, Currabubula  
 Phone: 3342 3424  
 Current Occupant: Mr. G.S. Crossby  
 Address: Durai Peak, Birkamere  
 Phone: 7440 6742 39

ACCESS

Access Report of 20/1/19 was found suitable/unsuitable.

FEATURE  
 0.00 Post Office Currabubula Head Towards Thamwoorth  
 0.17 Turn Left Just before Currabubula Gully  
 0.41 Turn Left onto Gravel Road  
 0.52 CAUSEWAY  
 1.13 GRID  
 2.10 GRID  
 3.69 GRID MR E PAYNE LIVES IN HOUSE ON RIGHT  
 3.97 THROUGH DOUBLE IRON GATES  
 4.64 THROUGH DOUBLE IRON GATES  
 5.22 THROUGH DOUBLE IRON GATES ON LEFT & FOLLOW TRACK LEFT  
 5.66 THROUGH DOUBLE IRON GATES NEXT TO SMALL YARDS  
 6.55 PASS FAINT TRACK ON LEFT  
 6.57 THROUGH NAME IRON GATE NON MR G.S. CROSSBY'S LAND  
 7.09 SADDLE - TURN RIGHT & HEAD TOWARDS TWO SMALL PINES & PRUNED TREE  
 7.24 PASS BLAZED TREE ON LEFT - VEER RIGHT UP OF RIDGE  
 7.42 STOP VEHICLE - FROM HERE WALK TO TOP OF RIDGE THEN LEFT TO TOP OF PEAK THEN INTO SADDLE & UP TO Durai G.S.

ABOUT 1 HOUR WALK WITH LOAD

Date	Record of Station







