

TS 7079
No.: 370A

STATION: PERA
MAP SHEET
SCALE 1:250 000
INSPECTED BY: P. Hobb
DATE: 23-11-11
AUTHORITY: MANILLA
FIELD BOOK:

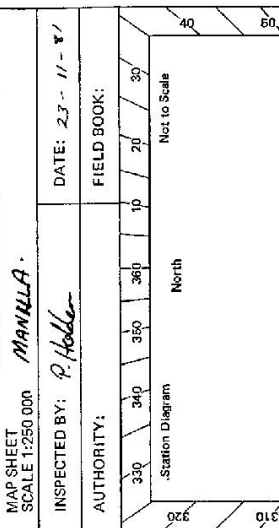

Geodetic Station Reconnaissance and Maintenance Report

Description:

1. Cleared by lanes bearing.....

2. Mast & Vanes ~~Painted~~ painted white & black respectively.

3. The station ~~pillar was unplied/constructed~~ on ~~2.2.11~~ 1951, dimensions now being:

Description of mark..... should be explicit, e.g., S/Steel Pillar Plate, Steel plug, Brass plug, Bolt, G.I. Pipe

Height of mark.....m, above below rock/concrete, Mark is.....m, above below G.L.

Height of Top Vanes to Top Mark/Pillar plate.....m. Diameter of Vanes (vertical).....m.

Height of Cairn.....m. Diameter of Cairn.....m. Name Plate found/not found/placed.

Length of Mast.....m. (approximate if not unplied)

4. A.....set in conc/rock has been placed/found, bearing.....°M from Mast/Plug/Pillar

5. A.....set in conc/rock has been placed/found, bearing.....°M from Mast/Plug/Pillar

6. A.....set in conc/rock has been placed/found, bearing.....°M from Mast/Plug/Pillar

7. A.....set in conc/rock has been placed/found, bearing.....°M from Mast/Plug/Pillar

8. Action required: ~~The cairn for mast & vanes, minimum clearing for 360° vision.~~

| STANDPOINT: | | | |
|-------------|-----------|-----------------|-------------------|
| Mark | Direction | Horiz. Distance | Height Difference |
| | | | above standpt. |
| | | | below standpt. |
| | | | above standpt. |
| | | | below standpt. |
| | | | above standpt. |
| | | | below standpt. |
| | | | above standpt. |
| | | | below standpt. |
| | | | above standpt. |
| | | | below standpt. |
| | | | above standpt. |
| | | | below standpt. |
| | | | above standpt. |
| | | | below standpt. |
| | | | above standpt. |
| | | | below standpt. |

Prepared by: *[Signature]* Checked: *[Signature]*

Noted on U.T.M. Card

SI 2733-1

STATION: **PERA** No.: **7079**

MAP SHEET SCALE 1:250 000 **MANILLA**

INSPECTED BY: **D. MOSS** DATE: **16.4.82**

AUTHORITY: **C.M.A. 55/11/833** FIELD BOOK: **2000**

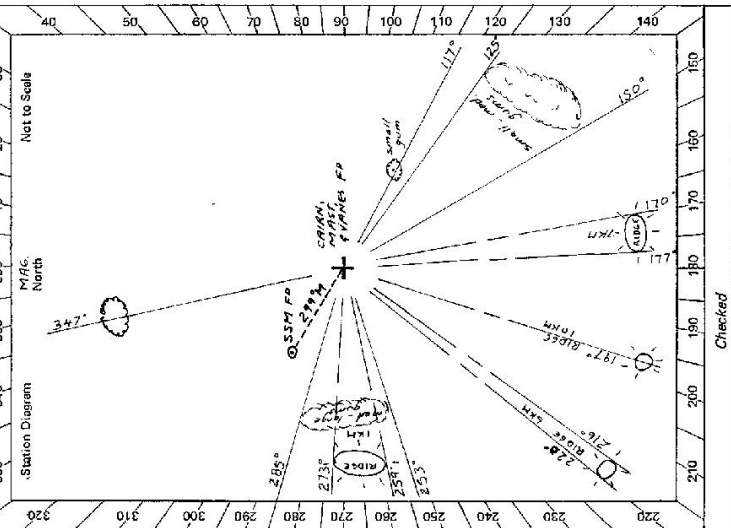

CENTRAL MAPPING AUTHORITY
 GEODETIC SURVEY OF N.S.W.
 GEODETIC STATION RECONNAISSANCE and MAINTENANCE REPORT

- Description: *Note: Cross out word or words which do not apply*
- Cleared by lanes bearing **360° - see diagram** from Trig. Mast
 - ~~Mast & Vanes have been painted white & black respectively.~~
 - The station/~~pillar~~ was ~~erected~~/~~not unplied~~/~~re-erected~~ on **16 APRIL 1982**, dimensions now being: Description of mark ~~should be explicit, e.g. S/Steel Pillar Plate, Steel plug, Brass plug, Bolt, G.I. Pipe~~
 - Height of mark ~~above rock/concrete;~~ Mark is ~~above~~ **G.L.**
 - Height of Top Vanes to Top Mark/Pillar plate ~~m.~~ Diameter of Vanes (vertical) **1.0** m.
 - Height of Cairn **1.2** m. Diameter of Cairn **2.2** m. ~~Name of Plate found/lost found/plate.~~
 - Length of Mast **3.0** m. (approximate if not unplied)
 - A **S.S.M.** set in conc/~~rock~~ has been ~~placed~~/~~found~~, bearing **277°** M from Mast/~~Plug/Pillar~~
 - A ~~set in conc/rock has been placed/~~found, bearing ~~.....~~ M from Mast/~~Plug/Pillar~~
 - A ~~set in conc/rock has been placed/~~found, bearing ~~.....~~ M from Mast/~~Plug/Pillar~~
 - A ~~set in conc/rock has been placed/~~found, bearing ~~.....~~ M from Mast/~~Plug/Pillar~~
 - Action required: **CONSTRUCT CONCRETE PILLAR** ~~SHAS CLEARING OF SMALL MEDIUM TREES FOR 360° VISION~~

STANDPOINT:

| Mark | GRIP Direction | Horiz. Distance | Height Difference | Mark | Direction | Horiz. Distance | Height Difference |
|------------|----------------|-----------------|-------------------|------------|------------------------------------|-----------------|-------------------|
| HAYSTACK | 34° 06' | 20.6 | above standpt | WELSH | 212° 47' | 11.6 | above standpt |
| KINGSTOWN | 67° 37' | 12.5 | below | TARRAGLY | 259° 14' | 31.2 | below |
| TARBUNDIE | 309° 26' | 22.5 | above standpt | GLEN BARRA | 148° 13' | 14.5 | above standpt |
| GLEN | 319° 10' | 29.3 | below | MENA | EXPANSIVE CLEARING ON EDGE OF SITE | | below |
| NANGARARRH | 344° 44' | 12.6 | below | BULLHEAD | MAY PROVIDE SIGN | | below |
| COMARA | 131° 16' | 21.0 | above standpt | | | | below |
| ROSENEATH | 168° 45' | 24.9 | below | | | | below |

Prepared by: **D.J. MANN** Checked: **[Signature]** Noted on U.T.M. Card

G

STATION PERA TS 7079

Owner's Name: PERA PASTORAL CO.
 Address: R. PRATTEN
"PERA"
VIA MANILLA
 Phone: 067 825384

Current Occupant: OWNER
 Address:
 Phone: BY WHEEL DRIVE

ACCESS

Access Report of 11/1/1988 was found suitable/unsuitable.
 NB. A KEY IS REQUIRED FROM OWNER FOR THIS ACCESS. A PHONE CALL IS NECESSARY
 0.00 AT P.O. BARRABA HEADING TOWARDS MANILLA. TURN LEFT AT 0.58 SP FROM
 MOUNTAIN. FOLLOW SIGNS TO CROW MOUNTAIN.
 27.12 PASS ROAD ON L.H.S SP "AVONDALE, COREENA"
 28.36 CROSS BRIDGE OVER CROW MTN CREEK THEN OVER GRID
 28.47 PASS ROAD TO MANILLA ON R.H.S.
 30.24 GRID # AT 30.94, 33.29, 34.59, 35.45, 36.09,
 36.36 TAKE LEFT FORK "SP LINTON" - RIGHT FORK TO "PERA" FOR KEY
 37.03 PASSING ROAD ON L.H.S THEN R.H.S - FOLLOW MAIN TRACK
 37.84 GRID # AT 41.02, #2.12
 43.12 TURN RIGHT "SP KINSTOWN"
 43.45 PASSING ROAD TO LINTON ON L.H.S
 46.55 GRID.
 48.67 TURN RIGHT ONT DIA TRACK.
 48.84 THRU LOCKED IRON GATE - FOLLOW TRACK - NB KEY FROM OWNER
 49.84 PASSING TRACK ON L.H.S THEN DIA ON R.H.S
 51.39 THRU DOUBLE IRON GATE # THEN THRU SINGLE IRON GATE
 51.44 VEER LEFT PASSING TRACK ON R.H.S WHICH FOLLOWS FENCE
 51.99 PASSING TRACK ON R.H.S AFTER PASSING THRU OLD FENCE LINE
 52.44 PASSING TRACK ON R.H.S
 52.89 AT PERA G.S.

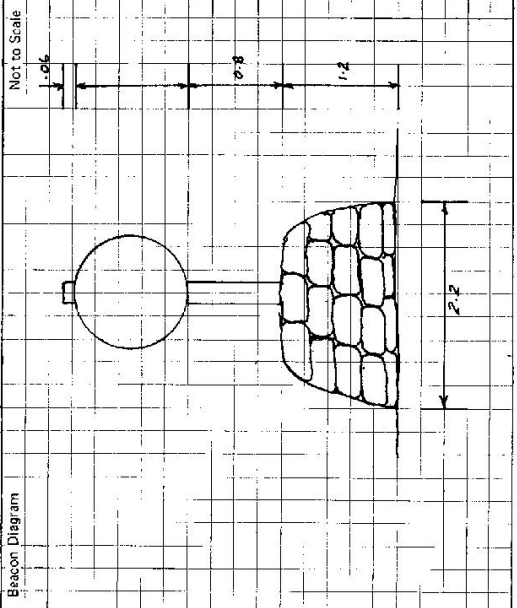

This section to be completed by officer constructing pillar.

Original station mark found/not found.

Description of mark:

Original beacon found/not found.

Description of beacon:

Height Top of Vanes to Top Mark.....m.

Height of mark.....m. above
 below G.L.

Diameter of Vanes.....m. Height of Cairn.....m.

Original Beacon has/not been destroyed by me.

| Date | Record of Station |
|---------|--|
| 16.4.82 | PERMISSION TO CLEAR # BUILD PILLAR FROM R. PRATTEN |
| | |
| | |

CENTRAL MAPPING AUTHORITY
 GEODETTIC SURVEY OF M.S.W.
 GEODETTIC STATION RECONNAISSANCE and MAINTENANCE REPORT

STATION: VELLA (P) No.: 7079
 MAP SHEET: MMA11A
 SCALE: 1:250 000
 INSPECTED BY: L. R. HOLLIS DATE: 13.9.1983
 AUTHORITY: CMA FIELD BOOK: 1450

Description:
 Note: Cross out word or words which do not apply

1. Cleared by lanes bearing 360° at Tail / 206° 500m LANE TO BULLHEAD from Trig. Mast (P) 270.
2. Mast & Vanes have been painted white & black respectively. ✓
3. The steel pillar was replaced / reconstructed on 17th Sept / 19.8.83, dimensions now being: Description of mark Steel Pillar Plate, Steel plug, Brass plug, Bolt, G.I. Pipe
 Height of mark 1.370 m. above rock / concrete; Mark is 1.520 m. above G.L.
 Height of Top Vanes to Top Steel / Pillar plate 1.435 m. Diameter of Vanes (vertical) 750 m.
 Height of Cairn 0 m. Diameter of Cairn 0 m. Name Plate found / not found / placed.
 Length of Mast 0 m. (approximate / not supplied)
4. A. SS Tail Pul set in conc / rock has been placed / found, bearing 320 M from Mark / Trig / Pillar
5. A. S.S.M set in conc / rock has been placed / found, bearing 347 M from Mast / Plug / Pillar
6. A. set in conc / rock has been placed / found, bearing 000 M from Mast / Plug / Pillar
7. A. set in conc / rock has been placed / found, bearing 000 M from Mast / Plug / Pillar
8. Action required: None

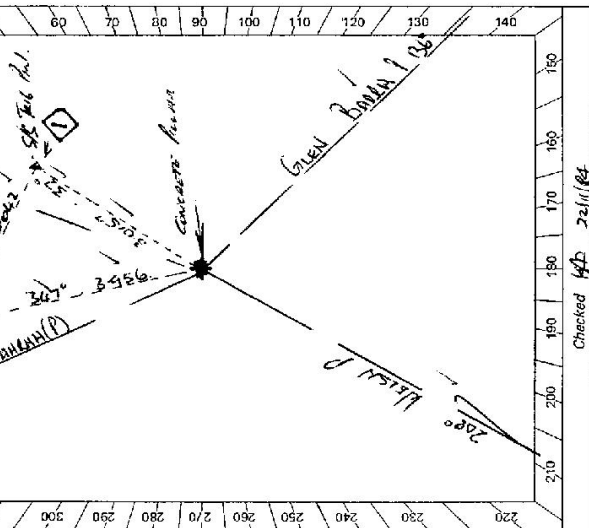

| Mark | Direction | Horiz. Distance | Height Difference | Mark | Direction | Horiz. Distance | Height Difference |
|-------------------------------|------------------|-----------------|-----------------------|-------------------------------|------------------|-----------------|-----------------------|
| <u>Steel Pillar Plate (P)</u> | <u>0 00 00</u> | | <u>above</u> standpt. | <u>Steel Pillar Plate (P)</u> | <u>0 00 00</u> | | <u>above</u> standpt. |
| <u>SS.M (P)</u> | <u>64 33 30</u> | | <u>above</u> standpt. | <u>SS.M (P)</u> | <u>64 31 55</u> | | <u>above</u> standpt. |
| <u>Haystack G.S.</u> | <u>146 30 30</u> | | <u>above</u> standpt. | <u>Haystack G.S.</u> | <u>79 57 00</u> | <u>3 015</u> | <u>above</u> standpt. |
| <u>Mast Plate</u> | <u>210 28 00</u> | <u>3 956</u> | <u>below</u> standpt. | <u>Mast Plate</u> | <u>161 32 35</u> | <u>3 042</u> | <u>below</u> standpt. |
| <u>Steel Plug</u> | <u>265 54 45</u> | | <u>above</u> standpt. | <u>Steel Plug</u> | <u>196 28 56</u> | | <u>above</u> standpt. |
| <u>Tail Pul</u> | <u>260 00 00</u> | <u>3 015</u> | <u>above</u> standpt. | <u>Tail Pul</u> | <u>245 54 15</u> | | <u>above</u> standpt. |

STANDPOINT: Steel Pillar Plate
 STANDPOINT: Steel Pillar Plate

Prepared by: S.H. Hollis
 Checked: Tail Pul 28/9/83 (Noted on U.T.M. Card)
 Checked 47 22/10/84

| | | |
|---|---|---------------------------|
| ST 2733-2 D. West, Government Printer Beacon Diagram | STATION PERA (P) IS 7079 Owner's Name: PERA Hospital Co Address: "PERA" Phone: 017 8253811 Current Occupant: PERA HOSPITAL Address: Phone: ACCESS Access Report of 12/9/1983 was found suitable/unsuitable. FERRARIE. BARBARA TO TRAVEL TOWARDS BUNGARA / TURN RIGHT SUB BUNGARA / LOW BRIDGE / LOADS REEF HAS LOW MOUNTAIN TO OLD BANK / TURN RIGHT SIDE KILISTOWN ST & OVER ROAD / HAS LUNDED. SPANISH BUNGARA 27 ON L.H.S. / HAS PERA & MUMUKA ON R.H.S. / TURN RIGHT OFF RD / THROUGH LOCKED I-GATE (CHA LOGIC) / THROUGH TOP SIDE (L.H.S) DOWN / ROAD GATE - STABLE AT ROAD / HAS PAINT ROAD ON R.H.S. / PERA G.S. ✓ | Date Record of Station |
| Not to Scale | This section to be completed by officer constructing pillar. Original station mark found/ reconstructed . Description of mark: SPANISH STEEL TALL PILL ✓ Original beacon found/ reconstructed . Description of beacon: CAIRN PILE & DISC ✓ Height Top of Vanes to Top Mark: 2.982 ✓ m. Height of mark: 0.53 ✓ m. above level conc 0.53 ✓ m. above G.L. Diameter of Vanes: 1.015 ✓ m. Height of Cairn: 1.42 ✓ m. Original Beacon has been been destroyed by me. ✓ | Date Record of Station |

CENTRAL MAPPING AUTHORITY

GEODETTIC SURVEY OF A.S.W.

GEODETTIC STATION RECONNAISSANCE and MAINTENANCE REPORT

Description:

1. Cleared by lanes bearing..... Note: *Cross out word or words which do not apply*..... from Trig, Mast
2. Mast & Vanes have been painted white & black respectively.
3. The station/pillar was unpiled/not unpiled/constructed on..... 19..... dimensions now being:

Description of mark..... should be explicit, e.g., S/Steel Pillar Plate, Steel plug, Brass plug, Bolt, G.I. Pipe

Height of mark..... m. ^{above} _{below} rock/concrete; Mark is..... m. ^{above} _{below} G.L.

Height of Top Vanes to Top Mark/Pillar plate..... m. Diameter of Vanes (vertical)..... m.

Height of Cairn..... m. Diameter of Cairn..... m. Name Plate found/not found/placed.

Length of Mast..... m. (approximate if not unpiled)

4. A..... set in conc/rock has been placed/found, bearing..... °M from Mast/Plug/Pillar
5. A..... set in conc/rock has been placed/found, bearing..... °M from Mast/Plug/Pillar
6. A..... set in conc/rock has been placed/found, bearing..... °M from Mast/Plug/Pillar
7. A..... set in conc/rock has been placed/found, bearing..... °M from Mast/Plug/Pillar

8. Action required.....

STANDPOINT:

STANDPOINT:

| Mark | Direction | Horiz. Distance | Height Difference | Mark | Direction | Horiz. Distance | Height Difference |
|------|-----------|-----------------|-------------------|------|-----------|-----------------|-------------------|
| | | | above standpt | | | | above standpt |
| | | | below standpt | | | | below standpt |
| | | | above standpt | | | | above standpt |
| | | | below standpt | | | | below standpt |
| | | | above standpt | | | | above standpt |
| | | | below standpt | | | | below standpt |
| | | | above standpt | | | | above standpt |
| | | | below standpt | | | | below standpt |
| | | | above standpt | | | | above standpt |
| | | | below standpt | | | | below standpt |
| | | | above standpt | | | | above standpt |
| | | | below standpt | | | | below standpt |

Prepared by: *[Signature]*

Checked by: *[Signature]*

Noted on U.T.M. Cont.

Checked

STATION: *PERA* No.: *7079*

MAP SHEETS SCALE 1:250 000 *MANILLA* SCALE 1:100 000

INSPECTED BY: *M. MORRISON* DATE: *1/5/88*

AUTHORITY: *CMA* FIELD BOOK: *1979*

Station Diagram

Not to Scale

