

CENTRAL MAPPING AUTHORITY  
Department of Lands

Trigonometrical Survey of N.S.W.

RECONNAISSANCE and MAINTENANCE REPORT

This Trig. Station has been:

Note: Cross out word or words which do not apply

1. ~~Completely cleared to permit 360° vision to surrounding Trig.~~
2. Cleared by limes bearing..... from Trig. Mast
3. Trig. Mast & Vanes have been painted white & black respectively.
4. The Trig. was unpiled/~~not supplied~~, dimensions now being:
  - Description of mark: ~~Brass Cartridge Case~~ for ~~Concrete~~ should be explicit, e.g. Steel plug, Brass plug, Bolt, G.I. Pipe
  - Height of mark..... 0.003 m <sup>above</sup> ~~below~~ concrete..... 0..... m <sup>above</sup> ~~below~~ G.L.
  - Height of Top Vanes to Top Mark, 3.292 m. ✓ Diameter of Vanes (vertical) 0.913 m.
  - Height of Cairn..... m. Diameter of Cairn..... m.

Length of Mast 3.295 m. (approximate if not unpiled)

5. A..... set in conc/rock has been placed..... m. bearing.....°M from Trig. Mast
6. ~~A. S.S.M.~~ set in conc/~~soil~~ has been placed <sup>found</sup> 2.100 m. bearing 39° ✓°M from Trig. Mast
7. A..... set in conc/soil has been placed..... m. bearing.....°M from Trig. Mast
8. A..... set in conc/rock has been placed..... m. bearing.....°M from Trig. Mast

9. Connection..... to..... m. bearing.....°M

10. Connection..... to..... m. bearing.....°M

11. Connection..... to..... m. bearing.....°M

12. Connection..... to..... m. bearing.....°M

13. Diff. Ht. S.S.M. in Concrete is 0.117 m. <sup>below</sup> ~~above~~ Cartridge Case in Concrete /

14. Diff. Ht. .... is..... m. <sup>above</sup> ~~below~~

15. Diff. Ht. .... is..... m. <sup>above</sup> ~~below~~

16. Diff. Ht. .... is..... m. <sup>above</sup> ~~below~~

Prepared by: H. P. JACKSON

Checked:

Noted on U.T.M. Card

STATION MANILLA 2460 7074

Co: Darling Ph: Veness

Map Sheet: MANILLA 1: 31 680 No: 9036

Inspected by: H. P. JACKSON Date: 4<sup>th</sup> APRIL 1977

Authority Geodetic Survey Div. C.M.A. Field Book: GEOMETRIK 137 AB 1553

Beacon Diagram

Not to Scale

Date 4/4/77 Record of Station

Station unpiled and left unpiled.

Checked



IS 7074  
No.: 2960

STATION: MANILLA  
MAP SHEET  
SCALE 1:250 000

INSPECTED BY: O. MOSS  
DATE: 23.3.82  
FIELD BOOK: 2000

MANILLA  
INSPECTED BY: O. MOSS  
DATE: 23.3.82  
FIELD BOOK: 2000

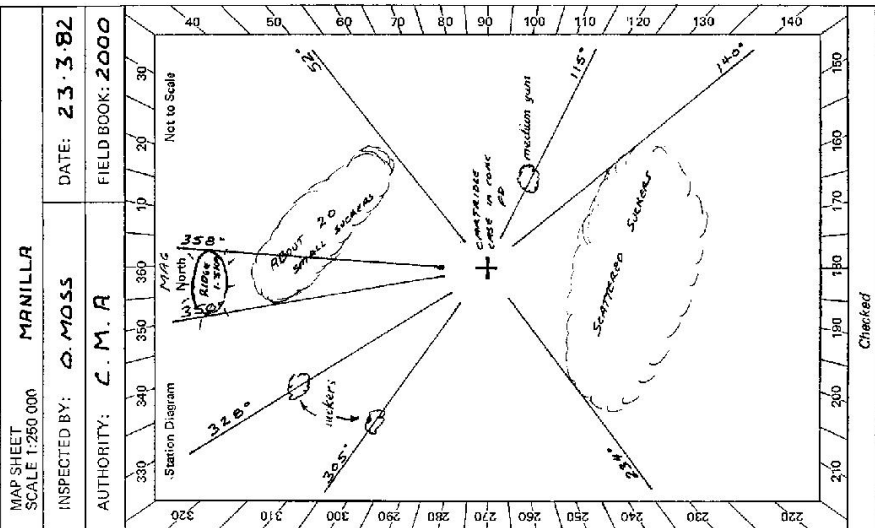

| Mark      | CR/D     | Direction | Horiz. Distance    | Height Difference | Mark     | Direction | Horiz. Distance     | Height Difference |
|-----------|----------|-----------|--------------------|-------------------|----------|-----------|---------------------|-------------------|
| BALDWIN   | 256° 31' | 7.6       | PREV above standpt | NEWRY             | 340° 44' | 26.6      | HILL below standpt  |                   |
| BOYD      | 271° 31' | 12.9      | STAY below         | WELSH             | 30° 20'  | 18.9      | GRASS above standpt |                   |
| TERRACE   | 323° 48' | 25.1      | "                  | STELLA            | 214° 30' | 14.9      | CLIFF below standpt |                   |
| FLEMING   | 48° 56'  | 7.4       | "                  | BUNLEHILL         | 119° 32' | 20.6      | HILL below standpt  |                   |
| ROSENEATH | 85° 25'  | 20.7      | "                  | BUBBULLIBAN       | 168° 11' | 18.2      | HILL below standpt  |                   |
| BROWNING  | 142° 25' | 14.1      | "                  | HOBDEN            | 311° 59' | 21.8      | HILL below standpt  |                   |
| SULEDA    | 148° 48' | 16.2      | "                  | WILSON            | 357° 17' | 24.6      | HILL below standpt  |                   |
| KLEAL     | 191° 56' | 19.1      | "                  |                   |          |           |                     |                   |

STANDPOINT: CONCRETE PILLAR 1-2 Poles 5.60m high  
 Prepared by: B. J. Moss Checked: 4/7/74  
 Noted on U.T.M. Card

Central Mapping Authority  
 GEODETIC SURVEY OF N.S.W.  
 GEODETIC STATION RECONNAISSANCE and MAINTENANCE REPORT  
 Description:  
 Note: Cross out word or words which do not apply  
 1. Cleared by lances bearing..... 52° 115' 120° 140' 234° 305° 328° 330° from Trig. Mast  
 11-4-41 G.R.S. 80 minutes clearing light clearing only. (Permission given)  
 2. Mast & Vanes have been painted white & black respectively.  
 3. The station/pillar was unpiled/re-erected/connected on..... 23.3.82..... 19....., dimensions now being:  
 Description of mark..... S.M.S.E..... should be explicit, e.g., S/Steel Pillar Plate, Steel plug, Brass plug, Bolt, G.I. Pipe  
 Height of mark..... m. above rock/concrete; Mark is..... m. above G.L.  
 Height of Top Vanes to Top Mark/Pillar plate..... m. Diameter of Vanes (vertical)..... m.  
 Height of Cairn..... m. Diameter of Cairn..... m. Name Plate found/not found/placed.  
 Length of Mast..... m. (approximate if not unpiled)  
 4. A..... S.M. set in conc/rock has been placed/removed, bearing..... 40° M from Mast/Plug/Pillar  
 5. A..... set in conc/rock has been placed/removed, bearing..... M from Mast/Plug/Pillar  
 6. A..... set in conc/rock has been placed/removed, bearing..... M from Mast/Plug/Pillar  
 7. A..... set in conc/rock has been placed/removed, bearing..... M from Mast/Plug/Pillar  
 8. Action required:..... CONCRETE PILLAR 1-2 Poles 5.60m high.....

STATION: MANILLA  
 MAP SHEET  
 SCALE 1:250 000  
 INSPECTED BY: O. MOSS  
 DATE: 23.3.82  
 FIELD BOOK: 2000  
 MANILLA  
 INSPECTED BY: O. MOSS  
 DATE: 23.3.82  
 FIELD BOOK: 2000

STATION: MANILLA  
 MAP SHEET  
 SCALE 1:250 000  
 INSPECTED BY: O. MOSS  
 DATE: 23.3.82  
 FIELD BOOK: 2000

|   |  |
|---|--|
| STATION<br><b>MANILLA IS 2460 7074</b>  | Owner's Name: <b>MA GYORGY</b><br>Address: <b>"MOUNT VIEW"</b><br><b>MANILLA</b><br>Phone: .....<br>Current Occupant: .....<br>Address: .....<br>Phone: .....<br><b>23-3-1982</b><br>ACCESS<br>AT R.O. MANILLA - HEAD NORTH TOWARDS BARRABA<br>CROSS NAMOI RIVER<br>FOLLOW ROAD TO BARRABA<br>PASS ROAD ON R.H.S.<br>TURN RIGHT ONTO DIRT TRACK & PASS OVER REMAINS OF OLD N'WAY<br>GO THRU DOUBLE IRON GATES "GYPSY PIGEON"<br>PASS OWNERS HOUSE ON RALS<br>GO THRU DOUBLE IRON GATES - TURN HARD RIGHT<br>TAKE LEFT FORK<br>GO THRU IRON GATE - PASS PENS ON R.H.S.<br>CROSS LEVEE BANK (CONCRETE WATER TOWER ON R.H.S. HEAD TOWARDS<br>OLD DOZER CUTTING & FOLLOW.<br>AT GRASSY PATCH FOLLOW CUTTING TO LEFT<br>TURN SHARP RIGHT - FOLLOW CUTTING & FENCE LINE<br>AT G.S. - 30sec walk around field |
| Beacon Diagram<br>Not to Scale<br>Contained   | Access Report of <b>Manilla</b> <b>19</b> <b>was found suitable for construction.</b><br>0.00 AT R.O. MANILLA - HEAD NORTH TOWARDS BARRABA<br>0.62 CROSS NAMOI RIVER<br>1.35 FOLLOW ROAD TO BARRABA<br>1.91 PASS ROAD ON R.H.S.<br>4.40 TURN RIGHT ONTO DIRT TRACK & PASS OVER REMAINS OF OLD N'WAY<br>4.49 GO THRU DOUBLE IRON GATES "GYPSY PIGEON"<br>4.6 PASS OWNERS HOUSE ON RALS<br>4.69 GO THRU DOUBLE IRON GATES - TURN HARD RIGHT<br>4.98 TAKE LEFT FORK<br>5.34 GO THRU IRON GATE - PASS PENS ON R.H.S.<br>5.58 CROSS LEVEE BANK (CONCRETE WATER TOWER ON R.H.S. HEAD TOWARDS<br>OLD DOZER CUTTING & FOLLOW.<br>6.38 AT GRASSY PATCH FOLLOW CUTTING TO LEFT<br>6.96 TURN SHARP RIGHT - FOLLOW CUTTING & FENCE LINE<br>7.82 AT G.S. - 30sec walk around field                                  |
| This section to be completed by officer constructing pillar.<br>Original station mark found/not found.<br>Description of mark: .....<br>Original beacon found/not found.<br>Description of beacon: .....<br>Height Top of Vanes to Top Mark .....m.<br>Height of mark .....m. above G.L.<br>below<br>Diameter of Vanes .....m. Height of Cairn .....m.<br>Original Beacon has/has not been destroyed by ma. | Date<br><b>23.3.82</b><br>Record of Station<br>REVISION TO STATION FROM <b>MRS GYORGY (old to P. Barry)</b>  |

CENTRAL MAPPING AUTHORITY

GEODETTIC SURVEY OF N.S.W.

GEODETTIC STATION RECONNAISSANCE and MAINTENANCE REPORT

- Description:  
 Cleared by lanes bearing  $360^\circ$  / Note: Cross out word or words which do not apply from Trig. Mast
- Mast & Vanes have been painted white & black respectively.
  - The station/pillar was ~~replaced~~ / constructed on 2nd SEPT 1983, dimensions now being: Description of mark S.S.P. in Conc. (A) should be explicit, e.g., S/Steel Pillar Plate, Steel plug, Brass plug, Bolt, G.I. Pipe
  - Height of mark 1.380 m. above ~~rock/concrete~~ / Mark is 2.030 m. above G.L.
  - Height of Top Vanes to Top ~~Mast~~ / Pillar plate 1.419 m. Diameter of Vanes (vertical) 0.148 m.
  - Height of Cairn 0 m. Diameter of Cairn 0 m. Name Plate ~~found~~ / ~~not found~~ / placed.
  - Length of Mast 0 m. (approximate if not unplied)
  - A S.S.H. set in conc ~~rock~~ has been placed / found, bearing 20 M from Mast / Plug / Pillar
  - A CARRIAGE CASE set in conc ~~rock~~ has been placed / found, bearing 11 M from Mast / Plug / Pillar
  - A set in conc / rock has been placed / found, bearing 0 M from Mast / Plug / Pillar
  - A set in conc / rock has been placed / found, bearing 0 M from Mast / Plug / Pillar

Action required: .....

| STANDPOINT: SIS PILLAR PLATE |           |                 |                      | STANDPOINT: CARRIAGE CASE |           |                 |                      |
|------------------------------|-----------|-----------------|----------------------|---------------------------|-----------|-----------------|----------------------|
| Mark                         | Direction | Horiz. Distance | Height Difference    | Mark                      | Direction | Horiz. Distance | Height Difference    |
| BALDAH CS (A)                | 0 00 00   |                 | above standpt.       | BALDAH CS (A)             | 0 00 00   |                 | above standpt.       |
| BALDAH CS (A)                | 34 59 05  |                 | above standpt.       | BORAH CS (A)              | 34 59 25  |                 | above standpt.       |
| CARRIAGE CASE                | 124 42 45 | 4.217           | 1.954 above standpt. | FLEMING CS (A)            | 152 26 25 |                 | above standpt.       |
| S.S.M.                       | 133 52 46 | 6.153           | 2.075 above standpt. | S.S.M.                    | 152 30 00 | 2.101           | 0.119 above standpt. |
| FLEMING CS (A)               | 152 24 05 |                 | above standpt.       | KLORU CS (A)              | 295 25 20 |                 | above standpt.       |
| KLORU CS (A)                 | 295 23 25 |                 | above standpt.       | S PILLAR PLATE            | 304 46 20 | 4.217           | 1.954 above standpt. |
|                              |           |                 | above standpt.       |                           |           |                 | below standpt.       |

Prepared by: [Signature] Checked: [Signature] Noted on U.T.M. Card

S-2733-1

STATION: MANILLA C.S. (P) No: 7074  
 MAP SHEET SCALE 1:250 000  
 INSPECTED BY: L.HITCHINS DATE: 5.9.83  
 AUTHORITY: C.M.A. FIELD BOOK: 1821

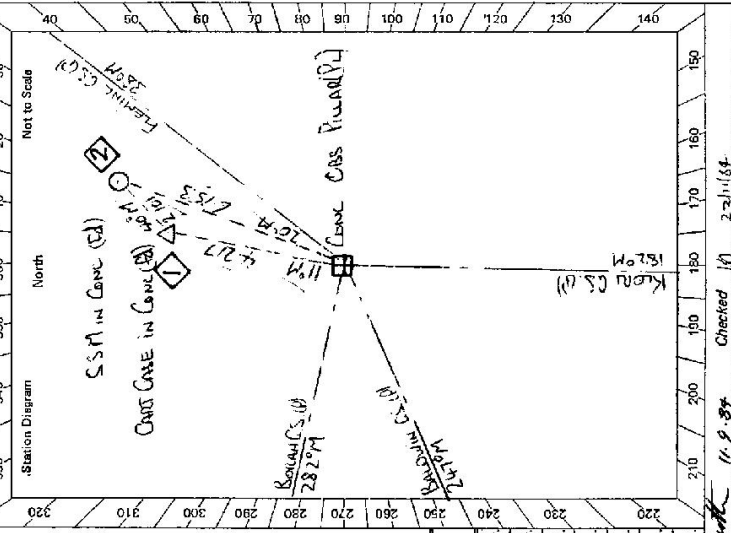

Checked: [Signature] 23/11/84

STATION **MANILLA C.S. (P) TS 7074**

Owner's Name: **Mr. GYONGY**  
 Address: **MOON VIENT MANILLA**  
 Phone: **ACCESS 5-9-83**

Current Occupant:  
 Address:  
 Phone:  
 ACCESS 5-9-83

Access Report of **23/1/1981** was found suitable for construction  
 AT MANILLA PD HEAD NORTH TOWARDS BARRABA.  
 0-00 CROSS NAMEI RIVER  
 1-35 FOLLOW ROAD TO BARRABA.  
 1-91 PASS ROAD ON R.H.S.  
 4-40 TURN RIGHT ONTO DIRT TRACK AND PASS OVER OLD HIGHWAY.  
 4-49 THROUGH DOUBLE IRON GATES "CYPRESS FERRY".  
 4-60 PASS OWNERS HOUSE ON RIGHT.  
 4-69 THROUGH DOUBLE IRON GATES THEN TURN HARD RIGHT.  
 4-98 TAKE LEFT FORK.  
 5-34 CROSS CONTOUR BANK (CONCRETE TANK ON RIGHT)  
 5-58 HEAD UP OLD DIRT CUTTING.  
 6-38 FOLLOW CUTTING TO LEFT AT GRASSY PATCH.  
 6-96 TURN SHARP RIGHT FOLLOW CUTTING AND FENCE LINE.  
 7-82 STOP TRACK PILLAR 1 MIN WALK ACROSS ROCKS.

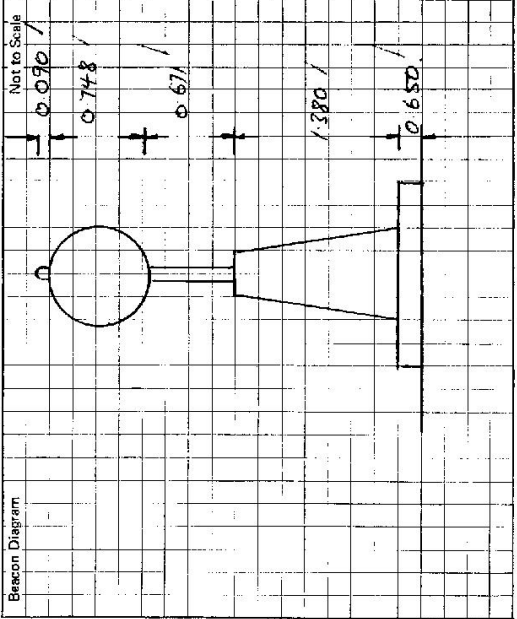

This section to be completed by officer constructing pillar.

Original station mark found ~~was found~~.  
 Description of mark: **CANTONCE CASE IN CONCRETE**  
 Original beacon found ~~was found~~.  
 Description of beacon: **UNPAVED CAIRN - MIST TOWER**  
 Height Top of Vanes to Top Mark: **32.95** m.  
 Height of mark **0.005** m. above rock/conc. **AT** ~~below~~ ~~below~~ G.L.  
 Diameter of Vanes **0.910** m. Height of Cairn ~~was found~~ m.  
 Original Beacon has ~~was found~~ been destroyed by me.

Date  
 Record of Station