

STATION: **BULLHEAD**
 MAP SHEET
 SCALE 1:250 000
 INSPECTED BY: **O. MOSS**
 AUTHORITY: **C.M.A** 5-5/11/832
 DATE: **16.4.82**
 FIELD BOOK: **2000**

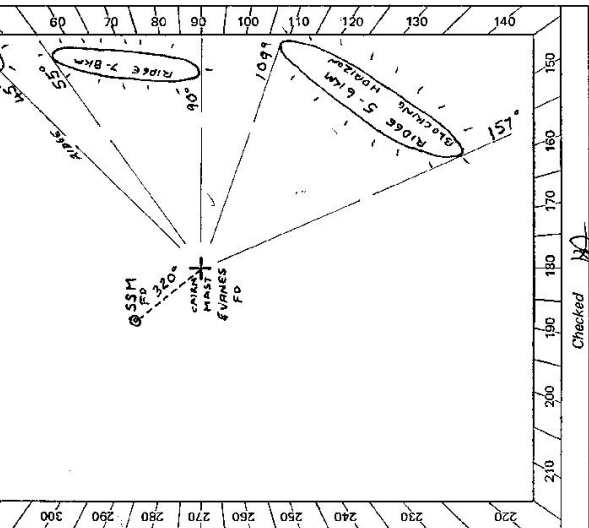
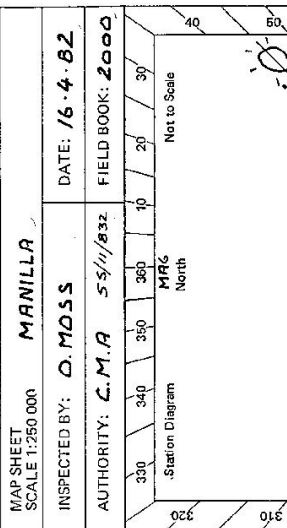

CENTRAL MAPPING AUTHORITY
 GEODETIC SURVEY OF N.S.W.
 GEODETIC STATION RECONNAISSANCE and MAINTENANCE REPORT

- Description: *Note: Cross out word or words which do not apply*
- Cleared by lanes bearing **360°** from Trig. Mast
 - Mast & Vanes have been painted **white & black** respectively.
 - The station/pillar was **unpiled/not unpiled/constructed on 16 APRIL 1982**, dimensions now being: Description of mark should be explicit, e.g., S/Steel Pillar Plate, Steel plug, Brass plug, Bolt, G.I. Pipe
 Height of mark **1.3** m. above rock/concrete; Mark is **1.0** m. above G.L.
 Height of Top Vanes to Top Mark/Pillar plate **1.0** m. Diameter of Vanes (vertical) **1.0** m.
 Height of Cairn **1.3** m. Diameter of Cairn **2.0** m. Name Plate found/~~not found~~/placed.
 - Length of Mast **3.2** m. (approximate if not unpiled)
 - A **SSM** set in conc/feek has been placed/found, bearing **320°** M from Mast/Plug/Pillar
 - A set in conc/rock has been placed/found, bearing **191° 48'** M from Mast/Plug/Pillar
 - A set in conc/rock has been placed/found, bearing **251° 50'** M from Mast/Plug/Pillar
 - A set in conc/rock has been placed/found, bearing **119° 32'** M from Mast/Plug/Pillar
 - Action required: **CONSTRUCT CONCRETE PILLAR**

STANDPOINT:		STANDPOINT:		STANDPOINT:		STANDPOINT:	
Mark	GRVD Direction	Horiz. Distance	Height Difference	Mark	Direction	Horiz. Distance	Height Difference
IRONBARK	356° 59'	24.2	1.1 above standpt	FLEMING	180° 11'	22.1	1.1 above standpt
TIRABUNDE	331° 26'	15.1	" above standpt	MANILLA	191° 48'	27.5	1.1 below standpt
NANGARRAH	31° 20'	13.2	" above standpt	TIPARPOLY	251° 50'	21.5	1.1 below standpt
NEWAY	262° 50'	14.5	" above standpt	BARBARA	314° 55'	22.7	" above standpt
WILSON	207° 00'	13.9	" above standpt	HOBDEN	330° 38'	27.1	1.1 above standpt
BORRH	218° 21'	28.4	" above standpt	GLEN	337° 11'	23.1	1.1 above standpt
WELSH	159° 48'	11.3	" above standpt	COMBAR	119° 32'	29.8	1.1 above standpt
				PEAR	94° 57'	10.2	1.1 below standpt

Prepared by: **O. J. Moss**
 Checked: **[Signature]**
 Noted on U.T.M. Card **[Signature]**

St 2735-2 D. West, Government Printer

STATION **BULLHEAD** **7064**

Owner's Name: **M.R. & M.J. THOMPSON**
 Current Occupant: **OWNER**
 Address: **"WAIRUNA"**
MARILLA
 Phone: **(0677) 825324**

ACCESS

Access Report of **16/4/1982** was found suitable/unsuitable.
0.00 AT BARRABA RD HEADING SOUTH TOWARDS MARILLA
8.58 TURN LEFT SP "CROW MOUNTAIN 19" PASSING ROADS TO "TRERTY" (RHS),
"WOODS REEF" (LHS) & "BLACK MOUNTAIN" (RHS)
27.12 PASS ROAD ON LHS SP "PUNDABLE, COALEENA"
28.36 CROSS BRIDGE OVER CROW MTN CREEK - TURN LEFT BEFORE GRID.
28.51 AT INTK OF TRACKS FOLLOW TRACK TO "WAIRUNA" SP
28.71 THRU IRON GATE "WAIRUNA"
28.98 TURN RIGHT (OWNERS HOUSE STRAIGHT AHEAD)
29.00 THRU IRON GATE
29.12 THRU DOUBLE IRON GATES & THEN THRU YARDS TO IRON GATE.
29.21 PASS TRACK TO COTTAGE ON LHS
29.44 TAKE LEFT FORK
29.53 THRU IRON GATE
29.96 THRU IRON GATE
30.08 CROSS GULLY & AT 30.62
31.04 THRU WOODEN GATE
31.32 PASSING UNDER POWER LINES
31.51 TURN RIGHT OFF TRACK & MAKE OWN WAY UP SPUR TO TOP OF
RIDGE. FOLLOW RIDGE UP TO G.S. AT 31.70.
NOTE: A LESS STEEP ASSENT CAN BE FOUND BY PROCEEDING ALONG
TRACK TO NEXT SPUR.

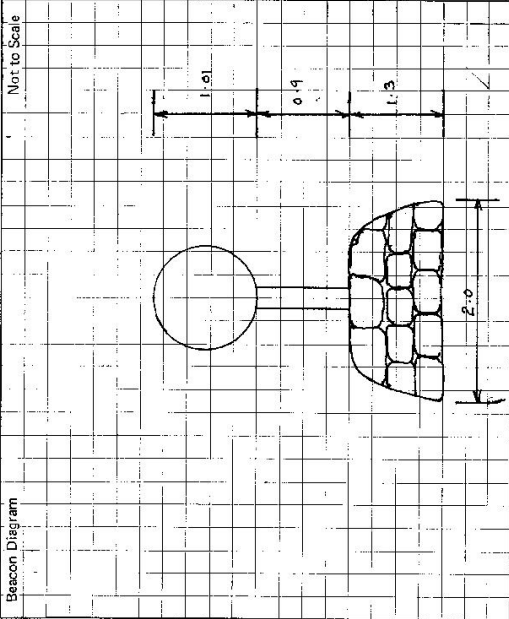

This section to be completed by officer constructing pillar.

Original station mark found/not found.

Description of mark:

Original beacon found/not found.

Description of beacon:

Height Top of Vanes to Top Markm.

Height of markm. above G.L.
 below G.L.

Diameter of Vanesm. Height of Cairnm.

Original Beacon has/has not been destroyed by me.

Date	Record of Station
16.4.82	PERMISSION TO BULLHEAD SPARKLE PLAKA

CENTRAL MAPPING AUTHORITY

GEODETIC SURVEY OF N.S.W.

GEODETIC STATION RECONNAISSANCE and MAINTENANCE REPORT

Description:

- Note: Cross out word or words which do not apply
1. Cleared by lanes bearing..... 360°..... from Trig. Mast
 2. Mast & Vanes have been painted white & black respectively. ✓
 3. The ~~section~~/pillar was ~~unplaced~~/constructed on..... 14..... 7..... 19..... 8.3 dimensions now being: Description of mark. PLUG..... should be explicit, e.g. S/Steel Pillar Plate, Steel plug, Brass plug, Bolt, G.I. Pipe
Height of mark..... 1.380..... m. above ~~concrete~~/concrete; Mark is 1530..... m. above G.L. ✓
Height of Top Vanes to Top ~~Mast~~/Pillar plate..... 137.5..... m. Diameter of Vanes (vertical)..... 750..... m. ✓
Height of Cairn..... m. Diameter of Cairn..... m. Name Plate ~~found~~/not found/placed. ✓
Length of Mast..... m. (~~approximate~~)
4. A SPANLESS STEEL TUBE Pillar..... set in conc/~~concrete~~/found, bearing..... 171°M from ~~Mast~~/Mast/Pillar
5. A SSM..... set in conc/~~concrete~~/found, bearing..... 342.8°M from ~~Mast~~/Mast/Pillar
6. A..... set in conc/rock has been placed/found, bearing..... °M from Mast/Plug/Pillar
7. A..... set in conc/rock has been placed/found, bearing..... °M from Mast/Plug/Pillar
8. Action required:.....

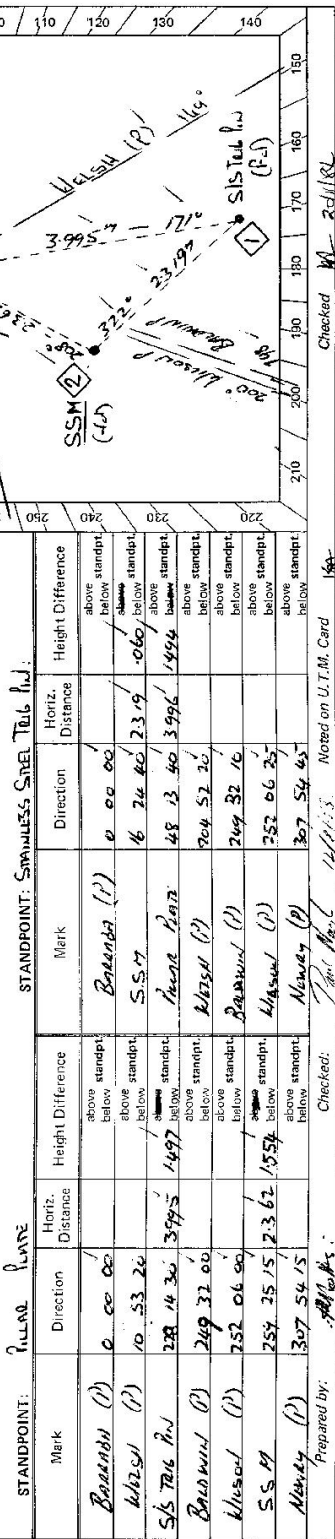

STANDPOINT: PILLAR PLATE		STANDPOINT: SPANLESS STEEL TUBE	
Mark	Direction	Horiz. Distance	Height Difference
BARBARA (P)	0 00 00	0 00 00	above standpt.
KUSSEL (P)	10 53 26	16 24 40	below standpt.
SSM TUBE PLUG	238 14 36	3995	below standpt.
BARBARA (P)	249 32 06	48 13 40	above standpt.
KUSSEL (P)	252 06 00	204 52 26	below standpt.
SSM	254 25 15	249 32 10	above standpt.
NEWBY (P)	307 54 15	252 06 25	below standpt.
		307 54 65	above standpt.

Prepared by: SM/MS Checked: MS/MS Noted on U.T.M. Card 14/11/13

St 2733-2 D. West, Government Printer

Beacon Diagram

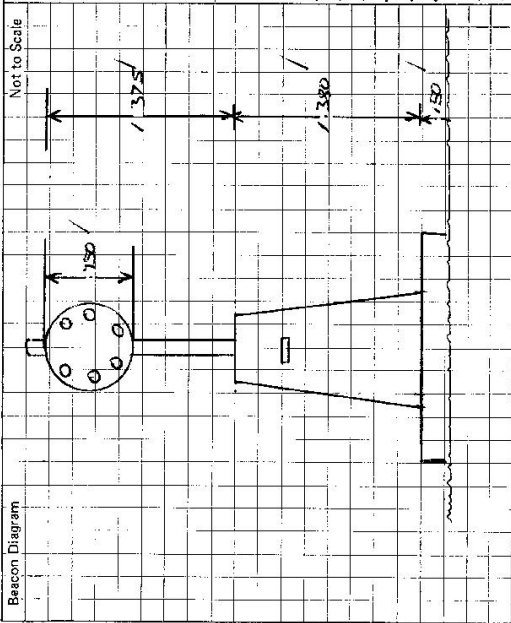

This section to be completed by officer constructing pillar.

Original station mark found/~~not found~~

Description of mark: *Spherical, 5.75m. Tall. Pin!*

Original beacon found/~~not found~~

Description of beacon: *Conical box & disc!*

Height Top of Vanes to Top Mark *3.075* m

Height of mark *0.25* m above ~~mark~~ *0.25* m above G.L. ~~below~~

Diameter of Vanes *1.00* m Height of Cairn *1.20* m

Original Beacon has ~~been~~ been destroyed by me. ✓

STATION *BULLHOUND (P) 7064*

Owner's Name: *M. H. & M. J. Thompson*
 Address: *"Kilnwood" / "Mansfield"*
 Phone: *01672 877524*

Current Occupant: *(owner)*
 Address:
 Phone:

ACCESS

Access Report of *16/7/1983* was found suitable/unavailable.

FEATURES
 0000 BARBARA P.O. HIND TOWNARDS MANILLA /
 858 TURN LEFT SIGN CROSS MTS 14th, PASSING BARRS /
 TO TURN (R.H.S) WOODSARE (L.H.S) & BULL HND (R.H.S)
 27-17 PASS LEAD TO L.H.S TO "WINDMILL", "GARDEN" /
 28-36 CROSS BARRS OVER LEAD MTS CAKE. TURN LEFT BREAK GRD. /
 28-51 AT 14th on TRACKS FOLLOW TO "DUNDASH" ST /
 28-71 TURN LEFT SW "WINDMILL" /
 28-98 OWNERS HOUSE AND L.H.S /
 29-00 TURN LEFT /
 29-12 AT WARD THROUGH D-WOODS BARRS & WINDMILL THROUGH TO TURN LEFT /
 29-21 PASS TRACK TO COTTAGE AND L.H.S. /
 29-44 TAKE L.H. FORD. / THROUGH TURN LEFT /
 29-48 THROUGH TURN LEFT; TURN RIGHT ALONG FENCE. ✓
 30-00 PASS TURN LEFT AND L.H.S. /
 30-56 TURN LEFT (JUST BEFORE BARRS) HEAD UP STREET SHUT FENCE, 1.6
 TRACKS.
 31-44 TURN LEFT AT FENCE & FOLLOW TO TAIL ✓
 32-00 BULLHOUND L.S. ✓

Date

Record of Station