

CENTRAL MAPPING AUTHORITY

GEODETIC SURVEY OF N.S.W.
 GEODETIC STATION RECONNAISSANCE and MAINTENANCE REPORT

Description: 3.C.C.C. Note: Cross out word or words which do not apply

- Cleared by lanes bearing..... from Trig, Mast
- Mast & Vanes have been painted white & black respectively.
- The station/~~pillar~~ ~~was supplied/not unpiled/constructed on~~ 2.4 x 3.1 m, dimensions now being: SMALL PILE OF 5 STONES FOUND Description of mark..... should be explicit, e.g., S/Steel Pillar Plate, Steel plug, Brass plug, Bolt, G.I. Pipe Height of mark.....m. ^{above} _{below} rock/concrete; Mark is.....m. ^{above} _{below} G.L.
- Height of Top Vanes to Top Mark/Pillar platem. Diameter of Vanes (vertical).....m.
- Height of Cairn.....m. Diameter of Cairn.....m. Name Plate found/not found/placed.
- Length of Mastm. (approximate if not unpiled)
- A.....set in conc/rock has been placed/found, bearing.....°M from Mast/Plug/Pillar
- A.....set in conc/rock has been placed/found, bearing.....°M from Mast/Plug/Pillar
- A.....set in conc/rock has been placed/found, bearing.....°M from Mast/Plug/Pillar
- A.....set in conc/rock has been placed/found, bearing.....°M from Mast/Plug/Pillar
- Action required: OK TO BUILD CONC PILLAR

STANDPOINT:

Mark	Direction	Horiz. Distance	Height Difference	Mark	Direction	Horiz. Distance	Height Difference
			above standpt.				above standpt.
			below standpt.				below standpt.
			above standpt.				above standpt.
			below standpt.				below standpt.
			above standpt.				above standpt.
			below standpt.				below standpt.
			above standpt.				above standpt.
			below standpt.				below standpt.
			above standpt.				above standpt.
			below standpt.				below standpt.

Prepared by: [Signature] 13/10/95

Checked: [Signature]

Noted on U.T.M. Card

S. 2733-1

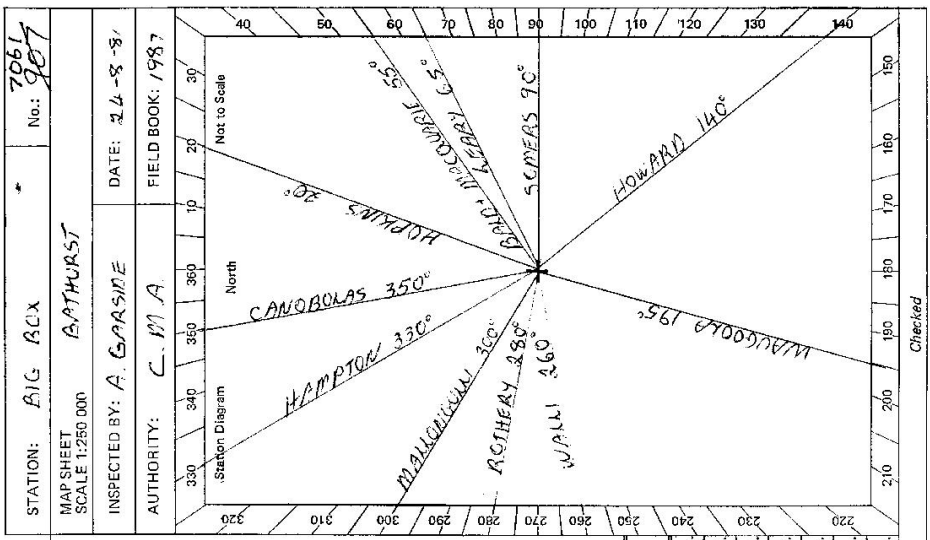

STATION: BIG ACX No.: 7061
 MAP SHEET SCALE 1:250 000 BATHURST
 INSPECTED BY: A. GAASIDE DATE: 24-5-87
 AUTHORITY: C.M.A. FIELD BOOK: 1987

St 2735-2 D. West, Government Printer

Beacon Diagram 	STATION A/G ACX * 7061 Owner's Name: <u>M.A. R. MANAGER</u> Address: <u>ROCKWELL</u> Phone: <u>65 2339</u>	Current Occupant: <u>M.A. D. HINES</u> Address: <u>ROCKWELL</u> Phone: <u>LYNDHURST</u> <u>CARLANO 32</u>	ACCESS Access Report of <u>21.8.1981</u> was found <u>not to be</u> <u>marked</u> K/M Footnote 0/0 LYNDHURST PO TAKE ROAD ON RIGHT TO MID WESTERN HIGHWAY 0 45 TURN LEFT ONTO MAIN, TRAVELLING SOUTH. 4 5 PASS "DONLOP" MARSHED ON LEFT 5 0 TURN LEFT ONTO GRAVEL ROAD OPPOSITE DUNE TREES 7 1 TAKE TRACK TO RIGHT 7 75 IRON GATE 9 1 IRON GATE "ROCKWELL" 9 55 IRON GATE 9 65 MANAGERS HOUSE ON RIGHT 9 9 THROUGH IRON GATE ON LEFT 10 25 IRON GATE 10 5 PASS IRON GATE ON RIGHT 10 55 IRON GATE 10 85 IRON GATE TAKE CAMPT TRACKS TO RIGHT (AROUND WET PATCH) 11 25 THROUGH RH IRON GATE 11 4 IRON GATE. HERE LEFT UP HILL KEEPING COURSE BANKS ON RIGHT. FOLLOW ANIMAL TRACKS 11 9 TURN RIGHT ALONG FENCE 12 05 IRON GATE MAKE OWN WAY TO TOP OF HILL 12 45 BIG BOX 6.5 (SMALL PILE OF STONES)
This section to be completed by officer constructing pillar. Original station mark found/not found. Description of mark: Original beacon found/not found. Description of beacon: Height Top of Vanes to Top Mark.....m. Height of mark.....m. above G.L. below Diameter of Vanesm. Height of Cairnm. Original Beacon has/has not been destroyed by me.		Date Record of Station	

GEODETTIC SURVEY OF N.S.W.

CENTRAL MAPPING AUTHORITY

GEODETTIC STATION RECONNAISSANCE and MAINTENANCE REPORT

Description:

Cleared by lanes bearing 360° Note: Cross out word or words which do not apply

1. Mast & Vanes have been painted white & black respectively. ✓

2. The station/pillar was ~~unpainted~~ constructed on $1-7-1983$, dimensions now being: 19.83 m. ~~Steel plate, Brass plate, Bolt, G.I. pipe~~

3. Description of mark: ~~S/S PILLAR~~ ~~PLATE~~ should be explicit, e.g., S/Steel Pillar Plate, ~~Steel plate, Brass plate, Bolt, G.I. pipe~~
 Height of mark: 1.375 m. ^{above rock/concrete} Mark is 1.475 m. ^{above G.L.}

Height of Top Vanes to Top Mark/Pillar plate: 1.425 m. Diameter of Vanes (vertical): 0.75 m.
 Height of Cairn: m. Diameter of Cairn: m. Name Plate ~~found/lost/erased/placed~~.

Length of Mast m. (approximate if not implied)

4. A. ~~Drill Hole in Rock~~ set in ~~conc/rock~~ has been ~~placed~~/found, bearing 207° M from ~~Mast/Plug/Pillar~~

5. A. ~~Copper Nail~~ set in ~~conc/rock~~ has been placed/~~found~~, bearing 355° M from ~~Mast/Plug/Pillar~~

6. A. ~~G.I. Pipe~~ set in ~~conc/rock~~ has been placed/~~found~~, bearing 142° M from ~~Mast/Plug/Pillar~~

7. A. set in ~~conc/rock~~ has been placed/~~found~~, bearing M from ~~Mast/Plug/Pillar~~

8. Action required:

STATION: **BIG BOX PI** No: **7061**
 MAP SHEET SCALE 1:250 000 **BATHURST**
 INSPECTED BY: **G. FORD** DATE: **14/7/83**
 AUTHORITY: **C. M. A.** FIELD BOOK: **1945**

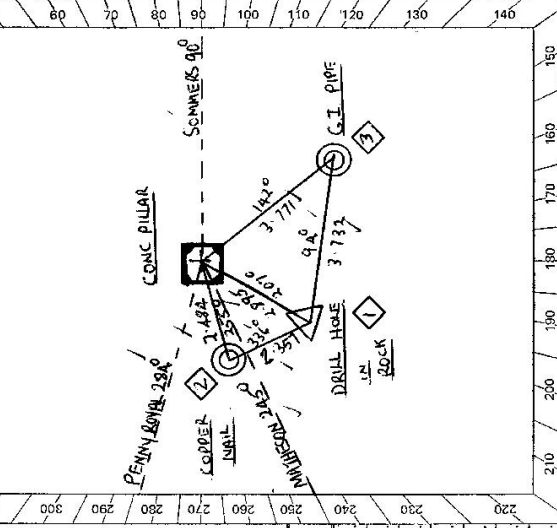

STANDPOINT: CONC PILLAR				STANDPOINT: DRILL HOLE IN ROCK			
Mark	Direction	Horiz. Distance	Height Difference	Mark	Direction	Horiz. Distance	Height Difference
MATHESON (PI)	0 00 00		above standpt.	MATHESON (PI)	0 00 00		above standpt.
COPPER NAIL	11 16 20	2.484	1.534	PENNY ROYAL (PI)	37 12 00		above standpt.
SOMMEKES (PI)	203 32 40		above standpt.	COPPER NAIL	84 36 00	2.357	0.394
G. I. PIPE	253 24 00	3.771	1.381	CONC PILLAR	139 59 30	2.893	1.919
DRILL HOLE IN ROCK	320 00 20	2.897	1.915	SOMMEKES (PI)	203 31 50		above standpt.
			below	G. I. PIPE	208 01 30	3.732	0.538
			below				below

Prepared by: *G Ford*

Checked: *Notes on U.T.M. Card*

8-2733-1

GS 24

STATION **BIG BOX (P) 7061**

Owner's Name: **MR. R. MILLNER**
 Address: **"ROSEDALE"**
 Phone: **68 2329**

Contact: **MR. D. HINES**
 Address: **"ROCKDELL"**
 Phone: **GARLAND 32**

ACCESS

Access Report of 21.8.19. was found suitable for installation.
 0.0 LYNDRUST PO TAKE ROAD ON RIGHT TO MID WESTERN HWY /
 0.45 TURN LEFT ONTO MAIN, TRAVELLING SOUTH /
 4.5 PASS "DUNKOP" HAYSHED ON LEFT. /
 5.0 TURN LEFT ONTO GRAVEL ROAD OPPOSITE PINE TREES /
 7.1 TAKE TRACK TO RIGHT /
 7.75 IRON GATE /
 9.1 IRON GATE "ROCK DELL" /
 9.55 IRON GATE /
 9.65 MANAGERS HOUSE ON RIGHT /
 9.8 THROUGH IRON GATE ON LEFT (MANAGERS HOUSE STRAIGHT AHEAD) /
 10.25 IRON GATE /
 10.5 PASS IRON GATE ON RIGHT /
 10.55 IRON GATE TAKE PAINT TRACKS TO RIGHT /
 10.85 IRON GATE /
 11.25 THROUGH R.H. IRON GATE /
 11.4 (IRON GATE) (COLD BE TAKEN DOWN HEAD LEFT UP HILL KEEPING CONTOUR /
 BANKS ON RIGHT FOLLOW ANIMAL TRACKS /
 11.9 TURN RIGHT ALONG FENCE /
 12.05 IRON GATE MAKE OWN WAY TO TOP OF HILL /
 12.45 BIG BOX G.S. /

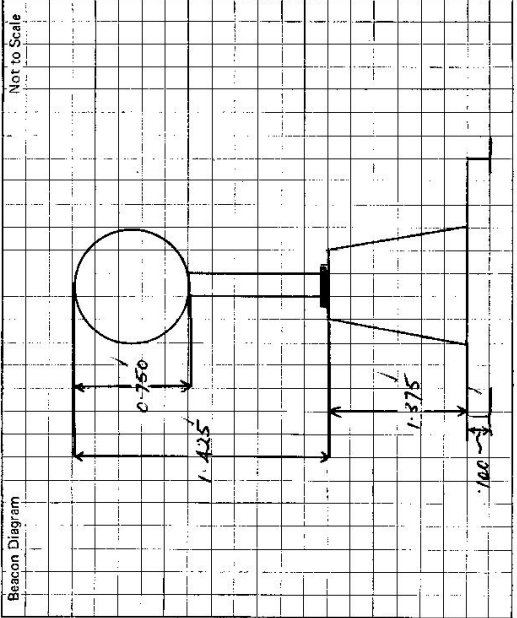

This section to be completed by officer constructing pillar.

Original station mark found/~~not~~ found.

Description of mark: **DRILL HOLE IN ROCK**

Original beacon found/~~not~~ found.

Description of beacon:

Height Top of Vanes to Top Mark:m.

Height of mark: **above** rock/conc. **1.405** m. **above** G.L. **below**

Diameter of Vanes:m. Height of Cairn:m.

Original Beacon has/~~not~~ been destroyed by me.

Date	Record of Station