

GEODETTIC SURVEY OF N.S.M.

CENTRAL MAPPING AUTHORITY

GEODETTIC STATION RECONNAISSANCE and MAINTENANCE REPORT

Description:

1. Cleared by lanes bearing 260° with ~~SCAFFOLD~~ ~~TRIPES~~ ~~TRIPES~~ from Trig. Mast
 Note: Cross out word or words which do not apply

2. Mast & Vanes have been painted white & black respectively.

3. The station/pillar was unpiled/net unpiled/constructed on $19.12.1980$, dimensions now being:

Description of mark S/S ~~TRIG. PIN~~ should be explicit, e.g., S/Steel Pillar Plate, Steel plug, Brass plug, Bolt, G.I. Pipe

Height of mark 0.18 m ^{above rock/concrete} Mark is ~~AT~~ ~~above~~ ~~below~~ G.L.

Height of Top Vanes to Top ~~Mark/Pillar plate~~ 4.219 m. Diameter of Vanes (vertical) 1.009 m.

Height of Cairn 0.455 m. Diameter of Cairn 0.532 m. Name Plate ~~found/lost/removed~~ placed.

Length of Mast 4.247 m. (approximate if not unpiled)

4. A. $S.S.M. No. 1605$ set in conc/rock has been ~~placed~~ found, bearing 114° M from Mast/~~Plug/Pillar~~

5. A. ~~COPPER NAIL~~ set in conc/rock has been placed ~~found~~, bearing 15° M from Mast/~~Plug/Pillar~~

6. A. set in conc/rock has been placed found, bearing $^\circ$ M from Mast/~~Plug/Pillar~~

7. A. set in conc/rock has been placed found, bearing $^\circ$ M from Mast/~~Plug/Pillar~~

8. Action required: ~~POSSIBLE TO PILLAR~~

STANDPOINT: ~~STAINLESS STEEL TRIG. PIN~~ STANDPOINT: $S.S.M. No. 1605$

| Mark | Direction | Horiz. Distance | Height Difference | Mark | Direction | Horiz. Distance | Height Difference |
|-----------------|----------------------|-----------------|-------------------|---------------|----------------------|-----------------|-------------------|
| TULLUMBA GS | $000^\circ 00'$ | | above standpt. | TULLUMBA GS | $000^\circ 00'$ | | above standpt. |
| MILL GS | $56^\circ 39' 20''$ | | above standpt. | MILL GS | $56^\circ 39' 10''$ | | above standpt. |
| COPPER NAIL | $164^\circ 39' 25''$ | 3.144 | above standpt. | S/S TRIG. PIN | $81^\circ 49' 10''$ | 2.881 | above standpt. |
| S.S.M. No. 1605 | $261^\circ 48' 45''$ | 2.881 | above standpt. | COPPER NAIL | $125^\circ 26' 15''$ | 4.522 | above standpt. |
| | | | below standpt. | | | | below standpt. |
| | | | above standpt. | | | | above standpt. |
| | | | below standpt. | | | | below standpt. |
| | | | above standpt. | | | | above standpt. |
| | | | below standpt. | | | | below standpt. |

Prepared by: *[Signature]* Checked: *[Signature]*

S: 27783-1

Noted on U.T.M. Card *[Signature]* Checked

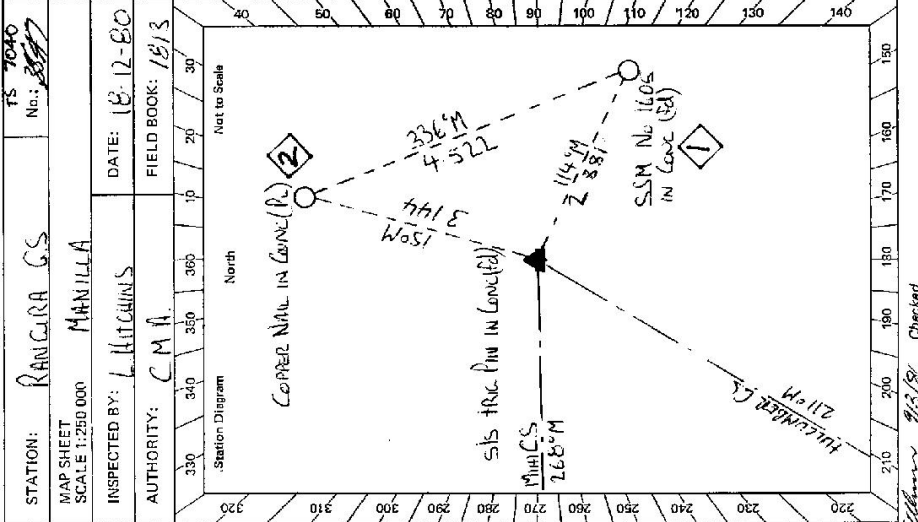

STATION: RANGIRA GS
 MAP SHEET SCALE 1:250,000
 INSPECTED BY: L. HITCHINS
 AUTHORITY: C.M.A.
 DATE: 18.12.80
 FIELD BOOK: 18/3

TS 7040
 No. *[Signature]*

| | |
|--|--|
| <p>Access Name: MR. LAJEEAN Address: "TOMY BARRA" Phone: 830151</p> <p>Access Name: MRS. HAYNES Address: NARRABARRA Phone: 18-12-1110</p> <p>Owner's Name: MR. LAJEEAN Address: "TOMY BARRA" Phone: 830151</p> <p>Owner's Name: MRS. HAYNES Address: NARRABARRA Phone: 18-12-1110</p> <p>* PLEASE NOTE: ACCESS OWNER BEING VISITING ACCESS</p> <p>Access Report of 07/7/193 was found suitable (unsuitable) O.D. PO GAVIN ROAD HEAD WISE FROM CONNORVILLE ST 0.45 TURN RIGHT INTO CHANNOS ST STRAIGHT AHEAD 29.4 END OF BITUMEN 30.0 STRAIGHT AHEAD 41.2 CROSS ROADS FOLLOW SIGN BARRABARRA 41.85 PASS ROAD ON RIGHT SIGN MANILLA 19 44.9 PASS ROAD TO OWNERS HOUSE ON LEFT 48.6 CROSS GRID 50.35 PASS ROAD ON RIGHT SIGN "MANILLA" 50.4 CROSS GRID 51.75 CROSS GRID 51.8 PASS TRACK ON RIGHT 53.9, 55.6, 56.7 CROSS GRIDS 56.95 PASS ROAD ON RIGHT SIGN "BARRABA" 57.45 CROSS GRID 58.1 PASS TRACK ON RIGHT 58.35 PASS RD ON RIGHT SIGN "BARRABA VIA BARRON" 59.0 THROUGH IRON GATE SIGN "ISORAHWALE" 59.7 PASS HOUSE ON LEFT 59.95 THROUGH WOODEN GATE PASS YARDS ON RIGHT 60.3 THROUGH WOODEN GATE 61.75 IRON GATE SIGN "TOBY BURN"</p> | <p style="text-align: center;">STATION RANCIIRA GS TS 7040</p> <p>Access Name: MR. LAJEEAN Address: "TOMY BARRA" Phone: 830151</p> <p>Access Name: MRS. HAYNES Address: NARRABARRA Phone: 18-12-1110</p> <p>Owner's Name: MR. LAJEEAN Address: "TOMY BARRA" Phone: 830151</p> <p>Owner's Name: MRS. HAYNES Address: NARRABARRA Phone: 18-12-1110</p> <p>* PLEASE NOTE: ACCESS OWNER BEING VISITING ACCESS</p> <p>Access Report of 07/7/193 was found suitable (unsuitable) O.D. PO GAVIN ROAD HEAD WISE FROM CONNORVILLE ST 0.45 TURN RIGHT INTO CHANNOS ST STRAIGHT AHEAD 29.4 END OF BITUMEN 30.0 STRAIGHT AHEAD 41.2 CROSS ROADS FOLLOW SIGN BARRABARRA 41.85 PASS ROAD ON RIGHT SIGN MANILLA 19 44.9 PASS ROAD TO OWNERS HOUSE ON LEFT 48.6 CROSS GRID 50.35 PASS ROAD ON RIGHT SIGN "MANILLA" 50.4 CROSS GRID 51.75 CROSS GRID 51.8 PASS TRACK ON RIGHT 53.9, 55.6, 56.7 CROSS GRIDS 56.95 PASS ROAD ON RIGHT SIGN "BARRABA" 57.45 CROSS GRID 58.1 PASS TRACK ON RIGHT 58.35 PASS RD ON RIGHT SIGN "BARRABA VIA BARRON" 59.0 THROUGH IRON GATE SIGN "ISORAHWALE" 59.7 PASS HOUSE ON LEFT 59.95 THROUGH WOODEN GATE PASS YARDS ON RIGHT 60.3 THROUGH WOODEN GATE 61.75 IRON GATE SIGN "TOBY BURN"</p> |
| <p>Not to Scale</p> <p>Beacon Diagram</p> | <p>This section to be completed by officer constructing pillar.</p> <p>Original station mark found/not found.....</p> <p>Description of mark: SIC TO B PIN.....</p> <p>Original beacon found/not found.....</p> <p>Description of beacon: CROWN POLE 1 DISCS.....</p> <p>Height Top of Vanes to Top Mark 3.706 m.</p> <p>Height of mark 0.028 m. above AT please G.L. below</p> <p>Diameter of Vanes 1.009 m. Height of Cairn 0.630 m.</p> <p>Original Beacon has not been destroyed by me.</p> |
| <p>Date</p> <p>Record of Station</p> | |

TS 7040
No.: 388T

STATION: **RANICARA**
MAP SHEET
SCALE 1:250 000
INSPECTED BY: **L. ALICHAUS**
AUTHORITY: **C.M.A.**

MANILLA
DATE: **21.3.82**
FIELD BOOK:

Station Diagram
North
Not to Scale
320 310 300 290 280 270 260 250 240 230 220
330 340 350 360 370 380 390 400

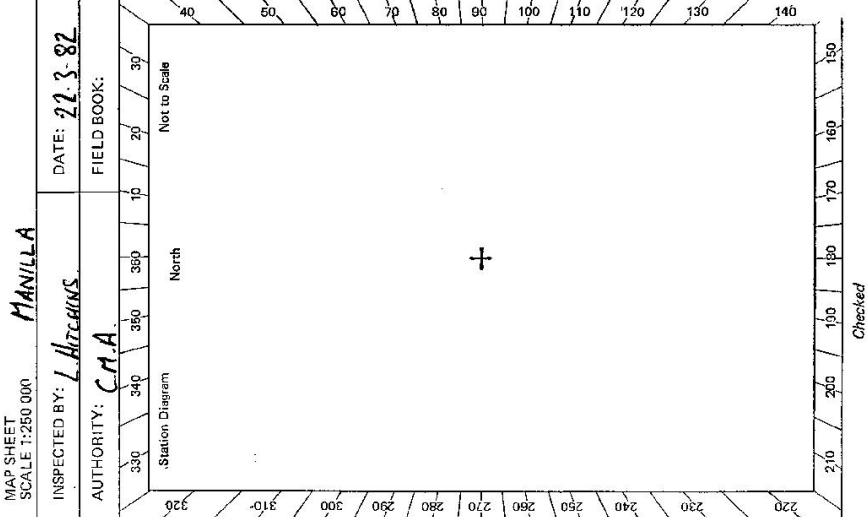

Central Mapping Authority
Geodetic Survey of N.S.W.
Geodetic Station Reconnaissance and Maintenance Report

Description:
1. Cleared by lanes bearing **360° with SCATTERED ROSES** from Trig. Mast
2. Mast & Vanes have been painted white & black respectively.
3. The station/pillar was unpiled/hot unpiled/constructed on **19** dimensions now being:
Description of mark **should be explicit, e.g., S/Steel Pillar Plate, Steel plug, Brass plug, Bolt, G.I. Pipe**
Height of mark **above** rock/concrete; Mark is **above** G.L.
Height of Top Vanes to Top Mark/Pillar plate **Diameter of Vanes (vertical)** m.
Height of Cairn **Diameter of Cairn** m. Name Plate found/not found/placed.
Length of Mast **(approximate if not unpiled)** m.
4. **S.S.M. No. 1605** set in conc/rock has been **placed**/found, bearing **114°** M from **Mast/Plug/Pillar**
5. **Copper Nail** set in conc/rock has been **placed**/found, bearing **15°** M from **Mast/Plug/Pillar**
6. **A** set in conc/rock has been **placed**/found, bearing **°** M from **Mast/Plug/Pillar**
7. **A** set in conc/rock has been **placed**/found, bearing **°** M from **Mast/Plug/Pillar**
8. Action required: **CONC. CAIRN, CONCI. COTE. IN FENCE (WITH SQUARES) CONTROL CHANGED. IF NOBLE CUSUMINE IS NECESSARY.**

| STANDPOINT: | | | |
|-------------|-----------|-----------------|-------------------|
| Mark | Direction | Horiz. Distance | Height Difference |
| | | | above standpt. |
| | | | below standpt. |
| | | | above standpt. |
| | | | below standpt. |
| | | | above standpt. |
| | | | below standpt. |
| | | | above standpt. |
| | | | below standpt. |
| | | | above standpt. |
| | | | below standpt. |
| | | | above standpt. |
| | | | below standpt. |
| | | | above standpt. |
| | | | below standpt. |

Prepared by: **[Signature]**
Checked: **[Signature]**
Noted on U.T.M. Card

STATION **RANCIIRA CS** TS 7040

Owner's Name: **MRS. MRS. MARYNE MRS R MIX**
 Address: **NARADA BARABA, KELVIN**
 Phone: **067425266**

ACCESS OWNER: **MR LAFFAN**
 Address: **FORCURN MANILLA**
 Phone: **017820151**

* PLEASE RUNC ACCESS BEFORE VISUAL ACCESS 22-3-1982

Access Report of 18/11/1980 was found suitable/unsuitable

0 O CONNEDAH PO MEMO WES ALONE (UNAPPROVED) ST 161.8 THROUGH GAP IN FENCE (NAME IRON BARBLES)

0.45 TURN RIGHT INTO CHANDOS ST. STRAIGHT (MEMO) 61.9 Co to LEFT OF HOUSE (CALL IN)

21.4 END OF STRAIGHT AHEAD

30.0 STRAIGHT AHEAD

41.2 CROSS ROAD FOLLOW SIGN BARBARA 43

41.85 PASS ROAD ON RIGHT SIGN MANILLA 14

44.9 PASS ROAD TO OWNERS HOUSE ON LEFT

48.6 CROSS GRID

50.35 PASS ROAD ON RIGHT SIGN MANILLA

50.4 CROSS GRID 51.75 CROSS GRID

51.8 PASS TRACK ON RIGHT

53.9 55.6 56.7 CROSS GRIDS

56.95 PASS ROAD ON RIGHT SIGN BARBARA

57.45 CROSS GRID

58.1 PASS TRACK ON RIGHT

58.35 PASS ROAD ON RIGHT BARBARA VIA DAMON

59.0 THROUGH IRON GATE SIGN BARBARA VALE

59.7 PASS HOUSE ON LEFT

59.95 THROUGH WOODEN GATE PASS YARD ON RIGHT

60.3 THROUGH WOODEN GATE

61.75 THROUGH IRON GATE SIGN TO 'REBURY'

62.0 PASS SHED AND FUEL TANKS ON LEFT

62.3 CROSS DAM WALL

62.5 THROUGH DOUBLE IRON GATES KEEP YARDS ON L.

62.55 CROSS DAM WALL

63.1 THROUGH (GAP)

63.8 THROUGH OLD WOODEN GATE. FOLLOW TRACK

64.0 PASS OLD FEE THROUGH ON LEFT.

65.15 TURN RIGHT UP FENCE LINE

65.2 FENCE CORNER 1/2 MIN WALK TO RANCIIRA CS.

Beacon Diagram

| |
|--------------|
| Not to Scale |
|--------------|

This section to be completed by officer constructing pillar.

Original station mark found/not found.

Description of mark:

Original beacon found/not found.

Description of beacon:

Height Top of Vanes to Top Mark:m.

Height of mark:m. above G.L.
below

Diameter of Vanesm. Height of Cairnm.

Original Beacon has/has not been destroyed by me.

Date

Record of Station

08

STATION **RANGIKA (P)** TS **7040**

Owner's Name: **MR. A. K. & MRS. C. HAYNE & MRS. K. MIX**
 Address: **"NABARAWARRA"**
MEVIN VIA **GUNNEDRA**
 Phone: **(087) 433336**

ACCESS **15-3-1983**

Access Report of 13/10/83 was found suitable/unavailable.

0.00 GUNNEDRA R.C. ROAD WEST ALONG CORNER/ALYST!
0.45 TURN RIGHT INTO CHANDOS ST. STRAIGHT AHEAD
29.4 END OF BITUMEN
30.0 STRAIGHT AHEAD
41.2 CROSS ROAD FOLLOW SIGN BARRABA A3!
41.85 PASS ROAD ON RIGHT SIGN MANULLA 19!
44.9 PASS ROAD TO OWNER'S HOUSE COLLECT!
48.6 CROSS GRID!
50.35 PASS ROAD ON RIGHT SIGN MANULLA
50.4 GRID 51.75 GRID!
51.8 PASS TRACK ON RIGHT!
53.9, 55.6, 56.7 GRIDS!
56.95 PASS ROAD ON RIGHT SIGN BARRABA
57.45 CROSS GRID
58.1 PASS TRACK ON RIGHT!
58.35 PASS ROAD ON RIGHT [BARRABA VIA BANGOL]
59.0 THROUGH IRON GATE SIGN "BORAHVALE"
59.7 PASS HOUSE ON LEFT!
59.95 THROUGH WOODEN GATE PASS YARDS ON RIGHT
60.3 WOODEN GATE
61.75 IRON GATE SIGN "TORYBROU"
61.9 GO TO LEFT OF HOUSE [CALLING]

62.0 PASS SHED AND FUEL TANKS ON LEFT!
62.3 CROSS DAM WALL!
62.55 THROUGH IRON GATE KEEP WOOD ON LEFT
63.1 CROSS DAM WALL!
64.0 THROUGH IRON GATE!
65.15 TURN RIGHT UP FENCE LINE!
65.2 FENCE CORNER 1/2 MIN WALK TO RANGIRA G.S.

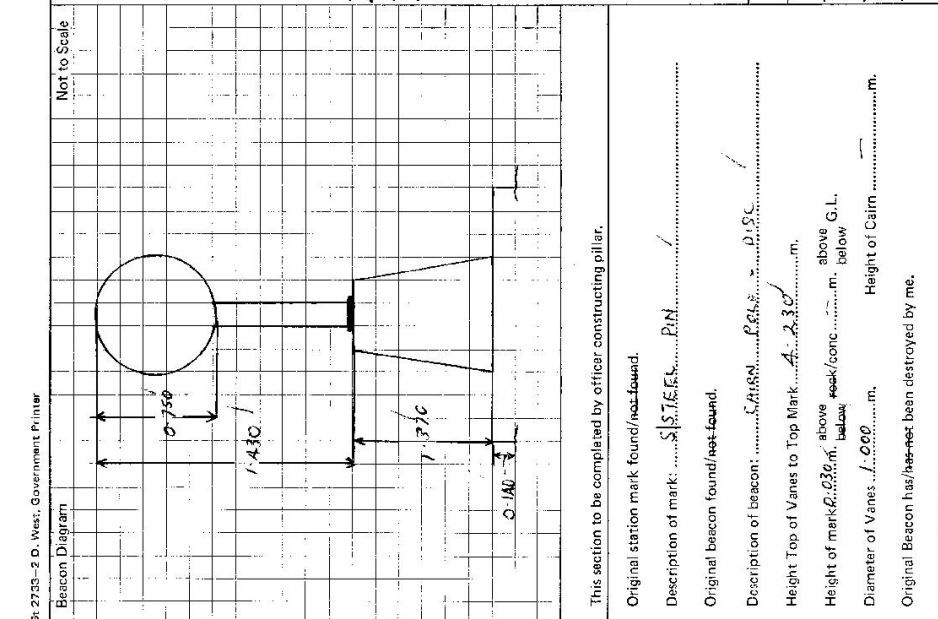

This section to be completed by officer constructing pillar.

Original station mark found/not found.

Description of mark: **STEEL PIN**

Original beacon found/not found.

Description of beacon: **STEEL PIN**

Height Top of Vanes to Top Mark: **2.30** m.

Height of mark: **0.30** m. above G.L. below

Diameter of Vanes: **0.00** m. Height of Cairn

Original Beacon has/has not been destroyed by me.

Date

Record of Station