

CENTRAL MAPPING AUTHORITY

GEODETTIC SURVEY OF N.S.W.

GEODETTIC STATION RECONNAISSANCE and MAINTENANCE REPORT

Description:

Note: Cross out word or words which do not apply

1. Cleared by James bearing..... Com. plate/sky..... 360°..... from Trig. Mast
2. Mast & Vanes have been painted white & black respectively.....
3. The station/pillar was unapplied/not unapplied/reconstructed on..... 19..... dimensions now being:  
Description of mark..... should be explicit, e.g., S/Steel Pillar-Plate, Steel plug, Brass plug, Bolt, G.I. Pipe  
Height of mark..... m..... above/below rock/concrete; Mark is..... m..... above/below G.I.
4. An..... S.S.M..... set in ~~conc~~/~~rock~~ has been placed/found, bearing..... 252°..... M from Mast/~~Plug/Pillar~~
5. A..... set in conc/rock has been placed/found, bearing..... °M from Mast/Plug/Pillar
6. A..... set in conc/rock has been placed/found, bearing..... °M from Mast/Plug/Pillar
7. A..... set in conc/rock has been placed/found, bearing..... °M from Mast/Plug/Pillar  
if ~~drivable~~ - reconstruct conc. pillar, otherwise site is suitable for
8. Action required: construction of..... top..... pillar..... (rock base)..... clearing..... road..... poison.....  
stumps

STANDPOINT:

Mark	Direction	Horiz. Distance	Height Difference	Mark	Direction	Horiz. Distance	Height Difference
KINGS TOWN	347 28	19.1	above standpt.				above standpt.
ROUND MOUNTAIN	414 38	11.2	below				below
RETREY MOUNTAIN	109 65	11.8	above standpt.				above standpt.
DURLEY MOUNTAIN	137 20	20.4	below				below
FENT	143 30	7.4	above standpt.				above standpt.
WATSONS CREEK	141 59	13.5	below				below
ROSEBETH	225 44	15.2	above standpt.				above standpt.
GLENS BARRA	230 35	8.2	below				below
PERA	311 16	21.0	above standpt.				above standpt.
			below				below
			above standpt.				above standpt.
			below				below
			above standpt.				above standpt.
			below				below

Prepared by: D. Kinlyside

Checked: D. HALLS

Noted on U.T.M. Card

ST 2733-1

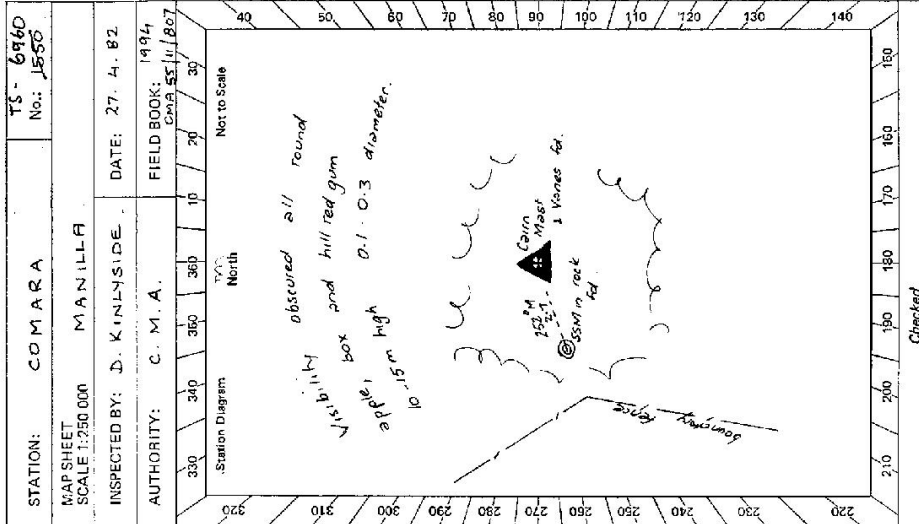

Checked

STATION: COMARA

TS- 6960  
No.: 1650

MAP SHEET  
SCALE 1:250 000

MANILLA

INSPECTED BY: D. KINLYSIDE

DATE: 27. 4. 82

AUTHORITY: C. M. A.

FIELD BOOK: 1494  
CMA 53/11/807

Station Diagram

North

Not to Scale

St 2733-2 D. West, Government Printer

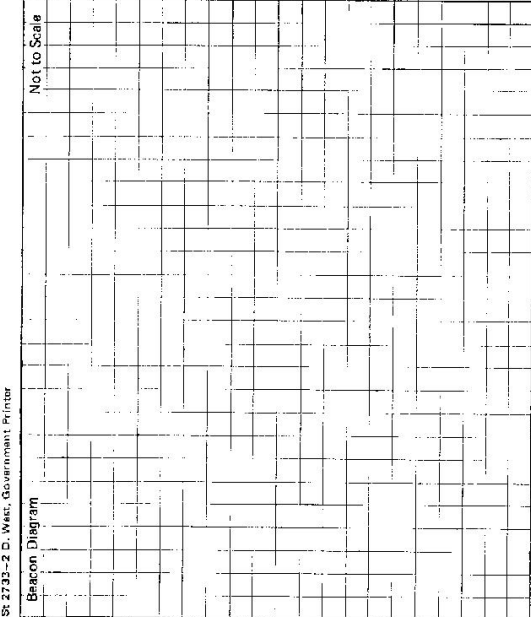

Owner's Name: Don White  
 Address: "Comera"  
Kings town  
 Phone: Kingstown 28

STATION COMARA IS-6960  
 Owner of Access: Very Walsh  
 Address: "Athlone"  
Kings Creek  
 Phone: 6 0130

ACCESS 27-4-82

Access Report of 12/1/1982 was found ~~inadequate~~ unsuitable.

0.0 Manilla P.O. heading east towards Bendeoneer

0.4 Straight ahead

4.02 Cross bridge

13.64 Turn LEFT sp Glen Barro Rd "Donmore"

13.81 Cross bridge

20.89 Take LEFT fork

22.84 Pass road to Dunmore on RHS

25.24 Take LEFT fork

29.23 Bridge

31.91 Take RIGHT fork

43.72 Pass turnoff to Glen Barro on RHS

45.41 Turn LEFT sp "Stone Hut" "Athlone"

48.20 Pass "The Springs" on LHS

50.54 Turn LEFT sp "Stone Hut" "Athlone"

[Straight ahead for 4.25 km then turn left for 4.5 km to winners house]

51.86 Iron gate sp "Athlone"

53.57 Iron gate then hard right through wire gate - follow fence in an easterly direction

[owner of access - straight ahead from iron gate for 1km then turn LEFT]

53.79 Through wire gate (caution should be taken from here during or after wet weather) - follow faint track

54.17 Large dam on LHS

54.94 Leave vehicle just below saddle - walk up to saddle and then veer right along top of ridge

10 minutes easy walk to trig

(By moving logs & rocks it may be possible to drive up saddle and to within 50m of trig)

Record of Station

Date

26.4.82

Very Walsh granted permission to improve access and clearing on his property. Ring him before going to trig

28.4.82

Don White granted permission for clearing and construction of pulley. Requested that stamps be poisoned. Does not wish to be contacted prior to any work being carried out.

This section to be completed by officer constructing pillar.

Original station mark found/not found.

Description of mark:

Original beacon found/not found.

Description of beacon:

Height Top of Vane to Top Mark.....m.

Height of mark.....m. above G.L. below

Diameter of Vane.....m.

Original Beacon has/has not been destroyed by me.

CENTRAL MAPPING AUTHORITY  
 GEODETIC SURVEY OF N.S.W.  
 GEODETIC STATION RECONNAISSANCE and MAINTENANCE REPORT

STATION: **COMARA (P)** / **TS No.: 6960**  
 MAP SHEET SCALE 1:250 000  
 INSPECTED BY: **G FORD** / **MANILLA** / DATE: **14-12-82**  
 AUTHORITY: **CMA** / FIELD BOOK: **1939**

- Description: *Note: Cross out word or words which do not apply*
- Cleared by lanes bearing **360°** from Trig. Mast
  - Mast & Vanes have been painted white & black respectively. ✓
  - The ~~station~~ pillar was ~~unplaced/unerected~~ constructed on **1-12-1982**, dimensions now being: Description of mark **S/S PILLAR PLATE** should be explicit, e.g., S/Steel Pillar Plate, ~~Steel plug~~, ~~Bress plug~~, Bolt, G.I. Pipe  
 Height of mark **1.370** m. <sup>above</sup> ~~below~~ **rock/concrete**; Mark is **1.530** m. <sup>above</sup> ~~below~~ G.L.  
 Height of Top Vanes to Top ~~mark~~ Pillar plate **1.390** m. Diameter of Vanes (vertical) **2.50** m.  
 Height of Cairn **.....** m. Diameter of Cairn **.....** m. Name Plate ~~found~~ ~~not found~~ ~~placed~~.
  - Length of Mast **.....** m. (approximate if not unplaced)
  - A. **BRASS TRIG. PLAG** set in ~~conc~~/rock has been ~~placed~~/found, bearing **171°** M from Mast/~~Plug~~/~~Pillar~~
  - A. **SSM** set in ~~conc~~/rock has been ~~placed~~/found, bearing **343°** M from Mast/~~Plug~~/~~Pillar~~
  - A. **COPPER NAIL** set in ~~conc~~/rock has been ~~placed~~/found, bearing **88°** M from Mast/~~Plug~~/~~Pillar~~
  - A. **.....** set in ~~conc~~/rock has been ~~placed~~/found, bearing **.....** M from Mast/~~Plug~~/~~Pillar~~
  - Action required: **.....**

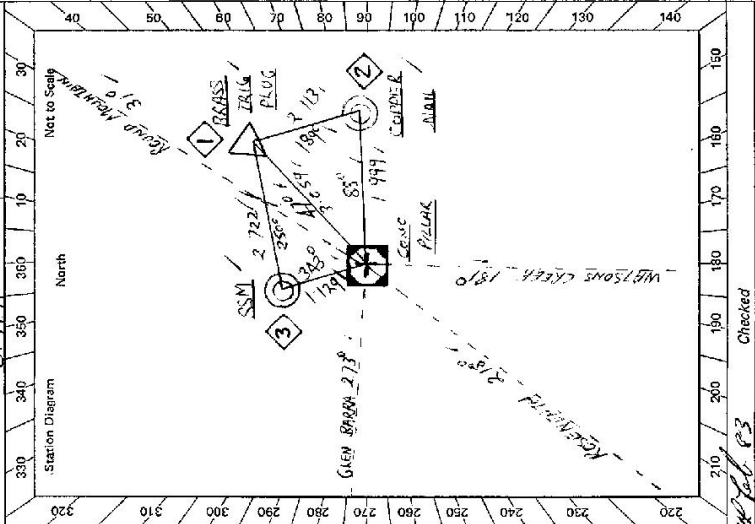

STANDPOINT: <b>CONC PILLAR</b>		STANDPOINT: <b>BRASS TRIG. PLAG</b>	
Mark	Direction	Mark	Direction
GLEN BARRA (P)	0 00 00 ✓	GLEN BARRA (P)	0 00 00 ✓
SSM	77 56 10 A 129 1 382	ROUND M7 (G.S.)	124 11 30 ✓
ROUND M7 (G.S.)	124 11 10 ✓	WATSONS CREEK (P)	271 38 00 ✓
BRASS TRIG. PLAG	140 08 40 B 057 1 718	COPPER NAIL	279 38 20 R 1131 0 304
COPPER NAIL	183 30 00 A 999 1 1415	ROSENEATH (P)	305 22 30 ✓
WATSONS CREEK (P)	271 36 40 ✓	CONG. PILLAR	320 09 30 B 058 1 720
ROSENEATH (P)	305 21 20 ✓	SSM	344 A1 30 2 722 0 340

Prepared by: **G Ford** Checked: **W. J. ...**  
 Noted on U.T.M. Card **77 78 60 63**

Station Diagram  
 North  
 East  
 Not to Scale  
 320 310 300 290 280 270 260 250 240 230 220  
 330 340 350 360 370 380 390 400  
 150 160 170 180 190 200 210 220  
 Checked

Sr 2733-2 D. West, Government Printer

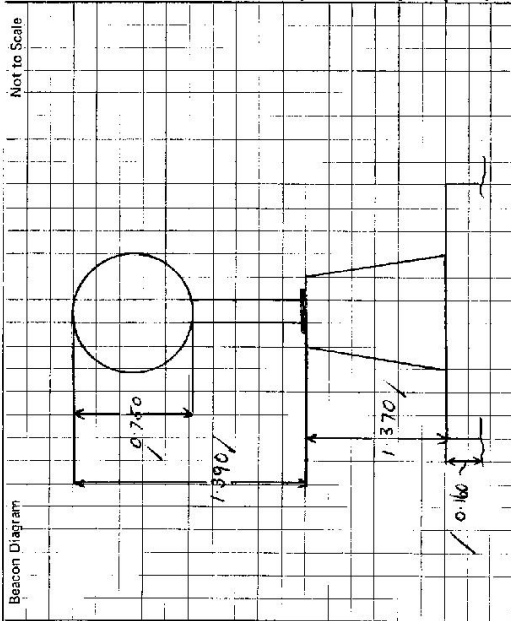

Beacon Diagram

Not to Scale

This section to be completed by officer constructing pillar.

Original station mark found/~~not found~~.

Description of mark: BRASS TRIG PLUG

Original beacon found/~~not found~~.

Description of reason: CRACKEN PILE & RISE

Height Top of Vanes to Top Mark: 3.640 m.

Height of mark: 0.750 m. above G.L. below

Diameter of Vanes: 0.750 m. Height of Cairn: 1.660 m.

Original Beacon has/~~not been~~ destroyed by mo.

STATION COMARA (P) TS 6960

Owner's Name: DEN WHITE  
 Address: S. COMARA  
KINGSTOWN  
 Phone: KINGSTOWN 28

OWNER OF ACCESS: GERRY WALSH  
 Current Occupant: ATHLONE  
 Address: WATSONS  
 Phone: 6.000.000

ACCESS

Access Report of 17/12/1982 was found suitable/unavailable.

- / 0.00 THUNDERBOLT IAN UGALLA SOUTH ALONG HWY TOWARDS THAMMORH
- / 1.03 TURN RIGHT TOWARDS KINGSTOWN
- / 21.48 PASS ROAD TO KINGSTOWN [SIGN UGALLA, RETREAT, KINGSTOWN]
- / 28.30 END OF BITUMEN
- (THEN CROSS FIGHT GRIDS)
- / 44.10 PASS ROAD TO KINGSTOWN R.H.S. [SIGN UGALLA REMEMBER KINGSTOWN]
- / 44.30 BRIDGE
- / 44.65 TAKE ROAD TO RIGHT [MANILLA ATHLONE]
- / 45.75 STRAIGHT AHEAD [LAND OWNER TO RIGHT MR. DWIGHT COMARA]
- / 49.95 TURN RIGHT SIGN STONEHUT, ATHLONE.
- / 51.30 IRON GATE 'ATHLONE & WALSH'
- / 53.00 GRID TURN HARD RIGHT BACK THROUGH WIRE GATE NEAR TO GRID FOLLOW TRACK

- / 53.25 (ACCESS OWNERS HOUSE STRAIGHT AHEAD FROM GRID THROUGH WIRE GATE IN FENCE CORNER THEN TO 'ATHLONE')
- / 53.65 PASS LARGE DAM ON LEFT & FOLLOW TRACK & BRACK TO TRIG
- / 54.95 COMARA GS.

[LAND FROM 53.65]

Record of Station

Date

GEODETTIC SURVEY OF R.S.M.

CENTRAL MAPPING AUTHORITY

GEODETTIC STATION RECONNAISSANCE and MAINTENANCE REPORT

Description:

- Cleared by lanes bearing  $20^{\circ} - 349^{\circ}$  Note: Cross out word or words which do not apply  
..... from Trig. Mast
- Mast & Vanes have been painted white & black respectively. ✓
- The station/pillar was unpiled/not unpiled/constructed on ..... 19....., dimensions now being:  
Description of mark..... should be explicit, e.g., S/Steel Pillar Plate, Steel plug, Brass plug, Bolt, G.I. Pipe  
Height of mark..... m. <sup>above</sup> <sub>below</sub> rock/concrete; Mark is..... m. <sup>above</sup> <sub>below</sub> G.L.  
Height of Top Vanes to Top Mark/Pillar plate ..... m. Diameter of Vanes (vertical)..... m.  
Height of Cairn..... m. Diameter of Cairn..... m. Name Plate found/not found/placed.  
Length of Mast ..... m. (approximate if not unpiled)
- A..... set in conc/rock has been placed/removed, bearing..... °M from Mast/Plug/Pillar
- A..... set in conc/rock has been placed/removed, bearing..... °M from Mast/Plug/Pillar
- A..... set in conc/rock has been placed/removed, bearing..... °M from Mast/Plug/Pillar
- A..... set in conc/rock has been placed/removed, bearing..... °M from Mast/Plug/Pillar
- Action required.....

STANDPOINT:

Mark	Direction	Horiz. Distance	Height Difference	Mark	Direction	Horiz. Distance	Height Difference
			above standpt.				below standpt.
			below standpt.				above standpt.
			above standpt.				below standpt.
			below standpt.				above standpt.
			above standpt.				below standpt.
			below standpt.				above standpt.
			above standpt.				below standpt.
			below standpt.				above standpt.
			above standpt.				below standpt.
			below standpt.				above standpt.

Prepared by: *[Signature]* 6/2/22

Checked: *[Signature]*

Noted on U.T.M. Card

STATION: *C O M A R A G S (P)* TS No.: *6960*  
 MAP SHEETS SCALE 1:250 000 SCALE 1:100 000  
 INSPECTED BY: *G. FORD* DATE: *6-12-88*  
 AUTHORITY: *C. M. A.* FIELD BOOK: *---*

