

CENTRAL MAPPING AUTHORITY

GEODETIC SURVEY OF N.S.W.

GEODETIC STATION RECONNAISSANCE and MAINTENANCE REPORT

- Description: *360*
 Note: Cross out word or words which do not apply
- Cleared by Janes bearing *360* from Trig. Mast
 - Mast & Vanes have been painted white & black respectively. ✓
 - The station/pillar was unpiled/~~not unpiled~~/constructed on *rock*..... dimensions now being: Description of mark *Rock (4.5)* should be explicit, e.g. S/Steel Pillar Plate, Steel plug, Brass plug, Bolt, G.I. Pipe
 Height of mark *0.012* m. ^{above} below rock/~~concrete~~; Mark is *4.5* m. ^{above} below G.L.
 Height of Top Vanes to Top Mark/~~Pillar plate~~ *2.865* m. Diameter of Vanes (vertical) *7.0* m.
 Height of Cairn *0.55* m. Diameter of Cairn.....m. Name Plate ~~found~~/~~not found~~/placed. ✓
 Length of Mast *2.865* m. (~~approximate if not completed~~)
 - A *S.S.M-137* set in conc/rock has been placed/found, bearing *288*° M from Mast/Plug/Pillar
 - A *Copper Mast* set in conc/rock has been placed/found, bearing *172*° M from Mast/Plug/Pillar
 - A..... set in conc/rock has been placed/found, bearing.....° M from Mast/Plug/Pillar
 - A..... set in conc/rock has been placed/found, bearing.....° M from Mast/Plug/Pillar
 - Action required: *Station! S.Mast to Pillar*

Mark	Direction	Horiz. Distance	Height Difference	Mark	Direction	Horiz. Distance	Height Difference
<i>Watts Hill?</i>	<i>0 00 00</i>		<i>above</i> standpt.	<i>Watts Hill G.S.</i>	<i>0 00 00</i>		<i>below</i> standpt.
<i>Thunder Best G.S.</i>	<i>142 05 40</i>		<i>above</i> standpt.	<i>Copper Mast</i>	<i>111 06 50</i>	<i>1.976</i>	<i>below</i> standpt.
<i>Copper Mast</i>	<i>195 15 50</i>		<i>above</i> standpt.	<i>Copper Mast</i>	<i>155 30 40</i>	<i>2.861</i>	<i>above</i> standpt.
<i>S.S.M-137</i>	<i>291 01 45</i>	<i>2.050</i>	<i>below</i> standpt.	<i>Thunder Best G.S.</i>	<i>142 05 10</i>		<i>below</i> standpt.
<i>Yarell G.S.</i>	<i>317 24 30</i>	<i>1.475</i>	<i>above</i> standpt.	<i>Yarell G.S.</i>	<i>317 24 30</i>		<i>below</i> standpt.
			<i>above</i> standpt.				<i>below</i> standpt.

STANDPOINT: *Copper Mast*

STANDPOINT: *S.S.M-137*

Prepared by: *Atkins*

Checked:

Noted on U.T.M. Card *9381*

Checked

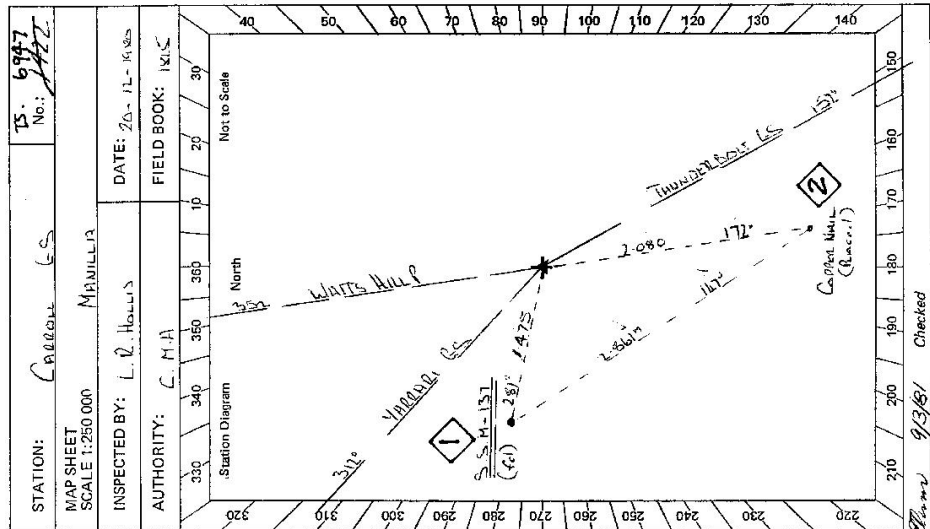

TS 6947 No: 9381

STATION: *Copper Mast*
 MAP SHEET SCALE 1:250 000
 INSPECTED BY: *L. V. Hollis*
 AUTHORITY: *C.M.A.*
 DATE: *20.11.14*
 FIELD BOOK: *IXIC*

e: 2733-2 D. West, Government Printer

STATION

CHOLL 65 TS-6947

Owner's Name: Mr. S. S. S. S. S.
 Address: No. 10, S. S. S. S. S.
 Phone:
 Current Occupant:
 Address:
 Phone:

ACCESS

Access Report of 20/12/19 was found suitable/unsuitable.

ACCESS
 CARROLL RD THRO THORNS TANGROTH
 TURN LEFT
 TURN LEFT OVER GARD
 TURN LEFT BOWMAN'S HOUSE on LEFT
 DOUBLE TURN GATES
 DOUBLE TURN GATES THROUGH THRO LEFT
 TURN RIGHT AND MAKE ROAD TURN TO TAKE
 LEAVE VEHICLE - 2 MINUTE DRIVE TO TAKE.

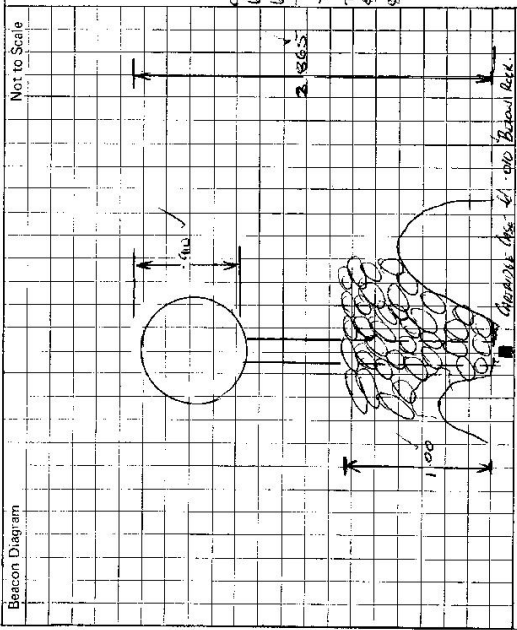

This section to be completed by officer constructing pillar.

Original station mark found/not found.

Description of mark:

Original beacon found/not found.

Description of Beacon:

Height Top of Vanes to Top Mark:m.

Height of mark:m. above G.L.
 below rock/cont.

Diameter of Vanes:m. Height of Cairn:m.

Original Beacon has/has not been destroyed by me.

Date	Record of Station

CENTRAL MAPPING AUTHORITY
 GEODETIC SURVEY OF N.S.W.
 STATION: **CARROLL (P)** No.: **6947**

MAP SHEET
 SCALE 1:250 000
 INSPECTED BY: **G FORD** DATE: **26-10-82**

MANILLA
 AUTHORITY: **CMA** FIELD BOOK: **1920**

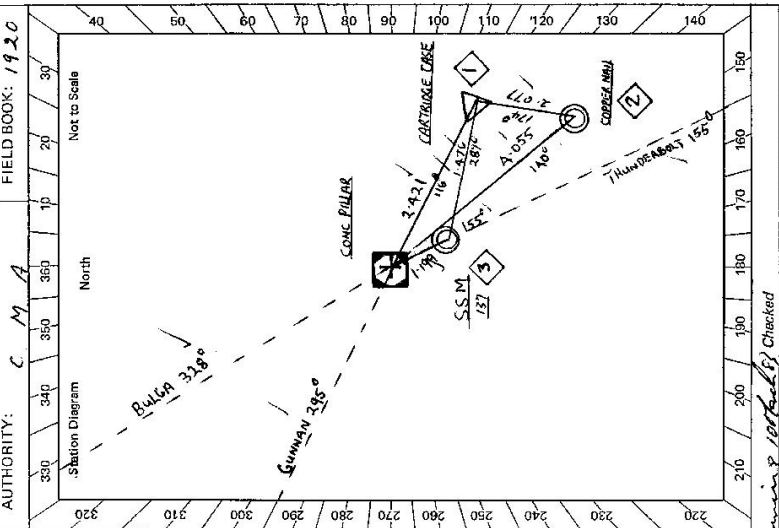

Description:	STANDPOINT: CONC PILLAR				STANDPOINT: CARTRIDGE CASE			
	Mark	Direction	Horiz. Distance	Height Difference	Mark	Direction	Horiz. Distance	Height Difference
1. Cleared by lanes bearing 3.60° ✓ Note: <i>Cross out word or words which do not apply</i> Mast & Vanes have been painted white & black respectively. ✓ from Trig. Mast								
2. Mast & Vanes have been painted white & black respectively. ✓ from Trig. Mast								
3. The station/pillar was used used for constructed on 35-70 1982 , dimensions now being: Description of mark: S/S/PLUG PILLAR should be explicit, e.g., S/Steel Pillar Plate, Street plug, Brass plug, Bolt, G.I. Pipe Height of mark 1.380 m. ^{above} below feet/concrete ; Mark is 630 m. ^{above} below G.L. Height of Top Vanes to Top Mark/Pillar plate 1.410 m. Diameter of Vanes (vertical) 0.250 m. Height of Cairn.....m. Diameter of Cairn.....m. Name Plate found/not found/placed. Length of Mast.....m. (approximate if not unpled)								
4. CARTRIDGE CASE set in conc/rock has been placed /found, bearing 116 °M from Mast/Plug/Pillar								
5. S.S.M. 137 set in conc/rock has been placed /found, bearing 155 °M from Mast/Plug/Pillar								
6. COPPER NAIL set in conc/rock has been placed /found, bearing 140 °M from Mast/Plug/Pillar								
7. A set in conc/rock has been placed /found, bearing..... °M from Mast/Plug/Pillar								
8. Action required:.....								

Prepared by: **G.Ford**
 Checked: **R. [Signature]** 15/1/12
 Noted on U.T.M. Card of **Jaming 10th Feb 82** Checked

S: 2733-2 D. West, Government Printer

Beacon Diagram

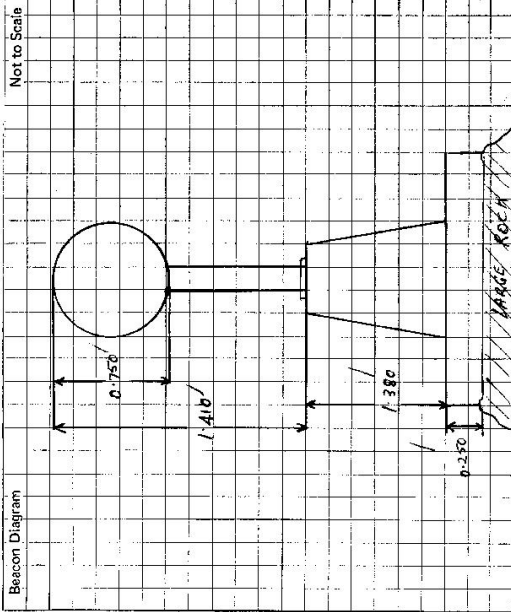

This section to be completed by officer constructing pillar.

Original station mark found/~~not found~~.

Description of mark: *CARRILLIDGE* *CASE*

Original beacon found/~~not found~~.

Description of beacon: *SHANK* *POLE* *V. DISC*

Height Top of Vanes to Top Mark: *2.876* m.

Height of mark: m. above rock/conc m. below G.L.

Diameter of Vanes: *9.20* m. Height of Cairn *3.00* m.

Original Beacon has/~~has not~~ been destroyed by me.

STATION

CARROLL (P) TS-6947

Owner's Name: *MR SWAIN*

Address: *MAUNTAIN VALLEY*

Phone: *(067) 43732*

Current Occupant:

Address:

Phone:

ACCESS

Access Report of *20/12/1986* was found suitable/~~unsuitable~~.

K.M.

- 0.00 CARROLL P.O. HEAD TOWARDS TAPWORTH (ON EXLEY HWY) ✓*
- 6.10 TURN LEFT ✓*
- 6.95 TURN LEFT OVER GAID ✓*
- 7.15 IRON GATE OVERS HOUSE ON LEFT ✓*
- 7.23 DOUBLE IRON GATES ✓*
- 7.45 " IRON GATES THEN ROUND TO LEFT ON FAINT TRACK ✓*
- 8.10 RIGHT AND MAKE OWN WAY UP ROCKY RIDGE (FROM SOUTH END) ✓*
- 8.70 LEAVE VEHICLE 2 MINUTE WALK TO TRIG ✓*

Date

Record of Station