

JS 6929  
No: 3820

STATION: QUARRY HILL

MAP SHEET  
SCALE 1:250 000

INSPECTED BY: K. HADLOW

DATE: 22-7-82

AUTHORITY: CMA

FIELD BOOK: L174

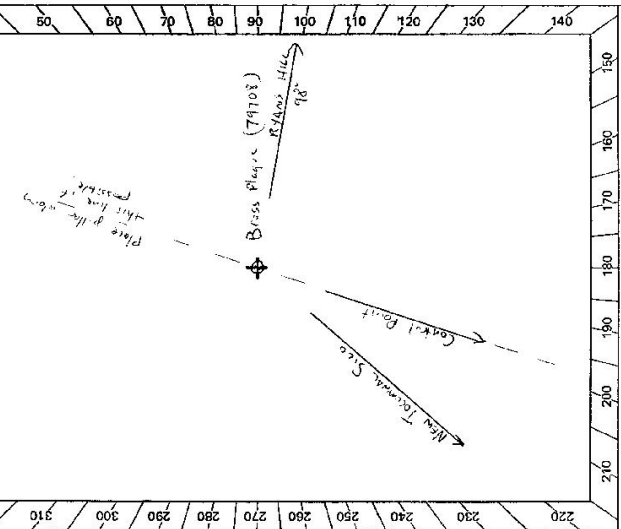

Checked

CENTRAL MAPPING AUTHORITY  
GEODETTIC SURVEY OF N.S.W.  
GEODETTIC STATION RECONNAISSANCE and MAINTENANCE REPORT

Description: Note: Cross out word or words which do not apply

1. Cleared by lanes bearing..... from Trig. Mast
2. Mast & Vanes have been painted white & black respectively.
3. The station/pillar was unpiled/not unpiled/constructed on..... 19....., dimensions now being:  
Description of mark: ~~Steel~~ <sup>Steel</sup> Pillar Plate, Steel plug, Brass plug, Bolt, G.I. Pipe  
Height of mark.....m. above rock/concrete; Mark is.....m. above below G.L.
- Height of Top Vanes to Top Mark/Pillar plate.....m. Diameter of Vanes (vertical).....m.
- Height of Cairn.....m. Diameter of Cairn.....m. Name Plate found/not found/placed.
- Length of Mast.....m. (approximate if not unpiled)
4. A..... set in conc/rock has been placed/found, bearing.....° M from Mast/Plug/Pillar
5. A..... set in conc/rock has been placed/found, bearing.....° M from Mast/Plug/Pillar
6. A..... set in conc/rock has been placed/found, bearing.....° M from Mast/Plug/Pillar
7. A..... set in conc/rock has been placed/found, bearing.....° M from Mast/Plug/Pillar
8. Action required: Construction of pillar

STANDPOINT:				STANDPOINT:			
Mark	Direction	Horiz. Distance	Height Difference	Mark	Direction	Horiz. Distance	Height Difference
			above standpt.				above standpt.
			below standpt.				below standpt.
			above standpt.				above standpt.
			below standpt.				below standpt.
			above standpt.				above standpt.
			below standpt.				below standpt.
			above standpt.				above standpt.
			below standpt.				below standpt.
			above standpt.				above standpt.
			below standpt.				below standpt.

Noted on U.T.M. Card

Checked:

Prepared by: K.S. Hadlow 30-7-82

GS 24

STATION QUARRY HILL TS 6929

Owner's Name: O. Quinn, Reserve 7265  
 Address: .....  
 Phone: .....  
 Current Occupant: .....  
 Address: .....  
 Phone: .....

ACCESS  
 Access Report of 22.7.1982 was found suitable/unsuitable.

- 00 Turn round Post Office. Head west along Denilquin Street
- 02 Turn right
- 03 Straight ahead towards Finley "
- 17 Turn right towards "The Rocks"
- 33 Straight ahead
- 7-4 Turn right into "The Rocks Road"
- 10-7 Turn left then right into "Blowhole Reserve"
- 10-9 Take track to left.
- 11-1 Follow track to left around west and north side of old granite quarry
- 11-4 At G.S.

Beacon Diagram

Not to Scale

No Beacon	
-----------	--

This section to be completed by officer constructing pillar.

Original station mark found/not found.

Description of mark: .....

Original beacon found/not found.

Description of beacon: .....

Height Top of Vanes to Top Mark .....m.

Height of mark .....m. above G.L.  
 below

Diameter of Vanes .....m. Height of Cairn .....m.

Original Beacon has/has not been destroyed by me.

Date	Record of Station

STATION: *Rumsey Hill S.S. (2)* No: *TS 6929*

MAP SHEET SCALE 1:250 000

INSPECTED BY: *P. POTTS* DATE: *13/9/82*

AUTHORITY: *C.M.A.* FIELD BOOK: *1668*

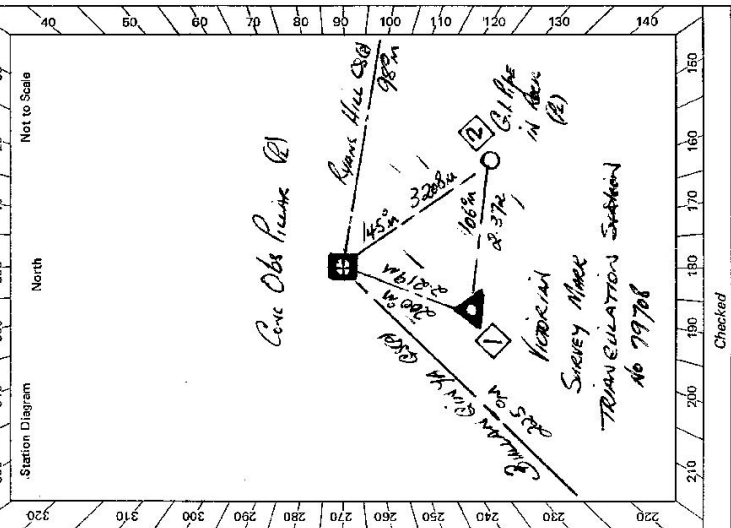

CENTRAL MAPPING AUTHORITY  
 GEODETIC SURVEY OF N.S.W.  
 GEODETIC STATION RECONNAISSANCE and MAINTENANCE REPORT

- Description: *Note: Cross out word or words which do not apply*
1. Cleared by lanes bearing... *Not Covered by Sintered Trees* from Trig. Mast
  2. Mast & Vanes have been painted white & black respectively. ✓
  3. The station/pillar was ~~reconstructed~~ *reconstructed* / constructed on *10th September 82*, dimensions now being: *3.5 base base*
  4. Description of mark... *Should be explicit, e.g., S/Steel Pillar Plate, Steel plug, Brass plug, Bolt, G.I. Pipe*
  5. Height of mark... *1370* m. *above rock* / concrete; Mark is *1590* m. *above rock*
  6. Height of Top Vanes to Top *1425* m. Diameter of Vanes (vertical) *0.750* m.
  7. Height of Cairn... m. Diameter of Cairn... m. Name Plate found/not placed.
  8. Length of Mast... m. (approximate if not unplied)
  9. A *Vertical* *RIC Mast No 79708* set in conc/rock has been ~~placed~~ *found*, bearing *260* °M, from ~~Mast/Pillar~~ *Pillar*
  10. A *G.I. Pipe* set in ~~conc/rock~~ *conc/rock* has been placed/~~found~~ *found*, bearing *145* °M from ~~Mast/Pillar~~ *Pillar*
  11. A set in conc/rock has been placed/~~found~~ *found*, bearing... °M from Mast/Plug/Pillar
  12. A set in conc/rock has been placed/~~found~~ *found*, bearing... °M from Mast/Plug/Pillar
  13. Action required: *None Obs Point*

Mark	Direction	Horiz. Distance	Height Difference	Mark	Direction	Horiz. Distance	Height Difference
<i>Rumsey Hill S.S. (2)</i>	<i>0 00 00</i>		<i>above</i> <i>standpt.</i>	<i>Rumsey Hill S.S. (2)</i>	<i>0 00 00</i>		<i>above</i> <i>standpt.</i>
<i>G.I. Pipe</i>	<i>48 57 59</i>	<i>3.201</i>	<i>7.655</i> <i>above</i> <i>standpt.</i>	<i>G.I. Pipe</i>	<i>5 16 26.2372</i>		<i>below</i> <i>standpt.</i>
<i>RIC 79708</i>	<i>76 38 30</i>	<i>2.218</i>	<i>7.500</i> <i>above</i> <i>standpt.</i>	<i>Bullans Hill S.S. (2)</i>	<i>0 13 40</i>		<i>above</i> <i>standpt.</i>
<i>Bullans Hill S.S. (2)</i>	<i>123 04 08</i>		<i>1.500</i> <i>above</i> <i>standpt.</i>	<i>Conc Obs Point</i>	<i>276 38 09</i>	<i>2.220</i>	<i>below</i> <i>standpt.</i>
			<i>below</i> <i>standpt.</i>				<i>below</i> <i>standpt.</i>
			<i>below</i> <i>standpt.</i>				<i>below</i> <i>standpt.</i>
			<i>below</i> <i>standpt.</i>				<i>below</i> <i>standpt.</i>
			<i>below</i> <i>standpt.</i>				<i>below</i> <i>standpt.</i>

STANDPOINT: *Vertical RIC Mast No 79708*

STANDPOINT: *Conc Obs Point*

Prepared by: *P. Potts, 16th September 1982* Checked: *P. Potts*

*21/9/82 Noted on U.T.M. Card*

GS 24

St 2733-2 D. West, Government Printer Beacon Diagram	Not to Scale 	STATION <u>Bunney Hill G.S.C.D</u> TS <u>6929</u> Owner Name: <u>ON Bunney Reserve 7295</u> Current Occupant: ..... Address: ..... Address: ..... Phone: ..... Phone: ..... ACCESS Access Report of 15/1/1987 was found suitable/unstable. KM FEATURE 0.00 <u>BY OFFICE TO CUMMINS HEAD TRIMERS FURLEY ✓</u> 0.20 <u>TOWN RIGHT</u> 0.26 <u>PAS BAND ON LEFT SIGN MELLONGNE ✓</u> 1.69 <u>TOWN RIGHT ON "THE ROCKS ROAD"</u> 3.34 <u>PAS BAND ON RIGHT</u> 7.43 <u>TOWN RIGHT "THE ROCKS ROAD"</u> 10.67 <u>TOWN LEFT</u> 10.69 <u>TOWN RIGHT SIGN ON TREE "LOW WALK HAZARD"</u> 10.84 <u>THE ROCK TO LEFT &amp; RIGHT AROUND LEFT OF OLD BUNNEY</u> 11.34 <u>BUNNEY HILL G.S.C.D</u>
This section to be completed by officer constructing pillar. Original station mark <del>found</del> not found. Description of mark: ..... Original beacon found/not found. Description of beacon: ..... Height Top of Vanes to Top Mark: .....m. Height of mark: .....m. above G.L. below Diameter of Vanes .....m. Height of Cairn .....m. Original Beacon has/has not been destroyed by me.		Date ..... Record of Station ..... ..... ..... .....