

6923  
75 103

STATION BOOMANOCMANA TS 4066

RECONNAISSANCE and MAINTENANCE REPORT

Department of Lands

Co: DENISON  
 Map Sheet:  
 Inspected by: C. STARKEY  
 Authority: DEPT LANDS  
 Date: 2/6/77  
 Field Book: SA1  
 No: PH: BOOMANOCMANA  
 Beacon Diagram  
 Not to Scale

This Trig. Station has been:-  
 1. Completely cleared to permit 360° vision to surrounding Trigs.  
 2. Cleared by James-bearing.  
 3. Trig-Mast & Vanes have been painted white & black respectively.  
 4. The Trig. was unpiled/~~not supplied~~, dimensions now being:  
 Description of mark: BRASS (with concrete) should be explicit, e.g. Steel plug, Brass plug, Bolt, Concrete Pillar  
 Height of mark: 0.107 m above rock/concrete  
 Height of Top Vanes to Top Mark: 1.17 m Diameter of Vanes (vertical): No vanes  
 Height of Cairn: m. Diameter of Cairn: m.  
 Length of Mast: m. (approximate if not unpiled)

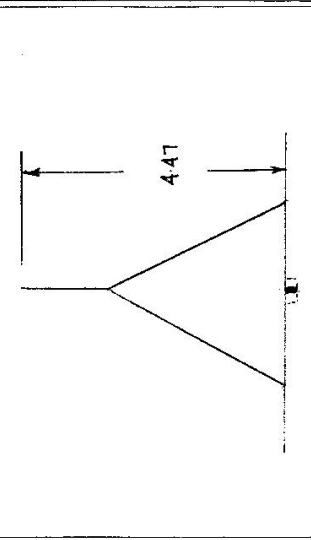

5. A SSM set in conc/rock has been placed/fd 2.619 m. bearing 108° 0M from Trig. Mast/pillar
6. A set in conc./soil has been placed/fd m. bearing °M from Trig. Mast/pillar
7. A set in conc./soil has been placed/fd m. bearing °M from Trig. Mast/pillar
8. A set in conc./rock has been placed/fd m. bearing °M from Trig. Mast/pillar
9. Connection to m. bearing °M
10. Connection to m. bearing °M
11. Connection to m. bearing °M
12. Connection to m. bearing °M
13. Diff. Ht: SSM is 0.219 m. above below Trig. Piles
14. Diff. Ht. is m. above below
15. Diff. Ht. is m. above below
16. Diff. Ht. is m. above below

Date	Record of Station

Prepared by: [Signature] Checked: [Signature]

6923  
STATION 1805 BOOMANOOMANA TS

Owners Name..... Current Occupant.....

Address.....

Access 2-6-77 TO CUMMAL 1:50000  
 FROM MULWALA TAKE THE ROAD WEST TO BAROOIGA  
 11.2km turn right at MT GYANE TELEPHONE EXCHANGE (F. WHEELS TRAIN ROAD)  
 14.9 km take gate on left about 100m North of house. follow track west along fence to TS.  
 2ND ACCESS

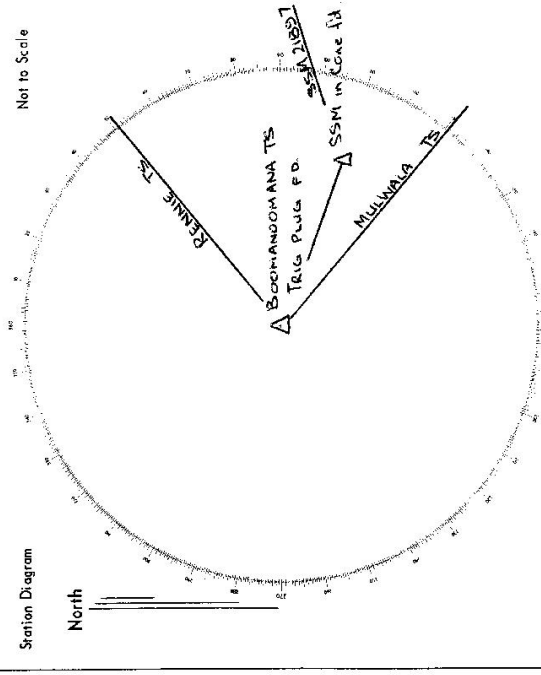

List of Observed Directions:-

Station	Direction	Station	Direction
SSM 21857	0°00'00"	RENNIE TS	0°00'00"
MULWALA TS	50°21'38"	SSM	56°18'06"
SSM 21857	0°00'00"		
MULWALA TS	50°21'40.5"		
BOOMANOOMANA TS	215°41'06"		
Station	Direction	Station	Direction

Standpoint: TRIG PLUG

CENTRAL MAPPING AUTHORITY

GEODETIC STATION RECONNAISSANCE and MAINTENANCE REPORT

STATION: BOMMANDOMANA No.: 6923  
 MAPSHEET SCALE 1:250 000 No.: JERILDERIE  
 INSPECTED BY: K. HADDON DATE: 23-7-82  
 AUTHORITY: C.M.A. FIELD BOOK: C 174

- Description: Note: Cross out word or words which do not apply
- Cleared by lanes bearing  $340^{\circ}$  to  $235^{\circ}$ ,  $283^{\circ}$  to  $315^{\circ}$  from Trig. Mast
  - Mast & Vanes have been painted white & black respectively.
  - The station/sillar was ~~unpiled~~ unpiled/consolidated on  $23-7-1982$ , dimensions now being: Description of mark: Brass plug, should be explicit, e.g., S/Steel Pillar Plate, Steel plug, Brass plug, Bolt, G.I. Pipe
- Height of mark.....m. above below rock/concrete; Mark is.....m. above below G.L.
- Height of Top Vanes to Top Mark/Pillar plate.....m. Diameter of Vanes (vertical).....m.
- Height of Cairn.....m. Diameter of Cairn.....m. Name Plate found/not found/placed.
- Length of Mast.....m. (approximate if not unpiled)
- A.....S.S.M. set in conc/rock has been placed/removed, bearing..... $110^{\circ}$  M from Mast/Plug/Pillar
  - A..... set in conc/rock has been placed/removed, bearing..... $^{\circ}$  M from Mast/Plug/Pillar
  - A..... set in conc/rock has been placed/removed, bearing..... $^{\circ}$  M from Mast/Plug/Pillar
  - A..... set in conc/rock has been placed/removed, bearing..... $^{\circ}$  M from Mast/Plug/Pillar
8. Action required: Construction of Brass Pillar Clear growth from  $235^{\circ}$  to  $340^{\circ}$

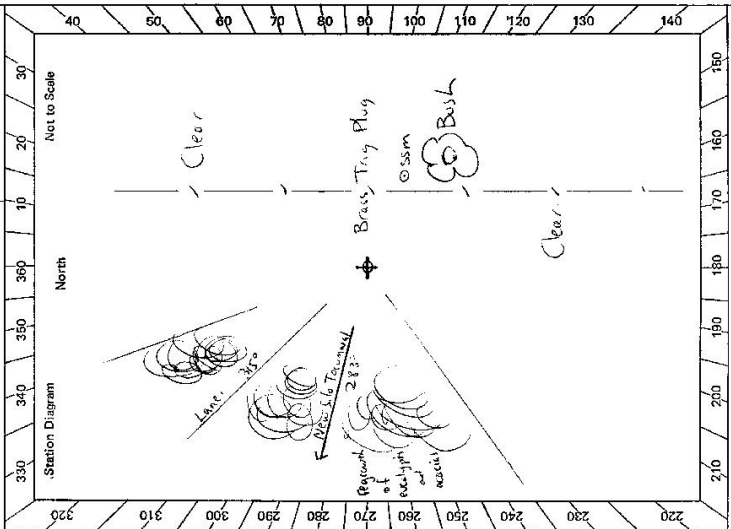

STANDPOINT:			
Mark	Direction	Horiz. Distance	Height Difference
			above standpt.
			below standpt.
			above standpt.
			below standpt.
			above standpt.
			below standpt.
			above standpt.
			below standpt.
			above standpt.
			below standpt.
			above standpt.
			below standpt.
			above standpt.
			below standpt.
			above standpt.
			below standpt.

Prepared by: K.S. Haddon 20-7-82 Checked: Noted on U.T.M. Card

SI 2735-2 D. West, Government Printer

STATION BOOMANDOMANA 6923

Adjoining Owner's Name: Hugh Slater (P67)  
 Address: "Oak Range"  
Yarraville Road, Mulwala  
 Phone: (057) 458219

Current Owner: Lessee Fredrick Kennedy  
 Address: "Ross Park"  
Mulwala  
 Phone: (057) 458233

ACCESS

Access Report of 23/7/1982 was found suitable/unsuitable.

See Tocumwal 8026 II-III 1:50000

00 Intersection of Mulwala-Boreaga Rd and Yarraville Road at Mt Guyane Telephone Exchange. (Ref D24219) Head north

1-1 Cross Mulwala Canal

[ 1-9 Residence of adjoining owner whose property you go through along track to right.

4-0 Turn left off bitumen road, go through gate, then follow track around south side of paddock.

5-1 Through gate.

5-2 Take track straight ahead up hill.

5-5 Take left track.

5-8 At G.S.

No Vanes

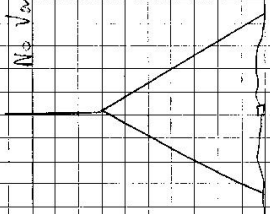

This section to be completed by officer constructing pillar.

Original station mark found/not found.

Description of mark: .....

Original beacon found/not found.

Description of beacon: .....

Height Top of Vanes to Top Mark.....m.

Height of mark.....m. above G.L. below

Diameter of Vanes .....m.

Height of Cairn .....m.

Original Beacon has/has not been destroyed by me.

Date	Record of Station

CENTRAL MAPPING AUTHORITY  
 GEODETIC SURVEY OF N.S.W.  
 GEODETIC STATION RECONNAISSANCE and MAINTENANCE REPORT

STATION: **BOOMANGOMANA GS** No.: **6923**  
 MAP SHEET SCALE 1:250 000  
 INSPECTED BY: **P. BOTT** DATE: **31.8.82**  
 AUTHORITY: **C.M.A.** FIELD BOOK: **1668**

Description:  
 Note: Cross out word or words which do not apply  
 1. Cleared by vanes bearing **125 m to 340 m** **302 m to 95 m** from Trig. Mast  
 2. Mast & Vanes have been painted white & black respectively.  
 3. The station was unpiled/~~was unpiled~~ on **31st August 1982**, dimensions now being:  
 Description of mark **Base Plug** should be explicit, e.g., S/Steel Pillar Plate, Steel plug, Brass plug, Bolt, G.I. Pipe  
 Height of mark **0.015** m above rock/~~concrete~~; Mark is **above** G.L.  
 Height of Top Vanes to Top Mark/Pillar plate ..... m. Diameter of Vanes (vertical) ..... m.  
 Height of Cairn ..... m. Diameter of Cairn ..... m. Name Plate found/not found/placed.  
 Length of Mast ..... m. (approximate if not unpiled)  
 4. A **S.S.M.** set in conc/~~rock~~ has been ~~found~~/found, bearing **10** ° **N** from ~~Mast/Plug/Pillar~~  
 5. A **G.I. Pipe** set in conc/~~rock~~ has been placed/~~found~~, bearing **270** ° **M** from ~~Mast/Plug/Pillar~~  
 6. A ..... set in conc/rock has been placed/~~found~~, bearing ..... ° **M** from Mast/Plug/Pillar  
 7. A ..... set in conc/rock has been placed/~~found~~, bearing ..... ° **M** from Mast/Plug/Pillar  
 8. Action required: .....

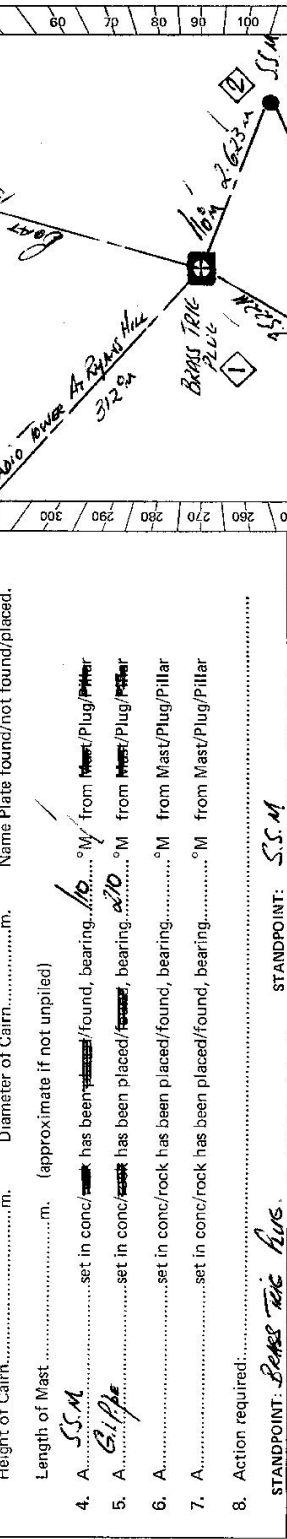

Mark	Direction	Horiz. Distance	Height Difference	Mark	Direction	Horiz. Distance	Height Difference
<b>BOAT G.S.P.</b>	<b>0 00 00</b>		above standpt.	<b>BOAT G.S.P.</b>	<b>0 00 00</b>		above standpt.
<b>S.S.M.</b>	<b>89 34 30</b>	<b>2.622</b>	above standpt.	<b>G.I. Pipe</b>	<b>23 24 20</b>	<b>3.935</b>	above standpt.
<b>G.I. Pipe</b>	<b>189 27 40</b>	<b>2.522</b>	above standpt.	<b>BRASS TRIG PLUG</b>	<b>289 33 20</b>	<b>2.623</b>	above standpt.
<b>RADIO TOWER A</b>	<b>282 32 20</b>		above standpt.	<b>RADIO TOWER A</b>	<b>282 32 20</b>		above standpt.
<b>BRASS HILL</b>			above standpt.	<b>BRASS HILL</b>			above standpt.
			above standpt.				above standpt.
			above standpt.				above standpt.

STANDPOINT: **BRASS TRIG PLUG**      STANDPOINT: **S.S.M.**  
 Prepared by: **P. BOTT**      18th September 1982      Checked: **P. BOTT**      21/9/82      Noted on U.T.M. Card  
 Sr 2733-1

GS 24

STATION <b>Boomanomana 6-S 6923</b>		Owner's Name: ..... Address: ..... Phone: ..... Current Occupant: ..... Address: ..... Phone: ..... Access Report of 31/5/1982 was found suitable/unsuitable. ACCESS																																																																																																																																																																																																																																						
Beacon Diagram	Not to Scale	<table border="1" style="width: 100%; border-collapse: collapse; height: 200px;"> <tr><td style="width: 5%;"></td><td style="width: 5%;"></td><td style="width: 5%;"></td><td style="width: 5%;"></td><td style="width: 5%;"></td><td style="width: 5%;"></td><td style="width: 5%;"></td><td style="width: 5%;"></td><td style="width: 5%;"></td><td style="width: 5%;"></td><td style="width: 5%;"></td><td style="width: 5%;"></td><td style="width: 5%;"></td><td style="width: 5%;"></td><td style="width: 5%;"></td><td style="width: 5%;"></td><td style="width: 5%;"></td><td style="width: 5%;"></td><td style="width: 5%;"></td><td style="width: 5%;"></td></tr> <!-- Multiple empty rows for the grid --> <tr><td></td><td></td><td></td><td></td><td></td><td></td><td></td><td></td><td></td><td></td><td></td><td></td><td></td><td></td><td></td><td></td><td></td><td></td><td></td><td></td><td></td></tr> <tr><td></td><td></td><td></td><td></td><td></td><td></td><td></td><td></td><td></td><td></td><td></td><td></td><td></td><td></td><td></td><td></td><td></td><td></td><td></td><td></td><td></td></tr> <tr><td></td><td></td><td></td><td></td><td></td><td></td><td></td><td></td><td></td><td></td><td></td><td></td><td></td><td></td><td></td><td></td><td></td><td></td><td></td><td></td><td></td></tr> <tr><td></td><td></td><td></td><td></td><td></td><td></td><td></td><td></td><td></td><td></td><td></td><td></td><td></td><td></td><td></td><td></td><td></td><td></td><td></td><td></td><td></td></tr> <tr><td></td><td></td><td></td><td></td><td></td><td></td><td></td><td></td><td></td><td></td><td></td><td></td><td></td><td></td><td></td><td></td><td></td><td></td><td></td><td></td><td></td></tr> <tr><td></td><td></td><td></td><td></td><td></td><td></td><td></td><td></td><td></td><td></td><td></td><td></td><td></td><td></td><td></td><td></td><td></td><td></td><td></td><td></td><td></td></tr> <tr><td></td><td></td><td></td><td></td><td></td><td></td><td></td><td></td><td></td><td></td><td></td><td></td><td></td><td></td><td></td><td></td><td></td><td></td><td></td><td></td><td></td></tr> <tr><td></td><td></td><td></td><td></td><td></td><td></td><td></td><td></td><td></td><td></td><td></td><td></td><td></td><td></td><td></td><td></td><td></td><td></td><td></td><td></td><td></td></tr> <tr><td></td><td></td><td></td><td></td><td></td><td></td><td></td><td></td><td></td><td></td><td></td><td></td><td></td><td></td><td></td><td></td><td></td><td></td><td></td><td></td><td></td></tr> <tr><td></td><td></td><td></td><td></td><td></td><td></td><td></td><td></td><td></td><td></td><td></td><td></td><td></td><td></td><td></td><td></td><td></td><td></td><td></td><td></td><td></td></tr> </table>																																																																																																																																																																																																																																						
This section to be completed by officer constructing pillar. Original station mark found/not found. Description of mark: ..... Original beacon found/not found. Description of beacon: ..... Height Top of Vanes to Top Mark: .....m. Height of mark: .....m. above G.L. below G.L. Diameter of Vanes .....m. Height of Cairn .....m. Original Beacon has/has not been destroyed by me.																																																																																																																																																																																																																																								
Date	Record of Station																																																																																																																																																																																																																																							

CENTRAL MAPPING AUTHORITY  
 GEODETIC SURVEY OF M.S.W.  
 GEODETIC STATION RECONNAISSANCE and MAINTENANCE REPORT

STATION: **BOMANODMANA G.S.O** No.: **6923**  
 MAP SHEET  
 SCALE 1:250 000  
 INSPECTED BY: **P.B.R.S.** DATE: **4.9.82**  
 AUTHORITY: **C.M.A.** FIELD BOOK: **1668**

Description:  
 1. Cleared by lanes bearing **625 m to 346 m**, **350 m to 95 m** from Trig. Mast  
 Note: Cross out word or words which do not apply  
 2. Mast & Vanes have been painted white & black respectively.  
 3. The ~~station~~ pillar was ~~replaced~~ constructed on **2nd September 1982**, dimensions now being:  
 Description of mark **Sp. Pine Bolt** should be explicit, e.g. S/Steel Pillar Plate, Steel plug, Brass plug, Bolt, G.I. Pipe  
 Height of mark **1.375** m. above ~~rock~~ concrete; Mark is **1.575** m. above G.L.  
 Height of Top Vanes to Top ~~rock~~ Pillar plate **2.826** m. Diameter of Vanes (vertical) **105** m.  
 Height of Cairn.....m. Diameter of Cairn.....m. Name Plate found/not ~~found~~ placed.  
 Length of Mast.....m. (approximate if not unplied)  
 4. A **S.S.M** set in conc/~~rock~~ has been ~~found~~ placed, bearing **110** ° M from ~~Mast/Pillar~~ Pillar  
 5. A **G.I. Pipe** set in conc/~~rock~~ has been placed/~~found~~, bearing **270** ° M from ~~Mast/Pillar~~ Pillar  
 6. A..... set in conc/~~rock~~ has been placed/~~found~~, bearing..... ° M from Mast/Plug/Pillar  
 7. A..... set in conc/~~rock~~ has been placed/~~found~~, bearing..... ° M from Mast/Plug/Pillar  
 8. Action required:.....

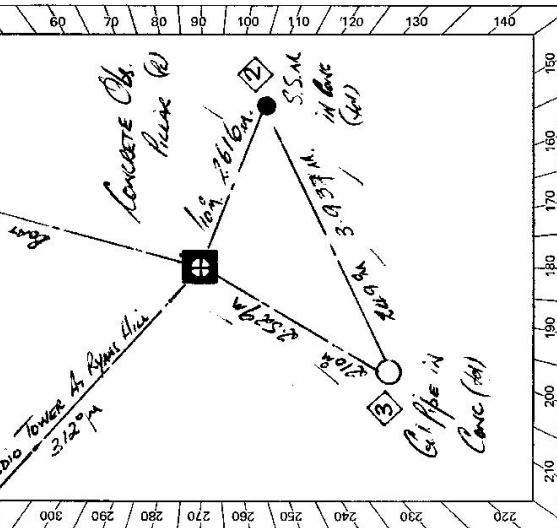

Mark	Direction	Horiz. Distance	Height Difference	Mark	Direction	Horiz. Distance	Height Difference
BOAT G.S.O	0 00 00		above standpt.	BOAT G.S.O	0 00 00		above standpt.
S.S.M	89 43 10	2.616	below standpt.	G.I. Pipe	230 20 00	3.937	above standpt.
G.I. Pipe	189 30 20	2.529	below standpt.	CONC OBS Pillar	289 43 40	2.616	above standpt.
Radio Tower A	282 32 20		above standpt.	Radio Tower A	282 33 00		above standpt.
Sp. Pine Bolt			below standpt.	Sp. Pine Bolt			below standpt.
			below standpt.				below standpt.
			below standpt.				below standpt.

STANDPOINT: **CONC OBS Pillar**      STANDPOINT: **S.S.M**  
 Prepared by: **P.B.R.S.** Date: **4th September 1982** Checked: **P.B.R.S.** 21/9/82  
 Station Diagram  
 North  
 North to Scale  
 220 230 240 250 260 270 280 290 300 310 320  
 140 150 160 170 180 190 200 210  
 Checked

GS 24

STATION **BOOMANONGA G.S. 6923**

Owner's Name: **ALICE MA WASH SLATTERY**  
 Address: **"DAX RANGE" YARRAMONGA ROAD**  
 Phone: **057 45 82 19**

Current Occupant: **LEIDGE**  
 Address: **MR. FREDERICK KENNEDY "ROSE PARK" MUMWALA**  
 Phone: **057 45 82 33**

**ACCESS**

Access Report of 19/11/88 was found suitable/unsuitable.  
**ACCESS**  
 1.4M FENCE  
 0.00 ASST OFFICE TO CUMMINS HEAD EAST TOMKOS BARROGA & MUMWALA  
 16.28 TURN RIGHT SIGN COORAM & CORONIA  
 16.35 TURN LEFT SIGN CORONIA  
 18.61 PASS COORAM TURN ON RIGHT  
 37.77 TURN LEFT AT INTERSECTION MUMWALA - BARROGA ROAD & YARRAMONGA RD  
 38.96 BRIDGE OVER MUMWALA CANAL  
 41.80 TURN LEFT THROUGH DOUBLE ION GATES & FOLLOW TRACK ALONG TO LEFT  
 42.93 100M GATE  
 43.01 TAKE TRACK TO LEFT UP RIDGE  
 43.33 TAKE TRACK TO LEFT UP RIDGE  
 43.56 BOOMANONGA G.S. PILLAR

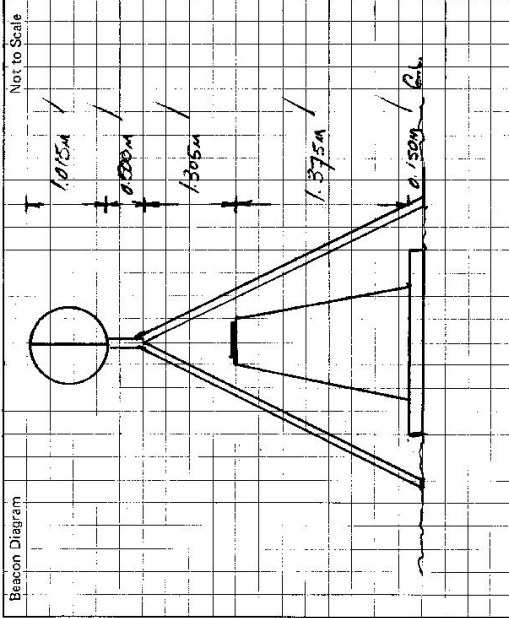

This section to be completed by officer constructing pillar.

Original station mark found/~~not found~~.  
 Description of mark: **Base 72c Pins**  
 Original beacon found/~~not found~~.  
 Description of beacon: **Quad 20 600**  
 Height Top of Vanes to Top Mark **1.4m** above G.L.  
 Height of mark **1.05m** above rock/~~below~~ m. below G.L.  
 Diameter of Vanes **46** m.  
 Original Beacon ~~has~~ has not been destroyed by me. **✓**

Date	Record of Station



SI 2135-2 E, West, Government Printer

TS 6923

STATION BOOMANDOMANA (P)

Beacon Diagram

Not to Scale

This section to be completed by officer constructing pillar.

Original station mark found/not found:

Description of mark:

Original beacon found/not found:

Description of beacon: **29 AUG 1995**

Height Top of Vane to Top Mark: **0.0** m.

Height of mark: **0.0** m. above rock/cont. **0.0** m. below G.L.

Diameter of Vane: ..... m. Height of Cairn: ..... m.

Original Beacon has/has not been destroyed by me.

Date	Record of Station
0.0	On Tocumwal - Corowa Rd & Berrigan - Barooga Rd intersection about 2km N of Barooga. Take road towards Corowa or MULWALA.
21.6	Turn L (North) on Yarrawonga Rd at MT Gwynne
2.7	Telephone exchange.
2.7	Bridge (MULWALA canal)
23.5	Road bends L. (straight shes to access owner)
25.3	Road bends R.
* 25.8	Turn L through double iron gates (Sometimes Locked)
26.85	wire gate
26.9	Pass track on R (ie stay on main road)
27.3	At quarry turn hard L and follow track up ridge
27.5	BOOMANDOMANA (P)

Owner's Name: **Access: Hugh Slattery**

Address: **"Oak Range"**

**Yarrawonga Rd MT Gwynne**

Phone: **03 5745 8219**

\* **LOCKED GATE** ACCESS

Access Report of: ...../...../19..... was found suitable/unusable.

Current Occupant: .....

Address: .....

Phone: .....

**2wd sedan 29.7.97**