

STATION: **BRADLEY** No.: **6885**
 MAP SHEET No.: **1130**
 SCALE 1:250 000
 INSPECTED BY: **D. MOSS** DATE: **17.3.82**
 AUTHORITY: **C. M. A** FIELD BOOK: **2000**

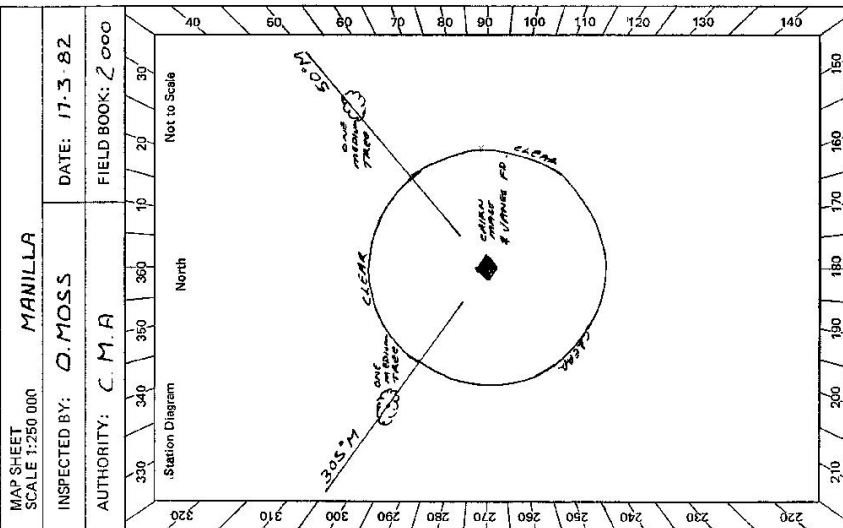

CENTRAL MAPPING AUTHORITY
 GEODETIC SURVEY OF N.S.W.
 GEODETIC STATION RECONNAISSANCE and MAINTENANCE REPORT

Description:
 Note: Cross out word or words which do not apply
 1. Cleared by vanes bearing..... **360°** ~~ALSO SEE DIAGRAM~~ from Trig. Mast
 2. Mast & Vanes have been painted white & black respectively.
 3. The station/pillar was ~~erected~~ ~~not unpiled~~ ~~erected~~ on..... **17th March 1982**..... dimensions now being:
 Description of mark..... should be explicit, e.g., S/Steel Pillar Plate, Steel plug, Brass plug, Bolt, G.I. Pipe
 Height of mark.....^{above} rock/concrete; Mark is.....^{above} G.L.
 Height of Top Vanes to Top Mark/Pillar plate.....^{above}.....m. Diameter of Vanes (vertical).....m.
 Height of Cairn.....^{above}.....m. Diameter of Cairn.....m. Name Plate found/not found/placed.
 Length of Mast.....m. (approximate if not unpiled)
 4. A.....^{above} set in conc/rock has been placed/found, bearing.....° M from Mast/Plug/Pillar
 5. A.....^{above} set in conc/rock has been placed/found, bearing.....° M from Mast/Plug/Pillar
 6. A.....^{above} set in conc/rock has been placed/found, bearing.....° M from Mast/Plug/Pillar
 7. A.....^{above} set in conc/rock has been placed/found, bearing.....° M from Mast/Plug/Pillar
 8. Action required:..... ~~CONSTRUCT PILLAR~~ ~~ONE WITNESS MARK~~ ~~CLEAR 2 TREES~~

STANDPOINT:

Mark	Direction	Honz. Distance	Height Difference	Mark	Direction	Honz. Distance	Height Difference
HAYSTACK	269° 11'	13.8	3.8' above standpt	HONEYBUCKLE	156° 23'	23.8	11.1' below
GEORGES MTN	36° 12'	15.5	1.1' above standpt	ROUND MTN	184° 14'	23.5	1.1' below
DRUMMOND	310° 14'	25.4	1.1' above standpt				
SENTRY BOX	314° 52'	16.3	1.1' above standpt				
BRAGGY	86° 53'	15.5	1.1' above standpt				
RANKIN	135° 33'	13.2	1.1' above standpt				
YARROWYK	121° 42'	23.5	11.1' below				

Prepared by: **P. J. Moss** Checked: **17/3/82** Noted on U.T.M. Card
 S: 2738-1 Checked

Sr: 2733-2 D. West, Government Printer

STATION **BRADLEY** **6885**

Owner's Name: **POWDER RIVER PASTORAL CO** Current Occupant: **J. MAHER**
 Address: **61- DAVID VAIENT** Address: **LABRA STN**
WALLUMUNAI STN WOLLUMUBI
AR. CITY OFFICE Phone: **BRADLEY 6885**
95 FAULKNER ACCESS NOTE: **BRADLEY G.S IS ON 'GLANMIAE'**
RAMIDALE **APPPOINTED SOON**
A NEW MANAGER IS TO BE
APPOINTED SOON

Access Report of **19** was found **unsuitable**.
AT BUNDARRA RD HEADING SOUTH AT 1.7KM TURN LEFT TOWARDS RAMIDALE
CROSS ABRINGTON CREEK
TURN RIGHT THRU "GLANMIAE" GATE
PASS BETWEEN SHEDS (L.H.S.) & DAM (R.H.S.)
GRID
GRID - DAM ON L.H.S. YARDS ON R.H.S.
TAKE RIGHT FORK PASSING WOOLSHEDS ON LEFT
IRON GATE
TAKE RIGHT FORK
PASS POINT TRACK ON R.H.S.
TAKE PAINT TRACK ON LEFT
GO THRU IRON GATE & STRAIGHT AHEAD
PASS DAM ON L.H.S. & R.H.S. AT 23.16
THRU IRON GATE - FOLLOW TRACK
PASS HAYSHED ON R.H.S.
GO THRU IRON GATE - STRAIGHT AHEAD & FOLLOW TRACK
GO THRU DOUBLE IRON GATE - GO STRAIGHT AHEAD ACROSS Paddock TO FENCE
TURN LEFT & FOLLOW FENCE.
TURN RIGHT THRU IRON GATE THEN HEAD TOWARDS GULLY (BEARING 235°M
& UP TO TRK (500M)

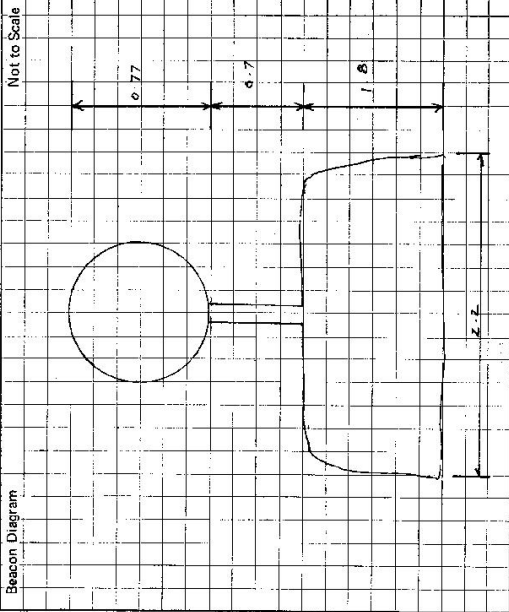

This section to be completed by officer constructing pillar.

Original station mark found/not found.

Description of mark:

Original beacon found/not found.

Description of beacon:

Height Top of Vanes to Top Mark:m.

Height of mark:m. above G.L.
m. below

Diameter of Vanesm. Height of Cairnm.

Original Beacon has/not been destroyed by me.

Date	Record of Station
17.3.82	PERMISSION TO CONSTRUCT PILLAR & CLEAR FROM J. MAHER (MANAGER OF LABRA STN & ACTING MANAGER 'GLANMIAE'. CONTACT OF NEW MANAGER WOULD BE ESSENTIAL BEFORE WORK COMMENCED

GEODETIC SURVEY OF M.S.W.

CENTRAL MAPPING AUTHORITY

GEODETIC STATION RECONNAISSANCE and MAINTENANCE REPORT

Description: ~~Clear~~ ^{360°} Note: Cross out word or words which do not apply

1. Cleared ~~by~~ bearing..... 360° from Trig. Mast

2. Mast & Vanes have been painted white & black respectively. ✓

3. The ~~eastern~~ pillar was ~~unplaced/not unplaced~~/constructed on..... 7 - S - 19.82..... dimensions now being:

Description of mark..... ~~S/S Pillar~~ P should be explicit, e.g., S/Steel Pillar Plate, Steel plug, Brass plug, Bolt, G.I. Pipe

Height of mark..... 1.375..... m. above rock/concrete; / Mark is 1.595..... m. above below G.L.

Height of Top Vanes to Top ~~Mark~~/Pillar plate 1.420..... m. Diameter of Vanes (vertical)..... 0.750..... m.

Height of Cairn..... m. Diameter of Cairn..... m. Name Plate ~~found~~/not ~~found~~/placed.

Length of Mast..... m. (approximate if not unplaced)

4. A..... ~~BRASS~~ ^{TRIC PILLAR} set in conc/~~rock~~ has been ~~placed~~/found, bearing..... 50..... °M from Mast/~~Plug~~/Pillar

5. A..... ~~COPPER NAIL~~ set in conc/~~rock~~ has been ~~placed~~/found, bearing..... 244..... °M from Mast/~~Plug~~/Pillar

6. A..... set in conc/~~rock~~ has been placed/found, bearing..... °M from Mast/~~Plug~~/Pillar

7. A..... set in conc/~~rock~~ has been placed/found, bearing..... °M from Mast/~~Plug~~/Pillar

8. Action required:.....

STANDPOINT: S/S PILLAR PLATE				STANDPOINT: TRIC PILLAR			
Mark	Direction	Horiz. Distance	Height Difference	Mark	Direction	Horiz. Distance	Height Difference
RANKIN CS	0 00 00		above standpt.	RANKIN CS	0 00 00		above standpt.
SENTRY BOX CS	179 19 55		above standpt.	S/S PILLAR PL	106 18 40	2.266	below standpt.
COPPER NAIL	221 01 00	8 842	below standpt.	SENTRY BOX CS	179 19 00		below standpt.
TRIC PILLAR	286 20 20	2.266	below standpt.	COPPER NAIL	206 23 50	8 159	below standpt.
			above standpt.				above standpt.
			below standpt.				below standpt.
			above standpt.				above standpt.
			below standpt.				below standpt.

Prepared by: *[Signature]* Checked: *[Signature]* Noted on U.T.M. Card

Sr 2733-1

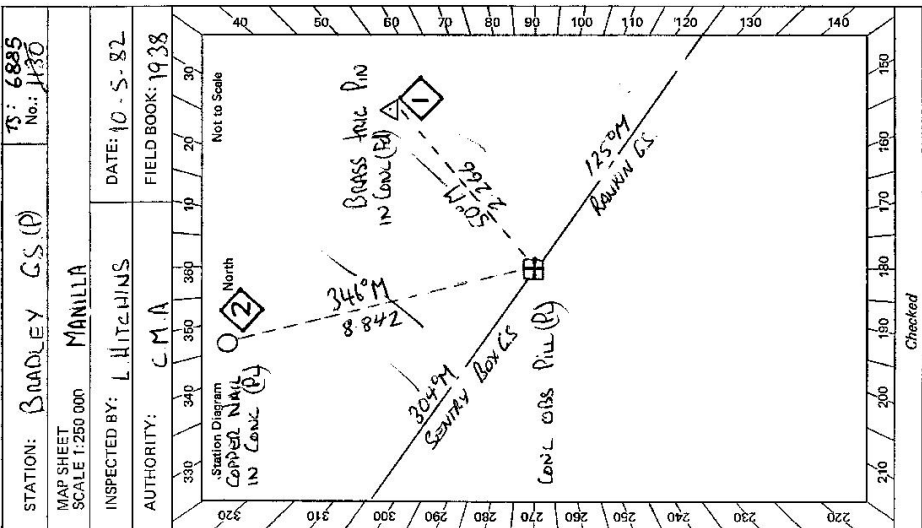

Sr 2733-2 D. West, Government Printer

STATION **BRADLEY C.S. (P) TS: 6885**

Owner's Name: **BRADLEY C.S. (P) TS: 6885**
 Address: **of DAVID MURPHY**
WILLIAM R. SMITH
 Phone: **of CITY OFFICE of I. COSET**
95 FLOUNDER'S NOMINALE

Current Occupant: **LETTER, ADMIRALTY**
 Address: **ADMIRALTY**
 Phone: **ADMIRALTY 5**
ACCESS 10-5-82

Access Report of 17/3/1982 was found suitable/unavailable.
 18 61 CROSS BRANTON CREEK
 19 36 TURN RIGHT THROUGH WOODEN GATES SIGN 'GLANMIDLE'.
 19 47 PASS HOUSE ON RIGHT + SUEDS ON LEFT
 20 58 GRID + GATE
 20 64 PASS TRACK ON RIGHT + YARDS ON LEFT.
 21 06 TURN RIGHT BEFORE SHEARING SHED
 21 16 THROUGH IRON GATE FOLLOW TRACK
 21 48 TAKE LEFT FORK.
 22 22 THROUGH GATE FOLLOW TRACK STRAIGHT AHEAD.
 23 39 THROUGH IRON GATE FOLLOW TRACK.
 23 94 PASS SHED ON RIGHT.
 24 25 THROUGH IRON GATE FOLLOW TRACK /
 25 02 THROUGH DOUBLE IRON GATES / HEAD STRAIGHT ACROSS Paddock.
 25 46 TURN LEFT ALONG FENCE / THEN TURN RIGHT ALONG FENCE /
 25 94 THROUGH GATE ON RIGHT THEN TURN RIGHT ALONG FENCE /
 25 98 TURN LEFT AWAY FROM FENCE HEAD UP Gully towards Hill.
 26 24 TURN LEFT AROUND / LARGE GUM TREE. HEAD UP SPUR to TRIG.
 26 70 BRADLEY C.S. (P)

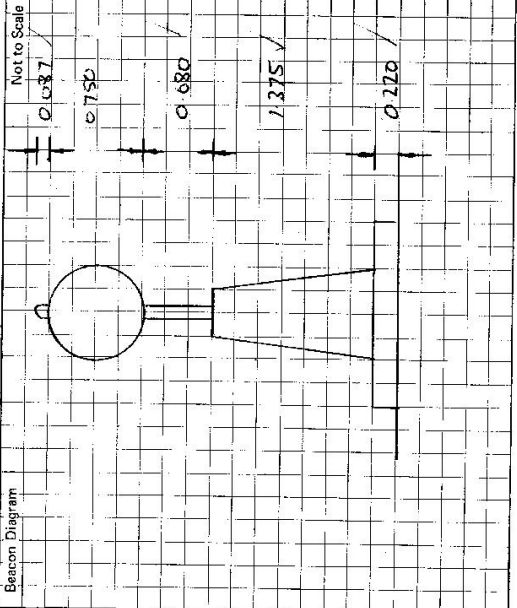

This section to be completed by officer constructing pillar.

Original station mark found/~~not found~~.
 Description of mark: **ROSS TALL PILE**
 Original beacon found/~~not found~~.
 Description of beacon: **CAIRN PILE + DISK**
 Height Top of Vanes to Top Mark: **3.053** m.
 Height of mark **0.017** m. above **0.163** m. below G.L.
 Diameter of Vanes **0.763** m. Height of Cairn **1.620** m.
 Original Beacon has/~~has not~~ been destroyed by me.

Date	Record of Station