

CENTRAL MAPPING AUTHORITY
Department of Lands

Trigonometrical Survey of N.S.W.

RECONNAISSANCE and MAINTENANCE REPORT

This Trig. Station has been:-

Note: Cross out word or words which do not apply

1. Completely cleared to permit 360° vision to surrounding Trigs.
2. Cleared by lanes bearing *7.55.5* *Colony, 1000, 1000, 1000* from Trig. Mast *Colony & Tembarombar Trig 5152*
3. Trig. Mast & Vanes have been painted white & black respectively, *v*
4. The Trig. was unpiled/~~not~~ unpiled, dimensions now being:
Description of mark *BRASS PLUG* should be explicit, e.g. Steel plug, Brass plug, Bolt, G.I. Pipe
Height of mark *0.050* m ^{above} ~~below~~ rock/concrete m ^{above} ~~below~~ G.L.
Height of Top Vanes to Top Mark *3.170* m. Diameter of Vanes (vertical) *1.01* m.
Height of Cairn *1.40* m. Diameter of Cairn *1.50* m.
Length of Mast *3.170* m. (approximate if not unpiled)
5. A *BRASS MARK* set in conc/rock has been placed *3.500* m, bearing *75.3* °M from Trig. Mast
6. A *STEEL MARK* set in conc/rock has been placed *4.670* m, bearing *63* °M from Trig. Mast
7. A set in conc/soil has been placed m, bearing °M from Trig. Mast
8. A set in conc/rock has been placed m, bearing °M from Trig. Mast
9. Connection *CONC. MARK* to *STEEL MARK* : *2.820* m, bearing *27* °M
10. Connection to : m, bearing °M
11. Connection to : m, bearing °M
12. Connection to : m, bearing °M
13. Diff. Ht. *TRIG* *2.255* m. ^{above} ~~below~~ *TRIG* *1.195* m. ^{above} ~~below~~ *CONC. MARK* *1.060* m.
14. Diff. Ht. *TRIG* *2.440* m. ^{above} ~~below~~ *CONC. MARK* *1.300* m. ^{above} ~~below~~ *CONC. MARK* *1.140* m.
15. Diff. Ht. is m. ^{above} ~~below~~ m. ^{above} ~~below~~
16. Diff. Ht. is m. ^{above} ~~below~~ m. ^{above} ~~below~~

Prepared by: *J. W. [Signature]* (16-4-74) Checked:

Noted on U.T.M. Card *J. D. [Signature]*

STATION *GRANITE TS 6883*

Co: *SELBY* | Ph: *SEALMONT*

Map Sheet: *YARRAPARILLI N* | No: *5526*

Inspected by: *K WOODHEAD* | Date: *25-3-74*

Authority: *C.M.A.* | Field Book: *A.9. 1256, 1357*

Beacon Diagram *Not to Scale*

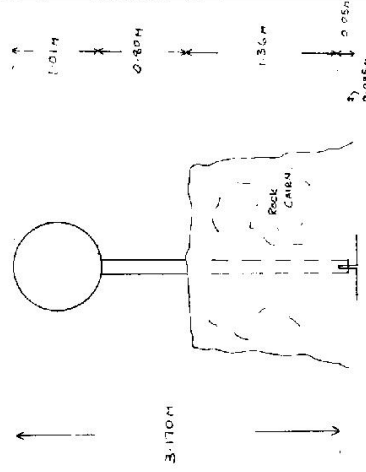

A.S. 1020

Date	Record of Station

Checked: *[Signature]*

STATION GRANITE T.S. 6883

Owners Name.....
 Current Occupant.....
 Address.....
 Address.....
 Access.....

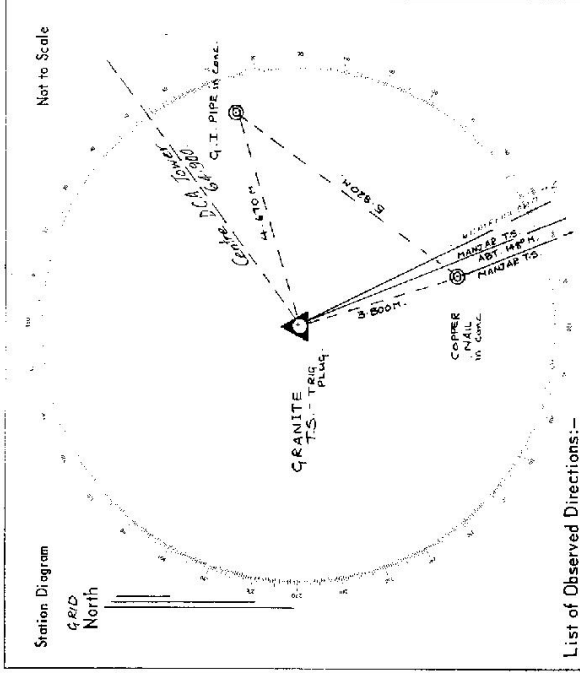

List of Observed Directions:-

Standpoint: TRIG. PLUG. IN CONC. FD.		Standpoint: COPPER NAIL IN CONC. FD.	
Station	Direction	Station	Direction
MANJAR T.S.	359° 59' 60"	MANJAR T.S.	359° 59' 60"
COPPER NAIL IN CONC. FD.	05° 38'	TRIG. PLUG. IN CONC. FD.	185° 30'
G.I. PIPE IN CONC. FD.	275° 59' 30"	G.I. PIPE IN CONC. FD.	238° 53' 00"
Centre of P.C.A. Tower	366° 15' 41"	Centre of P.C.A. Tower	253° 41' 30"
Centre of P.C.A. Tower	276° 23' 05"		

Station	Direction	Station	Direction

TS 6883
No. 2293

STATION: GRANITE
MAP SHEET SCALE 1:250 000
INSPECTED BY: R. LAMARCA
AUTHORITY: C.M.A.

WAGGA WAGGA
DATE: 16-12-89
FIELD BOOK: C0170

GEODETIC STATION RECONNAISSANCE and MAINTENANCE REPORT

Description: Note: Cross out word or words which do not apply

1. Cleared by lanes bearing ^{ANG} ~~MAZD~~ from Trig. Mast

2. Mast & Vanes ~~have been painted~~ white & black respectively.

3. The station/pillar was unpiled/not unpiled/constructed on 19 dimensions now being:

Description of mark should be explicit, e.g., S/Steel Pillar Plate, Steel plug, Brass plug, Bolt, G.I. Pipe

Height of mark m. above below rock/concrete; Mark is m. above below G.L.

Height of Top Vanes to Top Mark/Pillar plate m. ^{1.5} Diameter of Vanes (vertical) 1.0 m.

Height of Cairn m. ^{1.0} Diameter of Cairn m. Name Plate found/not found/placed.

Length of Mast 3.2 m. (approximate if not unpiled)

4. A set in conc/rock has been placed/found, bearing ° M from Mast/Plug/Pillar

5. A set in conc/rock has been placed/found, bearing ° M from Mast/Plug/Pillar

6. A set in conc/rock has been placed/found, bearing ° M from Mast/Plug/Pillar

7. A set in conc/rock has been placed/found, bearing ° M from Mast/Plug/Pillar

8. Action required. ~~CONCRETE PILLAR TO BE CONSIDERED AS OBSOLETE TO BE REMOVED TO SEE OR THIS IS AN OLD STATION - SEE MAPS~~ ^{CONCRETE PILLAR TO BE CONSIDERED AS OBSOLETE TO BE REMOVED TO SEE OR THIS IS AN OLD STATION - SEE MAPS}

STANDPOINT:

Mark	Direction	Horiz. Distance	Height Difference	Mark	Direction	Horiz. Distance	Height Difference
			above standpt				above standpt
			below				below
			above standpt				above standpt
			below				below
			above standpt				above standpt
			below				below
			above standpt				above standpt
			below				below
			above standpt				above standpt
			below				below
			above standpt				above standpt
			below				below

Prepared by: R. LAMARCA 16-12-89/Checked: J. Fleming 18-12-89/Noted on U.T.M. Card

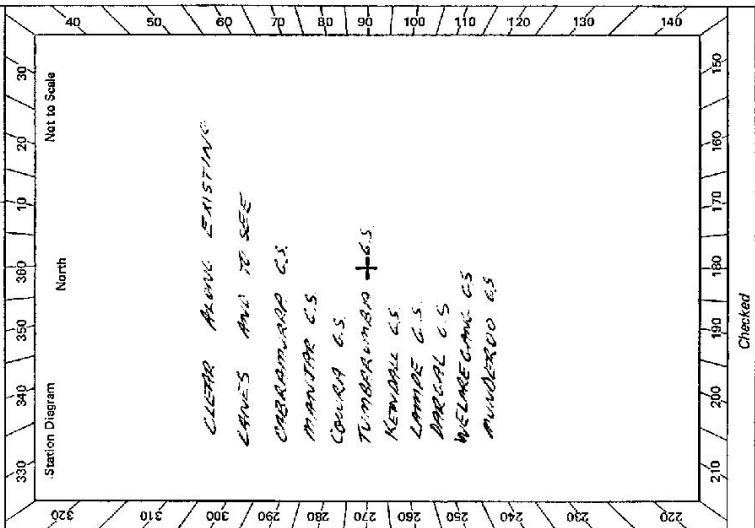

Checked

CENTRAL MAPPING AUTHORITY

GEODETIC SURVEY OF N.S.W.

GEODETIC STATION RECONNAISSANCE and MAINTENANCE REPORT

Description:

- Note: Cross out word or words which do not apply
1. Cleared by lanes bearing $162^{\circ} 20'$ to $165^{\circ} 10'$, $228^{\circ} 50'$ to $232^{\circ} 00'$, $232^{\circ} 00'$ to $235^{\circ} 30'$ from Trig. Mast 320 m to 333 m, $69^{\circ} 46'$ to 159° , $235^{\circ} 30'$ to 30°
 2. Mast & Vanes have been painted white & black respectively.
 3. The station/pillar was ~~unplanned/not completed~~/constructed on 15 m 19 83 , dimensions now being: 5 m 3 m 10 m

Description of mark: 5 m 3 m 10 m would be explicit, e.g., S/Steel Pillar Plate, Steel plug, Brass plug, Bolt, G.I. Pipe

Height of mark: 1.35 m. ^{above} ~~below~~ 1.515 m. ^{above} ~~below~~ G.L.

Height of Top Vanes to Top ~~Mark~~/Pillar plate: 14.42 m. Diameter of Vanes (vertical): 0.755 m.

Height of Cairn: m. Diameter of Cairn: m. Name Plate found/not found/placed.

Length of Mast: m. (approximate if not unpled)

4. A. Brass Trig Pipe set in ~~conc/rock~~ ^{found} has been ~~placed~~/found, bearing 16 $^{\circ}$ M from ~~Mark~~/Pillar
5. A. G.I. Pipe set in ~~conc/rock~~ ^{found} has been ~~placed~~/found, bearing 47 $^{\circ}$ M from ~~Mark~~/Pillar
6. A. Copper Niri set in ~~conc/rock~~ ^{found} has been ~~placed~~/found, bearing 90 $^{\circ}$ M from ~~Mark~~/Pillar
7. A. Aluminum Dumpy set in ~~conc/rock~~ ^{found} has been ~~placed~~/found, bearing 278 $^{\circ}$ M from ~~Mark~~/Pillar

8. Action required:

STANDPOINT: Cone Obs Pipe / Brass Trig Pipe

Mark	Direction	Horiz. Distance	Height Difference	Mark	Direction	Horiz. Distance	Height Difference
			above standpt. below				above standpt. below
Talbot's (20)	0 00 00	7.412	1.288	Talbot's (20)	0 00 00	4.673	0.277
G.I. Pipe	14 46 00	2.342	1.966	G.I. Pipe	36 42 40	3.502	0.277
Copper Niri	54 51 30	4.031	1.412	Copper Niri	148 15 00	3.536	1.067
Aluminum Dumpy	251 48 50	3.542	1.071	Cone Obs Pipe	165 11 10	5.519	0.302
Brass Trig Pipe	305 12 38	3.542	1.071	Talbot's (20)	212 01 26	5.519	0.302

Prepared by: P.Botts / 21.4.82 Checked: Johnson / 6/5/82 Noted on U.T.M. Card

St 2733-1

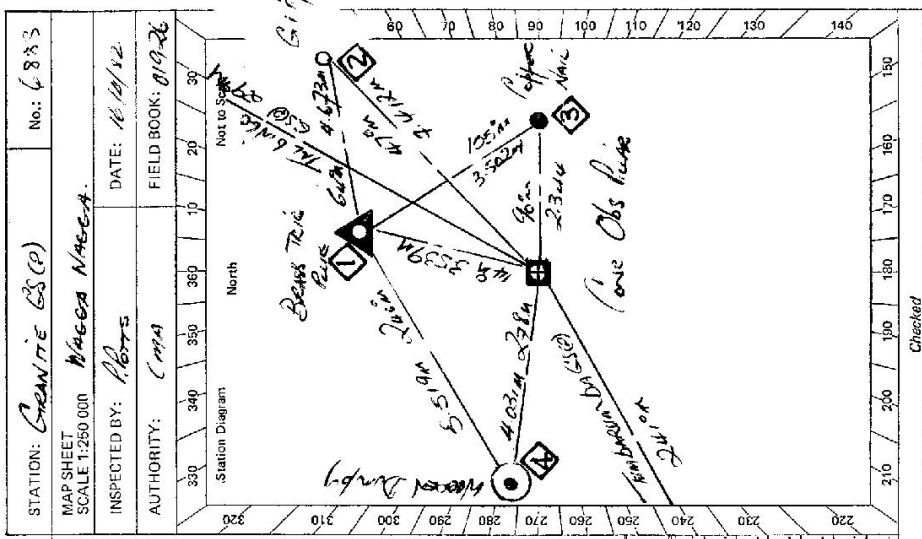

STATION: GRANITE 63 (P) No: 6883

MAP SHEET SCALE 1:250 000 N4600 N4600A

INSPECTED BY: P.Botts DATE: 16/11/82

AUTHORITY: C.M.A. FIELD BOOK: 01926

Checked

STATION **Granite (S) TS 6883**

Owner's Name: **TRIC RESERVE 29611** Current Occupant:
 Address: **NAGEA NAGEA L80** Address:
 Phone: **35 11 287** Phone:

ACCESS

Access Report of 16/1/1982 was found suitable/unsuitable.
 4/4 PEZZESE
 000 BOY OFFICE TOMBARUMIA HEAD SOUTH ABOVE MICKY STREET
 016 TOWN LEFT SIGN RECENT SWEEP /
 1737 TOWN LEFT SIGN GRANITE REPEATER STATION & KINDER, COOMA.
 3064 TOWN LEFT SIGN GRANITE REPEATER STATION
 3110 CAIRIS
 3170 CAIRIS
 3256 TAKE LEFT FOR GRANITE REPEATER STATION
 3386 TAKE RIGHT FOR FALCON MAIN TRACK
 3820 TAKE RIGHT FOR
 3880 GRANITE GEODETIC STATION

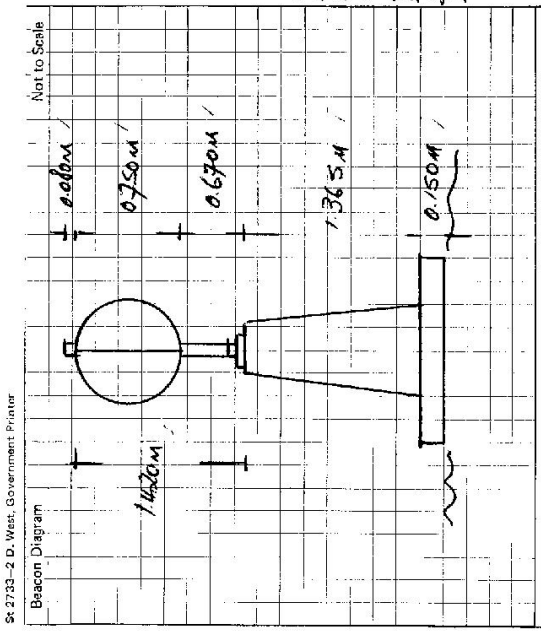

This section to be completed by officer constructing pillar.

Original station mark found/.....
 Description of mark: **BASES TRIC RUE.**
 Original beacon found/.....
 Description of beacon: **Cairn Pie f Disc**
 Height Top of Vanes to Top Mark: **3.135**.....m.
 Height of mark: **0.045** above rock/.....m. above G.L.
 Diameter of Vanes: **1.010**.....m. below
 Height of Cairn: **0.970**.....m.
 Original Beacon has/..... been destroyed by me.

Date	Record of Station