

7-2-98

CENTRAL MAPPING AUTHORITY
Department of Lands

Trigonometrical Survey of N.S.W.
RECONNAISSANCE and MAINTENANCE REPORT

STATION CURA GURA TS 6879
 Co: Wellington Ph: Coolamin
 Map Sheet: H11 End No: 8731-N
 Inspected by: I.W. Robins Date: 11/2/77
 Authority: CMA Field Book: H11 End.
 Beacon Diagram Not to Scale

This Trig. Station has been:-
 Note: Cross out word or words which do not apply

1. Completely cleared to permit 360° vision to surrounding Trig. but 1/2 day clearing on N side required
2. Cleared by lens-bearing from Trig. Mast
3. Trig. Mast & Vanes have been painted white & black respectively. Requires re painting
4. The Trig. was unpiled / not unpiled, dimensions now being: _____

Description of mark: _____ should be explicit, e.g. Steel plate, Brass plate, Bath, Gal. Pipe

Height of mark: _____ m above / below rock / concrete m above / below G.L.
 Height of Top Vanes to Top Mark: _____ m Diameter of Vanes (vertical) 0.76 m.

Height of Cairn: 1.8 m. Diameter of Cairn: 2.6 m.

Length of Mast: 2.99 m. (approximate if not unpiled)

5. A. _____ set in conc/rock has been placed _____ m bearing _____ m from Trig. Mast
6. A. _____ set in conc/soil has been placed _____ m bearing _____ m from Trig. Mast
7. A. ^{Appro} _____ set in conc/soil has been placed 2.2 m bearing _____ m from Trig. Mast
8. A. _____ set in conc/rock has been placed _____ m bearing _____ m from Trig. Mast

9. Connection _____ to _____ m bearing _____ m Suitable for pillar
10. Connection _____ to _____ m bearing _____ m Vehicle access across
11. Connection _____ to _____ m bearing _____ m paddock (any where) from
12. Connection _____ to _____ m bearing _____ m main road

13. Diff. Ht. _____ is _____ m above / below
14. Diff. Ht. _____ is _____ m above / below
15. Diff. Ht. _____ is _____ m above / below
16. Diff. Ht. _____ is _____ m above / below

Prepared by: I.W. Robins Checked: _____ Noted on U.T.M. Card

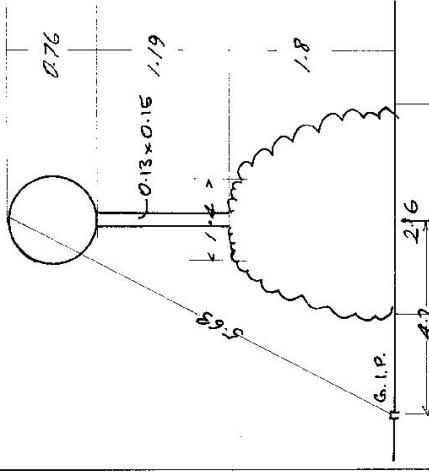

Date	Record of Station

TS 6879

CENTRAL MAPPING AUTHORITY

GEODETIC STATION RECONNAISSANCE and MAINTENANCE REPORT

STATION: CURRAGURRA

No.: 1745

Description:

Note: Cross out word or words which do not apply

- Cleared by lanes bearing 336° M \sim 142° M, 160° M \sim 192° M, 265° M \sim 322° M, from Trig. Mast
- Mast & Vanes have been painted white & black respectively
- The station/pillar was ~~unplaced~~/not unplaced/constructed on $15-07-81$, dimensions now being: Description of mark should be explicit, e.g., S/Steel Pillar Plate, Steel plug, Brass plug, Bolt, G.I. Pipe
Height of mark 2.8 m, above below rock/concrete; Mark is 2.6 m, above below G.L.
- Height of Top Vanes to Top Mark/Pillar plate 0.76 m. Diameter of Vanes (vertical) 0.76 m.
- Height of Cairn 1.8 m. Diameter of Cairn 2.6 m. Name Plate found/~~not found~~/placed.
- Length of Mast 2.8 m. (approximate if not unplaced)
- A. 2.8 m set in conc/rock has been placed/found, bearing 336° M from Mast/Plug/Pillar
- A. 160° M set in conc/rock has been placed/found, bearing 160° M from Mast/Plug/Pillar
- A. 142° M set in conc/rock has been placed/found, bearing 142° M from Mast/Plug/Pillar
- A. 192° M set in conc/rock has been placed/found, bearing 192° M from Mast/Plug/Pillar
- Action required: ~~PILLAR CONSTRUCTION AND SURVIVAL OF PILLAR VANES TO BAY TREES~~

STANDPOINT:

Mark	Direction	Horiz. Distance	Height Difference	Mark	Direction	Horiz. Distance	Height Difference
			above standpt.				above standpt.
			below standpt.				below standpt.
			above standpt.				above standpt.
			below standpt.				below standpt.
			above standpt.				above standpt.
			below standpt.				below standpt.
			above standpt.				above standpt.
			below standpt.				below standpt.

Prepared by: *MLL* 23-07-81

Checked: *MLL* 23-07-81

Noted on U.T.M. Card

SI 2753-1

MAP SHEET SCALE 1:250 000 BATHURST

INSPECTED BY: R. ELLIS

DATE: 15-07-81

AUTHORITY: C. M. A.

FIELD BOOK: 01917

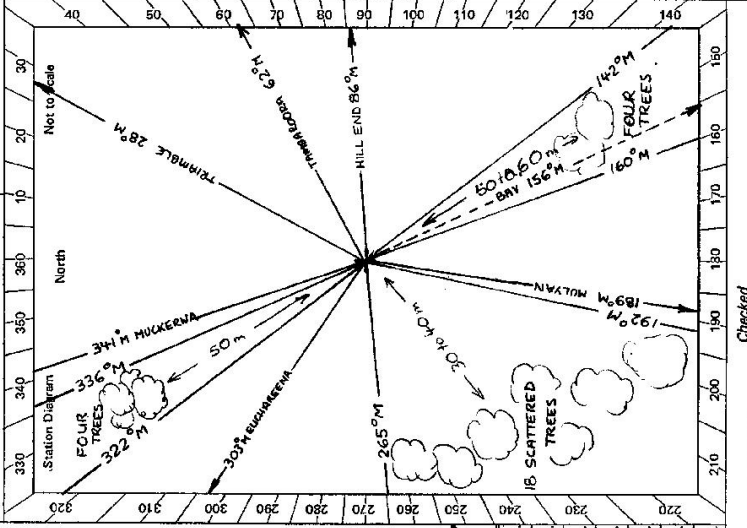

Checked

St 2733-2 D. West, Government Printer

STATION CURRAGURRA TS-6879

Owner's Name: MAXWELL TRUDGEY
 Address: * MERRINAH **
 Phone: (063) KERRES CK 14-D
 Current Occupant:
 Address:
 Phone:

ACCESS 15-7-1981
 ** HILL END 1:50,000 GR. 044464
 Access Report of 11/2/1977 was found suitable/unsuitable.

- | Km | Feature |
|-------|--|
| 0.0 | MULLION CREEK ~ INTERSECTION OF EUCHARRENA RD & LONG POINT RD.
HEAD EAST ALONG LONG POINT ROAD TOWARDS OPHIR. |
| 0.15 | RAILWAY CROSSING. |
| 1.8 | PASS ROAD TO OPHIR ON RIGHT |
| 12.0 | PASS ROAD TO OPHIR ON RIGHT - SIGN 'OPHIR 9' |
| 12.3 | GRID |
| 13.6 | GRID |
| 14.4 | GRID ~ TELEPHONE EXCHANGE ON LEFT |
| 15.2 | TAKE LEFT FORK ~ SIGN 'EUCHARRENA 13 Km' |
| 16.6 | IRON GATE |
| 17.5 | CROSS CREEK |
| 17.6 | GATEWAY |
| 18.8 | IRON GATE |
| 19.2 | HOUSE ON LEFT |
| 19.21 | TURN LEFT ~ FOLLOW TRACK TO SHED |
| 19.3 | PASS SHED KEEPING IT ON YOUR LEFT ~ THEN STRAIGHT AHEAD UP SMALL RIDGE |
| 19.8 | AT TOP OF RIDGE TURN RIGHT AND FOLLOW FAINT TRACK TO TRIG. |
| 20.4 | 'CURRAGURRA' TRIG |

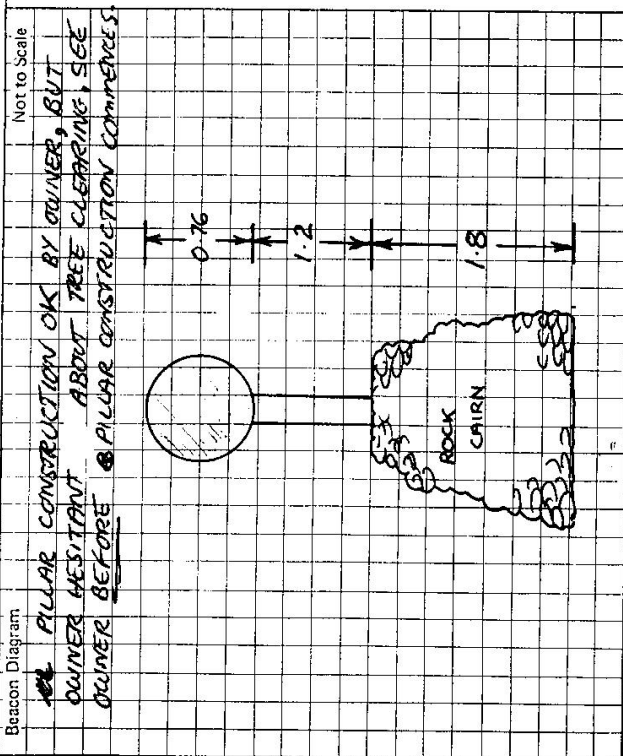

This section to be completed by officer constructing pillar.

Original station mark found/not found.

Description of mark:

Original beacon found/not found.

Description of beacon:

Height Top of Vanes to Top Markm.

Height of markm. above rock/concm. below G.L.

Diameter of Vanesm. Height of Cairnm.

Original Beacon has/has not been destroyed by me.

Date	Record of Station

CENTRAL MAPPING AUTHORITY

GEODETIC SURVEY OF N.S.W.

GEODETIC STATION RECONNAISSANCE and MAINTENANCE REPORT

STATION: *Careergara 650* No: *6879*
 MAP SHEET SCALE 1:250 000 *Earthwest*
 INSPECTED BY: *S. Kead* DATE: *7.5.82*
 AUTHORITY: *C.M.A.* FIELD BOOK: *01930*

- Description: *Note: Cross out word or words which do not apply*
- Cleared by lanes bearing *359m 145°, 140° to 191°, 230° to 285°*, from Trig. Mast
 - Mast & Vanes have been painted white & black respectively *298m to 327m*
 - The station/pillar was unpiled/not unpiled/constructed on *5m Above 19.82*, dimensions now being: *of 1.35m above rock/concrete; 1.435m above G.L.*
- Description of mark *of 1.35m above rock/concrete; 1.435m above G.L.* should be explicit, e.g. S/Steel Pillar Plate, Steel plug, Brass plug, Bolt, G.I. Pipe
- Height of mark *1.35* m. *above rock/concrete; 1.435* m. *above G.L.*
- Height of Top Vanes to Top *1.445* m. Diameter of Vanes (vertical) *0.750* m.
- Height of Cairn *1.445* m. Diameter of Cairn *0.750* m. Name Plate found/not found/placed.
- Length of Mast *1.445* m. (approximate if not unpiled)
- A. *Boss Trig* set in *conc/rock* has been *placed*/found, bearing *250°* M from *Mast/Pillar*
 - A. *Copper Nail* set in *conc/rock* has been *placed*/found, bearing *318°* M from *Mast/Pillar*
 - A. set in *conc/rock* has been *placed*/found, bearing *393°* M from *Mast/Pillar*
 - A. set in *conc/rock* has been *placed*/found, bearing *372°* M from *Mast/Pillar*

Action required: *Cone Obs. Pillar* STANDPOINT: *Boss Trig*

Mark	Direction	Horiz. Distance	Height Difference	Mark	Direction	Horiz. Distance	Height Difference
<i>ENCHAREEN (285)</i>	<i>0 00 00</i>		<i>above</i> standpt.	<i>ENCHAREEN (285)</i>	<i>0 00 00</i>		<i>above</i> standpt.
<i>GORMCORREE (318)</i>	<i>12 40 20</i>		<i>above</i> standpt.	<i>GORMCORREE (318)</i>	<i>12 39 30</i>		<i>above</i> standpt.
<i>Copper Nail (393)</i>	<i>13 03 46</i>	<i>3.893</i>	<i>7.322</i> <i>below</i> standpt.	<i>Copper Nail</i>	<i>12 44 00</i>	<i>4.558</i>	<i>0.60</i> <i>below</i> standpt.
<i>FREE MANTLE (372)</i>	<i>14 57 46</i>		<i>7.221</i> <i>below</i> standpt.	<i>Cone Obs. Pillar</i>	<i>13 44 00</i>	<i>4.119</i>	<i>1.219</i> <i>above</i> standpt.
<i>BOSS TRIG (253)</i>	<i>13 48 20</i>	<i>4.122</i>	<i>7.221</i> <i>below</i> standpt.	<i>FREE MANTLE (372)</i>	<i>14 57 50</i>		<i>above</i> standpt.
			<i>below</i> standpt.				<i>below</i> standpt.

Prepared by: *P.B.P.* 16.5.82. Checked: *J. Palmer* 11/5/82. Noted on U.T.M. Card

STATION **CURAGUABA (ESP)** TS 6879

Owner's Name: **MAXWELL TRUSTEES**
 Address: **MERRIMAN**
 Phone: **(063) 660149**
 Current Occupant:
 Address:
 Phone:

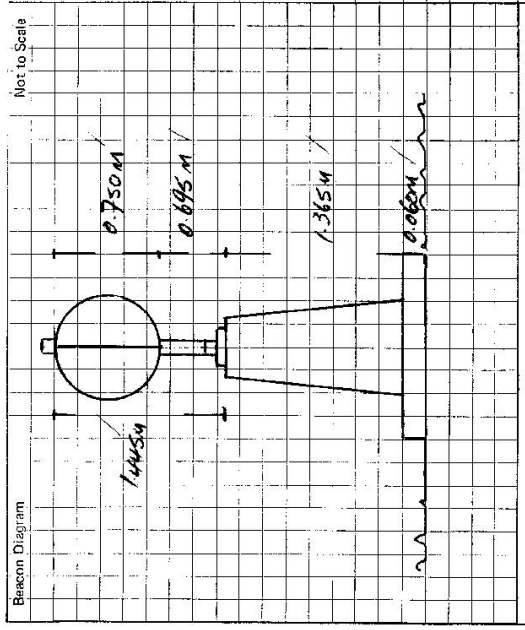

Access Report of 15/11/1988 was found suitable/unavailable.
ACCESS
 KM 0.00 MULLION CREEK INTERSECTION ON EDWARDS RD & LONG BUNT RD
 0.15 ROAD END ABOVE LONG BUNT RD TOWARDS OPHEE
 0.15 ROAD END ABOVE CROSSING
 1.80 PASS ROAD TO OPHEE ON RIGHT
 17.30 PASS ROAD TO OPHEE ON RIGHT
 17.60 GRAVE
 13.90 GRAVE
 14.70 GRAVE TELEPHONE EXCHANGE ON LEFT
 15.57 TAKE LEFT FOR SIGN EDWARDS RD 1341
 16.93 100M GATE
 17.90 CROSS CREEK
 17.96 GATEWAY
 19.20 100M GATE
 19.60 HOUSE ON LEFT
 19.63 TURN LEFT FOLLOW TRACK TO SHED
 19.70 PASS SHED KEEPING IT ON YOUR LEFT - THEN SHOOT UP SLOPE
 20.16 AT TOP OF RIDGE TURN RIGHT & FOLLOW HUNT TRACK TO 7816
 21.19 CURAGUABA (ESP)

This section to be completed by officer constructing pillar.

Date	Record of Station

Original station mark found/~~not found~~.
 Description of mark: **BASS TIC POLE**
 Original beacon found/~~not found~~.
 Description of beacon: **Cairn Pole & Disc**
 Height Top of Vanes to Top Markm.
 Height of mark **0.655** above rock/ **below** above G.L. belowm.
 Diameter of Vanes **0.660**m. Height of Cairn **1.760**m.
 Original Beacon has/has not been destroyed by me.

CENTRAL MAPPING AUTHORITY

GEODEIC SURVEY OF N.S.W.

GEODEIC STATION RECONNAISSANCE and MAINTENANCE REPORT

Description:

1. Cleared by lanes bearing: $339^{\circ} 26' 14.5''$ 145.0 191.0 222.2 275.0 from Trig. Mast
2. Mast & Vanes have been painted white & black respectively 296.5 327.0
3. The station/pillar was unplied/not unplied/constructed on 15^{th} 18^{th} dimensions now being:

Description of mark: 1^{st} 1^{st} should be explicit, e.g., S/Steel Pillar Plate, Steel plug, Brass plug, Bolt, G.I. Pipe
 Height of mark: 1.385 m, above rock/concrete; Mark is 1.425 m, above G.L.
 Height of Top Vanes to Top ~~mark~~ /Pillar plate: 1.445 m. Diameter of Vanes (vertical): 0.750 m.
 Height of Cairn: m. Diameter of Cairn: m. Name Plate found/not found/placed.
 Length of Mast: m. (approximate if not unplied)

4. A 1^{st} 1^{st} set in ~~conc/rock~~ has been placed/round, bearing: 330° 145 from Mast/Trig/Pillar
5. A 1^{st} 1^{st} set in ~~conc/rock~~ has been placed/round, bearing: 318° 145 from Mast/Trig/Pillar
6. A set in ~~conc/rock~~ has been placed/round, bearing: 1^{st} M from Mast/Plug/Pillar
7. A set in ~~conc/rock~~ has been placed/round, bearing: 1^{st} M from Mast/Plug/Pillar
8. Action required:

Mark	Direction	Horiz. Distance	Height Difference	Mark	Direction	Horiz. Distance	Height Difference
ENCLINEMENT	0 00		above standard	ENCLINEMENT	0 00		above standard
CONCRETE	12 46 20		above standard	CONCRETE	12 46 20		above standard
COPPER NAIL	13 03 46	3.893	above standard	COPPER NAIL	20 06 02	4.558	above standard
HEXAGONAL	197 57 46		below	HEXAGONAL	123 44 00	4.119	above standard
BONS TIC RUC	83 08 20	4.122	above standard	BONS TIC RUC	197 55 20		above standard
			below				below
			above standard				above standard
			below				below

Prepared by: *ABNS* *16.5.82* Checkd: *11/5/82* Noted on U.T.M. Card

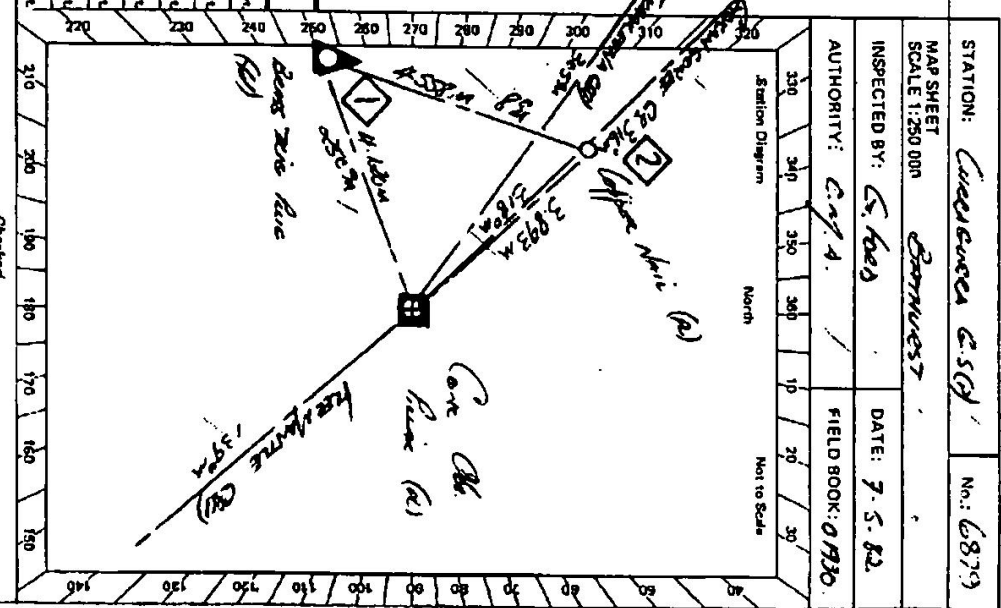

STATION: *WARRIENNA 250* No.: *6879*

MAP SHEET SCALE 1:250 000 *Barnes*

INSPECTED BY: *C. F. 608* DATE: *7.5.82*

AUTHORITY: *C.M.A.* FIELD BOOK: *01930*

BT 2733-2.0. Well, Government Printer

Beacon Diagram

Not to Scale

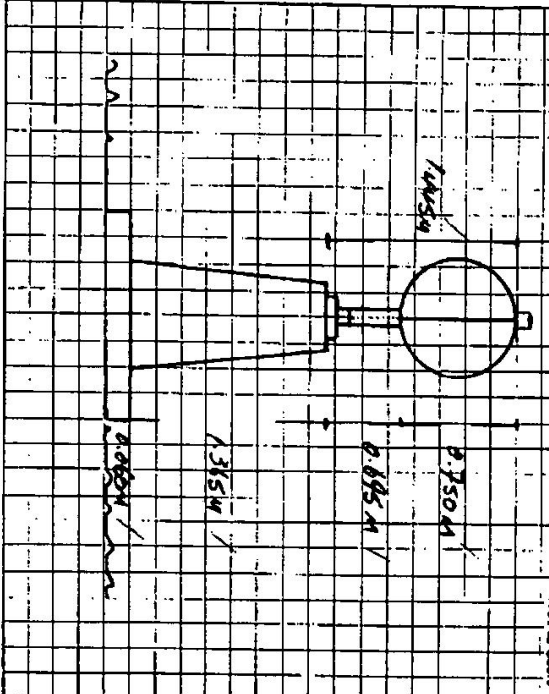

This section to be completed by officer constructing pillar.

Original station mark found/measured.

Description of mark: *Bees 720 Race 1*

Original beacon found/measured.

Description of beacon: *Paint Race 1 Disc*

Height Top of Vanes to Top Mark:

Height of mark: *0.85m* above rock/

Diameter of Vanes: *0.84m*

Original Beacon has/has not been destroyed by me.

STATION *CHICKEN COX (120) 15 68*

Owner's Name: *MURIEL TEUCEN*

Address: *MEERMAN - EUMALDENIA*

Phone: *(083) KERRS (X 4-4) (003) 660129*

ACCESS

Current Occupant:

Address:

Phone:

Access Report of 7.5.1982 was found suitable/unavailable.

KM 000

MURIEL TEUCEN INTERSECTION OF EUMALDENIA RD & LONG BAY RD. ROAD CROSS ABOVE LONG BAY RD TOWARDS OFFICE

0.15

RD BAY TO OFFICE ON RIGHT HAS ROAD TO OFFICE ON RIGHT

1.80

12.80

12.80

12.90

14.70

5.57

16.63

17.90

17.96

19.20

19.60

19.63

19.70

20.16

21.19

Access Report of 7.5.1982 was found suitable/unavailable.
KM 000
MURIEL TEUCEN INTERSECTION OF EUMALDENIA RD & LONG BAY RD. ROAD CROSS ABOVE LONG BAY RD TOWARDS OFFICE
0.15
RD BAY TO OFFICE ON RIGHT HAS ROAD TO OFFICE ON RIGHT
1.80
12.80
12.80
12.90
14.70
5.57
16.63
17.90
17.96
19.20
19.60
19.63
19.70
20.16
21.19

Date

Record of Station

CENTRAL MAPPING AUTHORITY

GEODETIC SURVEY OF N.S.W.

GEODETIC STATION RECONNAISSANCE AND MAINTENANCE REPORT

TS 6879

No: 1245

STATION: CURRAGURRA
 MAP SHEET BATHURST
 SCALE 1:250 000

INSPECTED BY: R. ELLIS
 DATE: 15-07-81

AUTHORITY: C. M. A.
 FIELD BOOK: 01917

Note: Cross out word or words which do not apply

1. Cleared by lanes bearing $336^{\circ}M \sim 162^{\circ}M, 160^{\circ}N \sim 192^{\circ}M, 285^{\circ}M \sim 328^{\circ}M$ from Trig. Mast
2. Mast & Vanes have been painted white & black respectively.
3. The station/pillar was ~~unapplied~~ not applied/connected on $15-07-1981$, dimensions now being:
 Description of mark: should be explicit, e.g. S/Steel Pillar Plate, Steel plug, Brass plug, Bolt, G.I. Pipe
 Height of mark: m. above rock/concrete; Mark is m. above G.L.
 Height of Top Vanes to Top Mark/Pillar plate: m. Diameter of Vanes (vertical): 0.76 m.
 Height of Cairn: 1.8 m. Diameter of Cairn: 2.6 m. Name Plate found/
 Length of Mast: 2.8 m. (approximate if not unplied)
4. A. set in conc/rock has been placed/found, bearing M from Mast/Plug/Pillar
5. A. set in conc/rock has been placed/found, bearing M from Mast/Plug/Pillar
6. A. set in conc/rock has been placed/found, bearing M from Mast/Plug/Pillar
7. A. set in conc/rock has been placed/found, bearing M from Mast/Plug/Pillar

B. Action required: PILLAR CONSTRUCTION AND SURROUNDING OF PEGS TO 650 MM

STANDPOINT:

STANDPOINT:

Mark	Direction	Hort. Distance	Height Difference	Mark	Direction	Hort. Distance	Height Difference
			above standard				above standard
			below				below
			above standard				above standard
			below				below
			above standard				above standard
			below				below
			above standard				above standard
			below				below
			above standard				above standard
			below				below
			above standard				above standard
			below				below

Prepared by: *W. J.*

23-07-81

Checked:

Noted on U.T.M. Card

Checked

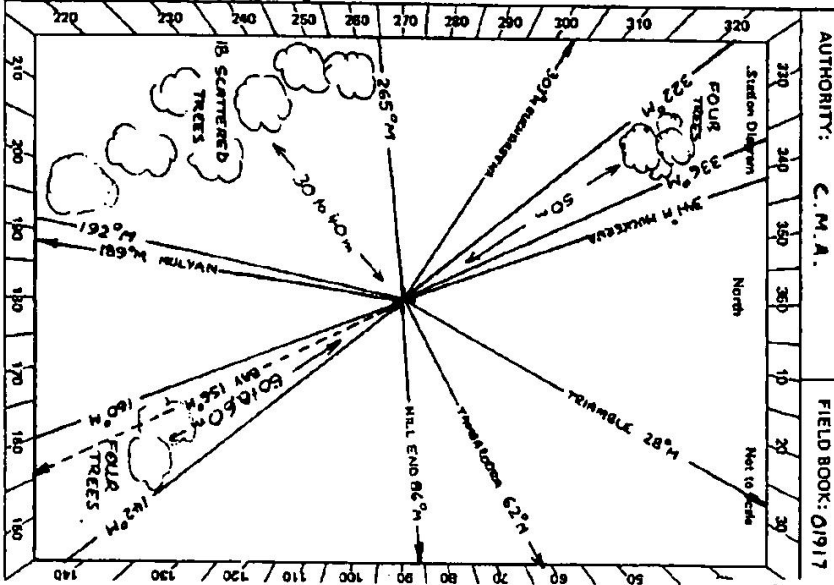

81 3730-1

West, Government Printer

30:am Not to Scale

PLUM CONSTRUCTION OK BY OWNER, BUT
 THE HEIGHT ABOUT TREE CLEARING, SEE
 ER BEFORE PLUM CONSTRUCTION COMMENCES

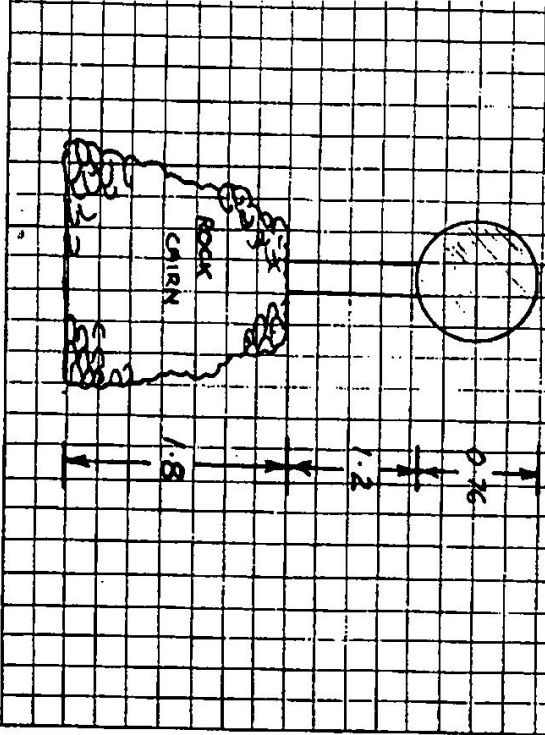

to be completed by officer constructing pillar.

tion mark found/not found.

of mark:

icon found/not found.

of beacon:

of Vanes to Top Mark:

ark: m. above rock/conc. m. above G.L.
 m. below m. below

Vanes: m. Height of Cairn m.

icon has/has not been destroyed by me.

STATION CURRAGURRA TS-6879

Owner's Name: MARWELL TRUBSETT

Address: "MERRINAH" #4

EUCHAREENA

Phone: (083) 4685 14-20

*** WILL END 1:50,000 GR. QU-464

Access Report of 11/2/1977: was found suitable/unsuitable.

Km

Feature

- 0.0 MULLION CREEK ~ INTERSECTION OF EUCHAREENA RD & LONG POINT RD.
- 0.15 HEAD EAST ALONG LONG POINT ROAD TOWARDS OPHIR.
- 1.0 RAILWAY CROSSING.
- 1.8 PASS ROAD TO OPHIR ON RIGHT
- 12.0 PASS ROAD TO OPHIR ON RIGHT - SIGN 'OPHIR 9'
- 12.3 GRID
- 13.6 GRID
- 14.4 GRID ~ TELEPHONE EXCHANGE ON LEFT
- 15.2 TAKE LEFT FORK ~ SIGN 'EUCHAREENA 13 Km'
- 16.6 IRON GATE
- 17.5 CROSS CREEK
- 17.6 GATEWAY
- 18.8 IRON GATE
- 19.2 HOUSE ON LEFT
- 19.21 TURN LEFT ~ FOLLOW TRACK TO SHED
- 19.3 PASS SHED KEEPING IT ON YOUR LEFT ~ THEN STRAIGHT AHEAD (10 SM SW) &
- 19.8 AT TOP OF RIDGE TURN RIGHT AND FOLLOW FAINT TRACK TO TRIG.
- 20.4 'CURRAGURRA' TRIG.

Current Occupant:

Address:

Phone:

ACCESS 15-7-1981

Date

Record of Station

Date	Record of Station

CENTRAL MAPPING AUTHORITY

Trigonometrical Survey of N.S.W.

Department of Lands

RECONNAISSANCE and MAINTENANCE REPORT

This Trig. Station has been:-

Note: Cross out word or words which do not apply

1. Completely cleared to permit 360° vision to surrounding Trig. Sta's 1/2 day clearing on W side required
2. ~~Cleared by lensed bearing~~ from Trig. Mast
3. Trig. Mast & Vanas have been painted white & black respectively. Requires repainting
4. The Trig. was unpainted/not unpainted, dimensions now being: _____

Description of mark: _____ should be explicit: eg. flag, plug, brass plug, ball, G.I. Pipe

Height of mark: _____ on above each / concrete _____ on below G.L.

Height of Top Vanas to Top Mark: _____ Diameter of Vanas (vertical): 0.76 m.

Height of Cairn: 1.8 m. Diameter of Cairn: 2.5 m.

Length of Mast: 2.99 m. (approximate if not unpainted)

5. ~~set in concrete~~ has been placed _____ m. bearing _____ M from Trig. Mast
6. ~~set in concrete/soil~~ has been placed _____ m. bearing _____ M from Trig. Mast
7. A ~~set~~ set in ~~concrete/soil~~ has been placed. Approx 2.2 m. bearing _____ M from Trig. Mast
8. ~~set in concrete/rock~~ has been placed _____ m. bearing _____ M from Trig. Mast
9. ~~Connection~~ _____ m. bearing _____ M Suitable for pillar
10. Connection _____ m. bearing _____ M Vehicle access across
11. Connection _____ m. bearing _____ M padlock (any where) from
12. Connection _____ m. bearing _____ M main road
13. Diff. Ht. _____ m. above _____ below
14. Diff. Ht. _____ m. above _____ below
15. Diff. Ht. _____ m. above _____ below
16. Diff. Ht. _____ m. above _____ below

Prepared by: I.W. Robins Checked: _____

Noted on U.T.M. Grid _____

STATION CURRA CURRA TS 68

Co: Wellington Ph: Coolammin

Map Sheet: Hill End No: 8731-N

Inspected by: I.W. Robins Date: 11/2/77

Authority: CMA Field Dept: Hill End

Beacon Diagram: _____ Nor to Scale

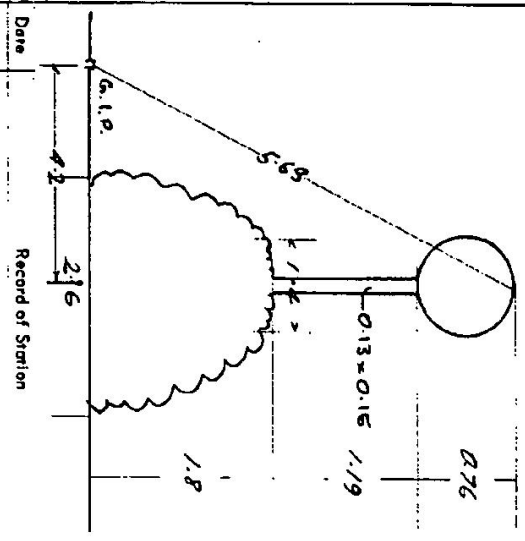

Date _____

Checked _____

