

RECONNAISSANCE and MAINTENANCE REPORT

STATION TELELL G.S TS 6766

Co: TELELL BANK Ph: TELELL
Map Sheet: WAG 64 No: _____
Inspected by: P. BERTS Date: 20/10/177
Authority: C.M.A. Field Book: 6165/LL

This Trig. Station has been:-
Note: Cross out word or words which do not apply

1. Completely cleared to permit 360° vision to surrounding Trigs.
2. Cleared by lances bearing. base black at base from Trig. Mast
3. Trig. Mast & Vanes have been painted white & black respectively.
4. The Trig. was unpiled/~~not unpiled~~ dimensions now being: base 14.5 m should be explicit, e.g. Steel plug, Brass plug, Bolt, G.I. Pipe

Description of mark: base 14.5 m should be explicit, e.g. Steel plug, Brass plug, Bolt, G.I. Pipe
Height of mark: 2.083 m above rock/concrete below G.L.
Height of Top Vanes to Top Mark: 2.982 m. Diameter of Vanes (vertical): 0.765 m.
Height of Cairn: 1.405 m. Diameter of Cairn: 0.126 m.

- Length of Mast: 2.083 m. (approximate if not unpiled)
5. A. S.S. set in conc/rock has been placed 2.810 m bearing 275°M from Trig. Mast
 6. A. G.I. Pipe set in conc/soil has been placed 3.375 m bearing 331°M from Trig. Mast
 7. A. _____ set in conc/soil has been placed _____ m bearing _____°M from Trig. Mast
 8. A. _____ set in conc/rock has been placed _____ m bearing _____°M from Trig. Mast
 9. Connection S.S. to G.I. Pipe: 2.410 m bearing 320°M
 10. Connection _____ to _____: _____ m bearing _____°M
 11. Connection _____ to _____: _____ m bearing _____°M
 12. Connection _____ to _____: _____ m bearing _____°M
 13. Diff. Ht. _____ is _____ m above _____ below _____
 14. Diff. Ht. _____ is _____ m above _____ below _____
 15. Diff. Ht. _____ is _____ m above _____ below _____
 16. Diff. Ht. _____ is _____ m above _____ below _____

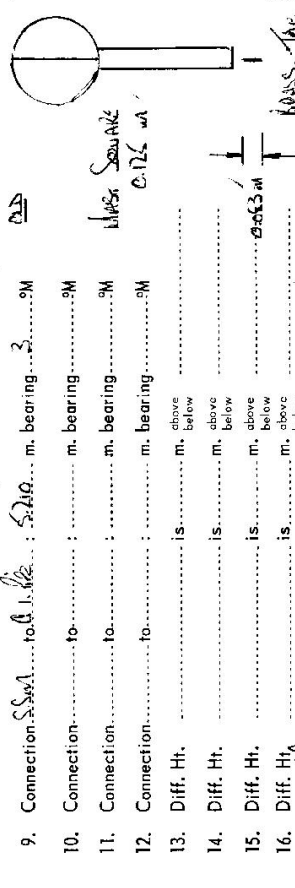

Prepared by: P. BERTS Date: 20/10/177 Checked: _____ Noted on U.T.M. Card

Beacon Diagram Not to Scale

Date _____ Record of Station _____

STATION REBELL C.S. TS 6766

Owners Name..... Current Occupant.....

Address..... Address.....

Access from WILKINSON 20/10/1977
WESTWICK
 Co. WILKINSON HEAD WEST TOWARDS CRESSILLS
 0.00 TURN RIGHT SAW SOME WILLOW TREE
 0.10 TURN LEFT SAW WILLOW TREE
 0.50 PASS ROAD ON LEFT
 38.60 TURN RIGHT MORE TIER ROAD - USE BEHIND VALLEY HEIGHTS STATION
 38.75 DOUBLE TURN CORNER - FROM HERE WALK RIGHT, KEEPING TO THE
 LEFT OF COURAGE BUSHES
 39.70 TURN RIGHT - FOLLOW ROAD TO BUZZ ON TREE!
 39.90 STOP VEHICLE AND WALK IN SOUTH EAST DIRECTION TO TOP
 OF FIRST HILL - THEN WALK RIGHT TO TOP
 WALKING TIME WITH LOAD 1 1/2 HOURS.
 Note for KUSNEZ Access Information See Table A
 VALLEY HEIGHT STATION
 T.C.

Station Diagram

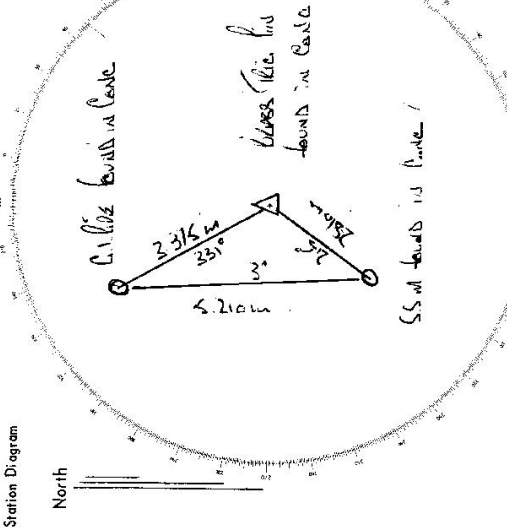

List of Observed Directions:-

Standpoint:	
Station	Direction
Standpoint:	
Station	Direction

CENTRAL MAPPING AUTHORITY

GEODETIC STATION RECONNAISSANCE and MAINTENANCE REPORT

STATION: TERELL No.: TS 6766

MAP SHEET SCALE 1:250 000 TANNORTH

INSPECTED BY: W. M. ELLIOTT DATE: 9-5-78

AUTHORITY: CMA FIELD BOOK: 1407

Description:
 1. Cleared by James bearing Note: Cross out word or words which do not apply
 2. Mast & Vanes have been painted white & black respectively. ✓
 3. The station pillar was unpiled/not unpiled/constructed on 5 19.78m, dimensions now being:
 Description of mark: BRASS PILLAR should be explicit, e.g., S/Steel Pillar Plate, Steel plug, Brass plug, Bolt, G.I. Pipe
 Height of mark: 2.27m above rock/concrete; Mark is m above G.L.
 Height of Top Vanes to Top Mark: 2.975m Diameter of Vanes (vertical): 0.760m.
 Height of Cairn: 1.0m Diameter of Cairn: 2.30m Name Plate: found/not found/placed.
 Length of Mast: 3.057m (approximate if not unpiled)
 4. A. S.S.M. set in conc/rock has been placed/found, bearing 2.14° M from Mast/Plug/Pillar
 5. A. G.I. PIPE set in conc/rock has been placed/found, bearing 32.9° M from Mast/Plug/Pillar
 6. A. set in conc/rock has been placed/found, bearing M from Mast/Plug/Pillar
 7. A. set in conc/rock has been placed/found, bearing M from Mast/Plug/Pillar
 8. Action required:

STANDPOINT: BRASS PILLAR		STANDPOINT: S.S.M.	
Mark	Direction	Mark	Direction
MARBRANDI G.S.	359 54 60 / above standpt.	MARBRANDI G.S.	359 54 60 / above standpt.
BLACK TOP PILLAR	26 22 40 / below standpt.	BLACK TOP PILLAR	26 22 55 / below standpt.
S.S.M.	149 22 15 / 2.808 / above standpt.	G.I. PIPE	293 17 25 / 5.210 / 0.202 / below standpt.
G.I. PIPE	263 54 25 / 3.371 / above standpt.	TRIG PILLAR	324 22 40 / 2.803 / 0.199 / below standpt.

Prepared by: Checked: Noted on U.T.M. Card

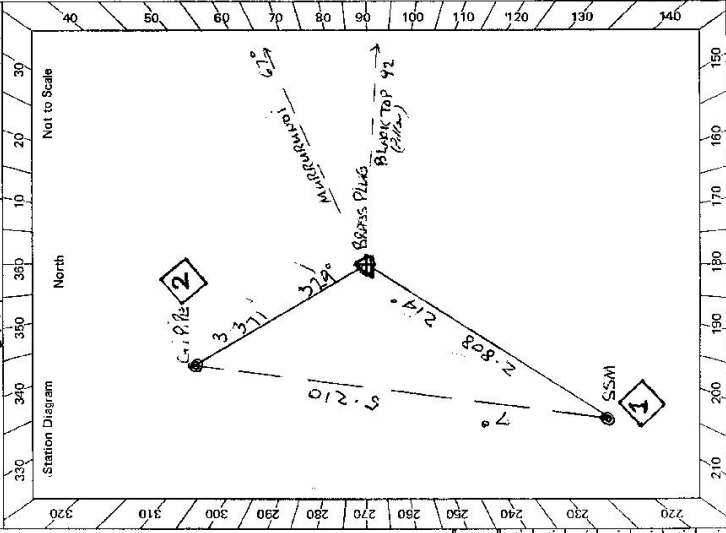

GS 24

STATION TS 6766 TERRILL	Owner's Name: Address: Phone: Current Occupant: Address: Phone: Access Report of <u>22/10/1977</u> was found suitable/unsuitable. <u>ACCESS</u>
Not to Scale Beacon Diagram 	This section to be completed by officer constructing pillar. Original station mark found/ not found . Description of mark: <u>Black Paint on Rock</u> Original beacon found/ not found . Description of beacon: <u>CALM MARK V. MARKS</u> Height Top of Vanes to Top Mark: <u>2.975</u> m. Height of mark \pm 0.257 m. above rock/level below G.L. Diameter of Vanes <u>0.740</u> m. Height of Calm <u>1.10</u> m. Original Beacon has has not been destroyed by me.
	Date Record of Station

CENTRAL MAPPING AUTHORITY

GEODETIC SURVEY OF N.S.W.

GEODETIC STATION RECONNAISSANCE and MAINTENANCE REPORT

Description:

1. Cleared by lanes bearing.....
 Note: Cross out word or words which do not apply
 from Trig. Mast
2. Mast & Vanes have been painted white & black respectively. ✓
3. The station/~~pillar~~ was unpiled/~~not visited/constructed~~ on ~~November 22.1.19.78~~., dimensions now being:
 Description of mark. ~~BRASS PLAG~~ should be explicit, e.g., ~~5/Steel-Pillar-Plate~~, Steel plug, Brass plug, Bolt, G.I. Pipe
 Height of mark.....~~0.070~~ m. ^{above} rock/~~concrete~~ Mark is.....~~at~~.....m. ^{above} ~~below~~ G.L.
 Height of Top Vanes to Top Mark/~~Pillar-plate~~.....~~2.990~~ m. Diameter of Vanes (vertical).....~~0.760~~ m.
 Height of Cairn.....~~1.5~~ m. Diameter of Cairn.....~~2.0~~ m. Name Plate found/~~not found~~/placed.
 Length of Mast.....~~3.060~~ m. (approximate if not unpiled) Beacon & Cairn Re-piled on 22/11/1978
4. A. ~~1~~.....~~S.S.M.~~.....set in conc/rock has been ~~placed~~/found, bearing.....~~214~~ °M from ~~Mast/Plug/Pillar~~
5. A.....~~G.I. Pipe~~.....set in conc/~~rock~~ has been ~~placed~~/found, bearing.....~~329~~ °M from ~~Mast/Plug/Pillar~~
6. A.....set in conc/rock has been placed/found, bearing.....°M from Mast/Plug/Pillar
7. A.....set in conc/rock has been placed/found, bearing.....°M from Mast/Plug/Pillar
8. Action required: Brass Plug was found loose in Rock - will need bonding at next visit

STANDPOINT:

Mark	Direction	Horiz. Distance	Height Difference	Mark	Direction	Horiz. Distance	Height Difference
S.S.M. Fd.	225° 43' 48"	2.810	0.197 above standpt.				
G.I. Pipe Fd.	340 17 30	3.373	0.399 above standpt.				
CRAWNEY GS OP	56 06 37		above standpt.				
BLACK TOP GS OP	102 44 30		above standpt.				
COCKCROW GS	110 31 29		above standpt.				
BRAWBOY GS OP	125 37 50		above standpt.				
BUNNAN GS OP	151 53 20		above standpt.				

Prepared by *[Signature]* 8/2/1979 Checked: *[Signature]*

Noted on U.T.M. Card

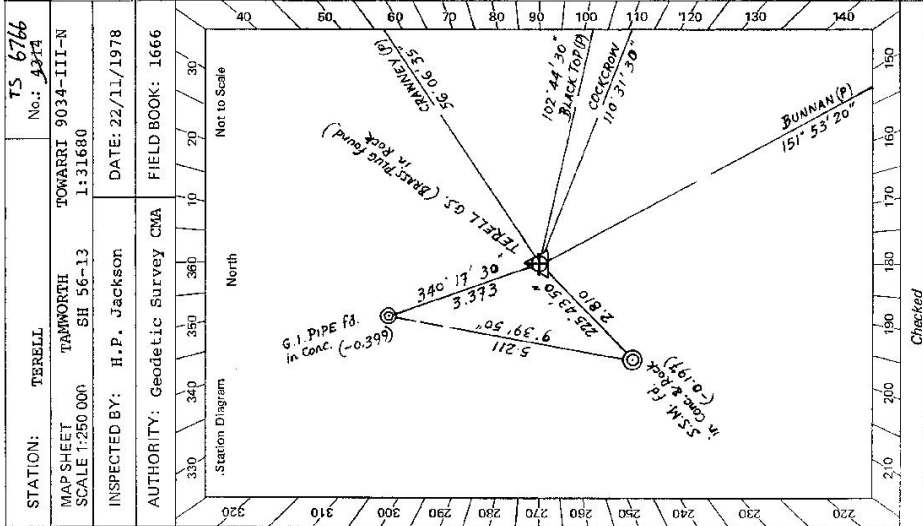

Checked

Noted on U.T.M. Card

Checked:

Prepared by *[Signature]* 8/2/1979

Noted on U.T.M. Card

Sr 2733-2 D. West Government Printer

STATION TERRELL NO.: 6766 TS 6766

Owner's Name:
 Address:
 Phone:
 Current Occupant:
 Address:
 Phone:
 ACCESS From WILLOW TREE 22/11/1978
 Date of Access: 16/11/1979
 A.M.D. Required

Access Report of 20/10/1977 was found unsuitable. ~~.....~~
 Kilometres:
 Feature:
 At Intersection of MERIEMA Road on New England Highway at MILLION TREE head west towards MERIEMA across Railway Level Crossing) swing left at 0.7 Km (MERIEMA 48 Mi), Swing Right at 1.45 Km (MERIEMA 96 Km), continue on this Tealed Road, PASSING MARRAH ROGER RD on Right at 9.1 Km, PASSING SWAINING RIDGES RD on Left at 15.8 Km, PASSING BLACKVILLE RD on Right at 20.0 Km, PASSING LITTLE JACKS CRK RD on Left at 21.0 Km, to end of 5/10m wide at 26.15 Km, Continue on Gravel Road, crossing an ineffective Grid at 29.35 Km, a conc. causeway at 30.3 Km, a Grid onto an unfenced Road at 30.6 Km, which Road winds up mountain range over a Grid at 33.6 Km, and onto a Grid at a Crest/Saddle in Liverpool Range at 35.7 Km (Murrumbidgee Murrumbidgee Bdy, Signpost MERIEMA 42K). Continue down winding Gravel Road to Cross a Grid at 38.6 Km, passing 'VALLEY HEIGHTS' Homestead on Right at 38.75 Km to:
 40.05 Km. Turn Left off MERIEMA Road onto rough Track heading South East, North of Fence Corner, veering around the Northern side of a gravel pit onto a dozed Track down towards a Creek. →
 40.4 Km Creek Crossing (Rocky base) → 40.5 Km Veer Left along South Side of Creek →
 40.55 Km Shallow Gully Crossing & again at 40.9 Km → 41.2 Km Gully crossing near Creek confluence
 41.22 Km Veer Right up Slope on dozed Track away from Creek →
 41.55 Km Through Mesh Wire Gate at fence intersection - continue straight ahead with fence on your Right on dozed Track (Low Range preferable - this Section not asportable after leaving Run).
 41.65 Km Veer Left up Slope onto dozed track away from fence → 42.05 Km Start of Steeper Slope
 42.25 Km Swing Hard Right up steep Section in dozed Track around South Western & Southern Side of Spur on dozed Track (Low Range preferable - Continue on dozed Track around South Western & Southern Side of Spur
 42.6 Km End of Steep Section - Continue on dozed Track around North-South Ridge line to Park Vehicle at 43.7 Km down and then up to fence line at Saddle of North-South Ridge line to Park Vehicle at 43.7 Km
 Walk up fence line in Northerly direction, Following fence to the base of Cliff face, from here proceed to a Staff in Rock face on Southern Side of fence (fallen timber), Climb up cliff and proceed to TERRELL G.S. generally in a North East direction. It is about 40 minutes' steep walk from Vehicle with a medium load.

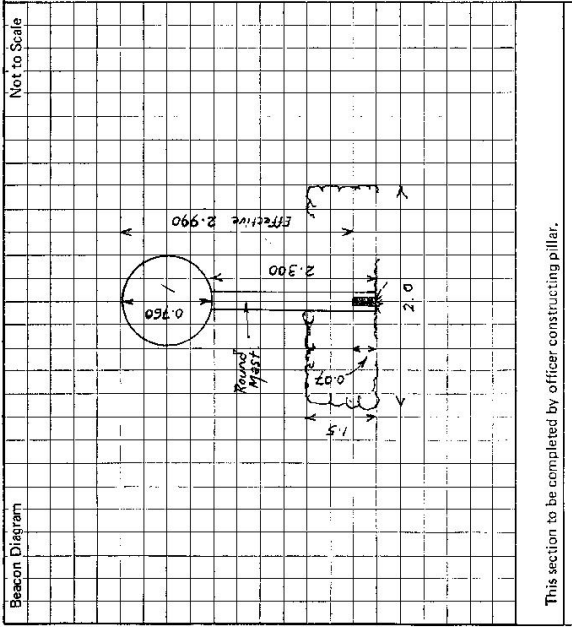

This section to be completed by officer constructing pillar.
 Original station mark found/not found:
 Description of mark:
 Original beacon found/not found.
 Description of beacon:
 Height Top of Vanes to Top Mark m.
 Height of mark m. above G.L. below G.L.
 Diameter of Vanes m. Height of Cairn m.
 Original Beacon has/has not been destroyed by me.

Date
 Record of Station

STATION: TERELL GS No.: 4341

MAP SHEET SCALE 1:250 000 TAMIWORTH

INSPECTED BY: N. K RAHE DATE: 5-4-79

AUTHORITY: C. M. A. FIELD BOOK 1584
101 16

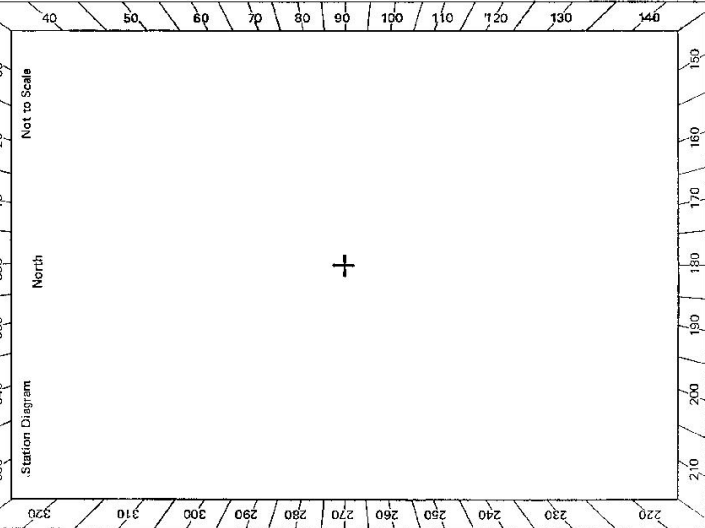

CENTRAL MAPPING AUTHORITY
GEODETTIC SURVEY OF N.S.W.
GEODETTIC STATION RECONNAISSANCE and MAINTENANCE REPORT

Description: *Note: Cross out word or words which do not apply*

1. Cleared by lanes bearing..... ³⁶⁰°..... from Trig. Mast
 2. Mast & Vanes have been painted white & black respectively.
 3. The station/~~pillar~~ ~~was~~ ~~unpiled~~/~~not~~ ~~unpiled~~/~~constructed~~ on..... ^{5.4.79}..... ~~19~~..... ~~dimensions~~ ~~now~~ ~~being~~;
- Description of mark..... should be explicit, e.g., S/Steel Pillar Plate, Steel plug, Brass plug, Bolt, G.I. Pipe
- Height of mark.....m..... ^{above} rock/concrete; Mark is.....m..... ^{above} G.L. ~~below~~
- Height of Top Vanes to Top Mark/Pillar plate.....m..... Diameter of Vanes (vertical).....m.
- Height of Cairn.....m..... Diameter of Cairn.....m. Name-Plate found/not found/placed.
- Length of Mast.....m. (approximate if not unpiled)
4. A..... ^{above} set in conc/rock has been placed/found, bearing.....° M from Mast/Plug/Pillar
 5. A..... ^{above} set in conc/rock has been placed/found, bearing.....° M from Mast/Plug/Pillar
 6. A..... ^{above} set in conc/rock has been placed/found, bearing.....° M from Mast/Plug/Pillar
 7. A..... ^{above} set in conc/rock has been placed/found, bearing.....° M from Mast/Plug/Pillar

8. Action required:..... Mast..... ~~appears to be struck by lightning - still standing but needs replacing.~~

STANDPOINT:

Mark	Direction	Horiz. Distance	Height Difference	Mark	Direction	Horiz. Distance	Height Difference
			above standpt				above standpt
			below standpt				below standpt
			above standpt				above standpt
			below standpt				below standpt
			above standpt				above standpt
			below standpt				below standpt
			above standpt				above standpt
			below standpt				below standpt
			above standpt				above standpt
			below standpt				below standpt

Prepared by: M. K. RAHE 18.4.79 Checked: [Signature] Noted on U.T.M. Card

GS 24

<p>Owner's Name:</p> <p>Address:</p> <p>Phone:</p>	<p>Current Occupant:</p> <p>Address:</p> <p>Phone:</p>	<p>STATION TERELL GS. IS 6766</p> <p>ACCESS 5-4-1979</p> <p>Access Report of 22/11/1979 was found unsuitable unsuitable.</p> <p>0-0 At Intersection of Bethington and Nemmacher Streets Merrima - Take Bethington St to the north towards Scene 4 Willow Tree</p> <p>0-6 Follow road around to right towards Willow Tree</p> <p>5-5 Turn left towards Willow Tree - Follow bitumen and then gravel road towards Willow Tree</p> <p>24-9 Cross Coulsons Creek</p> <p>29-14275 Cross Grids</p> <p>30-2 Cross Coulsons Creek</p> <p>38-2 Turn off road to the right after fence corner and follow faint track</p> <p>38-3 Take track to left - by-passing quarry</p> <p>38-4 Pass under powerline veering to the right around the south of quarry</p> <p>38-6 Cross dry creek bed and follow faint track in a southerly direction parallel to gully</p> <p>39-9 Cross gullies</p> <p>39-7 Pass through gate in corner - continue following track up ridge and around west end of hill as possible. Park vehicle and follow fence line to the north and then the east to the base of rock crown and then up through gap in rocks on the southern side of fence to the trig. About 40 minute walk with load</p> <p>41-8 Track meets North South Fence line - turn left off track and head north up steep ridge as far as possible. Park vehicle and follow fence line to the north and then the east to the base of rock crown and then up through gap in rocks on the southern side of fence to the trig. About 40 minute walk with load</p>
<p>Description of beacon:</p> <p>Height Top of Vanes to Top Markm.</p> <p>Height of markm. above rock/concm. below G.L.</p> <p>Diameter of Vanesm. Height of Cairnm.</p> <p>Original Beacon has/has not been destroyed by me.</p>	<p>Date</p>	<p>Record of Station</p>

TS 6766

GEODETTIC SURVEY OF N.S.W.

CENTRAL MAPPING AUTHORITY

GEODETTIC STATION RECONNAISSANCE and MAINTENANCE REPORT

Description: *Note: Cross out word or words which do not apply*

- Cleared by lanes bearing..... from Trig. Mast
- Mast & Vanes have been painted white & black respectively.
- The station/~~pillar~~ was ~~unfilled~~/not unfilled/~~reassessed~~ on...~~October~~...~~12~~...~~19~~...~~79~~... dimensions now being:
 - Description of mark.....should be explicit, e.g., ~~Steel Pillar/Plate~~, ~~Steel Poles~~, Brass plug, ~~Beets~~, ~~C.I. Pipe~~
 - Height of mark.....m. ^{above}/_{below} rock/concrete; Mark is.....m. ^{above}/_{below} G.L.
 - Height of Top Vanes to Top Mark/Pillar platem. Diameter of Vanes (vertical).....m.
 - Height of Cairn.....m. Diameter of Cairn.....m. Name Plate found/~~not found~~/~~found~~
 - Length of Mast.....m. (approximate if not unplied)
- A. Copper NAIL.....set in ~~conc~~/rock has been placed/~~found~~, bearing.....~~137~~°M from Mast/~~Plug~~/~~Pillar~~
- A. S.S.M.....set in conc/rock has been ~~placed~~/found, bearing.....~~215~~°M from Mast/~~Plug~~/~~Pillar~~
- A. C.I. Pipe.....set in conc/~~rock~~ has been ~~placed~~/found, bearing.....~~330~~°M from Mast/~~Plug~~/~~Pillar~~
- A.....set in conc/rock has been placed/~~found~~, bearing.....°M from Mast/~~Plug~~/~~Pillar~~
- Action required: New Mast required as existing one is split near Vane Junction.....

STANDPOINT: Copper NAIL (Brad) Placed in Rock

Mark	Direction	Horz. Distance	Height Difference	Mark	Direction	Horz. Distance	Height Difference
S.S.M. in Conc.	279° 11 54	3.555	^{above} 0.038 standpt.				^{above} standpt.
Mean Mast of Vanes	329 40 58	2.862	^{above} 2.471 standpt.				^{above} standpt.
BLACK TOP (P)	102 44 19		^{above} standpt.				^{above} standpt.
GASPARD SSM 1641	38 30 26		^{above} standpt.				^{above} standpt.
CRAWNEY (P)	56 06 24		^{above} standpt.				^{above} standpt.
TERMI	59 05 35		^{above} standpt.				^{above} standpt.
MURRURUNDI	76 21 20		^{above} standpt.				^{above} standpt.

Prepared by: *H.P. Jackson* October '79 Checked: *H.P. Jackson*

St 2793-1

Checked

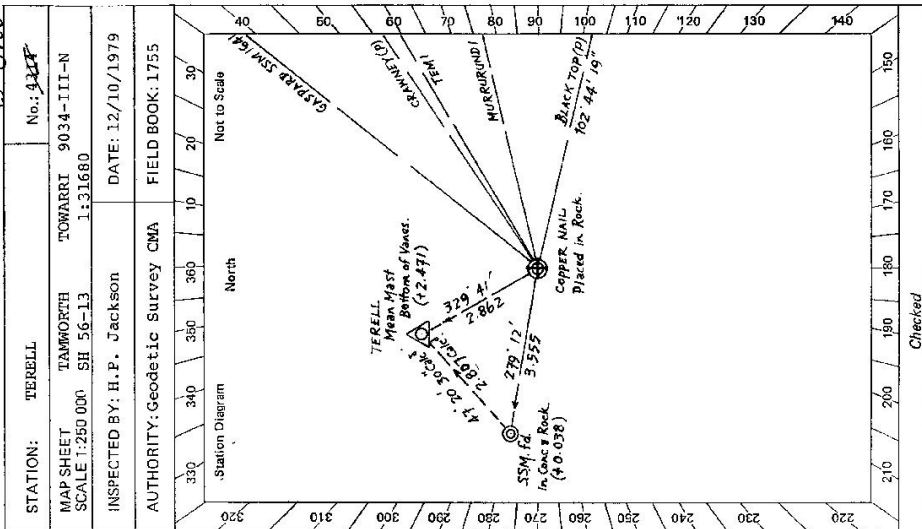

STATION: TERRELL No.: 3434

MAP SHEET TAMBORH TOWARRI 9034-III-N SCALE 1:250 000 SH 56-L3 1:31680

INSPECTED BY: H. P. Jackson DATE: 12/10/1979

AUTHORITY: Geodetic Survey CMA FIELD BOOK: 1755

CENTRAL MAPPING AUTHORITY

GEODETIC SURVEY OF N.S.W.

GEODETIC STATION RECONNAISSANCE and MAINTENANCE REPORT

- Description: *Note: Cross out word or words which do not apply*
1. Cleared ~~by~~ *To permit 360° vision* from Trig. ~~Mast~~ *Pillar*.
 2. Mast & Vanes have been painted white & black respectively.
 3. The ~~Roof-top~~ *Roof-top* ~~steel~~ *Roof-top* ~~plate~~ *plate* was ~~constructed on~~ *constructed on* ~~29 October~~ *29 October* 19*82*, dimensions now being: ~~Pillar Plate~~ *Pillar Plate* should be explicit, e.g., S/Steel Pillar Plate, Steel plug, Brass plug, Bolt, G.I. Pipe
Height of mark *1.380* m. above ~~rock~~ *rock*/concrete; Mark is *1.530* m. above G.L.
Height of Top Vanes to Top ~~Mast~~ *Mast*/Pillar plate *1.405* m. Diameter of Vanes (vertical) *1.50* m.
Height of Cairn *1.505* m. Diameter of Cairn *1.50* m. Name Plate ~~found~~ *found* placed.
Length of Mast *1.505* m. (approximate if not emptied) *Central Mapping Authority*
4. A. ~~Brass~~ *Brass* ~~trig~~ *trig* ~~pin~~ *pin* set in ~~base~~ *base*/rock has been ~~placed~~ *placed*/found, bearing *359*° M from ~~Mast~~ *Mast*/Plug/Pillar
5. A. ~~S.S.M.~~ *S.S.M.* set in ~~conc~~ *conc*/rock has been ~~placed~~ *placed*/found, bearing *305*° M from ~~Mast~~ *Mast*/Plug/Pillar
6. A. ~~G.I. pipe~~ *G.I. pipe* set in ~~conc~~ *conc*/rock has been ~~placed~~ *placed*/found, bearing *344*° M from ~~Mast~~ *Mast*/Plug/Pillar
7. A. ~~set in conc/rock has been placed/found, bearing~~ *set in conc/rock has been placed/found, bearing* *344*° M from ~~Mast~~ *Mast*/Plug/Pillar
8. Action required: *None*

STANDPOINT: *Roof top obs. Pillar.*

Mark	Direction	Horiz. Distance	Height Difference	Mark	Direction	Horiz. Distance	Height Difference
<i>WEREID R/T (P)</i>	<i>0 00 00</i>		<i>above standpt.</i>	<i>WEREID R/T (P)</i>	<i>0 00 00</i>		<i>above standpt.</i>
<i>MOAN R/T (P)</i>	<i>6 34 55</i>		<i>above standpt.</i>	<i>MOAN R/T (P)</i>	<i>6 35 08</i>		<i>above standpt.</i>
<i>S.S.M.</i>	<i>44 37 00</i>	<i>2.092</i>	<i>below standpt.</i>	<i>G.I. pipe</i>	<i>67 30 15</i>	<i>3.376</i>	<i>below standpt.</i>
<i>G.I. Pipe</i>	<i>82 35 10</i>	<i>6.698</i>	<i>below standpt.</i>	<i>BUNNAN (Pillar)</i>	<i>239 08 15</i>		<i>above standpt.</i>
<i>Brass Trig pin</i>	<i>96 52 50</i>	<i>3.553</i>	<i>below standpt.</i>	<i>Roof-top obs. pillar</i>	<i>216 55 20</i>	<i>3.555</i>	<i>above standpt.</i>
<i>BUNNAN Pillar</i>	<i>239 06 30</i>		<i>above standpt.</i>	<i>DIAMOND R/T (P)</i>	<i>286 55 15</i>		<i>above standpt.</i>
<i>DIAMOND R/T (P)</i>	<i>286 54 25</i>		<i>above standpt.</i>	<i>S.S.M.</i>	<i>312 56 40</i>	<i>2.812</i>	<i>below standpt.</i>

Prepared by:

Checked: *Michael Clark* 10-3-82

Noted on U.T.M. Card

SI 2733-1

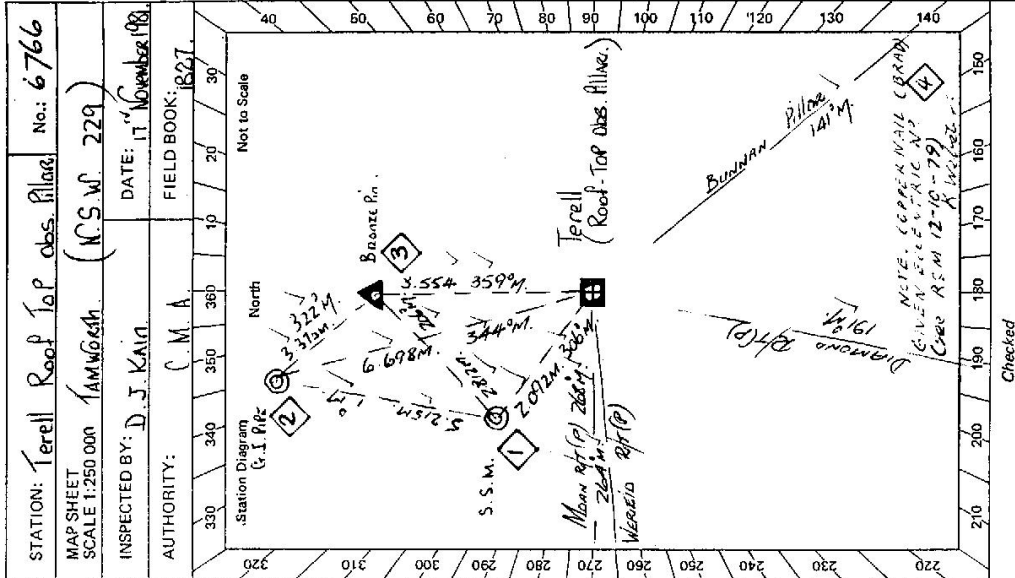

Checked



SI 2735-2 D. West, Government Printer

STATION Terrell Roof - Top obs. pillar TS 6766

GS 24

Owner's Name: Mr. Boyd REDMAN
 Address: REDMAN BUILDING LODGE
Willow Tree Road, Murrumbidgee
 Phone: (065) 691500
18515

Current Occupant:
 Address:
 Phone:

ACCESS

Access Report of S.A./A.10191 was found suitable/unsuitable.
 O.D.X.M.S.
 0-3 At Intersection of Berrington and Venacher Streets Murrumbidgee - Take Berrington Street to the North Towards Stone & Willow Tree.
 0-6 Follow Road around to Right Toward Stone & Willow Tree. Then Left Toward Willow Tree - Follow bitumen and then gravel ROAD Toward Willow Tree.
 5-5 Pass Mountain Station Road on Left.
 26.9 Cross Coulsons Creek.
 27.58, 29.1 Cross Grids.
 30.2 Cross Coulsons Creek.
 38.2 Turn off ROAD to the Right after fence corner and follow faint track.
 38.3 TAKE TRACK TO LEFT - by passing quarry.
 38.4 Pass under Powerline veering to the Right around the South of Quarry.
 38.6 Cross DRY CREEK BED and follow faint tracks in a southerly direction parallel to Gully.
 39.0, 39.3 Cross Gullies.
 39.7 Pass THROUGH GATE in Corner - Continue following track up ridge and around WEST END of hill.
 41.8 track meets North South fence line, turn left off track and head North to under hill at fence, running up ridge.
 LEAVE Vehicle 20 minute walk to Root-top pillar with LONO. DRY WEATHER ACCESS ONLY.

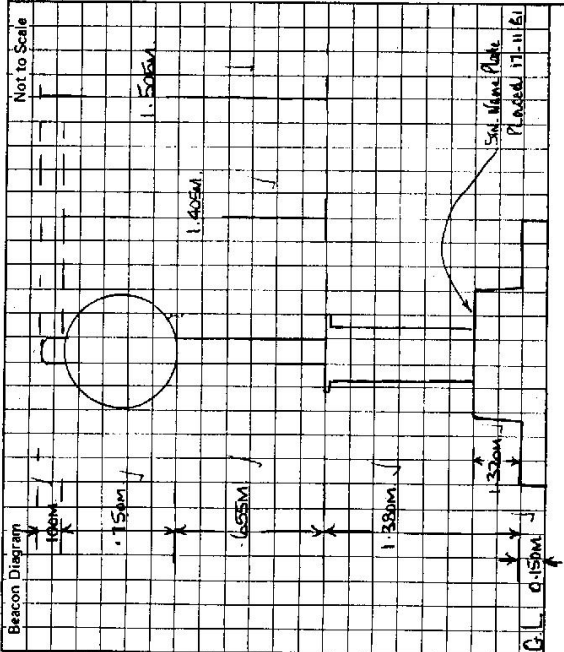

This section to be completed by officer constructing pillar.

Original station mark found/needed.
 Description of mark: BRICK
 Original beacon found & utilised 25.9.1981.
 Description of beacon: Cairn pole & Disc
 Height Top of Vane to Top Mark: 7.915 m.
 Height of mark: 0.85 m. above rock/level M m. above G.L. below
 Diameter of Vane: 100 m. Height of Cairn: m.
 Original Beacon has/has not been destroyed by me.

Date	Record of Station