

TS 6751

GEODETTIC SURVEY OF M.S.W.

CENTRAL MAPPING AUTHORITY

GEODETTIC STATION RECONNAISSANCE and MAINTENANCE REPORT

Description: *Note: Cross out word or words which do not apply*

1. Cleared by lanes bearing..... from Trig, Mast
2. Mast & Vanes have been painted white & black respectively.
3. The station/pillar was unpainted/rot unpainted/constructed on..... 19....., dimensions now being: Description of mark..... should be explicitly, eg, S/Steel Pillar Plate, Steel plug, Brass plug, Bolt, G.I. Pipe
- Height of mark.....m. above below rock/concrete; Mark is.....m. above below
- Height of Top Vanes to Top Mark/Pillar plate.....m. Diameter of Vanes (vertical).....m.
- Height of Cairn.....m. Diameter of Cairn.....m. Name Plate found/not found/placed.
- Length of Mast.....m. (approximate if not unplaced)
4. A..... set in conc/rock has been placed/found, bearing.....°M from Mast/Plug/Pillar
5. A..... set in conc/rock has been placed/found, bearing.....°M from Mast/Plug/Pillar
6. A..... set in conc/rock has been placed/found, bearing.....°M from Mast/Plug/Pillar
7. A..... set in conc/rock has been placed/found, bearing.....°M from Mast/Plug/Pillar

8. Action required: *REPAIR TO BE CONSIDERED. WILL TO BE CLEARED FOR M.S.W. STATION STANDPOINT. PERMISSION HAS BEEN OBTAINED AND CLEARANCE.*

Mark	Direction	Horiz. Distance	Height Difference	Mark	Direction	Horiz. Distance	Height Difference
			above standpt.				above standpt.
			below standpt.				below standpt.
			above standpt.				above standpt.
			below standpt.				below standpt.
			above standpt.				above standpt.
			below standpt.				below standpt.
			above standpt.				above standpt.
			below standpt.				below standpt.
			above standpt.				above standpt.
			below standpt.				below standpt.

Prepared by: *924-1781* Checked: *Noted on U.T.M. Card*

SR 2733-1

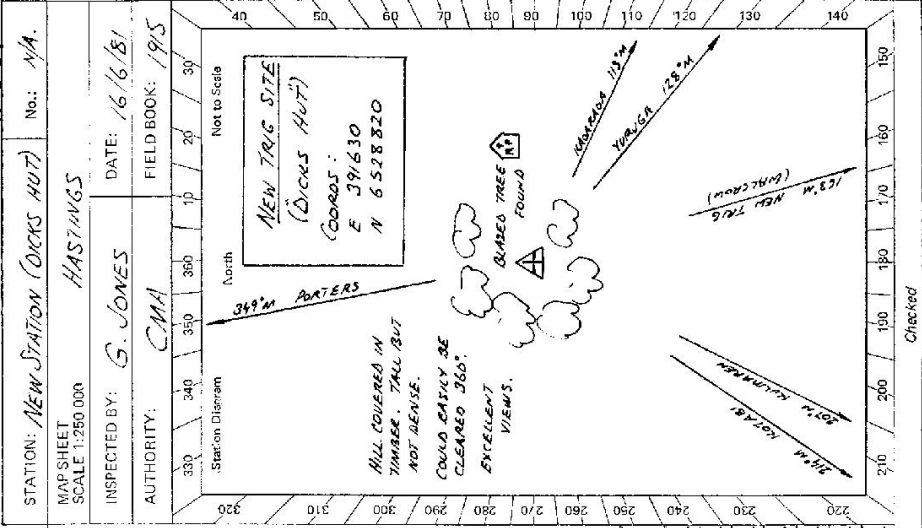

CENTRAL MAPPING AUTHORITY

GEODETIC SURVEY OF M.S.W. GEODETIC STATION RECONNAISSANCE and MAINTENANCE REPORT

Description: Note: Cross out word or words which do not apply

- 1. Cleared by lanes bearing $270^\circ - 240^\circ$ M
- 2. Mast & Vanes have been painted white & black respectively. ✓
- 3. The station/pillar was ~~reconstructed~~ constructed on 19.5×19.5 m, dimensions now being:
 Description of mark: ~~mark~~ should be explicit, e.g., S/Steel Pillar Plate, Steel plug, Brass plug, Bolt, G.I. Pipe
 Height of mark: 1.372 m, above ~~base~~ concrete; Mark is 1.495 m, above G.I.
 Height of Top Vanes to Top ~~mark~~ Pillar plate ... 1.433 m. Diameter of Vanes (vertical) ... 1.36 m.
 Height of ~~Cairn~~ m. Diameter of ~~Cairn~~ m. Name Plate ~~found/not found/placed~~.
 Length of Mast ... m. (approximate if not unpeeled)
- 4. A ~~concrete~~ ~~mark~~ set in conc/rock has been placed/~~found~~, bearing 331° M from ~~Mast/Plug/Pillar~~
- 5. A ~~C.I. Pipe~~ set in conc/~~rock~~ has been placed/~~found~~, bearing 43° M from ~~Mast/Plug/Pillar~~
- 6. A set in conc/rock has been placed/~~found~~, bearing 0° M from Mast/Plug/Pillar
- 7. A set in conc/rock has been placed/~~found~~, bearing 0° M from Mast/Plug/Pillar
- 8. Action required: ~~Mark~~ ~~to~~ ~~be~~ ~~found~~ ~~to~~ ~~be~~ ~~found~~

STANDPOINT: <u>Range Pole</u>				STANDPOINT: <u>Cover Mail</u>			
Mark	Direction	Horiz. Distance	Height Difference	Mark	Direction	Horiz. Distance	Height Difference
Pillar P	0 00 00		above standpt	Pillar P	0 00 00		above standpt
G.I. Pipe	60 07 03	2.718	above standpt	BRASS BRASS P	73 06 50		above standpt
BRASS BRASS P	73 07 00		below	G.I. Pipe	114 05 20	3.645	below
Keystone Fur Tower	134 16 00		above standpt	Keystone Fur Tower	134 15 30		above standpt
Muskele P	153 17 40		below	Muskele P	153 17 35		below
Muskele P	250 24 10		below	Pillar Plate	160 26 30	3.037	below
Cover Mail	340 28 10	1.130	below	Keystone P	230 28 30		below standpt

Prepared by: ASG

Checked: ASG Noted on U.T.M. Card

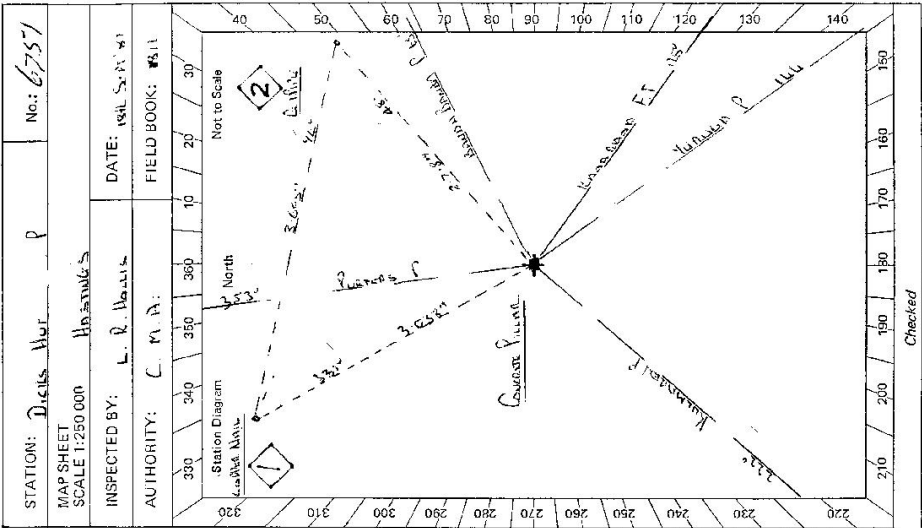

Checked

STATION: Dicks Hill No: 6751

MAP SHEET SCALE 1:250,000

INSPECTED BY: L. R. Housley

AUTHORITY: C.M.A.

DATE: 19th Sept 91

FIELD BOOK: 511

Sr 2793-2 D. West, Government Printer

Beacon Diagram

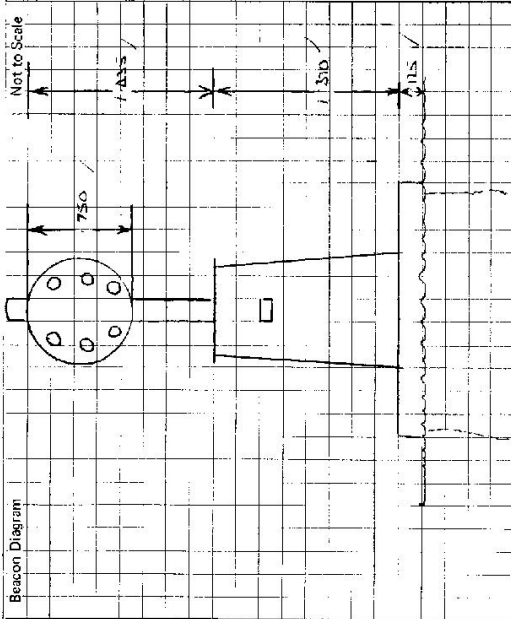

This section to be completed by officer constructing pillar.

Original station mark found/not found.

Description of mark:

Original beacon found/not found.

Description of beacon:

Height Top of Vanes to Top Mark:m.

Height of mark:m. above G.L. below

Diameter of Vanesm. Height of Cairnm.

Original Beacon has/not been destroyed by me.

STATION **Duils Hut, Ruwa TS 6751**

Owner's Name: **Tanaka Construction, Haha...**

Address:

Phone:

Current Occupant: **Tanaka Construction, Haha...**

Address:

Phone:

ACCESS

Access Report of 07/Jan/1981 was found suitable/unsuitable.

- 0 00 Whakara P.O. Tawaia Stn.
- 0 10 Cross Church on Right
- 07 10 Cross Church on Right
- 48 20 Turn Right Side "Snowdon" "Chardons Rd"
- 48 30 Turn Right Side "Upper Harewood"
- 48 70 Turn Left Fork Side "Upper Harewood"
- 49 20 Cross Snowdon Hill on Right
- 50 00 Cross Road on Right
- 59 00 Gate & Shed "Empire Stone Farm"
- 59 10 Cross Forester's Hut on Left
- 60 05 Turn Right Road "Empire Stone Farm"
- 61 20 Cross "Daisy Hill" Forest Rd on Left
- 64 40 Cross Road & Dam on Right
- 67 30 Cross Double Dike Rd on Left, to Dike that has Turn on Right
- 68 30 Turn Right at Barrie on Hill "Whiro White"
- 70 35 Turn Right " "
- 71 60 Geostatic Station

Good Track to Tebe.

Date

Record of Station