

CENTRAL MAPPING AUTHORITY
 GEODETIC SURVEY OF N.S.W.

GEODETIC STATION RECONNAISSANCE and MAINTENANCE REPORT

Description: *Note: Cross out word or words which do not apply*

1. Cleared by lances bearing..... *See diagram*..... from Trig. Mast
2. Mast & Vanes have been painted white & black respectively.
3. The station/pillar was unpiled/not unpiled/constructed on.....19....., dimensions now being:
 Description of mark.....should be explicit, e.g., S/Steel Pillar Plate, Steel plug, Brass plug, Bolt, G.I. Pipe
 Height of mark.....m. ^{above} _{below} rock/concrete; Mark is.....m. ^{above} _{below} G.L.
 Height of Top Vanes to Top Mark/Pillar plate.....m. Diameter of Vanes (vertical).....m.
 Height of Cairn.....m. Diameter of Cairn.....m. Name Plate found/not found/placed.
 Length of Mast.....m. (approximate if not unpiled)
4. A..... set in conc/rock has been placed/found, bearing.....° M from Mast/Plug/Pillar
5. A..... set in conc/rock has been placed/found, bearing.....° M from Mast/Plug/Pillar
6. A..... set in conc/rock has been placed/found, bearing.....° M from Mast/Plug/Pillar
7. A..... set in conc/rock has been placed/found, bearing.....° M from Mast/Plug/Pillar
8. Action required: *Pillar to be constructed. See owner first.*

STANDPOINT: *No clearing at this stage.*

Mark	Direction	Horiz. Distance	Height Difference	Mark	Direction	Horiz. Distance	Height Difference
			above standpt				above standpt
			below standpt				below standpt
			above standpt				above standpt
			below standpt				below standpt
			above standpt				above standpt
			below standpt				below standpt
			above standpt				above standpt
			below standpt				below standpt
			above standpt				above standpt
			below standpt				below standpt

Prepared by: *GL*

8/7/81

Checked:

A. Judge 21.7.81

Noted on U.T.M. Card

SR 2733-1

STATION: *BEAU GS.* No: *6388*

MAP SHEET SCALE 1:250 000

INSPECTED BY: *G. JONES* DATE: *23.6.81*

AUTHORITY: *CMA* FIELD BOOK: *1915*

Checked

GS 24

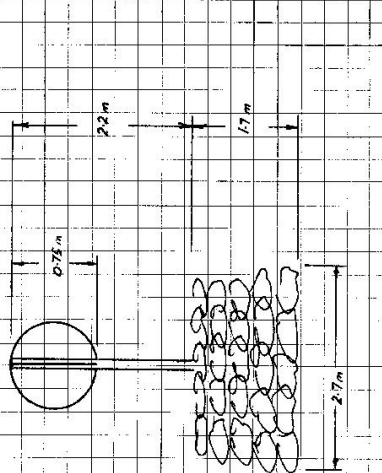
STATION BENI GS. 6744	Owner's Name: MR BILL COLLINS Address: S. MILGA RACE Phone: 82 74 94 Current Occupant: Address: Phone: ACCESS 23-6-81 Access Report of 2/7/1975 was found inadequate /unsuitable. 0.0 <i>Railway crossing in Dussbo, on the Newell Highway towards Gilgandra. Travel north.</i> 0.15 <i>Turn right. Sign, "Gilgandra".</i> 0.35 <i>Straight ahead. Sign, "Duncebo".</i> 1.25 <i>Railway crossing.</i> 7.5 <i>Pass Harfield road on right.</i> 9.8 <i>Turn right onto sealed road. Sign, "Duncebo Road".</i> 12.0 <i>Turn left. Sign, "Wattle road".</i> 13.0 <i>over fence.</i> <i>2ms all weather access.</i>
Beacon Diagram Not to Scale Most Vanes are in poor condition. 	This section to be completed by officer constructing pillar. Original station mark found/not found. Description of mark: Original beacon found/not found. Description of beacon: Height Top of Vanes to Top Mark:m. Height of mark:m, above G.L., below Diameter of Vangs:m. Height of Cairnm. Original Beacon has/has not been destroyed by me.
	Date Record of Station

CENTRAL MAPPING AUTHORITY

GEODETTIC SURVEY OF N.S.W.

GEODETTIC STATION RECONNAISSANCE and MAINTENANCE REPORT

Description:

Note: Cross out yard or words which do not apply

1. Cleared by lances bearing $227^{\circ} 26'S$ $26^{\circ} 20' 21''$ 20° $25^{\circ} 29' 9''$ 36° $33^{\circ} 23' 9''$ from Trig. Mast $35^{\circ} 4' 13''$ $98^{\circ} 9' 97''$ 99° 120°
2. Mast & Vanes have been painted white & black respectively. ✓
3. The ~~station~~/pillar was ~~not~~/constructed on ~~29m Mason~~ 19.81 m, dimensions now being: Description of mark ~~Steel Pipe~~ should be explicit, e.g., S/Steel Pillar Plate, Steel plug, Brass plug, Bolt, G.I. Pipe
- Height of mark 1.370 m. ^{above} rock/concrete; Mark is 1.520 m. ^{above} G.L.
- Height of Top Vanes to Top ~~Mast~~ ~~Pillar~~ ~~Rock~~ ~~Plate~~ 1.435 m. Diameter of Vanes (vertical) 0.750 m.
- Height of Cairn 0.000 m. Diameter of Cairn 0.000 m. Name Plate found/not ~~found~~/placed.
- Length of Mast 0.000 m. (approximate if not unpiled)
4. ~~Brass Trig. Pins~~ set in ~~conc~~/rock has been ~~placed~~/found, bearing 176° 0° $00'$ from ~~Mast~~/Pillar
5. A. ~~G.I. PIPE~~ set in ~~conc~~/rock has been placed/ ~~found~~, bearing 123° 0° $00'$ from ~~Mast~~/Pillar
6. A. ~~CONC OBS PLATE~~ set in ~~conc~~/rock has been placed/ ~~found~~, bearing 00° 0° $00'$ from Mast/Plug/Pillar
7. A. ~~CONC TRIG PLUG~~ set in ~~conc~~/rock has been placed/ ~~found~~, bearing 00° 0° $00'$ from Mast/Plug/Pillar
8. Action required: ~~None~~

STANDPOINT: ~~CONC OBS PLATE~~ ~~CONC TRIG PLUG~~ **BRASS TRIG PLUG**

Mark	Direction	Horiz. Distance	Height Difference	Mark	Direction	Horiz. Distance	Height Difference
TALBERT GAE BRG	0 00 00		above standpt.	TALBERT GAE BRG	0 00 00		above standpt.
G.I. PIPE in CONC	75 57 40	4.366	below standpt.	G.I. PIPE in CONC	54 00 39.20	0.137	below standpt.
BRASS TRIG PLUG	126 16 30	4.837	below standpt.	MONGAMINE BRG	289 45 00		below standpt.
TOWER	191 04 00		below standpt.	CONC OBS PLATE	306 17 40	4.840	above standpt.
MONGAMINE BRG	289 42 10		above standpt.				above standpt.
			below standpt.				below standpt.
			below standpt.				below standpt.

Prepared by: P. POTTS 14-9-81 Checked: *[Signature]* Noted on U.T.M. Card

S: 2733-1

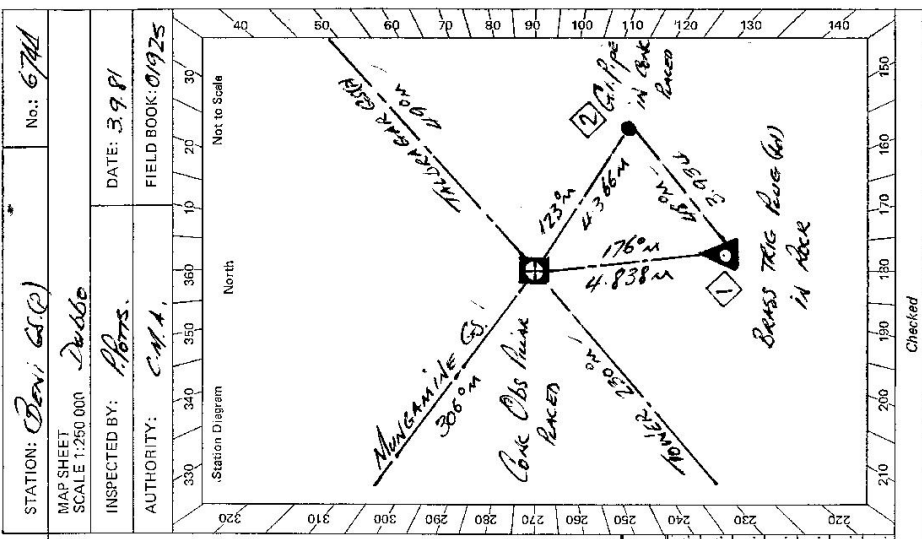

STATION: *Deni GRC* No.: *6744*

MAP SHEET SCALE 1:250 000 DATE: *3.9.81*

INSPECTED BY: *Potts* FIELD BOOK: *01925*

AUTHORITY: *C.M.A.*

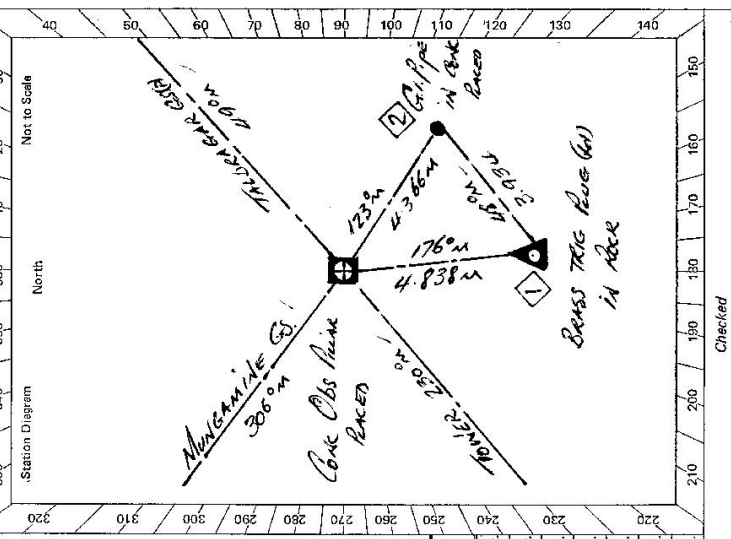

Checked

GS 24

STATION Beni (S.P) **6744**

Owner's Name: MR. Bili Collins Current Occupant:

Address: 2000 Address:

Phone: 7194 Phone:

ACCESS

Access Report of 21/19/1981 was found suitable/unsuitable.

FEATURE

0.00 **BY OFFICE 2000 HEAD NORTH ON MARGARIE STREET**

0.26 **UNDER RAIL LINE BRIDGE**

0.36 **TURN RIGHT EASTING STREET**

1.89 **RAIL LINE CROSSING**

10.37 **TURN RIGHT DURRANNEEN ROAD**

12.53 **TURN LEFT WITH WATTLE ROAD**

13.48 **AT FENCE WALK 50 METRES TO TRIG**

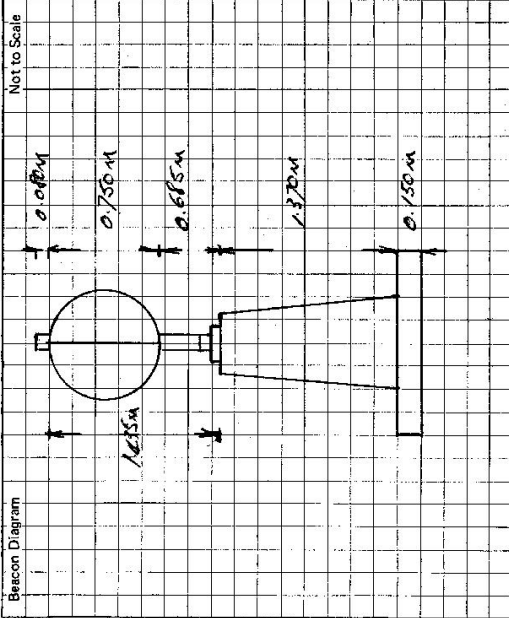

This section to be completed by officer constructing pillar.

Original station mark found/ ~~not found~~.

Description of mark: BRASS TRIG MARK

Original beacon found/ ~~not found~~.

Description of beacon: CHINA BRICK & DISC

Height Top of Vanes to Top Mark: 3.805 m.

Height of mark: 0.035 m. above rock/ 0.000 m. below G.L.

Diameter of Vanes: m. Height of Cairn: 1.700 m.

Original Beacon has/ ~~has not~~ been destroyed by me.

Date	Record of Station