

CENTRAL MAPPING AUTHORITY  
 GEOMETRIC SURVEY OF NSW  
 GEODETIC STATION RECONNAISSANCE and MAINTENANCE REPORT

STATION: MACQUEEN P No: 6702  
 MAP SHEET: CRAFTEN  
 SCALE 1:250 000  
 INSPECTED BY: L. R. HALLS DATE: 17th Nov 21  
 AUTHORITY: C. M. A. FIELD BOOK: 011113

Description:  
 Note: *Cross out word or words which do not apply*  
 1. Cleared by lanes bearing 154 11° 34' 10" 154 10° 19' 10" 154 21° 24' 25" 155 17° 20' 32" from Trig. Mast  
 (1993 135° 14' 50" bearing 48° 15' 32" / 287° 26' 14" *See SkyPlot & Towers only*)  
 2. Mast & Vanes have been painted white & black respectively.  
 3. The station pillar was replaced/renewed/constructed on 8th MAY 1981, dimensions now being:

Description of mark. Recessed Mast should be explicit, e.g. S/Steel Pillar Plate, Steel plug, Brass plug, Bolt, G.I. Pipe

Height of mark 1.369 m. above feet/concrete; Mark is 1.349 m. above G.L.  
 Height of Top Vanes to Top Recessed/Pillar plate 1.1445 m. Diameter of Vanes (vertical) 75.55 m.  
 Height of Cairn ..... m. Diameter of Cairn ..... m. Name Plate ..... placed/~~.....~~/placed.

Length of Mast ..... m. (approximate if not supplied)

1. A Calc. 1374 set in conc/~~mark~~ has been ~~placed~~/found, bearing 243° M from ~~Mast/Plug/Pillar~~
2. A Recessed Mast 1 set in conc/~~mark~~ has been ~~placed~~/found, bearing 356° M from ~~Mast/Plug/Pillar~~
3. A Recessed Mast 2 set in conc/~~mark~~ has been ~~placed~~/found, bearing 268° M from ~~Mast/Plug/Pillar~~
4. A ..... set in conc/~~mark~~ has been ~~placed~~/found, bearing .....° M from ~~Mast/Plug/Pillar~~

8. Action required: .....

STANDPOINT: Recessed Mast      STATIONPOINT: Q.G.S. 1374

Mark	Direction	Horiz. Distance	Height Difference	Mark	Direction	Horiz. Distance	Height Difference
<u>Details Mast P</u>	<u>0 00 00</u>		<u>above</u> <u>standpt</u>	<u>Details Mast P</u>	<u>0 00 00</u>		<u>above</u> <u>standpt</u>
<u>RECESS MAST 1</u>	<u>21 24 10</u>	<u>6.932</u>	<u>above</u> <u>standpt</u>	<u>RECESS MAST 1</u>	<u>21 24 10</u>	<u>6.932</u>	<u>above</u> <u>standpt</u>
<u>RED HILL P</u>	<u>158 44 30</u>		<u>below</u> <u>standpt</u>	<u>PILLAR PLATE</u>	<u>51 45 30</u>	<u>5.674</u>	<u>above</u> <u>standpt</u>
<u>Q.G.S. 1374</u>	<u>267 30 00</u>	<u>3.074</u>	<u>above</u> <u>standpt</u>	<u>RED HILL P</u>	<u>158 44 30</u>		<u>below</u> <u>standpt</u>
<u>LEEFIELD P</u>	<u>290 10 50</u>		<u>above</u> <u>standpt</u>	<u>LEEFIELD P</u>	<u>290 01 00</u>		<u>below</u> <u>standpt</u>
<u>RECESS MAST 2</u>	<u>201 19 50</u>	<u>13.608</u>	<u>above</u> <u>standpt</u>	<u>RECESS MAST 2</u>	<u>207 46 45</u>	<u>10.570</u>	<u>above</u> <u>standpt</u>
			<u>below</u> <u>standpt</u>				<u>below</u> <u>standpt</u>

Prepared by: L. R. HALLS      Checked: .....      Noted on U.T.M. Card

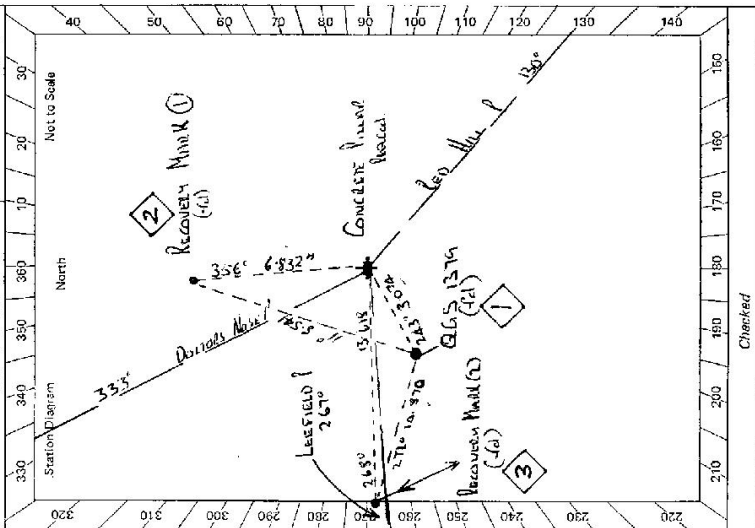

Station Datum      North      Not to Scale

Checked

STATION MACLEDDIE P IS 6702

Owner's Name: D. & J. DE LAMOND  
 Address: 12/198 Lanes found suitable/unsuitable.  
 Phone: 0800 000 000

ACCESS

Access Report of 12/198 Lanes found suitable/unsuitable.

Feeture

0-00 TENDERFIELD PD TRAVEL TOWARDS BEEN TOWARDS  
 0-45 TURN RIGHT INTO DOUGLASS ST  
 1-10 CONCRETE BRIDGE  
 1-75 BRIDGE OVER RAILWAY LINE  
 1-90 TURN LEFT  
 2-00 TURN LEFT FOLLOW INTERNAL RD  
 2-30 CAUSEWAY  
 3-00 LENSSE OF RECORD LAND FROM 10-3-40-0-3  
 5-00 HOUSE NO 111 S. (MR. MAC MURCH N MACLEDDIE)  
 6-10 ROAD  
 6-10 CAUSEWAY  
 8-40 TURN LEFT INTO GRAVEL RD APT 150 MARKHAM GUEST  
 9-00 GOLF  
 9-00 GOLF  
 10-10 TURN LEFT OVER GOLF  
 10-30 GOLF WITH LOCKED GOLF HOLE NOW FORMER HILL CAMP BEE RAILLOCK.  
 12-40 MACLEDDIE G.S.

Not to Scale

Beacon Diagram

This section to be completed by officer constructing pillar.

Original station mark found/~~not found~~.

Description of mark: ARMY BEANS PLANT C 1942

Original beacon found/~~not found~~.

Description of beacon: Concrete Pav. & Pill

Height Top of Vanes to Top Mark: 3.660 m.

Height of mark: M/L m. above rock/cont. below

Diameter of Vanes: 0.30 m. Height of Cairn: 1.60 m.

Original Beacon has/~~not~~ been destroyed by me.

Date

Record of Station