

CENTRAL MAPPING AUTHORITY
 GEODETIC SURVEY OF M.S.W.
 STATION: MCKERENA G.S. (P) No.: 6695

MAP SHEET
 SCALE 1:250 000
 INSPECTED BY: P. PETS
 DATE: 28th May 1981
 AUTHORITY: C.M.A
 FIELD BOOK: 1808

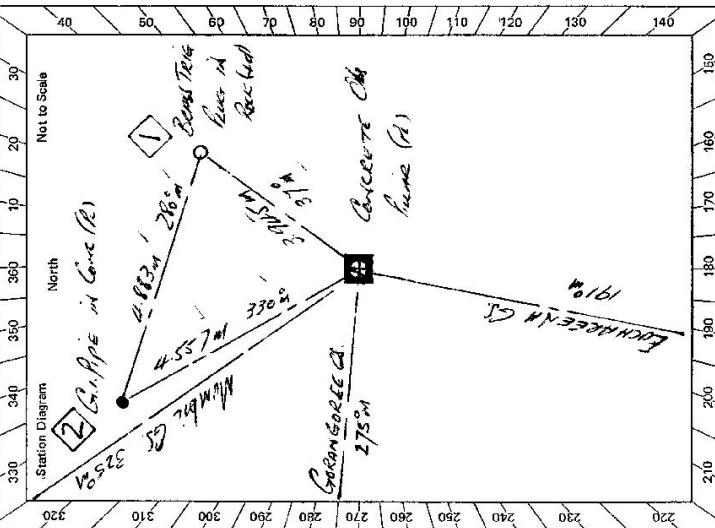

GEODETIC STATION RECONNAISSANCE and MAINTENANCE REPORT

Description:
 Note: Cross out word or words which do not apply
 1. Cleared by lances bearing $299^{\circ} 30' 30''$ $323^{\circ} 36' 32''$ $19^{\circ} 46' 28''$ from Trig. Mast
 2. Mast & Vanes have been painted white & black respectively.
 3. The ~~station~~ pillar was ~~reconstructed~~ constructed on 23rd April 1981, dimensions now being:
 Description of mark St. Pierre's Point should be explicit, e.g., S/Steel Pillar Plate, Steel plug, Brass plug, Bolt, G.I. Pipe
 Height of mark 1.370 m. above ~~rock~~ concrete; Mark is 1.520 m. above G.L.
 Height of Top Vanes to Top ~~mark~~ Pillar plate 1.375 m. Diameter of Vanes (vertical) 0.750 m.
 Height of Cairn.....m. Diameter of Cairn.....m. Name Plate ~~found~~/not ~~found~~/placed.
 Length of Mast.....m. (approximate if not unpled)
 4. Bench Trig ~~has~~ set in ~~stone~~ rock has been ~~placed~~/found, bearing 37 °M from ~~Mast~~/Bench/Pillar /
 5. G.I. Pipe ~~has~~ set in ~~conc~~ rock has been ~~placed~~/found, bearing 330 °M from ~~Mast~~/Bench/Pillar /
 6. A..... set in ~~conc~~ rock has been ~~placed~~/found, bearing..... °M from Mast/Plug/Pillar
 7. A..... set in ~~conc~~ rock has been ~~placed~~/found, bearing..... °M from Mast/Plug/Pillar
 8. Action required: Name Plate.....

STANDPOINT: Conc obs bench			STANDPOINT: Bench Trig Axis		
Mark	Direction	Horiz. Distance	Height Difference	Direction	Horiz. Distance
Mumbic G.S.	0 00 00	0 00 00	above standpt.	0 00 00	above standpt.
G.I. Pipe	6 01 00	4.55	below standpt.	226 05 50	above standpt.
Bench Trig Axis	75 41 40	3.945	below standpt.	25 42 10	below standpt.
EUCKAREENA G.S.	226 00 10		above standpt.	311 41 00	above standpt.
GREENGROVE G.S.	311 40 50		below standpt.	316 46 00	below standpt.
			below standpt.	4 03	below standpt.
			below standpt.	0 15	below standpt.

Prepared by: P. PETS 28th May 1981
 Checked: C. Noted on U.T.M. Card
 S: 2733-1

GS

<p>STATION MUCKERNA Gd (A) TS 6695</p> <p>Owner's Name: TRIG RESERVE</p> <p>Address: NO 38 352</p> <p>Phone: MR R.R. & N. SALTMAN</p> <p>Phone: 38 CHRISTINA RD. ORANGE</p> <p>Current Occupant: ANSEL THORPEY</p> <p>Address: MR TRIG RESERVE MEDWARDS</p> <p>Phone: MR M.A. REID</p> <p>Phone: PH 468209</p> <p>Phone: MEDLANDS</p>	<p>Access Report: 07/20/15, 1988, was found suitable/unsuitable.</p> <p>ACCESS</p> <p>FEATURE</p> <p>000 P.O. SWART TOWN HEAD TOWARDS ECKHARENA</p> <p>305 TURN LEFT ONTO ECKHARENA ROAD SIGN "ARCHAM"</p> <p>450 TURN LEFT ACROSS RAILWAY LINE</p> <p>466 CR2's</p> <p>535 CR2's</p> <p>645 CR2's</p> <p>740 TURN RIGHT SIGN "MEDLANDS"</p> <p>830 CR2's</p> <p>930 HAS MC PETER SPANARD'S HOUSE ON RIGHT</p> <p>940 TURN LEFT - SWERING SPARE ON LEFT</p> <p>960 BRUY CROSSING, KEEP LEFT TOWARDS GATE</p> <p>970 NOW GATE</p> <p>1030 NOW GATE</p> <p>1130 TAKE LEFT TRACK</p> <p>1160 TAKE LEFT TRACK</p> <p>1170 KEEP LEFT DOWN RIDGE TO ION CAPE & DAM.</p> <p>1180 NOW GATE - TURN RIGHT & FOLLOW TRACK UP HILL THEN LEFT ALONG FENCE LINE</p> <p>1250 FENCE CORNER</p> <p>1270 PROTECTIVE STATION MUCKERNA.</p>
<p>Beacon Diagram</p>	<p>This section to be completed by officer constructing pillar.</p> <p>Original station mark found/measured.</p> <p>Description of mark: ROSS TRIG BEG</p> <p>Original beacon found/measured.</p> <p>Description of beacon: Carry over & Disc</p> <p>Height Top of Varies to Top Markm.</p> <p>Height of mark 0.246 above rock/casem. below G.L.</p> <p>Diameter of Varies 1.220m. Height of Cairn 0.700m.</p> <p>Original Beacon has/has not been destroyed by me.</p>
	<p>Date</p> <p>Record of Station</p>