

CENTRAL MAPPING AUTHORITY  
Department of Lands

Trigonometrical Survey of N.S.W.

RECONNAISSANCE and MAINTENANCE REPORT

This Trig. Station has been:

Note: Cross out word or words which do not apply

1. Completely cleared to permit 360° vision to surrounding Trig.
2. Cleared by James bearing Not clear 182-250, 9-265-335 (Reservoirs) from Trig. Mast
3. Trig. Mast & Vanes have been painted white & black respectively. NO BEACON

4. The Trig. was unpiled/~~not unpiled~~, dimensions now being:

Description of mark Brass plaque in cone should be explicit, e.g. Steel plug, Brass plug, Bolt, G.I. Pipe

Height of mark..... 0.0 m above below rock/concrete ..... m above below G.I. .... m

Height of Top Vanes to Top Mark..... m. Diameter of Vanes (vertical)..... m.

Height of Cairn..... m. Diameter of Cairn..... m.

Length of Mast..... m. (approximate if not unpiled)

5. G.I. Pipe set in conc./~~soil~~ has been placed. Set 21.922 m. bearing 125.9°M from Trig. Mast Plaque

6. A..... set in conc./soil has been placed..... m. bearing.....°M from Trig. Mast

7. A..... set in conc./soil has been placed..... m. bearing.....°M from Trig. Mast

8. A..... set in conc./rock has been placed..... m. bearing.....°M from Trig. Mast

9. Connection..... to..... m. bearing.....°M

10. Connection..... to..... m. bearing.....°M

11. Connection..... to..... m. bearing.....°M

12. Connection..... to..... m. bearing.....°M

13. Diff. Ht. Brass Plaque is 0.020m G.I. Pipe

14. Diff. Ht. is..... m. above below

15. Diff. Ht. is..... m. above below

16. Diff. Ht. is..... m. above below

Prepared by: 512-77 Checked:

Noted on U.T.M. Card

STATION LANG TS 6666

Co: Richmond PH: Riley

Map Sheet: WOODBURN

No: 9539

Inspected by: A. Sivertsen Date: 25-11-77

Authority: CMA Field Book: 1613

Beacon Diagram Not to Scale

It would be difficult to establish a beacon on one of the reservoirs unless a platform was built.

A second G.I. Pipe could be re-established to west of Δ with extensive views.

\* No clearing necessary

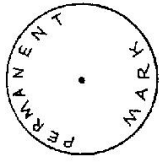

Brass plaque ca.

\* Could be pillared  
Date Record of Station

Checked





STATION TS 6666 / 2796 LANG. (P)

Owners Name.....  
 Current Occupant.....  
 Address.....  
 Address.....  
 Access May 1979  
CONVENTIONAL VEHICLE

Richmond River  
 Richmond Highway  
 Woodburn  
 Evan's Head Light House  
 Richmond Highway  
 Woodburn  
 Evan's Head Light House

D. West, Government Printer, New South Wales - 1976

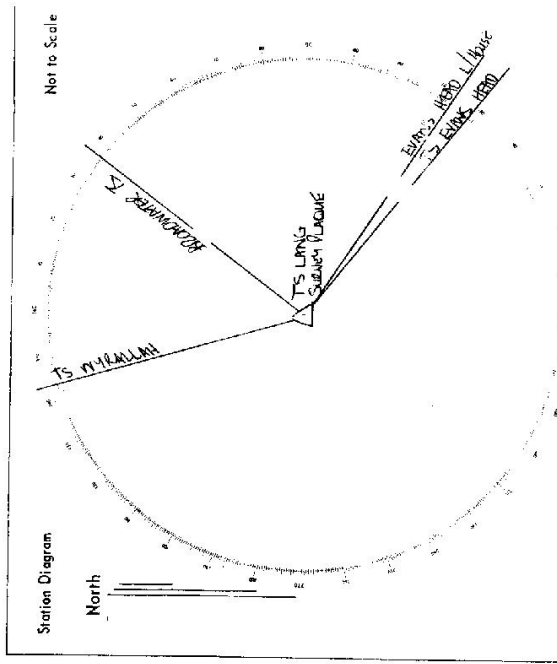

List of Observed Directions:-

Station	Direction	Station	Direction
TS BURNETT	108° 00' 00"	TS LANG	343° 20' 51"
TS MICALLAH	35° 51' 42.9"	EVAN'S HEAD LIGHTHOUSE	175° 25' 07.0"
TS BURNETT		EVAN'S HEAD LIGHTHOUSE	
TS LANG		EVAN'S HEAD LIGHTHOUSE	

TS- 6666  
No.: 2736

GEODETTIC SURVEY OF N.S.W.

CENTRAL MAPPING AUTHORITY

GEODETTIC STATION RECONNAISSANCE and MAINTENANCE REPORT

STATION: L.A.N.C. MACLEAN

MAP SHEET SCALE 1:250 000

INSPECTED BY: D. KIRKBY

DATE: 13.4.80

AUTHORITY: C.M.A.

FIELD BOOK: 1853

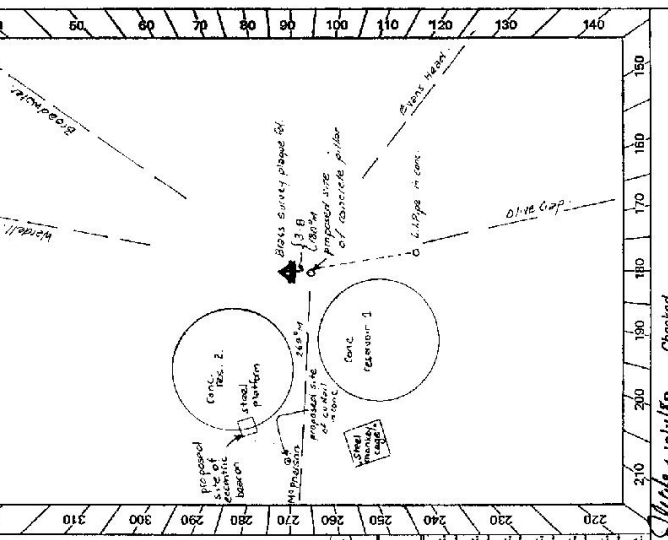

- Description: *Note: Cross out word or words which do not apply*
- Cleared by lanes bearing..... No. clearing..... of timber required..... from Trip-Mast
  - Mast & Vanes have been painted white & black respectively, not found.
  - The station/pillar was unpiled/ret-emptied/constructed on..... dimensions now being:
    - Brass Survey Pillar: Steel plug, Brass plug, Bolt, G.I. Pipe
    - Height of mark..... m. above below
    - Height of Top-Vanes to Top-Mark/Pillar-plate..... m. Diameter of Vanes (vertical)..... m.
    - Height of Cairn..... m. Diameter of Cairn..... m. Name Plate found/not found/placed.
    - Length of Mast..... m. (approximate if not unplaced)
  - A *G.I. Pipe* (slightly loose) set in conc/teeek has been placed/found, bearing.....° M from Mast/Plug/Pillar
  - A..... set in conc/rock has been placed/found, bearing.....° M from Mast/Plug/Pillar
  - A..... set in conc/rock has been placed/found, bearing.....° M from Mast/Plug/Pillar
  - A..... set in conc/rock has been placed/found, bearing.....° M from Mast/Plug/Pillar
  - Action required: Concrete pillar to be established 3.8 metres south of Brass Survey Pillar. Witness mark removed & concrete bearing to be set on platform of Reservoir 1 approximately 40 m south of Brass Survey Pillar.

STANDPOINT: Brass Survey Plaque.

Mark REQUIRED	Direction	Horiz. Distance	Height Difference	Direction	Horiz. Distance	Height Difference
BROAD WATER	31°M		above standpt			above standpt
EVANS HEAD	136°M		above standpt			above standpt
OLIVE GAP	168°M		below	172°M		below
OTHERS			above standpt			above standpt
WARDSELL	10°M		below			below
			above standpt			above standpt
			below			below

Prepared by: P. Holden  
Checked: P. Holden  
Noted on U.T.M. Card

Station Diagram  
Not to Scale  
Checked: 10/11/80

2125-2 D. West, Government Printer

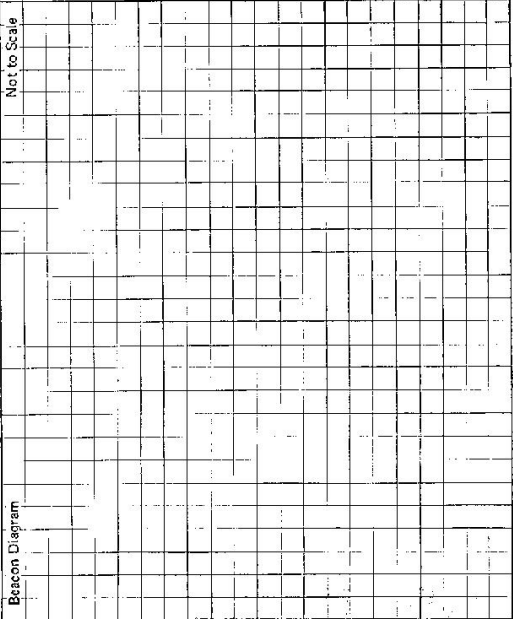
<p>STATION <b>LANG TS 6666</b></p>	<p>Owner's Name: <b>Ross County Council</b>                  Address: <b>23 Conroy Street Bismore</b>                  Phone: .....                  Current Occupant: .....                  Address: .....                  Phone: .....</p> <p style="text-align: center;"><b>ACCESS</b></p> <p>Access Report of <b>25/11/1977</b> was found suitable/unsuitable, amended.</p> <table style="width: 100%; border-collapse: collapse;"> <tr> <td style="width: 10%; text-align: right;">Km</td> <td style="width: 10%; text-align: center;">Feature</td> <td></td> </tr> <tr> <td>0.0</td> <td>Woodburn P.O heading north along Pacific Hwy</td> <td></td> </tr> <tr> <td>3.9</td> <td>Turn RIGHT off hwy and cross grid</td> <td></td> </tr> <tr> <td>4.4</td> <td>Reservoirs</td> <td></td> </tr> </table>	Km	Feature		0.0	Woodburn P.O heading north along Pacific Hwy		3.9	Turn RIGHT off hwy and cross grid		4.4	Reservoirs	
Km	Feature												
0.0	Woodburn P.O heading north along Pacific Hwy												
3.9	Turn RIGHT off hwy and cross grid												
4.4	Reservoirs												
<p>Beacon Diagram</p> <p style="text-align: right;">Not to Scale</p> 	<p>This section to be completed by officer constructing pillar.</p> <p>Original station mark found/not found.</p> <p>Description of mark: .....</p> <p>Original beacon found/not found.</p> <p>Description of beacon: .....</p> <p>Height Top of Vanes to Top Mark.....m.</p> <p>Height of mark.....m. above rock/conc.....m. below G.L.</p> <p>Diameter of Vanes.....m. Height of Calm.....m.</p> <p>Original Beacon has/has not been destroyed by me.</p>												
<p>Date</p> <p>16 Dec</p>	<p>Record of Station</p> <p>Waiting permission in writing from Ross County Council                  letter received. Permission granted. Notice received before work commences</p>												

GEODETTIC SURVEY OF N.S.W.

CENTRAL MAPPING AUTHORITY

GEODETTIC STATION RECONNAISSANCE and MAINTENANCE REPORT

STATION: **Lanic (Pillar)** No.: **6666**  
 MAP SHEET SCALE 1:250 000  
 INSPECTED BY: **J. J. Kaid** DATE: **5 February 1988**  
 AUTHORITY: **C.M.A.** FIELD BOOK: **1827**

Description:

Note: Cross out word or words which do not apply

- Cleared by lanes bearing.....  $342^\circ$ .....  $186^\circ$ .....  $265^\circ$ .....  $285^\circ$ ..... from Trig, Mast pillar.
- Mast & Vanes have been painted white & black respectively. ✓
- The station/pillar was ~~used~~ ~~constructed~~ /constructed on.....  $5.16$ .....  $198$ ..... dimensions now being:  
 Description of marks.....  $33$ .....  $144$ ..... should be explicit, e.g., S/Steel Pillar Plate, Steel plug, Brass plug, Bolt, G.I. Pipe  
 Height of mark.....  $1.19$ ..... m.....  $42$ ..... m..... above ~~below~~ G.L.  
 Height of Top Vanes to Top Mast/Pillar plate.....  $1.44$ ..... m..... Diameter of Vanes (vertical).....  $750$ ..... m.  
 Height of Cairn..... m..... Diameter of Cairn..... m..... Name Plate found/~~not found~~/placed.  
 Length of Mast.....  $1.530$ ..... m..... (approximate if not measured/placed)

Brass Plug

- A ~~Survey~~ MARK set in conc/~~rock~~ has been placed/~~found~~, bearing.....  $177$ .....  $0^\circ$  M from Mast/~~Plug~~/Pillar
- A ~~G.I. pipe~~..... set in conc/~~rock~~ has been placed/~~found~~, bearing.....  $177$ .....  $0^\circ$  M from Mast/~~Plug~~/Pillar
- A ~~Survey~~ MARK set in conc/~~rock~~ has been placed/~~found~~, bearing.....  $273$ .....  $0^\circ$  M from Mast/~~Plug~~/Pillar
- A..... set in conc/~~rock~~ has been placed/~~found~~, bearing.....  $0^\circ$  M from Mast/~~Plug~~/Pillar

8. Action required.....

STANDPOINT: **Concrete Observation Pillar**

Mark	Direction	Horiz. Distance	Height Difference	Mark	Direction	Horiz. Distance	Height Difference
McPherson (Pillar)	$0$	$00$	above standpt	BROADWAY RT (P)	$0$	$00$	above standpt
Cable Mark	$3$	$03$	below standpt	EVANS MARK (P)	$172$	$07$	below standpt
Brass Plug (Trig)	$18$	$19$	above standpt	G.I. Pipe	$140$	$33$	below standpt
Measurement Centre Tower	$10$	$09$	below standpt	Conc. Obs. Pillar	$147$	$13$	above standpt
BROADWAY RT (P)	$122$	$02$	above standpt	Meers Road (Gate Mark)	$328$	$06$	below standpt
EVANS HEAD (P)	$214$	$09$	below standpt				
G.I. Pipe	$261$	$13$	above standpt				

STANDPOINT: **BRASS PLaque (Pillar)**

Mark	Direction	Horiz. Distance	Height Difference
McPherson (Pillar)	$0$	$00$	above standpt
Cable Mark	$3$	$03$	below standpt
Brass Plug (Trig)	$18$	$19$	above standpt
Measurement Centre Tower	$10$	$09$	below standpt
BROADWAY RT (P)	$122$	$02$	above standpt
EVANS HEAD (P)	$214$	$09$	below standpt
G.I. Pipe	$261$	$13$	above standpt

Prepared by: *[Signature]* Checked: *[Signature]* Noted on U.T.M. Card

GS 24

<p>STATION <u>LANG (Pillar) IS 6666</u></p>	<p>Owner's Name: <u>Ross County Council</u>                  Address: <u>33 CANWAY Street, LISMORE</u>                  Phone: <u>Contact Mr. Michael O'Keefe ~ 215241</u></p> <p>Current Occupant: .....                  Address: .....                  Phone: .....</p> <p>Access Report of <u>19.4.19</u> was found suitable/<del>unsuitable</del>.</p> <p style="text-align: center;"><u>ACCESS</u></p> <p><u>Feature</u>                  Woodburn PO. heading North along Pacific Highway.                  Turn right off highway and access grid.                  RESERVES AND Concrete observation pillar</p> <p><u>k.m.</u>                  0.0                  3.9                  4.4</p>
<p>Beacon Diagram</p> <p>Not to Scale</p> <p>0.25m                  0.15m                  0.25m                  1.50m                  1.75m</p> <p>Sixteen Vane                  Plate pillar                  0.25m</p>	<p>This section to be completed by officer constructing pillar.</p> <p>Original station mark found/<del>not found</del>.</p> <p>Description of mark: <u>Plate pillar</u></p> <p>Original beacon <del>found</del>/not found.</p> <p>Description of beacon: .....</p> <p>Height: Top of Vanes to Top Mark .....m.                  Height of mark <u>1.75</u> above rock/conc .....m. above G.L.                  below                  Diameter of Vanes .....m. Height of Capm .....m.</p> <p>Original Beacon <del>mark</del> has not been destroyed by me.</p>
	<p>Date</p> <p>Record of Station</p>



CENTRAL MAPPING AUTHORITY

GEODETIC SURVEY OF N.S.W.

GEODETIC STATION RECONNAISSANCE and MAINTENANCE REPORT

- Description:
- Note: Cross out word or words which do not apply
- Cleared by lanes bearing..... from Trig, Mast
  - Mast & Vanes have been painted white & black respectively. ✓
  - The station/~~pillar~~ ~~is not used~~ constructed on ~~5.7m x 19.8m~~ ~~19.8m x 19.8m~~ dimensions now being: ~~5.7m x 19.8m~~ ~~19.8m x 19.8m~~
- Description of mark/~~pillar~~ should be explicit, e.g., S/Steel Pillar Plate, Steel plug, Brass plug, Bolt, G.I. Pipe
- Height of mark.....m. above rock/concrete; Mark is.....m. above below G.L.
- Height of Top Vanes to Top ~~Steel Plate~~ ~~Steel Plate~~.....m. Diameter of Vanes (vertical) ~~0.619~~.....m.
- Height of Cairn.....m. Diameter of Cairn.....m. Name Plate found/not found/placed.
- Length of Mast.....m. (~~approximate if not measured~~)
- A. ~~Brass~~ ~~(Nagpe. 10g)~~ set in conc/~~rock~~ has been placed/found, bearing.....°M from Mast/~~Plug/Pillar~~
  - A..... set in conc/rock has been placed/found, bearing.....°M from Mast/~~Plug/Pillar~~
  - A..... set in conc/rock has been placed/found, bearing.....°M from Mast/~~Plug/Pillar~~
  - A..... set in conc/rock has been placed/found, bearing.....°M from Mast/~~Plug/Pillar~~
- Action required:.....

STANDPOINT:

Mark	Direction	Horiz. Distance	Height Difference	Mark	Direction	Horiz. Distance	Height Difference
MC PILLAR (Pillar)	0° 00' 00"		above standpt				above standpt
MEERSCHAUM (Lime)	90 14 02		above standpt				above standpt
LIME PLATE ON RESERVOIR	109 15 17	10.02	above standpt				above standpt
CONC. OBS. PILLAR	183 04 26	37.310	above standpt				above standpt
MAGNETIC PILLAR	321 00 30		above standpt				above standpt
* ECCENTRIC MARK NO 4 (SEE PLAN)			above standpt				above standpt

Prepared by: *[Signature]* Checked: *[Signature]* Noted on U.T.M. Card

SI 2733-1

STATION: LAMB (Pillar) At Copper Nail No.: 6666

MAP SHEET SCALE 1:250 000

INSPECTED BY: D.J. KAH

DATE: 9<sup>th</sup> February 1981

AUTHORITY: C.M.A. FIELD BOOK: 1627

GS 24

<p>STATION <u>LANG. RIDGE AT COPPER HILL 6666</u></p> <p>Owner's Name: <u>Ross County Council</u>                  Address: <u>33 Conway Street, Lisnaree</u>                  Phone: <u>Mr. Michael O'Keefe 25241</u></p> <p>Current Occupant: .....                  Address: .....                  Phone: .....</p> <p>Access Report of <u>9.12.1981</u> was found suitable/unsuitable.</p>	<p>Beacon Diagram</p> <p>Not to Scale</p> <p>0.20m 0.40m 1.30m 1.14m</p> <p>Beacon on Platform on Edge of Reservoir</p> <p>Reservoir</p> <p>Copper Hill</p> <p>G.L.</p>
<p>This section to be completed by officer constructing pillar.</p> <p>Original station mark found/not found. ....</p> <p>Description of mark: .....</p> <p>Original beacon found/not found. ....</p> <p>Description of beacon: .....</p> <p>Height Top of Vanes to Top Mark: .....m.</p> <p>Height of mark: .....m. above G.L.                  below</p> <p>Diameter of Vanes .....m. Height of Cairn .....m.</p> <p>Original Beacon has/has not been destroyed by me.</p>	
	<p>Date</p> <p>Record of Station</p>

6666  
 STATIONS 2186 LANG (P)  
 Co: RICHMOND  
 Map Sheet: WOODBURN  
 No: 9539  
 Inspected by: N.L. HURCUM  
 Date: 13-5-81  
 Authority: SURVEY CONTROL BRANCH  
 Field Book: TAA/18  
 Beacon Diagram  
 Not to Scale

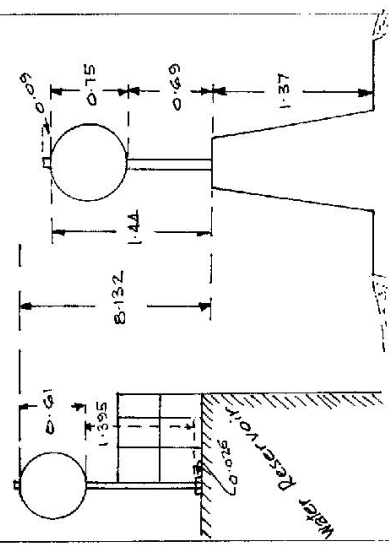

Date: 13-5-81  
 Record of Station  
 Connections by N.L. Hurcum.

Department of Lands  
 Integrator  
 RECONNAISSANCE and MAINTENANCE REPORT

Note: Cross out word or words which do not apply

This Trig. Station has been:

1. Completely cleared to permit 360° vision to surrounding Trigs.
2. Cleared by James bearing..... from Trig. Mast
3. Trig. Mast & Vanes have been painted white & black respectively. ✓
4. The Trig. was unpiled/~~not unpiled~~, dimensions now being:

Description of mark: ~~Concrete Pillar~~ should be explicit, e.g. Steel plug, Brass plug, Bolt, Concrete Pillar  
 Height of mark: 1.37 m <sup>above</sup> ~~rock~~ concrete 1.37 m <sup>above</sup> G.L.  
 Height of Top Vanes to Top Mast/Top pillar plate: 1.44 m Diameter of Vanes (vertical) 0.75 m.  
 Height of Cairn: ..... m. Diameter of Cairn: ..... m.

Length of Mast: 1.53 m. (approximate if not unpiled)

5. A ~~Pillar~~ <sup>Sub Survey</sup> set in conc./~~rock~~ has been placed/d 3.718 m. bearing 352.0M from Trig. Mast/pillar
6. A G.I. Pipe set in conc./soil has been placed/d 18.160 m. bearing 164.0M from Trig. Mast/pillar
7. A Copper Spike set in conc./soil has been placed/d 31.326 m. bearing 265.0M from Trig. Mast/pillar
8. A set in conc./rock has been placed/d ..... m. bearing .....M from Trig. Mast/pillar

9. Connection <sup>Copper Beacon</sup> Spike to Reservoir 10.911 m. bearing 12.0M

10. Connection to ..... m. bearing .....M

11. Connection to ..... m. bearing .....M

12. Connection to ..... m. bearing .....M

13. Diff. Ht. ~~Sub Survey~~ <sup>Pillar Plate</sup> ~~Pillar~~ is 1.511 m. <sup>below</sup>

14. Diff. Ht. G.I. Pipe to Cairn is 1.536 m. <sup>below</sup>

15. Diff. Ht. Copper Spike is 1.955 m. <sup>below</sup>

16. Diff. Ht. T.D. Res. Beacon is 8.132 m. <sup>above</sup>

Prepared by: N.L. Hurcum  
 Checked: .....

STATION TS 6666 LANG (P)  
 3756

Owners Name.....  
 Current Occupant.....

Address.....  
 Address.....

Access 13-5-1981  
 (NOT TO SCALE)  
 Drive to TS as per diagram

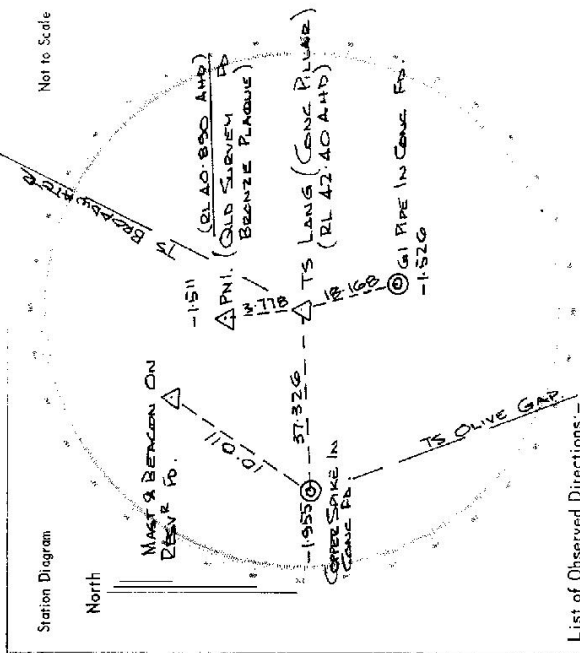
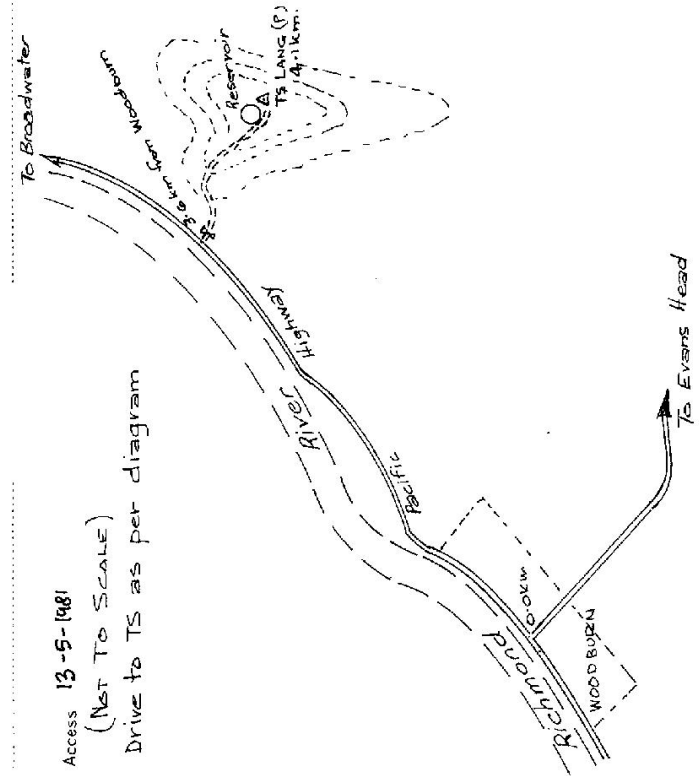

List of Observed Directions:-

Station	Direction	Station	Direction
TS 1164 Broadwater	25 02 24.7	TS 4341 OLIVE GAP	0 00 00
TS 10203 EVERS HEAD	117 09 23.5	BENCHON ON RESERVOIR	215 01 45
GI PIPE IN CONCRETE	164 13 04	TS LANG (CONC PILLAR)	288 53 39
CONCRETE SPIKE IN CONCRETE	266 04 20		
P.N.I. (OLD SURVEY POINT)	352 19 05		