

TS 6663

GEODETTIC SURVEY OF M.S.W.

CENTRAL MAPPING AUTHORITY

GEODETTIC STATION RECONNAISSANCE and MAINTENANCE REPORT

STATION: **NUMULGI**

MAP SHEET SCALE 1:250 000 **TWEED HERDS**

INSPECTED BY: **D. FREDRIKSEN**

DATE: **31/3/80**

AUTHORITY: **C.M.A.**

FIELD BOOK: **1852**

Description: *Note: Cross out word or words which do not apply*

- Cleared by lanes bearing **No. 6** bearing **148° 29'** from Trig. Mast
- Mast & Vanes have been painted white & black respectively. **Abandoned** **fd destroyed**
- The station/pillar was unpiled/~~not unpiled~~ constructed on **31.1.3.180.19**, dimensions now being: Description of mark **RASC** plaque should be explicit, e.g., S/Steel Pillar Plate, Steel plug, Brass plug, Bolt, G.I. Pipe
- Height of mark **0.5** m. above rock/concrete; Mark is **0.5** m. above G.L.
- Height of Top Vanes to Top Mark/Pillar plate **0.5** m. Diameter of Vanes (vertical) **0.5** m.
- Height of Cairn **0.5** m. Diameter of Cairn **0.5** m. Name Plate found/not found/placed.
- Length of Mast **0.5** m. (approximate if not unpiled)
- A.C.W. Nail** ~~set in conc/rock has been placed~~ **found**, bearing **215° 25'** M from Mast/Plug/Pillar **3.057** m
- A.C.I.P.** ~~set in conc/rock has been placed~~ **found**, bearing **118° 38'** M from Mast/Plug/Pillar **3.807** m
- A.** ~~set in conc/rock has been placed~~ **found**, bearing **0.5** M from Mast/Plug/Pillar
- A.** ~~set in conc/rock has been placed~~ **found**, bearing **0.5** M from Mast/Plug/Pillar
- Action required: **Pillar** ~~constructed~~, **marks** ~~searched~~ **found**.

Mark REQUIREMENTS	Direction	Height Difference	STANDPOINT:		Direction	Height Difference
			Height Distance	Direction		
GOONENGERRY	31° 40' Grid	G.S.	DIHEERS	148° 29' Grid	Trees & Blgs.	above standpt.
CLUNES	82° 22' hill	Not on	PEARCES CREEK	115° 25'	Reservoir	below standpt.
BROOKLET	50° 17' G.S.P.	hill	TEVEN	118° 38'	G.S.	above standpt.
LISMORE	22° 28' hill	G.S.	BYRON VIEW	65° 14'	G.S.P.	above standpt.
DUNDON	34° 28' G.S.	G.S.	GRANVILLE	65° 20'	House	above standpt.
			TREGERGLE	171° 47'	Blgs	below standpt.
			PARROTS NEST	222° 39'	gap in scrub	below standpt.

STATION DIAGRAM: **RASC plaque**

Prepared by: **D. Fredriksen** 16/4/80

Checked: **D. Fredriksen**

Noted on U.I.M. Card

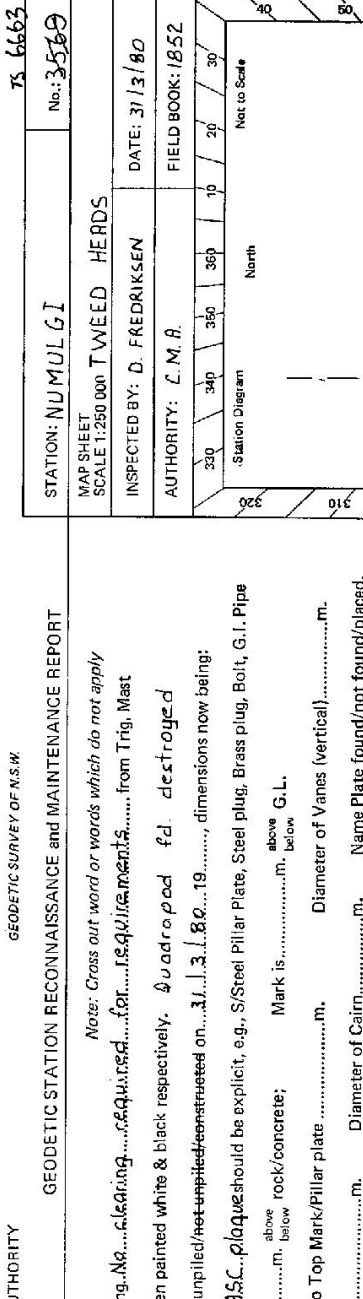

Station Diagram

North

Not to Scale

Boundary

Lance

2nd post from c.m.

RASC plaque in conc. fd

50m approx.

1.3m

320 310 300 290 280 270 260 250 240 230 220

210 200 190 180 170 160 150

Checked

16/4/80

D. Fredriksen

Noted on U.I.M. Card

Prepared by

D. Fredriksen

16/4/80

Checked

D. Fredriksen

SI 2733-2 D. West, Government Printer

Station NUMULGI

G.S. TS 6663

Beacon-Station	OTHER	TRIGS	SIGHTED	cont'd	Not to Scale
FERN'SIDE		255' 12'	60d	Not on (ridge abt 3 km)	
BENTLEY		264' 06'	.	hill (line grazes ridge 3km)	
CHEIMS FORD		277' 04'	.	S. end ridge Not high pt	
TOWER		293' 14'	.	Ridge (line grazes ridge 1.5 km)	
BILLET		301' 08'	.	Ridge (tree, this hill on line)	
STONY CHUTE		308' 19'	.	? Ridge	
PEACH MTN		5' 22'	.	Lookout tower	
MATHESON		349' 22'	.	Timbered hill	
BLUJE KNOB		332' 25'	.	Hill	
JERUSALEM		2' 53'	.	Not on	
Trig on water tower E. Lishate		191' 44'	.		

This section to be completed by officer constructing pillar.
 Original station mark found/not found.
 Description of mark:
 Original beacon found/not found.
 Description of beacon:
 Height Top of Vanes to Top Mark m.
 Height of mark m. above G.L.
 below
 Diameter of Vanes m. Height of Cairn m.
 Original Beacon has/not been destroyed by me.

Owner's Name: SELWAN, BRYAN
 Address: COSY CAMP R.D.
 Phone: 0661 284 323

CORNBALLE
 Phone: 282216

ACCESS
 old Access Report of 21/3/1988 was found ~~unsuitable~~ (unsuitable).
 Kms.
 0-00 BEXHILL P.O. head towards Corn Dale & Rosebank 1.5"
 1-13 Turn LEFT towards NUMULGI
 3-03 Turn RIGHT towards DUNDON 9" at intersection BEXHILL 4 & LISMORE 9"
 6-33 Turn RIGHT off bitumen just before house.
 7-21 Thro iron gate before sheds
 7-33 Thro iron gate past W. ELLIOTT'S house on RHS then another house on L.H.S.
 7-54 Thro iron gate up ridge past tank & to left along top of ridge.
 8-08 RT fence. Trig. is about 50m east of here.

Piling overseers should contact both owners re. cutting the fence. (should be O.K.)

Date	Record of Station
	Access
	Construction permission granted.

CENTRAL MAPPING AUTHORITY

GEODETIC STATION RECONNAISSANCE and MAINTENANCE REPORT

- Description: *Note: Cross out word or words which do not apply*
 1. Cleared by lanes bearing 360° from Trig. Mast
 2. Mast & Vanes have been painted white & black respectively.
 3. The station/pillar was unpiled/not unpiled/constructed on 11.7×19.8 m., dimensions now being:
 Description of mark S/S Pillar should be explicit, e.g., S/Steel Pillar Plate, Steel plug, Brass plug, Bolt, G.I. Pipe
 Height of mark 1.365 m. above below reek/concrete; Mark is 1.515 m. above below G.L.
 Height of Top Vanes to Top Mark/Pillar plate 1.400 m. Diameter of Vanes (vertical) 0.755 m.
 Height of Cairn 1.450 m. Diameter of Cairn 1.450 m. Name Plate found/not found/placed.
 Length of Mast 1.450 m. (approximate if not unpiled)
 4. Copper Nail set in conc/reek has been placed/found, bearing 358° M from Mast/Plug/Pillar
 5. Copper Nail set in conc/reek has been placed/found, bearing 229° M from Mast/Plug/Pillar
 6. R.A.S.C. Pillar set in conc/reek has been placed/found, bearing 307° M from Mast/Plug/Pillar
 7. R.A.S.C. Pillar set in conc/reek has been placed/found, bearing 307° M from Mast/Plug/Pillar
 8. Action required: CONCRETE Pillar

Mark	Direction	Horiz. Distance	Height Difference	Mark	Direction	Horiz. Distance	Height Difference
GOODENGERY (P)	359 59 60		above standpt	GOODENGERY (P)	359 59 60		above standpt
BROOKLET (P)	58 36 30		above standpt	COPPER NAIL	56 46 20	3.056	above standpt
WYRALLAH RES	163 06 15		above standpt	BROOKLET PILLAR	58 36 25		above standpt
LISMORE (P)	197 49 45		above standpt	WYRALLAH RES	163 03 00		above standpt
R.A.S.C. PILLAR	289 20 10	3.703	1.700 below	WYRALLAH RES	163 03 00		above standpt
DUNSCON PILLAR	311 44 30		above standpt	WYRALLAH RES	163 03 00		above standpt
COPPER NAIL	338 17 50	2.787	1.538 below	DUNSCON PILLAR	311 44 30		above standpt
G.I. P. P.	210 01 20	2.337	1.495 below				

STANDPOINT: R.A.S.C. PLAGUE

Checked: *[Signature]*

Prepared by: *[Signature]*

Sr 2743-1

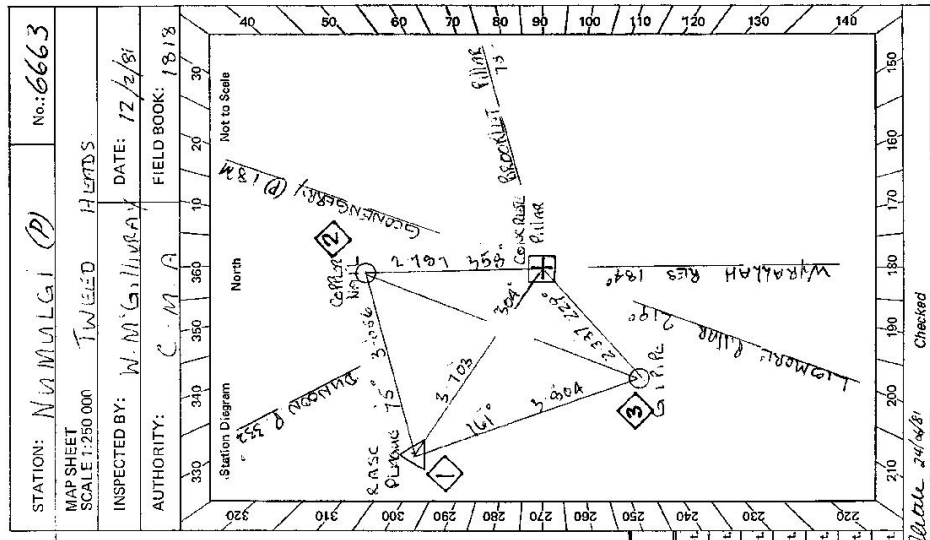

STATION: NIMULGI (P) No: 6663
 MAPSHEET SCALE: 1:250 000 TWEEED HILLS
 INSPECTED BY: W.M. GILGIBRAY DATE: 12/2/81
 AUTHORITY: C.M.A. FIELD BOOK: 1813

STATION NUMMULESI (P) TS 6663

Owner's Name: SILVAIN BAYANI Current Occupant:

Address: COZY CAMP ROAD Address:

Phone: 066 287323 Phone:

ACCESS

Access Report of 17/10/18 was found suitable/unsuitable.

FROM LISMOBE TAKE THE BANGALOW ROAD TO THE VILLAGE OF BEXHILL

POST OFFICE BEXHILL HEAD TOWARDS CORNDALE & ROADBANK IS

0.0 TURN LEFT TOWARDS NUMMULESI

1.13 TURN RIGHT TOWARDS DUNDON 9

3.83 TURN RIGHT OFF BITUMEN JUST BEFORE HOUSE.

6.53 IRON GATE SHEPHERD SHEDS.

7.21 IRON GATE W ELLIOTT'S HOUSE ON RIGHT ANOTHER HOUSE ON LHS

7.55 IRON GATE DRIVE UP GRASSY BANK

8.10 O.K. TO UNDO FENCE

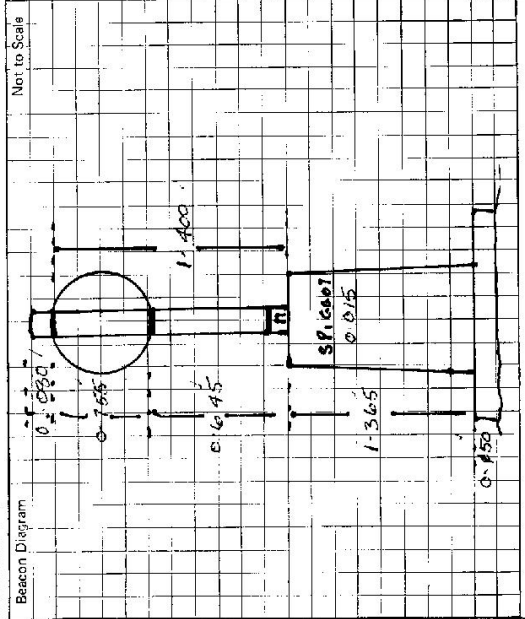

This section to be completed by officer constructing pillar.

Original station mark found/not-found.

Description of mark: R.A.S.C. PLAGUE

Original beacon found/not found.

Description of beacon:

Height Top of Vanes to Top Markm.

Height of markm above G.L. below

Diameter of Vanesm Height of Cairnm.

Original Beacon has/has not been destroyed by me.

Date	Record of Station