

STATION GRASSLEE (PTS) 6657

Owners Name.....

Current Occupant.....

Address.....

Address.....

Access 8-9-1975 AND

Murwellbrook PO travel towards Singleton
 take sealed road on left signposted Muscle Creek Rd.
 Cross bridge over railway
 Concrete causeway
 Take gravel road on right
 Take right fork through iron gate
 Iron gate
 Take right fork
 Wooden gate
 Take iron gate on left - have on right - follow across grassy
 paddock above dam with fence on RHS.
 Through iron gate on fence corner from here work your way down
 paddock to old slip roads
 Travel between dam & fence then take very faint trail
 to your right just above lone ironback tree. Follow up grassy
 ridge in an ~~east~~ easterly direction
 Pass through old wooden gate then travel as far as possible
 up ridge by vehicle
 Leave vehicle TS is 136° from here about 1 hour walk.

- 1:00
- 5:00
- 6:00
- 6:30
- 11:59
- 12:32
- 12:40
- 13:08
- 14:09
- 15:13
- 16:10
- 16:34
- 16:58
- 17:22
- 18:35
- 18:52

Not to Scale

Station Diagram

North

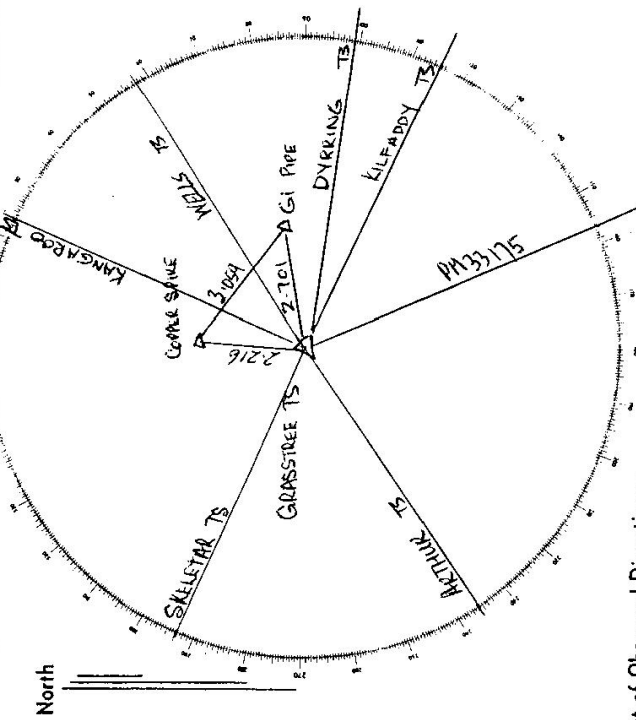

List of Observed Directions:-

Standpoint: TRIG AUG.

Station	Direction	Station	Direction
ACTARUE TS	0° 00' 00"		
SKELSTAR TS	57° 04' 36.6"		
KANGAROO TS	144° 17' 43"		
WELLS TS	182° 16' 25.6"		
DYRRING TS	222° 14' 22.2"		
Station	Direction	Station	Direction
KILFADDY TS	246° 22' 49.0"		
PM 33175	279° 25' 54.3"		
COPPER SAUCE	127° 40' 58"		
GI PIPE	203° 58' 30"		

CENTRAL MAPPING AUTHORITY

GEODETTIC SURVEY OF N.S.W.
GEODETTIC STATION RECONNAISSANCE and MAINTENANCE REPORT

Description:

Note: Cross out word or words which do not apply

1. Cleared by lanes bearing..... from Trig. Mast
2. Mast & Vanes have been painted white & black respectively.
3. The station/~~pillar~~ was unpiled/~~not repaired/constructed~~ on..... 20.7..... 19.726..... dimensions now being:
Description of mark.....
Height of mark.....
Height of Top Vanes to Top Mark/Pillar plate.....
Height of Cairn.....
Length of Mast.....
4. A. ~~Cairn~~..... set in conc/rock has been placed/~~found~~, bearing..... 271°..... M from Mast/Plug/Pillar
5. A. ~~Cairn~~..... set in conc/rock has been placed/~~found~~, bearing..... 172°..... M from Mast/Plug/Pillar
6. A..... set in conc/rock has been placed/~~found~~, bearing..... °M from Mast/Plug/Pillar
7. A..... set in conc/rock has been placed/~~found~~, bearing..... °M from Mast/Plug/Pillar

8. Action required:.....

Mark	Direction	Horiz. Distance	Height Difference	Mark	Direction	Horiz. Distance	Height Difference
Bells Mountain	359° 59' 40"		above standpt.	Bells Mountain	359° 59' 40"		above standpt.
G.I. Pillar 1	53° 12' 15"	3.847	above standpt.	G.I. Pillar 1	83° 25' 15"	5.549	below standpt.
Wells	92° 24' 09"		below	Wells	92° 24' 20"		below standpt.
Cairn	304° 32' 35"	2.952	above standpt.	Grass Pile	174° 33' 05"	2.955	above standpt.
			below				below
			above standpt.				above standpt.
			below				below
			above standpt.				above standpt.
			below				below

STANDPOINT: BRASS TRIG. PILE / CORNER MAIL 2
STANDPOINT: CORNER MAIL 2
Prepared by: [Signature] Checked: [Signature] 23.11.78 Note on U.T.M. Grid

SR 2733-1

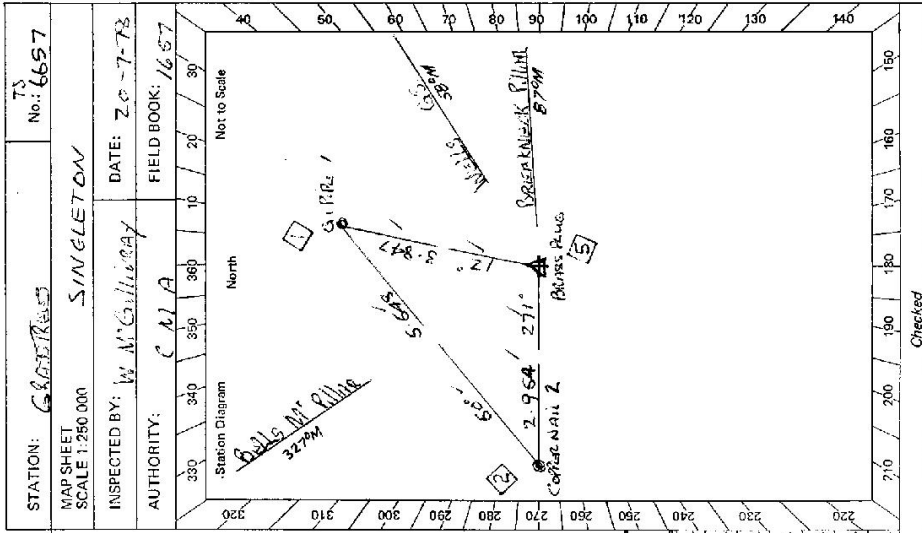

Checked

St 2738-2 D. West, Government Printer

STATION **GRASS PILES TS 6657**

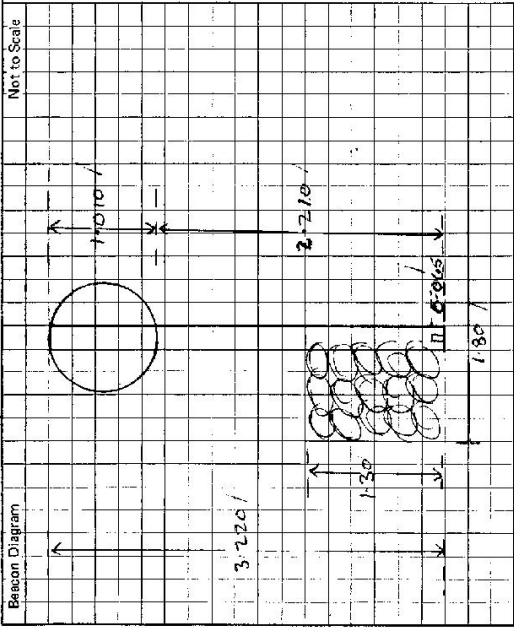

Owner's Name: **HERBY PERAIN**
 Address: **1150 KILPATRICK HWY**
 Phone: **MALDEN MASS**

Current Occupant:
 Address:
 Phone:

ACCESS
 Access Report of **7/7/1978** was found suitable/unsuitable.

This section to be completed by officer constructing pillar.

Original station mark found/~~not found~~:

Description of mark: **GRASS PILES**

Original beacon found/~~not found~~:

Description of beacon: **PILE OF STONES**

Height Top of Vane to Top Mark: **3.905** m.

Height of mark: **0.00** m. above rock/stone below G.L.

Diameter of Vane: **1.010** m. Height of Cairn: **1.30**

Original Beacon has/~~was~~ been destroyed by me.

Date

Record of Station

GEODETTIC SURVEY OF N.S.W.

CENTRAL MAPPING AUTHORITY

GEODETTIC STATION RECONNAISSANCE and MAINTENANCE REPORT

Description:

1. Cleared by lances bearing.....265.....271 M.....279.....241 M..... from Trig. **Mass Pillar**.
 Note: Cross out word or words which do not apply

2. Mast & Vanes have been painted white & black respectively.

3. The ~~station~~/pillar was ~~reconstructed~~/constructed on.....15.....~~19~~..... dimensions now being:

Description of mark.....~~set~~ **Mass Pillar** should be explicit, e.g., S/Steel Pillar Plate, Steel plug, Brass plug, Bolt, G.I. Pipe

Height of mark.....1.380.....m. above ~~base~~/concrete; Mark is.....1.460.....m. above G.L.

Height of Top Vanes to Top ~~Mark~~/Pillar plate1.430.....m. Diameter of Vanes (vertical).....0.150.....m.

Height of Cairn.....m. Diameter of Cairn.....m. Name Plate ~~reconstructed~~/placed.

Length of Mast.....1.530.....m. (~~applied~~)

4. A.....~~Brass~~ **Pin**.....set in ~~concrete~~/rock has been ~~placed~~/found, bearing.....52.....° M from ~~Mass~~/Pillar

5. A.....~~Copper Nail~~ **NO(1)**.....set in conc/~~rock~~ has been ~~placed~~/found, bearing.....12.....° M from ~~Mass~~/Pillar

6. A.....~~Copper Nail~~ **NO(2)**.....set in conc/~~rock~~ has been ~~placed~~/found, bearing.....31.6.....° M from ~~Mass~~/Pillar

7. A.....~~G.I. Pipe~~.....set in conc/~~rock~~ has been ~~placed~~/found, bearing.....73.....° M from ~~Mass~~/Pillar

8. Action required:.....

STANDPOINT: **Concrete Observation Pillar**

Mark	Direction	Horiz. Distance	Height Difference	Mark	Direction	Horiz. Distance	Height Difference
Wells G.S.	0° 00' 00"	0.00	above standpt.	Well G.S.	0° 00' 00"	0.00	above standpt.
Savoy (Pillar)	160 47 35	1.61	above standpt.	Savoy (Pillar)	161 25 27	1.61	above standpt.
Arthur (Pillar)	177 43 39	1.77	above standpt.	Conc. obs. pillar	172 44 43	2.243	above standpt.
Copper Nail (Pillar)	267 36 47	1.876	above standpt.	Arthur (Pillar)	177 43 41	1.77	above standpt.
Bella Mtn (1)	329 11 49	4.079	above standpt.	Copper Nail NO(2)	272 11 18	2.952	above standpt.
G.I. Pipe (1)	322 24 31	5.867	above standpt.	Bells Mtn (Pillar)	267 34 05	2.67	above standpt.
Brass Plug	352 46 19	2.233	below standpt.	Copper Nail No. (1)	305 08 57	2.212	above standpt.
				Copper Nail (1)	320 42 53	3.883	above standpt.

Prepared by:..... Checked:..... (Noted on U.T.M. Card)

54 2733-1

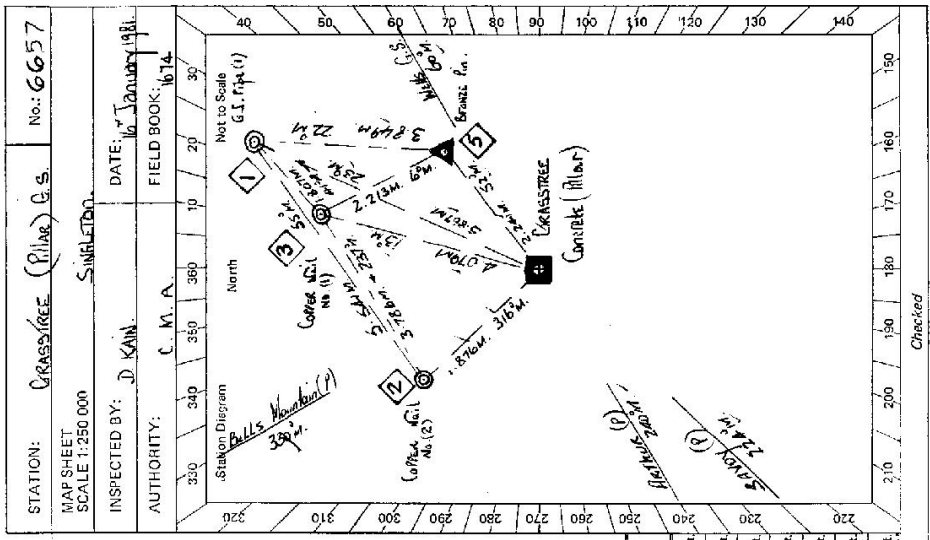

Checked

