

TS 6652

STATION: HOMELEIGH G.S.

No. 2502

MAP SHEET  
SCALE 1:250 000 TWEED HERDS

INSPECTED BY: D. FREDRIKSEN

DATE: 16/6/80

AUTHORITY: C.M.H.

FIELD BOOK: 1873

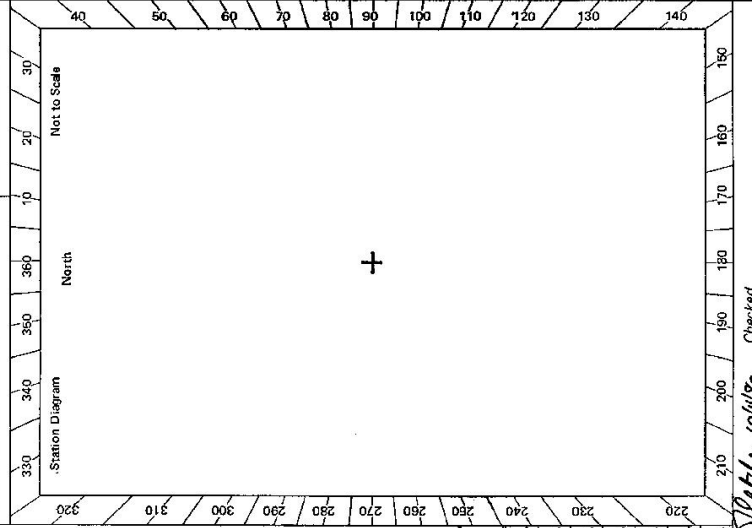

GEODETIC SURVEY OF N.S.W.

GEODETIC STATION RECONNAISSANCE and MAINTENANCE REPORT

- Description: *Note: Cross out word or words which do not apply*
- Cleared by lanes bearing..... from Trig. Mast
  - Mast & Vanes have been painted white & black respectively.
  - The station/pillar was ~~erected~~ *erected* on ~~.....~~ *.....*, dimensions now being:
    - Description of mark..... should be explicit, e.g., S/Steel Pillar Plate, Steel plug, Brass plug, Bolt, G.I. Pipe
    - Height of mark.....<sup>above</sup> m. ~~.....~~ *.....* m. <sup>above</sup> G.L.
    - Height of Top Vanes to Top Mark/Pillar plate..... m. Diameter of Vanes (vertical)..... m.
    - Height of Cairn..... m. Diameter of Cairn..... m. Name Plate found/not found/placed.
    - Length of Mast..... m. (approximate if not unpiled)
  - A..... G.I. P..... set in conc/reek has been placed/found, bearing  $322.0^\circ$  M from Mast/Plug/Pillar 3.06 m
  - A..... S.S.M..... set in conc/reek has been placed/found, bearing  $138.0^\circ$  M from Mast/Plug/Pillar 2.26 m
  - A..... set in conc/rock has been placed/found, bearing..... M from Mast/Plug/Pillar
  - A..... set in conc/rock has been placed/found, bearing..... M from Mast/Plug/Pillar
  - Action required: ~~clearing~~ *pillar constructed*

Mark	Direction	Horiz. Distance	Height Difference	Mark	Direction	Horiz. Distance	Height Difference	STANDPOINT:	
								OTHERS	NOT ON SURVEY
GREEN PINGEON (EDM)	1713' 60"	hill top	above standpt.	AFTERLEE	260' 35' 6"	doubtful	above standpt.		
STONY CHUTE (EDM)	113' 26' "	C.M.V.	above standpt.	ETTRICK	245' 24' 6"	"	above standpt.		
BOORABEE (EDM)	195' 46' "	Vanes	above standpt.	EDEN	223' 01' 6"	"	above standpt.		
			below standpt.	DYRABARA	239' 29' 6"	10'	above standpt.		
			below standpt.	SQUIN ORELSK	273' 46' 6"	hill	above standpt.		
			below standpt.				below standpt.		
			above standpt.				above standpt.		

Prepared by: D. Fredriksen 24/6/80 Checked: P. Holden 26/6/80 Noted on U.T.M. Card

Sketch 10/1/80 Checked

4r 2738-2 D. West, Government Printer

Beacon Diagram

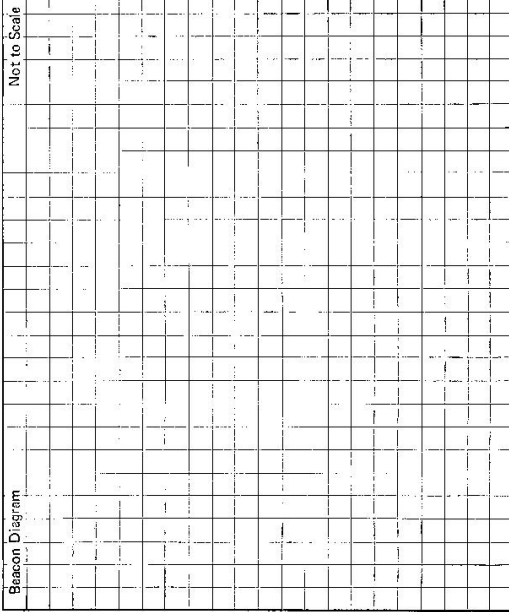

This section to be completed by officer constructing pillar.

Original station mark found/not found.

Description of mark: .....

Original beacon found/not found.

Description of beacon: .....

Height Top of Vanes to Top Mark: .....m.

Height of mark: .....m. above below rock/conc .....m. above below G.L.

Diameter of Vanes: .....m. Height of Cairn: .....m.

Original Beacon has/has not been destroyed by me.

STATION HOMELEIGH G.S. TS. 6652

Owner's Name: K. B. GRIFFITHS .....  
 Current Occupant: .....  
 Address: S.C.C. Access: H. B. ....  
 Phone: .....  
 Address: .....  
 Phone: .....

ACCESS

old Access Report of 16.6.1988 was found suitable/unavailable.  
 Kms. Feature  
 0.00 KYDGE P.O. head towards Murwillumbah  
 2.09 Turn right towards Murwillumbah 71, Nimbin 31  
 5.24 Turn LEFT towards "Homeleigh" just before Back Crk. bridge  
 8.92 End of bitumen  
 14.01 Pass "Loopers Dip" and yards on L.H.S.  
 14.62 Turn RIGHT off road thro' iron gate at farmhouse  
 14.66 Pass between owners house and sheds  
 14.72 Thro' iron gate  
 14.99 Thro' wire gate  
 15.07 Creek crossing  
 15.33 Right hand bend in laneway  
 15.58 Thro' iron gate go up hill  
 15.92 Take left iron gate (3 gates)  
 16.21 Thro' wire gate take cutting to right  
 16.5 Turn hard left up cutting just past apple gum  
 16.8 Turn LEFT up spur  
 17.0 At fence on top of hill turn Right along ridge  
 17.4 At trig. (drive is slippery and boggy in wet)

approx. distances

Date

Record of Station

Access, Cleaning and construction permission granted.

CENTRAL MAPPING AUTHORITY

GEODETIC SURVEY OF N.S.W.

GEODETIC STATION RECONNAISSANCE and MAINTENANCE REPORT

- Description:
- Cleared by lanes bearing  $360^\circ$ . *Note: Cross out word or words which do not apply*
  - Mast & Vanes have been painted white & black respectively. ✓
  - The station/pillar was ~~unplaced~~ ~~not unplaced~~ /constructed on  $2.12$ ..... $19.80$ ..... dimensions now being: Description of mark **PLATE** ~~PLATE~~ should be explicit, e.g. S/Steel Pillar Plate, Steel plug, Brass plug, Bolt, G.I. Pipe
  - Height of mark  $1.375$ .....m. <sup>above</sup> ~~below~~ ~~feet~~/concrete; Mark is  $5.25$ .....m. <sup>above</sup> ~~below~~ Diameter of Vanes (vertical)  $0.750$ .....m.
  - Height of Top Vanes to Top Mark/Pillar plate  $1.490$ .....m. Diameter of Cairn.....m. Name Plate found/not found/placed.
  - Length of Mast..... $1.570$ .....m. (approximate if not unplaced)
  - A **PLATE** set in conc/rock has been placed/~~found~~, bearing  $258.0^\circ$  M from Mast/Plug/Pillar
  - A **S.S.M.** set in conc/rock has been placed/~~found~~, bearing  $228.0^\circ$  M from Mast/Plug/Pillar
  - A **G.I. P.P.** set in conc/rock has been placed/~~found~~, bearing  $293.0^\circ$  M from Mast/Plug/Pillar
  - A..... set in conc/rock has been placed/~~found~~, bearing..... $^\circ$  M from Mast/Plug/Pillar
  - Action required:.....

STANDPOINT: <b>CONSULTE Pillar</b>				STANDPOINT: <b>A.S.C PLATE</b>			
Mark	Direction	Horiz. Distance	Height Difference	Mark	Direction	Horiz. Distance	Height Difference
THE HELMLET GS	359 59 60		above standpt.	THE HELMLET GS	359 59 60		below standpt.
BOERABOEL Pillar	299 11 10		below standpt.	G.I. P.P.	26 16 30	3.067	above standpt.
Fairy Mount P	275 14 40		above standpt.	HELMLET GS P	193 10 50	2.368	below standpt.
S.S.M	293 16 20	3.988	above standpt.	BOERABOEL Pillar	299 09 30		below standpt.
A.S.C PLATE	323 12 40	2.369	below standpt.	S.S.M	261 51 30	2.268	above standpt.
G.I.P.P.	359 15 50	4.649	below standpt.	Fairy Mount P	275 13 25		below standpt.

Prepared by:

Checked:

Noted on U.T.M. Card

Checked

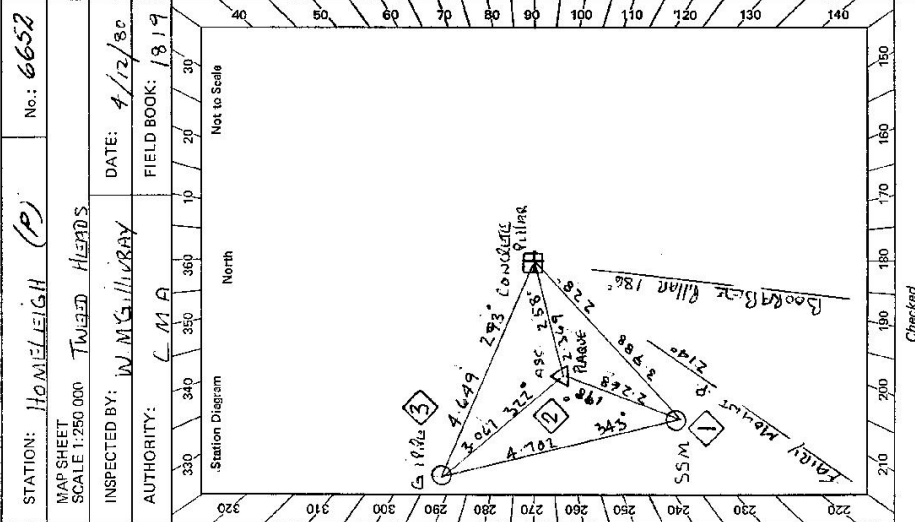

STATION: **HOMELIGHT (P)** No.: **6652**

MAP SHEET SCALE 1:250 000 **TWILVED HEADS**

INSPECTED BY: **W.M. GILLIVRAY** DATE: **4/12/80**

AUTHORITY: **C.M.A.** FIELD BOOK: **1819**

Station Diagram

North

Not to Scale

320 330 340 350 360 370 380 390 400

220 230 240 250 260 270 280 290 300 310 320

40 50 60 70 80 90 100 110 120 130 140

150 160 170 180 190 200 210 220

150 160 170 180 190 200 210 220

150 160 170 180 190 200 210 220

150 160 170 180 190 200 210 220

150 160 170 180 190 200 210 220

150 160 170 180 190 200 210 220

150 160 170 180 190 200 210 220

150 160 170 180 190 200 210 220

150 160 170 180 190 200 210 220

150 160 170 180 190 200 210 220

150 160 170 180 190 200 210 220

150 160 170 180 190 200 210 220

150 160 170 180 190 200 210 220

150 160 170 180 190 200 210 220

150 160 170 180 190 200 210 220

150 160 170 180 190 200 210 220

150 160 170 180 190 200 210 220

150 160 170 180 190 200 210 220

150 160 170 180 190 200 210 220

150 160 170 180 190 200 210 220

150 160 170 180 190 200 210 220

150 160 170 180 190 200 210 220

150 160 170 180 190 200 210 220

150 160 170 180 190 200 210 220

150 160 170 180 190 200 210 220

150 160 170 180 190 200 210 220

150 160 170 180 190 200 210 220

150 160 170 180 190 200 210 220

150 160 170 180 190 200 210 220

150 160 170 180 190 200 210 220

150 160 170 180 190 200 210 220

150 160 170 180 190 200 210 220

150 160 170 180 190 200 210 220

150 160 170 180 190 200 210 220

150 160 170 180 190 200 210 220

150 160 170 180 190 200 210 220

dt. 2733-2 D. West, Government Printer

STATION **HOMELLEIGH (P) TS 6652**

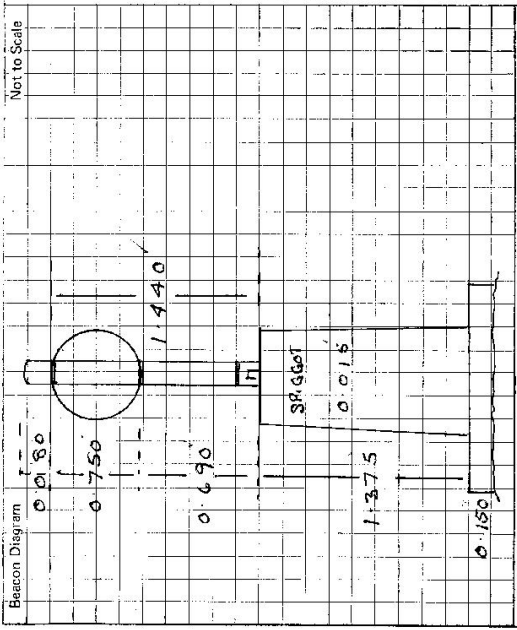

Owner's Name: **K. B. GARLFFITHS**  
 Address: **S.E.L. ACCESS**  
 Phone: **1466**

Current Occupant:  
 Address:  
 Phone:

**ACCESS**

Access Report of 16/1/1988 was found suitable/unsuitable:  
 0:00 POST OFFICE KYOGLE HEAD TO WARDS MURWILLUMBAH ..  
 2:09 TURN RIGHT TOWARDS MURWILLUMBAH 71 NIMBIN 31 ..  
 5:29 TURN LEFT TOWARDS HOMELLEIGH  
 8:92 END OF BITUMEN  
 14:62 TURN RIGHT THROUGH GATE AT FARM HOUSE.  
 14:66 PASS BETWEEN OWNERS HOUSE & SHEDS  
 14:72 IRON GATE.  
 14:99 WIRE GATE.  
 15:07 GREEN CROSSING  
 15:53 TAKE RIGHT HAND BEND IN LANE WAY.  
 15:58 IRON GATE GO UP HILL.  
 15:52 TAKE LEFT IRON GATE. (3 GATES)  
 16:21 WIRE GATE. TAKE CUTTING TO RIGHT  
 16:50 TURN HARD LEFT UP CUTTING  
 17:00 AT FENCE ON TOP OF HILL TURN RIGHT ALONG RIDGE  
 17:40 G.S.

(TRACK IS SLIPPERY WHEN WET)

This section to be completed by officer constructing pillar.

Original station mark found/lost/destroyed: .....

Description of mark: **ARMY SURVEY CORPS PLATEAU**

Original beacon found/lost/destroyed: .....

Description of beacon: **ROCK CAIRN** ..... m.

Height Top of Vanes to Top Mark: **3.825** ..... m.  
above below

Height of mark: **6.6** ..... m. above below G.L.

Diameter of Vanes: **1.010** ..... m. Height of Cairn: **1.00** ..... m.

Original Beacon has/has not been destroyed by ma. ....

Date	Record of Station