



STATION POCUPAR 74 T.S. 6647

Owners Name, In. State Forest  
 Current Occupant  
 Address

Access MILEAGE  
 0-0  
 0-60  
 1-15  
 1-25  
 1-45  
 2-65  
 2-70  
 4-85  
 5-70  
 5-75  
 5-80  
 6-45  
 6-90  
 7-0  
 7-10  
 7-35  
 7-40  
 8-50  
 9-25  
 10-50

FEATURE  
 OLD BONALBO P.O. Travelling South  
 BRIDGE, KOOKSONS C.K.K.  
 Turn right onto gravel road at 'Joes Box' Sign 'HAYSTACK RD'  
 Bear right at fork  
 Bridge on L.H.S.  
 Yards on L.H.S.  
 Bridge  
 Grid  
 Grid  
 Bridge  
 Pass track on L.H.S.  
 Grid  
 Grid  
 Yards on R.H.S.  
 Bridge  
 Bear left at fork  
 Turn onto track on L.H.S. ✓  
 GRID  
 GRID  
 Large wooden grid.  
 Old caravan on right. Take track on left here  
 Follow this track to its end in a small clearing. Leave vehicle  
 and walk through scrub for about 100m thence swing right, cross  
 gully onto ridge Follow this ridge onto top of hill.

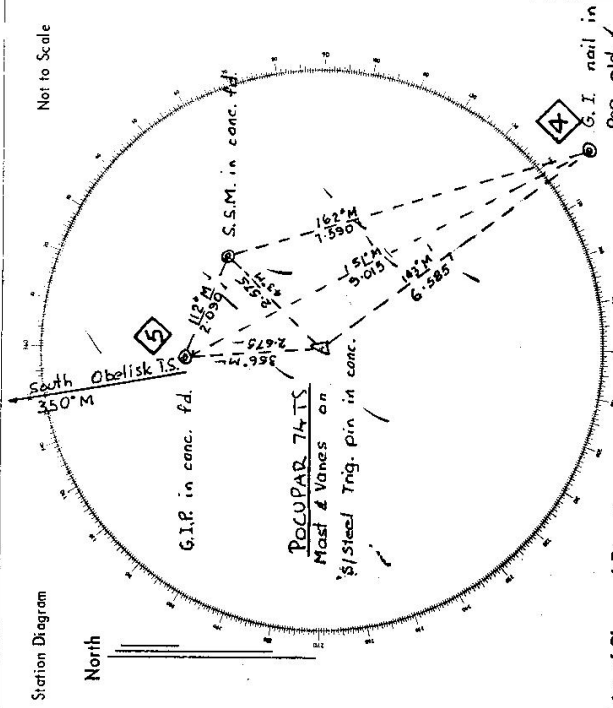

List of Observed Directions:-

Standpoint: G.I. nail in Peg pld.      Standpoint: S.S.M. in conc.

Station	Direction	Station	Direction
South Obelisk T.S.	0° 00' 00"	South Obelisk T.S.	0° 00' 00"
Mast	333° 27' 00"	G.I. nail in Peg pld.	172° 47' 30"
G.I.P. in conc. fld.	342° 10' 00"	Mast	230° 47'
S.S.M. in conc. fld.	352° 47' 00"	G.I.P. in conc.	300° 11'

Station	Direction	Station	Direction
Standpoint G.I.P. in conc.			
South Obelisk T.S.	0° 00' 00"		
S.S.M. in conc. fld.	120° 11'		
G.I. nail in Peg pld.	162° 09' 30"		
Mast	184° 28'		

68

TS 6647

GEODETTIC SURVEY OF N.S.W.

CENTRAL MAPPING AUTHORITY

GEODETTIC STATION RECONNAISSANCE and MAINTENANCE REPORT

STATION: POCUPAR No.: 5888

MAP SHEET SCALE 1:250 000 WARWICK (CAPEEN 1:25,000)

INSPECTED BY: A. Sivertsen DATE: 3-7-80

AUTHORITY: CMA FIELD BOOK: 1848

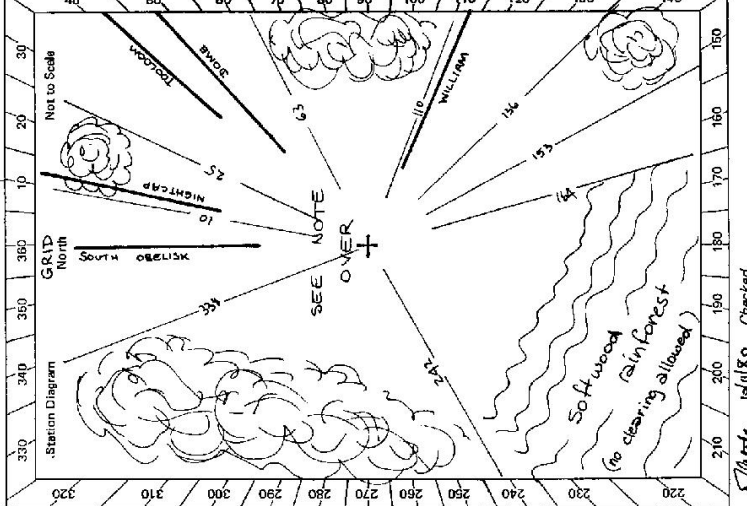

- Description:
1. Cleared by lanes bearing *See diagram*..... from Trig. Mast  
*Note: Cross out word or words which do not apply*
2. Mast & Vanes have been painted white & black respectively.
3. The station/pillar was unpiled/constructed on..... 19....., dimensions now being:  
 Description of mark..... should be explicit, e.g., S/Steel Pillar Plate, Steel plug, Brass plug, Bolt, G.I. Pipe  
 Height of mark..... m. above rock/concrete; Mark is..... m. above G.L.  
 Height of Top Vanes to Top Mark/Pillar plate..... m. Diameter of Vanes (vertical)..... m.  
 Height of Cairn..... m. Diameter of Cairn..... m. Name Plate found/not found/placed.  
 Length of Mast..... m. (approximate if not unpiled)
4. A..... S.M. set in conc/rock has been placed/found, bearing.....° M from Mast/Plug/Pillar at 2.6 m
5. A..... G.I. Pipe set in conc/rock has been placed/found, bearing.....° M from Mast/Plug/Pillar at 2.7 m
6. A Nail in peg, NOT F.P. set in conc/rock has been placed/found; bearing.....° M from Mast/Plug/Pillar
7. A..... set in conc/rock has been placed/found, bearing.....° M from Mast/Plug/Pillar
8. Action required: Place some pillar / clear timber / if necessary. NOT SET F.TWO OF.....

STANDPOINT:		STANDPOINT:		STANDPOINT:			
Mark REQUIRED	Direction	Horiz. Distance	Height Difference	Mark OTHERS	Direction	Horiz. Distance	Height Difference
NIGHTCAP VA	Hill		above standpt	TOOLOOM	M & V		above standpt
DOME VA	Hill		above standpt	DYRABBA			above standpt
WILLIAM EDM	Hill		above standpt	↑ EDINBURGH CASTLE & PEACOCK?			above standpt
SOUTH ORELSK EDM	Hill		above standpt	hill is cleared.			above standpt
			above standpt				above standpt
			above standpt				above standpt
			above standpt				above standpt
			above standpt				below

Prepared by: A. Sivertsen 6-7-80 Checked: H. Holden Noted on U.T.M. Card

658

27331-2 D. West Government Printer

Not to Scale

Beacon Diagram

CLEARING : Suckering & clearing essential hardwoods OK by Forestry.

PILLAR : OK by Forestry.

Note: 1) Blade grass will have to be cleared nearly to ground level for line to WILLIAM GS or the pillar be placed further SE.  
 2) Clearing softwood rainforest is prohibited (no requirements here anyway).

Original Beacon has not been destroyed by me.

STATION POCUPAR TS 6647

Owner's Name: Forestry Comm. of NSW  
 Address: URBENVILLE Sub-District  
 FORESTER, Mr. Pat COONEY  
 Phone: (066) 341318 (Home 341253)

Current Comment: This is in  
 Address: YABBERA STATE FOREST  
 No 394  
 Phone:

ACCESS

Access Report of: 19/18 was found suitable/unsuitable. AWD (2WD in very dry conditions) to 16.6

0.0 km At locality known as JOES BOX which is 9.5 km north of BONALBO and is 2.1 km south of OLD BONALBO. Take road west-sign YABBERA RD, HAYSTACK RD Take HAYSTACK CREEK RD to left.

1.75 Grid Take left fork

2.2 Grid Take left fork

3.3 Grid Take left fork

6.3 Grid Take left fork

7.0 Grid Take left fork

7.3 Grid Take right fork over grid. (SOUTH HAYSTACK RD)

7.7 Grid Take right fork

8.4 Grid Take right fork POCUPAR ROAD

10.1 Grid Take right fork (YABBERA LINK RD goes to left)

12.9 Grid Take right fork POCUPAR TRIG ROAD (CORKWOOD RD goes to right)

15.45 Grid Turn left POCUPAR TRIG ROAD along centre of hill.

16.6 Grid Turn right at blazed trees along overgrown track.

16.7 Grid POCUPAR ▲

Record of Station

Date

8-7-80 Permission to clear & place pillar from Mr. COONEY at URBENVILLE Forestry office.

GEODETIC SURVEY OF N.S.W.

CENTRAL MAPPING AUTHORITY

GEODETIC STATION RECONNAISSANCE and MAINTENANCE REPORT

STATION: **POCUPARA (P)** No: **6647**

MAP SHEET SCALE 1:250 000 **WAWLIK**

INSPECTED BY: **C. PAILKES** DATE: **18/11/80**

AUTHORITY: **C.M.A** FIELD BOOK: **1809**

Description: **233° TO 52°** Note: *Cross out word or words which do not apply*  
 1. Cleared by lanes bearing **100° TO 18°** from Trig, Mast

2. Mast & Vanes have been painted white & black respectively.

3. The section/pillar was emptied/net emptied/constructed on **07 AUGUST 1980**, dimensions now being:

Description of mark: **S/STEEL PLATE** should be explicit, e.g., S/Steel Pillar Plate, Steel plug, Brass plug, Bolt, G.I. Pipe

Height of mark: **1.365** m. above rock/concrete; Mark is **1.505** m. above G.L.

Height of Top Vanes to Top Mark/Pillar plate **1.450** m. Diameter of Vanes (vertical) **0.755** m.

Height of Cairn **0.00** m. Diameter of Cairn **0.00** m. Name Plate **found/not found/**placed.

Length of Mast **0.00** m. (approximate if not unpled)

4. A **COPPER MAIL** set in conc/rock has been placed/**found**, bearing **160°** M from Mast/Plug/Pillar

5. A **S/STEEL PIN** set in conc/rock has been placed/**found**, bearing **145°** M from Mast/Plug/Pillar

6. A **S.S.M.** set in conc/rock has been placed/**found**, bearing **88°** M from Mast/Plug/Pillar

7. A **S.S.M.** set in conc/rock has been placed/**found**, bearing **00°** M from Mast/Plug/Pillar

8. Action required: **None**

STANDPOINT: PILLAR PLATE			STANDPOINT: S/STEEL PIN		
Mark	Direction	Horiz. Distance	Height Difference	Direction	Horiz. Distance
SOUTH OBEISK	0 00 00		above standpt.	0 00 00	
S.S.M	99 36 20	2.965	1.263 below standpt.	SOUTH OBEISK	0 00 00
WILLIAM (P)	114 00 45		above standpt.	S.S.M	51 01 00
S/STEEL PIN	156 20 40	2.303	1.960 below standpt.	WILLIAM (P)	114 00 20
COPPER MAIL	174 30 05	2.871	1.278 below standpt.	COPPER MAIL	177 37 20
			above standpt.	PILLAR PLATE	336 23 00
			below standpt.		2.305
			above standpt.		
			below standpt.		

Prepared by: **C. PAILKES** Checked: **[Signature]** Based on U.T.M. Card

SI 2733-1

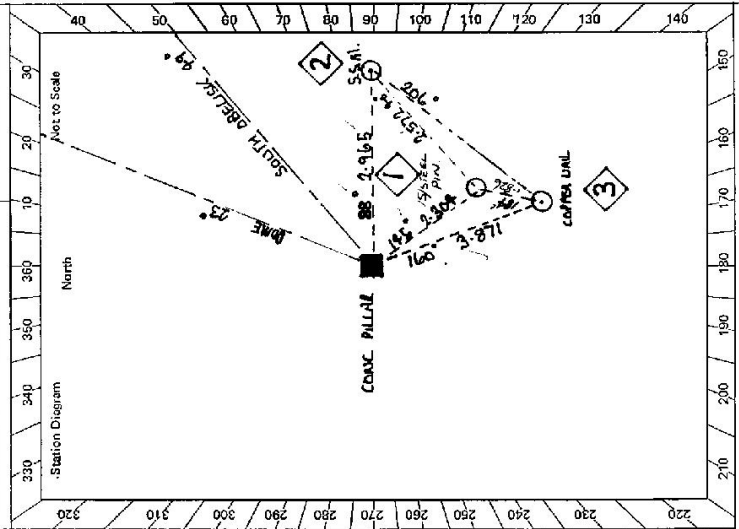

CENTRAL MAPPING AUTHORITY

GEODETIC STATION RECONNAISSANCE and MAINTENANCE REPORT

STATION: **POCUPAR** No.: **6647**

MAP SHEET SCALE: **1:250 000** **WARAWICK**

INSPECTED BY: **P. JACKSON** DATE: **17-3-01**

AUTHORITY: **CHA - NSW 3102** FIELD BOOK: **C-069**

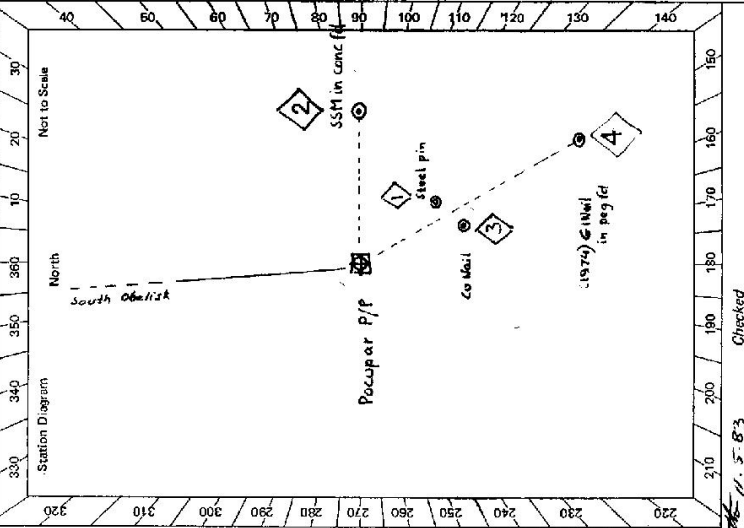

- Description:**
- Cleared by lanes bearing.....  
*Note: Cross out word or words which do not apply*
  - Mast & Vanes have been painted white & black respectively.
  - The station/pillar was unpiled/not unpiled/constructed on.....19....., dimensions now being:  
Description of mark.....should be explicit, e.g., S/Steel/Pillar Plate, Steel plug, Brass plug, Bolt, G.I. Pipe
  - Height of mark.....m. <sup>above</sup>/<sub>below</sub> rock/concrete; Mark is.....m. <sup>above</sup>/<sub>below</sub> G.L.
  - Height of Top Vanes to Top Mark/Pillar plate.....m. Diameter of Vanes (vertical).....m.
  - Height of Cairn.....m. Diameter of Cairn.....m. Name Plate found/not found/placed.
  - Length of Mast.....m. <sup>approximate if not unpiled</sup>
  - A.....~~set in conc/rock has been placed/found, bearing.....°M from Mast/Plug/Pillar~~
  - A.....~~set in conc/rock has been placed/found, bearing.....°M from Mast/Plug/Pillar~~
  - A.....~~set in conc/rock has been placed/found, bearing.....°M from Mast/Plug/Pillar~~
  - A.....~~set in conc/rock has been placed/found, bearing.....°M from Mast/Plug/Pillar~~
  - Action required.....  
*Fixe connections only.*

STANDPOINT:		Pillar			STANDPOINT: (1974) G/Mail in peg 4		
Mark	Direction	Horiz. Distance	Height Difference	Mark	Direction	Horiz. Distance	Height Difference
South Obelisk	0 00 00			South Obelisk	0 00 00		above standpt.
SSM in conc	99 35 10	2.764	1.357	Dyrroaba	116 30 05		above standpt.
Dyrroaba	116 39 45			Pillar Plate	324 13 32	8.909	below standpt.
G Mail in peg 4	154 11 50	8.709	1.103				above standpt.
							below standpt.
							above standpt.
							below standpt.
							above standpt.
							below standpt.

Prepared by: **C. Zahra** Checked: **D. Zahra** Noted on U.T.M. Card **11.5.83** Checked

GS

STATION <b>POCUPAK (P). TS 664-7</b>	Owner's Name: <b>FORESTRY COMMISSION</b> Address: <b>UNBENHULE SUB-DISTRICT</b> <b>PALESTER, M. PAT. COONEY</b> Phone: <b>066 - 341318</b> Current Occupant: Address: Phone: ACCESS Access Report of <b>28/11/1980</b> was found suitable/unsuitable. <b>K.M. DIRECTION</b> 0-0 AT LOCALITY KNOWN AS JOES BOX WHICH IS 9-5 KM SOUTH OF BOMALUBO AND IS 2-1 KM SOUTH OF OLD BOMALUBO. TAKE ROAD WEST SIGN YABARA RJ HAYSTACK RJ. 0-1 TAKE HAYSTACK RJ TO LEFT. 1-75 GRID. 2-20 TAKE LEFT FORK. 3-30 GRID. 6-50 GRID. 7-00 TAKE LEFT FORK. 7-30 TAKE RIGHT FORK OVER GRID. (SOUTH HAYSTACK RJ). 7-70 GRID. 8-40 GRID. 10-10 TAKE RIGHT FORK POCUPAK RJ. 12-90 TAKE RIGHT FORK <del>POCUPAK</del> (YABARA LINK RD GOES TO LEFT). 15-45 TURN LEFT POCUPAK TRIG RD (CORRUPTED RJ GOES TO RIGHT). 16-6 TURN RIGHT OFF TRACK AT BLAZED TREES. 16-7 POCUPAK C.S. OP.
Beacon Diagram Not to Scale 	This section to be completed by officer constructing pillar. Original station mark found/ <del>not found</del> : Description of mark: <b>STEEL TIG. PIN</b> Original beacon found/ <del>not found</del> : Description of beacon: <b>MAST LAMPS &amp; WIRE SUPPORTS</b> Height Top of Vanes to Top Mark: <b>3.980</b> m. Height of mark: <b>0.035</b> m. above <del>mark</del> G.L. below Diameter of Vanes: <b>1.010</b> m. Height of Catin ..... m. Original Beacon has/ <del>has not</del> been destroyed by me.
	Date Record of Station