

CENTRAL MAPPING AUTHORITY

GEODETIC SURVEY OF N.S.W.

GEODETIC STATION RECONNAISSANCE and MAINTENANCE REPORT

STATION: **BULLDOG G.S.** No.: **6641**
 MAP SHEET SCALE 1:250 000 **GRAFTON**
 INSPECTED BY: **M.L. MORRISON** DATE: **9/1/80**
 AUTHORITY: **C.M.A.** FIELD BOOK: **1799**

Station Diagram
 North
 Not to Scale

TRIG ED IN GOOD ORDER
 MAST NEEDS REPAIRING VANES OK
 ASY 2 DAYS TO CLEAR 360
 VERY EASY TO LAKE. MAST CLEARING
 IS IN A/D-DIRECTWN BUT TIMBER IS
 SMALL.

A 1 PLACE IN CONC WAS FOUND BUT
 THIS IS NOT STABLE AS IT IS ONLY
 SITTING ON ROCK & CAN BE MOVED,
 NO OTHER MARKS ED.

+

VEASY TO PLACE ROOFTOP
 PILLAR IF NOT A CONC ONE.

U.S. AREA CLOSE TO TRIG HAS
 RECENTLY BEEN LOGGED AND
 MORE LOGGING MAY BE CARRIED
 OUT.

- Description:
1. Cleared by lanes bearing.....
 Note: Cross out word or words which do not apply
 from Trig. Mast
2. Mast & Vanes have been painted white & black respectively.
3. The station/pillar was unpiled/not unpiled/constructed on..... 19..... dimensions now being:
 Description of mark..... should be explicit, e.g., S/Steel Pillar Plate, Steel plug, Brass plug, Bolt, G.I. Pipe
 Height of mark..... m..... above/below rock/concrete; Mark is..... m..... above/below G.L.
- Height of Top Vanes to Top Mark/Pillar plate..... m. Diameter of Vanes (vertical)..... m.
- Height of Cairn..... m. Diameter of Cairn..... m. Name Plate found/not found/placed.
- Length of Mast..... m. (approximate if not unpiled)
4. A..... set in conc/rock has been placed/found, bearing..... ° M from Mast/Plug/Pillar
5. A..... set in conc/rock has been placed/found, bearing..... ° M from Mast/Plug/Pillar
6. A..... set in conc/rock has been placed/found, bearing..... ° M from Mast/Plug/Pillar
7. A..... set in conc/rock has been placed/found, bearing..... ° M from Mast/Plug/Pillar
8. Action required:.....

STANDPOINT:

Mark	Direction	Horiz. Distance	Height Difference	Mark	Direction	Horiz. Distance	Height Difference
			above standpt.				above standpt.
			below standpt.				below standpt.
			above standpt.				above standpt.
			below standpt.				below standpt.
			above standpt.				above standpt.
			below standpt.				below standpt.
			above standpt.				above standpt.
			below standpt.				below standpt.
			above standpt.				above standpt.
			below standpt.				below standpt.

Prepared by: *[Signature]* 30/1/80
 Checked: *[Signature]*
 Noted on U.T.M. Card

GEODETIC SURVEY OF N.S.W.

CENTRAL MAPPING AUTHORITY

GEODETIC STATION RECONNAISSANCE and MAINTENANCE REPORT

STATION: **BULLDOG G.S. (P)** No.: **6641**

MAP SHEET SCALE 1:250 000 **GRAFTON**

INSPECTED BY: **G. L. FORD** DATE: **3-11-80**

AUTHORITY: **C. M. A** FIELD BOOK: **1682**

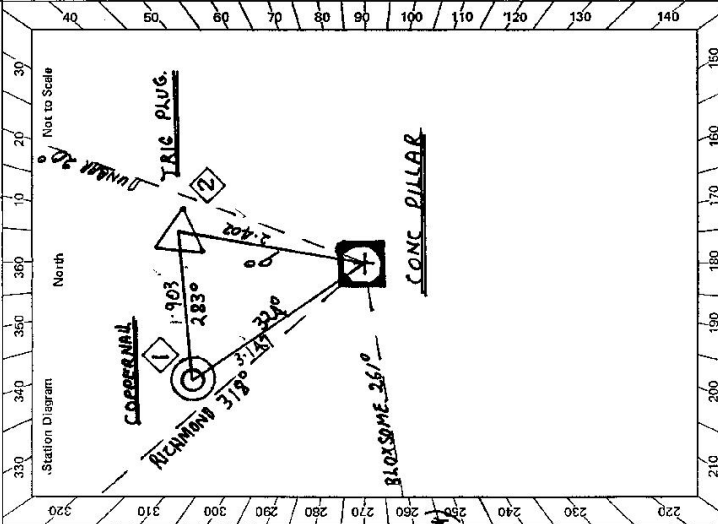

- Description: *Note: Cross out word or words which do not apply*
- Cleared by lanes bearing **360° Chas. Ridge 80° - 170°** from Trig. Mast
 - Mast & Vanes have been painted white & black respectively. ✓
 - The station/pillar was unpiled/not unpiled/constructed on **19.8** m. **19.80** m., dimensions now being: **SS PILLAR PLATE** should be explicit, e.g., S/Steel Pillar Plate, **Steel Plug, Press Plug, Bolt, C-Plate**
 - Height of mark **1.380** m. ^{above} **1.630** m. _{below} G.L. Diameter of Vanes (vertical) **0.750** m.
 - Height of Top Vanes to Top Mark/Pillar plate **1.450** m. Name Plate **found/not found/** placed.
 - Length of Mast **.....** m. (approximate if not unpiled)
 - A. AUSTRALIAN SERVICEMAN** set in **conc/rock** has been **placed/** found, bearing **9** ° M from **Mast/Plug/Pillar**
 - A. COPPER NAIL** set in **conc/rock** has been **placed/** found, bearing **324** ° M from **Mast/Plug/Pillar**
 - A.** set in **conc/rock** has been **placed/** found, bearing **.....** ° M from **Mast/Plug/Pillar**
 - A.** set in **conc/rock** has been **placed/** found, bearing **.....** ° M from **Mast/Plug/Pillar**
 - Action required: **.....**

STANDPOINT:	Mark	Direction	Horiz. Distance	Height Difference	Mark	Direction	Horiz. Distance	Height Difference
CONC PILLAR	BLYSOME 65	0 00 00		above standpt.	BLYSOME	0 00 00		above standpt.
	RICHMOND (P) 58 59 10			above standpt.	COPPER NAIL 21 16 00			above standpt.
	COPPER NAIL 70 55 30			above standpt.	RICHMOND (P) 58 59 30			above standpt.
	TRIG PLUG 108 01 50			above standpt.	DUNBAR (P) 123 05 50			above standpt.
	DUNBAR (P) 133 05 00			above standpt.	CONC PILLAR 208 04 10			above standpt.
				below				below

STANDPOINT: **TRIG PLUG (AUSTRALIAN SERVICEMAN)**

Prepared by: **G. L. Ford**

Checked: **.....**

Checked

STATION **BULLDOG G.S. (P) 6641**

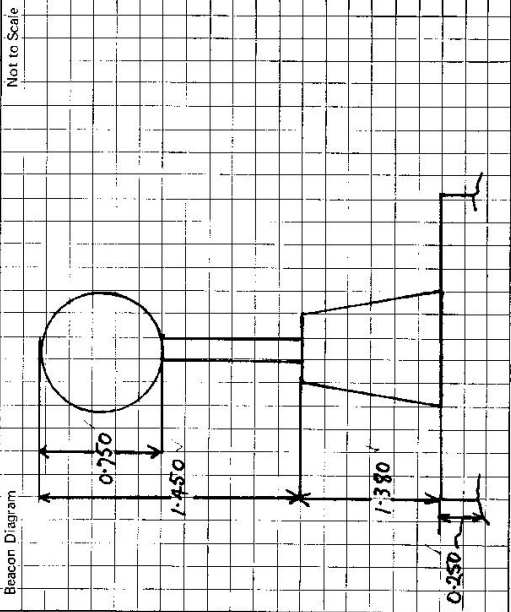

Owner's Name: **M.A. J. C. SMITH**
 Address: **PARENTS ADDRESS MENTON VILLA**
TENTERFIELD
 Phone: **067 361081 OR DRANE 35**

Current Occupant:
 Address:
 Phone:

ACCESS

HM Access Report of 9/1/1980 was found suitable/unsuitable.
 0.00 AT 3.54 WEST OF TABULARM ON BRAUNER H.WY. AT SIGN POST
 "TENTERFIELD 71 CASINO G/ EWINGAR 20 TAKE ROAD SOUTH TO EWINGAR
 2.85 PASS CHAVEL RD ON LEFT
 19.65 TURN RIGHT SIGN "EWINGAR"
 21.80 TURN RIGHT SIGN "BULLDOG ROAD"
 22.05 24.20 25.80 28.30 GRID & GATE
 29.65 PASS "WHITES ROAD" ON RIGHT
 30.75 32.15 34.95 36.60 GRID = GATE
 37.05 GRID & GATE SIGN "BULLDOG"
 38.65 TAKE RIGHT FORK
 40.60 LOCKED GATE (CMA LOCK) AFTER GATE TAKE SECOND FORK TO LEFT
 40.70 TOWARDS LOG DUMP
 40.90 PASS LOG DUMP ON YOUR RIGHT JUST AFTER OLD FENCE
 FOLLOW TRACK WEST UP TO TRIG A.I. 45.

This section to be completed by officer constructing pillar.

Original station mark found/~~not found~~.

Description of mark: **AUSTRALIAN SURVEY CORPS MARK**

Original beacon found/~~not found~~.

Description of beacon: **CAIRN MAST & VANES**

Height Top of Vanes to Top Mark: **3.580** m.

Height of mark: m. above G.L. / m. below

Diameter of Vanes: **0.915** m. Height of Cairn **1.500** m.

Original Beacon has ~~been~~ been destroyed by me.

Date	Record of Station