

TS 6627

CENTRAL MAPPING AUTHORITY

GEODETIC SURVEY OF N.S.W.

STATION: M'LEARN'S RIDGE G.S. No.: 3033

MAP SHEET SCALE 1:250 000 TWEED HEADS

INSPECTED BY: D. FREDRIKSEN DATE: 24/4/80

AUTHORITY: C. M. A. FIELD BOOK: 1873

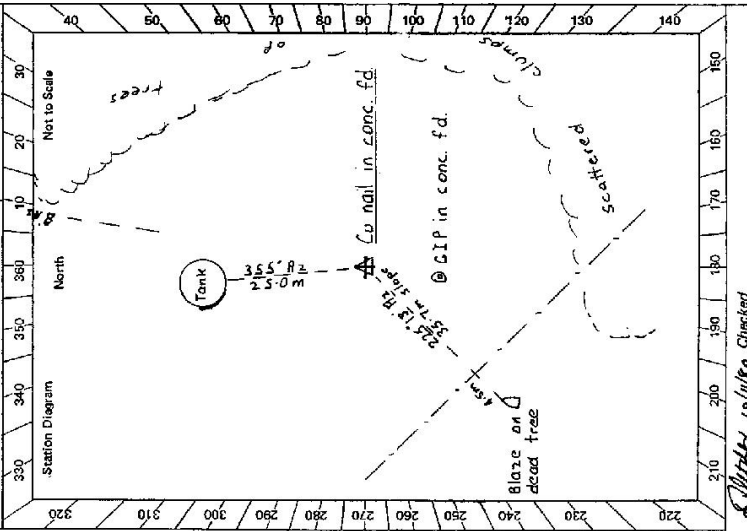

GEODETIC STATION RECONNAISSANCE and MAINTENANCE REPORT

Description: *Note: Cross out word or words which do not apply*
 1. Cleared by lanes bearing *Need. lanes. to. G. 100' high. by. 100' high. by. 100' high. by. 100' high.*
 2. Mast & Vanes have been painted white & black respectively.
 3. The station/pillar was unpiled/not unpiled/constructed on..... 19....., dimensions now being:
 Description of mark *Cu. Nail. in. conc. fd.* should be explicit, e.g., S/Steel Pillar Plate, Steel plug, Brass plug, Bolt, G.I. Pipe
 Height of mark.....m. ^{above} rock/concrete; Mark is.....m. ^{above} G.L.
 Height of Top Vanes to Top Mark/Pillar plate.....m. Diameter of Vanes (vertical).....m.
 Height of Cairn.....m. Diameter of Cairn.....m. Name Plate found/not found/placed.
 Length of Mast.....m. (approximate if not unpiled)
 4. A. G.I.P.....set in conc/rock has been placed/found, bearing *21.2.° M from Mast/Plug/Pillar 4.1 m*
 5. A. *Blaze. in. dead. tree.* set in conc/rock has been placed/found, bearing *21.5.° M from Mast/Plug/Pillar 35.7 m slope*
 6. A.....set in conc/rock has been placed/found, bearing.....° M from Mast/Plug/Pillar
 7. A.....set in conc/rock has been placed/found, bearing.....° M from Mast/Plug/Pillar
 8. Action required: *Pillar. construction. clearing.*

Mark Required	Direction Sighted	Horiz. Distance	Height Difference	Direction	Mark	STANDPOINT:	Horiz. Distance	Height Difference
DUNOON	334.50 Pz	Quad Vanes	above standpt.					above standpt.
GODMENGERRY	10.50 "	Mast & Vanes	below standpt.					below standpt.
BROOKLET	55.36 "	G.S.P.	below standpt.					below standpt.
PEARCES CREEK	70.03 "	conc tank	above standpt.					above standpt.
TEVEN	96.32 "	Not on	below standpt.					below standpt.
TREGERGLE	216.43 "	House & Tank	below standpt.					below standpt.

Prepared by: D. Fredrikson 12/5/80 Checked: *D. Fredrikson* Noted on U.T.M. Card

61 2728 -2 D- West Government Printer

Species/Class	OTHER	TRIGS	LOOKED FOR	Notes/Status
NUMULGI	328 18 82		Bald hill	
BLUE KNOB	331 10		Large hill	
CLUNES	17 05		Timber on this hill	
PARROTS NEST	252 42		NOT ON ridge 5km	
LISMORE	273 58		Red & white beacon; timbered ridge	
WARRNING	345 19		Peak	
MATHESON	343 11		Timbered hill	
FERNSIDE	280 41		NOT ON timber on ridge 2.3km	
BENTLEY	281 14		Timbered hill	
CHELMSEFORD	291 28		South end timbered ridge	
TOWER	303 08		Scattered timber on ridge	
BILLET	309 02		Small timbered hill	
STONE WHITE	313 40		Doubtful distant timbered ridge	
PEACH MTN	357 31		Timbered hill	
	258 30		Most of vines on creek water tower	

OWNERS cont'd.

Mrs. C. EDWARDS,
23 Cabbage Tree Lane,
Fairymeadow,
N.S.W.

Mrs. W. ALLSOPP,
23 Andrew St.,
Mt. Waverly,
VIC

STATION M'LEANS RIDGE TS 6627

Owner's Name: Alec M'LEARN
Address: 100 CONWAY ST
LISMORE
Phone: 4 his sisters

Current Occupant: M.B. MANSON
Address: 190 ANGLICAN ST
Works at: Walloongbar Experimental
Phone: FARM

ACCESS

old Access Report of 24.4.1988 was found suitable/unsuitable.

FEATURE

KMS
0-00 On BALLINA - LISMORE Rd 11 km east of LISMORE and just west of Walloongbar take bitumen road north. Turn RIGHT off road thro wooden gate just before dip
1-79 Turn RIGHT at tenants house.
1-90 Thro wire gate at RIGHT of cowshed
2-01 Thro wire gate at 'T' fence intersection
2-14 At fence corner keep fence on R.H.S. and fig trees on L.H.S
2-31 Thro N-S fence at intersection up hill to tank
2-47 At trig.

Date

Record of Station

Permissions: Clearing North side of fence & construction of pillar granted by M'LEARN on behalf of himself and 2 sisters.
Access - contact tenant

CENTRAL MAPPING AUTHORITY

GEODETIC SURVEY OF N.S.W.
 GEODETIC STATION RECONNAISSANCE and MAINTENANCE REPORT

STATION: *McLEANS RIDGE (C&P)* No: *6627*

MAP SHEET
 SCALE 1:250 000 *THREED HEADS*

INSPECTED BY: *P.BOTS.* DATE: *8.11.80*

AUTHORITY: *C.M.A.* FIELD BOOK: *1924*

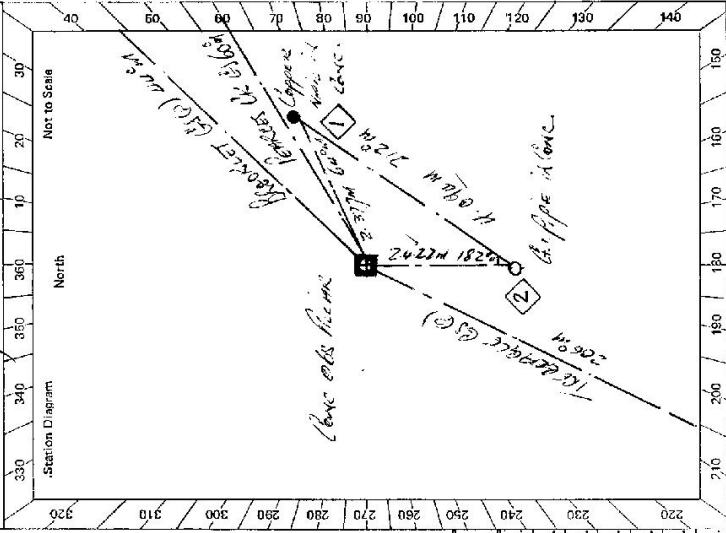

Description:

Note: Cross out word or words which do not apply

- Cleared by lanes bearing *255° 04' 6.2"* to *392° 46' 88.2"* - *10° 44' 12.2"* from Trig. Mast
70° 4' to 210° 4'
- Mast & Vanes have been painted white & black respectively.
- The ~~station~~/pillar was ~~reconstructed~~/constructed on *5th November 1980*, dimensions now being:
 Description of mark: *St. Steel Pillar Plate, Steel plug, Brass plug, Bolt, G.I. Pipe*
- Height of mark: *1.375* m. above ~~mean~~/concrete; Mark is *152.5* m. above G.L.
- Height of Top Vanes to Top ~~mark~~/Pillar plate *1.440* m. Diameter of Vanes (vertical) *0.750* m.
- Height of Cairn *0.000* m. Diameter of Cairn *0.000* m. Name Plate ~~found~~/reconstructed/placed.
- Length of Mast *0.000* m. (approximate if not unipiled)
- A. *Copper Mark* set in conc/~~rock~~ has been ~~placed~~/found, bearing *64*° M from ~~mark~~/flag/Pillar
- A. *G.I. Pipe* set in conc/~~rock~~ has been ~~placed~~/found, bearing *182*° M from ~~mark~~/flag/Pillar
- A. set in conc/~~rock~~ has been placed/found, bearing *000*° M from Mast/Plug/Pillar
- A. set in conc/~~rock~~ has been placed/found, bearing *000*° M from Mast/Plug/Pillar

Action required:

8. Action required: *None*

Mark	Direction	Horiz. Distance	Height Difference	Mark	Direction	Horiz. Distance	Height Difference	STANDPOINT: <i>Copper Mark</i>	
								above	below
<i>TRIGEROLE (SIC)</i>	<i>0 00 00</i>		<i>above</i> <i>standpt.</i>	<i>TRIGEROLE (SIC)</i>	<i>0 00 00</i>		<i>above</i> <i>standpt.</i>		
<i>PROSPECT (SIC)</i>	<i>178 54 30</i>		<i>above</i> <i>standpt.</i>	<i>G.I. PIPE</i>	<i>5 44 00</i>		<i>above</i> <i>standpt.</i>		
<i>CONC OBS.</i>	<i>23 19 20</i>		<i>above</i> <i>standpt.</i>	<i>CONC OBS FOUND</i>	<i>26 59 00</i>		<i>above</i> <i>standpt.</i>		
<i>COPPER MARK</i>	<i>27 00 20</i>	<i>2377</i>	<i>above</i> <i>standpt.</i>	<i>RECONSTRUCTED (SIC)</i>	<i>01 53 00</i>		<i>above</i> <i>standpt.</i>		
<i>G.I. PIPE</i>	<i>230 07 10</i>	<i>2422</i>	<i>above</i> <i>standpt.</i>	<i>RECONSTRUCTED (SIC)</i>	<i>213 17 10</i>		<i>above</i> <i>standpt.</i>		
			<i>below</i> <i>standpt.</i>				<i>below</i> <i>standpt.</i>		
			<i>below</i> <i>standpt.</i>				<i>below</i> <i>standpt.</i>		

Prepared by: *P.BOTS. 8.11.80* Checked: *[Signature]* Noted on U.T.M. Card

STATION *McLEANS RIDGE (A) IS 6627*

Owner's Name: *MR ALEC McLEAN*
 Address: *100 BANKERS STREET*
 Phone: *1535006 MSN*
 Current Occupant: *MR AND MRS McLEAN*
 Address: *270 OLIVE STREET*
 Phone: *535512345*

ACCESS
 Access Report of *S.I. 111980* was found suitable/unsuitable.
MS L. EDWARDS
23 CONURGE TREE LANE & *MS IN ALLSOPP*
FAIRY MERDON MSN *23 RIVERVIEW STREET*
MT NAVERLY VIC.
 000 *FEATHER*
 080 *POST OFFICE - McLEANS RIDGE*
 090 *TURN RIGHT SIGN McLEANS RIDGE*
 265 *TURN RIGHT AT WOODEN GATE*
 270 *TURN RIGHT LAINT TRACK*
 280 *WIRE GATE - TENANT'S HOUSE DOWN TO THE LEFT & DRIVEWAY ON LEFT*
 285 *WIRE GATE - AT FENCE "T" INTERSECTION*
 295 *TURN RIGHT CAMP IN FENCE - THEN FOLLOW FENCE UP*
 300 *RIGHT KEEP FENCE ON RIGHT - THEN GATE THEN LEFT*
 310 *TURN RIGHT THROUGH WIRE GATE THEN LEFT*
 330 *LEFT FOLLOW FENCE TRACK TO TRAIL McLEANS RIDGE (A) STATION*

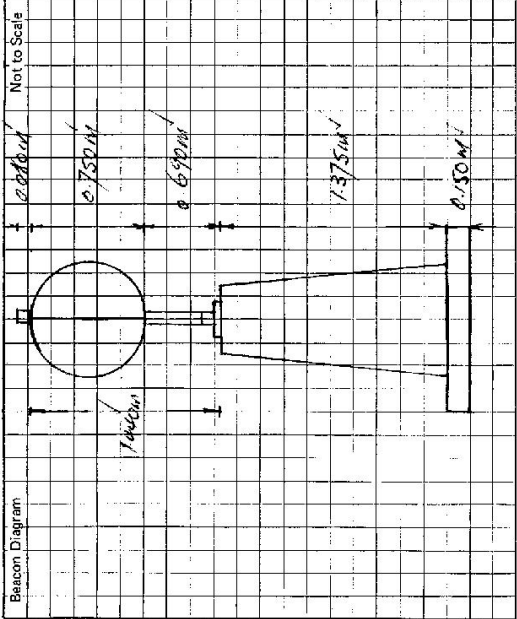

This section to be completed by officer constructing pillar.
 Original station mark found/not found.
 Description of mark: *Not Found*
 Original beacon found/not found.
 Description of beacon: *Nil*
 Height Top of Vanes to Top Mark:m.
 Height of mark:m. above G.L. /m. below
 Diameter of Vanes: *Nil*m. Height of Cairn: *Nil*m.
 Original Beacon has/has not been destroyed by me.

Date	Record of Station