

CENTRAL MAPPING AUTHORITY

GEODETTIC SURVEY OF N.S.W.

GEODETTIC STATION RECONNAISSANCE AND MAINTENANCE REPORT

Description:

1. Cleared by lanes bearing 1.3.6.5 2.1.1.1 1.5.3 4.8.2 from Trig. Mast  
 Note: Cross out word or words which do not apply
2. Mast & Vanes have been painted white & black respectively.
3. The station/pillar was unplaced/not unplaced/constructed on 3.7 7 19.8, dimensions now being:  
 Description of mark: Pillar Plate, should be explicit, e.g., S/Steel Pillar Plate, Steel plug, Brass plug, Bolt, G.I. Pipe  
 Height of mark: 1.3.6.5 m, above below feet/concrete; Mark is 1.5.1.5 m, above below  
 Height of Top Vanes to Top Mark/Pillar plate 1.4.4.5 m. Diameter of Vanes (vertical) 0.755 m.  
 Height of Cairn: .....m. Diameter of Cairn: .....m. Name Plate found/not found/placed.  
 Length of Mast: .....m. (approximate if not unplaced)
4. A. S/S Pin set in conc/rock has been placed/found, bearing 197 °M from Meat/Plug/Pillar
5. A. Coil Nail set in conc/rock has been placed/found, bearing 121 °M from Meat/Plug/Pillar
6. A. G.I. Pipe set in conc/rock has been placed/found, bearing 180 °M from Meat/Plug/Pillar
7. A. .... set in conc/rock has been placed/found, bearing ..... °M from Mast/Plug/Pillar
8. Action required: .....

STANDPOINT: <u>PILLAR PLATE</u>		STANDPOINT: <u>S/S PIN</u>					
Mark	Direction	Horiz. Distance	Height Difference	Mark	Direction	Horiz. Distance	Height Difference
<u>WELLS PILLAR</u>	<u>359 59 60</u>		above standpt.	<u>WELLS PILLAR</u>	<u>359 59 60</u>		above standpt.
<u>COIL NAIL</u>	<u>229 02 30</u>	<u>2.556</u>	above standpt.	<u>SINGLE TREE PILLAR</u>	<u>118 49 05</u>	<u>2.603</u>	above standpt.
<u>G.I. PIPE</u>	<u>281 09 45</u>	<u>5.723</u>	above standpt.	<u>COIL NAIL</u>	<u>170 46 05</u>	<u>3.132</u>	above standpt.
<u>S/S PIN</u>	<u>248 49 45</u>	<u>2.604</u>	below standpt.	<u>G.I. PIPE</u>	<u>267 29 55</u>	<u>3.337</u>	below standpt.
			below standpt.				below standpt.
			above standpt.				above standpt.
			below standpt.				below standpt.
			above standpt.				above standpt.
			below standpt.				below standpt.

Prepared by:

Checked:

Noted on U.T.M. Card

SI: 2738-1

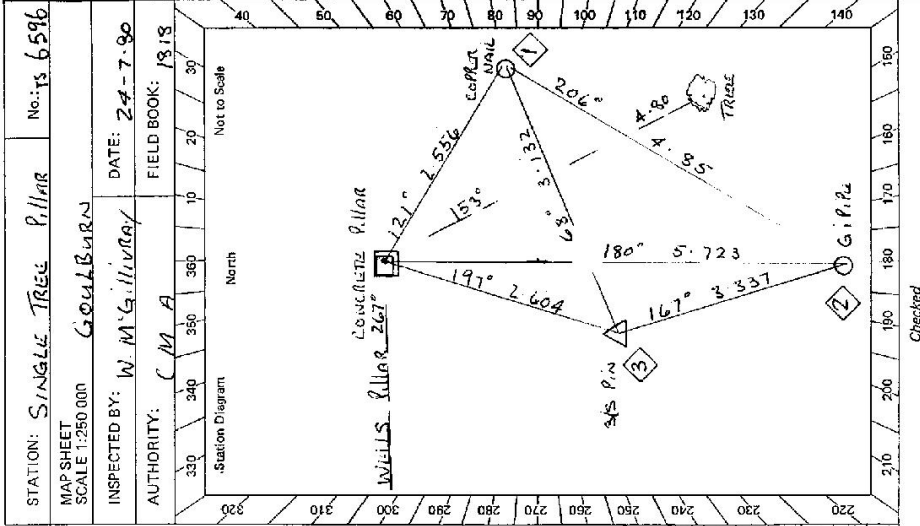

Checked

STATION: SINGLE TREE PILLAR No.: TS 6596

MAPSHEET SCALE 1:250 000 GOULDBURN

INSPECTED BY: W.M.G. ILLVOY DATE: 24-7-90

AUTHORITY: CM A FIELD BOOK: 1818

G1

<p>Owner's Name: <b>CROWN LAND (TR 1999)</b>                  Access Through: <b>DR. C.D. BAHAM</b>                  Address: <b>"HOPEFULL"</b>                  Phone: <b>Perth 8346025</b></p>	<p>STATION <b>SINGLE TRAIL PILLARS 6596</b>                  Owner of Land adjoining Pt.                  Current Occupier: <b>HARRY HEARN</b>                  Address: <b>BATHURST ROAD</b>                  Phone: <b>BATHURST</b></p>	<p>Access Report of 24.1.1988 was found suitable/unsuitable.</p> <p><b>ACCESS</b></p> <p>FROM <b>CRONKWELL TAKLE ROAD TO LAGAN.</b></p> <p><b>0.0</b> LAGAN POST OFFICE, TAKE BATHURST ROAD.</p> <p><b>*33.2</b> TURN SHARP RIGHT, MAIL BOX ON LEFT SIGN. "HOPEFULL C.D. BAHAM."</p> <p><b>33.7</b> WIRE GATE.</p> <p><b>34.2</b> WIRE GATE.</p> <p><b>34.5</b> G.S.</p>
<p>Beacon Diagram</p> <p style="text-align: right;">Not to Scale</p>		<p>This section to be completed by officer constructing pillar.</p> <p>Original station mark found/<del>not found</del>.</p> <p>Description of mark: <b>S/S P.N. IN CONCRETE</b></p> <p>Original beacon found/<del>not found</del></p> <p>Description of beacon: <b>P.V.C. MAST STEEL TRIPOD</b></p> <p>Height Top of Vanes to Top Mark <b>NA. NAMES. 1.0m.</b></p> <p>Height of mark <b>0.040</b> above <del>mark/conc.</del> <b>0.040</b> above G.L. below</p> <p>Diameter of Vanes <b>Not</b> <del>1.0</del> <b>1.0</b> m. Height of Cairn <b>Not</b> <del>1.0</del> <b>1.0</b> m.</p> <p>Original Beacon has/<del>has not</del> been destroyed by me.</p>
<p>Owner's Name: <b>CROWN LAND (TR 1999)</b>                  Access Through: <b>DR. C.D. BAHAM</b>                  Address: <b>"HOPEFULL"</b>                  Phone: <b>Perth 8346025</b></p>		<p>STATION <b>SINGLE TRAIL PILLARS 6596</b>                  Owner of Land adjoining Pt.                  Current Occupier: <b>HARRY HEARN</b>                  Address: <b>BATHURST ROAD</b>                  Phone: <b>BATHURST</b></p>
<p>Access Report of 24.1.1988 was found suitable/unsuitable.</p> <p><b>ACCESS</b></p> <p>FROM <b>CRONKWELL TAKLE ROAD TO LAGAN.</b></p> <p><b>0.0</b> LAGAN POST OFFICE, TAKE BATHURST ROAD.</p> <p><b>*33.2</b> TURN SHARP RIGHT, MAIL BOX ON LEFT SIGN. "HOPEFULL C.D. BAHAM."</p> <p><b>33.7</b> WIRE GATE.</p> <p><b>34.2</b> WIRE GATE.</p> <p><b>34.5</b> G.S.</p>		<p>* DO NOT GO THROUGH HARRY HEARN PLACE HOUSE ON RIGHT PAST GATE AT 33.2 *</p> <p>* Additions to access from this point as at Feb 84 From this gate at 0.0 Leave track turning head left and following old faint track more or less along old netting fence passing through face wire at 0.34 west right 0.84 find up ridge to meet another track at 0.83 Turn left here and follow up ridge to Queensland Gate in netting fence Record of Station at 1.07m reaching GS at 1.49 kms</p>