

TS-6594
No.: 1786

STATION: DARLING GS
MAP SHEET SCALE 1:250 000
INSPECTED BY: W.M. GILLIBAY
AUTHORITY: CMA

DATE: 12-7-90
FIELD BOOK: 1818

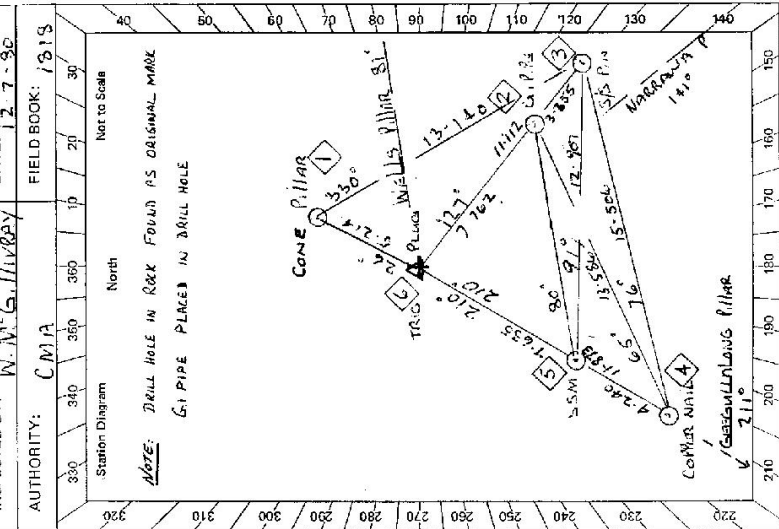

CENTRAL MAPPING AUTHORITY
GEODETTIC SURVEY OF N.S.W.
GEODETTIC STATION RECONNAISSANCE and MAINTENANCE REPORT

Description:
Note: Cross out word or words which do not apply
Cleared by lines bearing..... from Trig. Mast

1. Mast & Vanes have been painted white & black respectively.
2. The station/pillar was unpiled/~~not unpiled~~/~~constructed~~ on.....
Description of mark..... should be explicit, e.g., S/Steel Pillar Plate, Steel plug, Brass plug, Bolt, G.I. Pipe
3. Height of mark.....
Height of Top Vanes to Top Mark/Pillar plate.....
Height of Cairn.....
Length of Mast.....
4. A..... set in conc/feek has been placed/~~found~~, bearing..... from Mast/Plug/Pillar
5. A..... set in conc/feek has been placed/~~found~~, bearing..... from Mast/Plug/Pillar
6. A..... set in conc/feek has been placed/~~found~~, bearing..... from Mast/Plug/Pillar
7. A..... set in conc/feek has been placed/~~found~~, bearing..... from Mast/Plug/Pillar
8. Action required:.....

STANDPOINT: TRIG PILE		STANDPOINT: COPPER NAIR	
Mark	Direction	Mark	Direction
WELLS PILLAR	359 59 60	WELLS PILLAR	359 59 60
S/S PIN	44 03 30	GASWILLIANG P.	127 31 05
G.I. PIPE	44 03 05	TRIG PILE	308 50 35
GASWILLIANG	127 29 50	S/S PILE	308 45 20
COPPER NAIR	128 43 55	G.I. PIPE	359 31 40
S/S PILE	128 50 00	S/S PIN	359 23 00
CORNER MARK	303 12 00		

Horiz. Distance	Height Difference	Horiz. Distance	Height Difference
11.112	1.843	11.872	0.915
7.762	0.992	4.240	0.267
11.574	0.971	13.586	0.115
7.655	0.673	15.506	0.971
5.214	0.915		

Prepared by:
Checked:
Notes on U.T.M. Grid

GS 24

<p>STATION DARLING GS TS-6594</p> <p>Owner's Name: PETER GERHARD Address: Phone:</p> <p>Current Occupant: Address: Phone:</p> <p>ACCESS Access Report of 12.7.1980 was found suitable/unsuitable.</p>	<table border="1" style="width: 100%; border-collapse: collapse;"> <tr> <td style="width: 10%; text-align: center;">Not to Scale</td> <td style="width: 90%; height: 150px;"> </td> </tr> </table> <p>This section to be completed by officer constructing pillar.</p> <p>Original station mark found/not found.</p> <p>Description of mark: DRILL HOLE IN ROCK (S.P. PLACED)</p> <p>Original beacon found/not found.</p> <p>Description of beacon: ROCK CAIRN</p> <p>Height Top of Varies to Top Mark:m.</p> <p>Height of mark:m. <small>above G.L.</small> <small>rock/cone</small>m. <small>below</small></p> <p>Diameter of Variesm. Height of Cairn 3.00m.</p> <p>Original Beacon has/has not been destroyed by me.</p>	Not to Scale											
Not to Scale													
	<table border="1" style="width: 100%; border-collapse: collapse;"> <tr> <td style="width: 50%;"></td> <td style="width: 50%; text-align: center;">Record of Station</td> </tr> <tr> <td style="text-align: center;">Date</td> <td></td> </tr> <tr> <td> </td> <td> </td> </tr> <tr> <td> </td> <td> </td> </tr> <tr> <td> </td> <td> </td> </tr> <tr> <td> </td> <td> </td> </tr> </table>		Record of Station	Date									
	Record of Station												
Date													

CENTRAL MAPPING AUTHORITY

GEODETIC SURVEY OF N.S.W.

GEODETIC STATION RECONNAISSANCE and MAINTENANCE REPORT

Description:

1. Cleared by lanes bearing..... Note: Cross out word or words which do not apply
 from Trig. Mast

2. Mast & Vanes have been painted white & black respectively.

3. The station/pillar was unpiled/not unpiled/constructed on 12.7.80, dimensions now being:

Description of mark G.I. Pillar should be explicit, e.g. S/Steel Pillar Plate, Steel plug, Brass plug, Bolt, G.I. Pipe

Height of mark 0.52m above rock/concrete; Mark is.....m. above G.L.

Height of Top Vanes to Top Mark/Pillar plate.....m. Diameter of Vanes (vertical).....m.

Height of Cairn.....m. Diameter of Cairn 5.30m. Name Plate found/not found/placed.

Length of Mast.....m. (approximate if not unpiled)

4. A concrete set in conc/teeck-has been placed/found, bearing 210°M from Mast/Plug/Pillar

5. A S.S.M set in conc/teeck-has been placed/found, bearing 210°M from Mast/Plug/Pillar

6. A S/S set in conc/teeck has been placed/found, bearing 127°M from Mast/Plug/Pillar

7. A G.I. Pillar set in conc/teeck has been placed/found, bearing 127°M from Mast/Plug/Pillar

8. Action required:.....

STANDPOINT: S/S P.N

Mark	Direction	Horiz. Distance	Height Difference	Mark	Direction	Horiz. Distance	Height Difference
WELLS PILLAR	359	59.60	above standpt.				above standpt.
BRISBANE P	127	31.55	above standpt.				above standpt.
CEPPAR MAIL	174	23.35	below				below
SSM	137	57.13	above standpt.				above standpt.
TRIG PLUG	224	04.45	above standpt.				above standpt.
G.I. P.P.	224	05.20	above standpt.				above standpt.
CONE PILLAR	247	01.15	below				below

Prepared by:

Checked:

Noted on U.T.M. Card

Sr 2733-1

STATION: DARLING G.S. No.: 1786

MAP SHEET SCALE 1:250 000 G.S. 102/202N

INSPECTED BY: W. McGILLIVRAY DATE: 12.7.80

AUTHORITY: C.M.A. FIELD BOOK: 1315

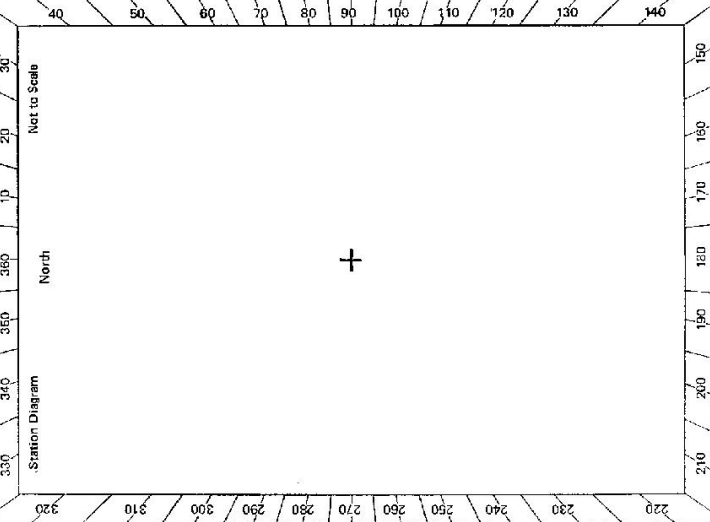

Checked

GS 24

ST 2733-2 D. West, Government Printer Beacon Diagram	STATION DERLING GS IS 6594	Owner's Name: PETER GRIFFIN Address: Phone: Current Occupant: Address: Phone: ACCESS Access Report of 17.7.1980 was found suitable/unsuitable.
Not to Scale 	This section to be completed by officer constructing pillar. Original station mark found/not found. Description of mark: Original beacon found/not found. Description of beacon: Height Top of Vanes to Top Markm. Height of markm. above G.L. rock/concm. below Diameter of Vanesm. Height of Cairnm. Original Beacon has/has not been destroyed by mc.	
Date		Record of Station

GEODETTIC SURVEY OF A.S.I.V.

CENTRAL MAPPING AUTHORITY

GEODETTIC STATION RECONNAISSANCE and MAINTENANCE REPORT

Description:

1. Cleared by James bearing 145° .
 Note: Cross out word or words which do not apply
 from Trig, Mast

2. Mast & Vanes have been painted white & black respectively.

3. The station/pillar was ~~unplaced/not applied~~/constructed on $1.6 \times 7.19 \times 8.0$, dimensions now being:

Description of mark ~~Pillar~~ ~~Plate~~ should be explicit, e.g., S/Steel Pillar Plate, Steel plug, Brass plug, Bolt, G.I. Pipe

Height of mark 1.365 m. ^{above} ~~below~~ ~~feet~~/concrete; Mark is 4.05 m. ^{above} ~~below~~ G.L.

Height of Top Vanes to Top ~~Mast~~/Pillar plate 1.440 m. Diameter of Vanes (vertical) 7.55 m.

Height of Cairn m. Diameter of Cairn m. Name Plate found/not found/placed.

Length of Mast m. (approximate if not unplied)

4. A ~~C.I. Pipe~~ ~~Nail~~ set in conc/feek has been placed/~~found~~, bearing 210° M from ~~Mast/Ring~~/Pillar

5. A ~~S.S.M.~~ set in conc/feek has been placed/~~found~~, bearing 210° M from ~~Mast/Ring~~/Pillar

6. A ~~S/S~~ ~~Pipe~~ set in conc/feek has been placed/~~found~~, bearing 127° M from ~~Mast/Ring~~/Pillar

7. A ~~G.I. Pipe~~ set in conc/feek has been placed/~~found~~, bearing 127° M from ~~Mast/Ring~~/Pillar

8. Action required:

Mark	Pillar Plate		STANDPOINT: COPPER NAIL		Height Difference	Horiz. Distance	Direction	Height Difference
	Direction	Horiz. Distance	Mark	Direction				
WELLS PILLAR	359	69.60	WELLS PILLAR	359	59.60	above	standpt.	
S/S PIN	44	17.25	GUEGALLALONG (P)	127	31.00	above	standpt.	
G.I.P.I.P.E	44	23.05	TRIG PLUG	308	49.45	above	standpt.	
GUEGALLALONG	129	19.40	S.S.M.	1677	308	48.20	above	standpt.
COPPER NAIL	129	37.10	G.I.P.I.P.E	373	32.40	above	standpt.	
S.S.M N°	1677	107.669	S/S PIN	359	22.30	above	standpt.	
CONE PILLAR	308	60.55	DARLING PILLAR	309	20.30	above	standpt.	

Prepared by: *Noted on U.T.M. Grid*

Checked:

SR 2733-1

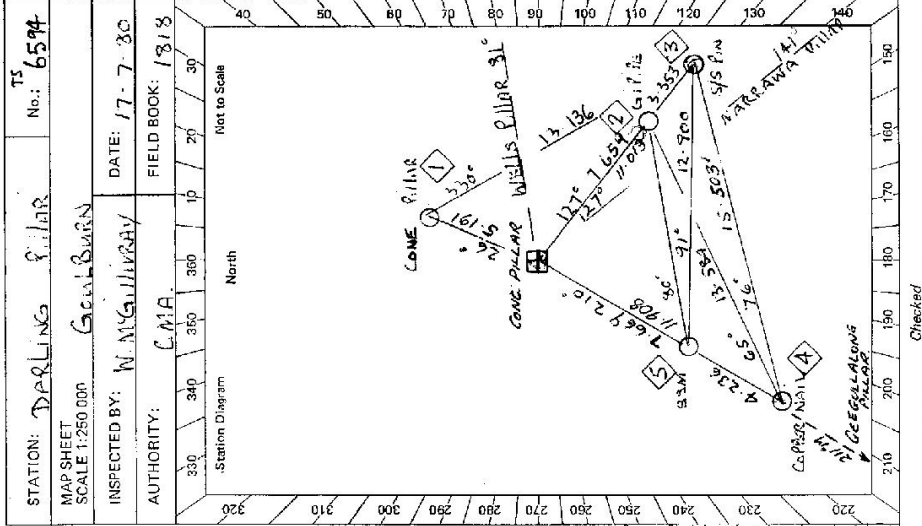

Checked

GS 24

STATION DARLING PILLAR TS 6594

Owner's Name: PETER GOSHAM
 Address: Mount Doree
 Phone: Graham 462443

Current Occupant:
 Address:
 Phone:

ACCESS

Access Report of 17.7.1986 was found suitable/unsuitable.
 POST OFFICE BOOROWA. TAKE CROOKWELL ROAD
 TURN LEFT OFF CROOKWELL RD AT SIGN CORRA 60"
 FROGMOLE.
 PASS ROAD ON LEFT. SIGN CORRA 34"
 TURN RIGHT AT SIGN CORRA 32 BOOROWA 26" CROSS BIDGE
 TURN RIGHT SIGN MT DARLING WHITE GATE.
 TURN LEFT GATE.
 OWNERS HOUSE ON LEFT.
 GATE.
 GATE.
 SHARP RIGHT TURN, SWIDE ON LEFT.
 GATE.
 TURN RIGHT OFF TRACK AT GATE. SIGN BOX RANGE. GATE.
 FOLLOW TRACK.
 SHED ON LEFT
 GATE.
 CREEK CROSSING
 WOOD FENCE ON LEFT. FOLLOW TRACK TO GS AT 61.2
 CORNER POST.

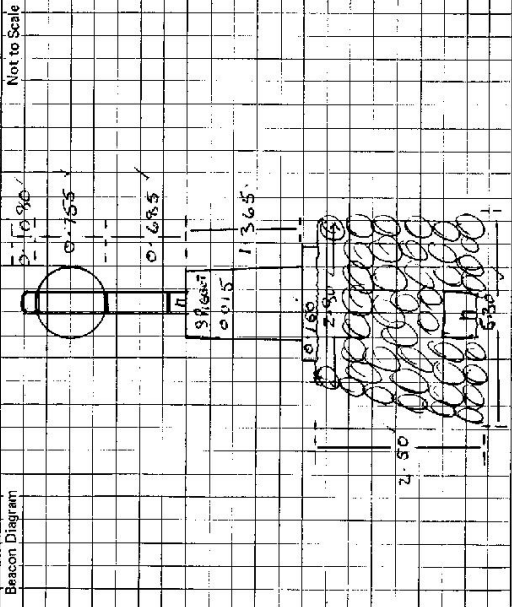

This section to be completed by officer constructing pillar.

Original station mark found/not found.

Description of mark: G.I. PILLAR

Original beacon found/not found.

Description of beacon: ROCK CAIRN

Height Top of Vanes to Top Mark.....m.

Height of mark.....m. above G.L. below

Diameter of Vanes.....m. Height of Cairn.....3.00.....m.

Original Beacon has/has not been destroyed by me.

Date

Record of Station

GEODETTIC SURVEY OF NSW

CENTRAL MAPPING AUTHORITY

GEODETTIC STATION RECONNAISSANCE and MAINTENANCE REPORT

- Description: *Note: Cross out word or words which do not apply*
- Cleared by lanes bearing..... from Trig, Mast
 - Mast & Vanes have been painted white & black respectively.
 - The station/pillar was ~~unpiled/not unpiled~~/constructed on..... 19.80m, dimensions now being: Description of mark. ~~Pillar~~ *Pillar* should be explicit, e.g. S/Steel Pillar Plate, Steel plug, Brass plug, Bolt, G.I. Pipe
Height of mark. ~~1.365~~ *1.365* m. ^{above} ~~reek/concrete~~ *reek/concrete*; Mark is ~~4.05~~ *4.05* m. ^{above} ~~G.L.~~ *G.L.*
Height of Top Vanes to Top Mark/Pillar plate ~~1.440~~ *1.440* m. Diameter of Vanes (vertical).....m.
Height of Cairn.....m. Diameter of Cairn.....m. Name Plate found/not found/placed.
Length of Mast.....m. (approximate if not unpiled)
 - A. ~~Copper Nail~~ *Copper Nail* set in conc/reek has been placed ~~found~~ *found*, bearing. ~~2.10~~ *2.10* °M from Mast/Plug/Pillar
 - A. ~~S.S.M~~ *S.S.M* set in conc/reek has been placed ~~found~~ *found*, bearing. ~~2.10~~ *2.10* °M from Mast/Plug/Pillar
 - A. ~~S.S.Pin~~ *S.S.Pin* set in conc/reek has been placed ~~found~~ *found*, bearing. ~~12.7~~ *12.7* °M from Mast/Plug/Pillar
 - A. ~~G.I. Pipe~~ *G.I. Pipe* set in conc/reek has been placed ~~found~~ *found*, bearing. ~~12.7~~ *12.7* °M from Mast/Plug/Pillar
 - Action required:.....

STANDPOINT:		S/S		Pin		STANDPOINT:	
Mark	Direction	Horiz. Distance	Height Difference	Mark	Direction	Horiz. Distance	Height Difference
Wells Pillar	359 59 60		above standpt.	CONE Pillar	247 01 25	13 13 6	2762 above standpt.
GEOGALLALONG P	127 32 15		above standpt.				above standpt.
COPPER NAIL	174 22 40	15 500 0 925	below				below
S S M	187 57 35	12 900 1 172	below				below
TRIG PLUG	224 05 00	11 000 1 847	below				below
G.I. PIPE	224 06 00	3 353 0 852	below				below
DARLING PILLAR	224 18 10	11 014 5562	below				below

Prepared by: *J. H. C.* Checked: *J. H. C.* *Noted on U.T.M. Card below*

SI 2733-1

STATION: **DARLINGS Pillar** No.: **6594**
 MAP SHEET SCALE 1:250 000 **Geol. BARN**
 INSPECTED BY: **W. W. GALLIBRAY** DATE: **17-7-80**
 AUTHORITY: **CMA** FIELD BOOK: **1818**

Station Diagram
 North
 Not to Scale

CENTRAL MAPPING AUTHORITY

GEODETIC SURVEY OF N.S.W.

GEODETIC STATION RECONNAISSANCE and MAINTENANCE REPORT

Description:

Note: Cross out word or words which do not apply

1. Cleared by lanes bearing..... from Trig, Mast
2. Mast & Vanes have been painted white & black respectively.
3. The station/pillar was unpiled/not unpiled/constructed on.....19....., dimensions now being:
Description of mark.....should be explicit, e.g., S/Steel Pillar Plate, Steel plug, Brass plug, Bolt, G.I. Pipe
Height of mark.....m.....^{above} rock/concrete, Mark is.....m.....^{above} below G.L.
Height of Top Vanes to Top Mark/Pillar plate.....m..... Diameter of Vanes (vertical).....m.
Height of Cairn.....m..... Diameter of Cairn.....m..... Name Plate found/not found/placed.
Length of Mast.....m..... (approximate if not unpiled)
4. A.....set in conc/rock has been placed/found, bearing.....° M from Mast/Plug/Pillar
5. A.....set in conc/rock has been placed/found, bearing.....° M from Mast/Plug/Pillar
6. A.....set in conc/rock has been placed/found, bearing.....° M from Mast/Plug/Pillar
7. A.....set in conc/rock has been placed/found, bearing.....° M from Mast/Plug/Pillar
8. Action required:.....

STANDPOINT:

STANDPOINT:

Mark	Direction	Horiz. Distance	Height Difference	Mark	Direction	Horiz. Distance	Height Difference
			above standpt				above standpt
			below standpt				below standpt
			above standpt				above standpt
			below standpt				below standpt
			above standpt				above standpt
			below standpt				below standpt
			above standpt				above standpt
			below standpt				below standpt
			above standpt				above standpt
			below standpt				below standpt

Prepared by: E. L. REID

Checked:

Noted on U.T.M. Grid

Checked

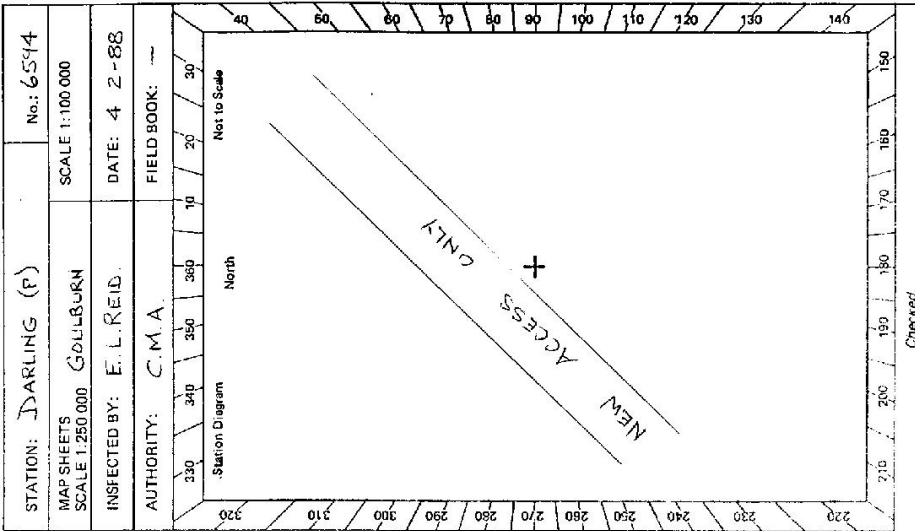

GS 24

2733-2 D. West, Government Printer Beacon Diagram:	Not to Scale 	STATION DARLING (P) 6594	Owner's Name... PETER GORHAM Address... MOUNT DARLING Phone... GRAHAM 45 2443 Current Occupant: Address: Phone: 4-2-1988 ACCESS Access Report of 17/7/1988 was found suitable/unavailable. Post Office BOOROWA - Take road to CROCKWELL . Turn left off CROCKWELL ROAD at sign "COWRA 50" FROGMORE Pass road on left - sign - "COWRA 34" Turn Right at sign "COWRA 50, BOOROWA 42, REID FLAT 16" - Cross bridge towards REID FLAT Turn Left at sign "MOUNT DARLING" - go through white GATE. Turn Left - Gate Gate Owners House on Left Gate Gate Gate Sharp Right Turn - Sheds on Left. - Gate Turn Right off track before Gate with sign "BOX RANGE" and go through Gate into paddock. Follow track, pass dam on Left Shed on Left. 57.3 - Gate Creek crossing (Observe G.S. on hill Straight ahead) Follow faint track towards G.S. Gate (DO NOT ENTER) Turn Right follow fence line on your Left. Gate, enter and follow fence line on your Left, pass two fence corners Gate enter and angle away from fence towards G.S. 58.8 DARLING G.S.
This section to be completed by officer constructing pillar. Original station mark found/not found. Description of mark: Original beacon found/not found. Description of beacon: Height Top of Vane to Top Mark m. Height of mark m. above G.L. below Diameter of Vane m. Height of Cairn m. Original Beacon has/has not been destroyed by me.		Date Record of Station	