

CENTRAL MAPPING AUTHORITY
Department of Lands

Trigonometrical Survey of N.S.W.

RECONNAISSANCE and MAINTENANCE REPORT

This Trig. Station has been:-

Note: Cross out word or words which do not apply

1. Completely cleared to permit 360° vision to surrounding Trig.
2. Cleared by James bearing from Trig-Mast
3. Trig-Mast & Vanes have been painted white & black respectively.
4. The Trig. was unpiled/not unpiled, dimensions now being:

Description of mark..... should be explicit, e.g. Steel plug, Brass plug, Belt, G.I. Pipe

Height of mark..... m ^{above} rock/concrete m ^{below} G.L.

Height of Top Vanes to Top Mark..... m Diameter of Vanes (vertical)..... m.

Height of Cairn..... m. Diameter of Cairn..... m.

Length of Mast..... m. (approximate if not unpiled)

5. A. ~~set in conc/rock has been placed..... m. bearing.....°M from Trig. Mast~~
6. A. ~~set in conc/soil has been placed..... m. bearing.....°M from Trig. Mast~~
7. A. ~~set in conc/soil has been placed..... m. bearing.....°M from Trig. Mast~~
8. A. ~~set in conc/rock has been placed..... m. bearing.....°M from Trig. Mast~~

9. Connection..... to..... m. bearing.....°M

10. Connection..... to..... m. bearing.....°M

11. Connection..... to..... m. bearing.....°M

12. Connection..... to..... m. bearing.....°M

13. Diff. Ht. is..... m. ^{above} below

14. Diff. Ht. is..... m. ^{above} below

15. Diff. Ht. is..... m. ^{above} below

16. Diff. Ht. is..... m. ^{above} below

Prepared By: B J MITCHELL 5 8 75 Checked: J H GILLIES 8 AUG 1975 Noted on U.T.M. Card

STATION MANTON TS 6593

Co: KING PH: MANTON

Map Sheet: No:

Inspected by: J H GILLIES Date: 18.2.75

Authority: D.M.R. Field Book:

Bearing Diagram Net to Scale

TRIG NOT UNPILED, SKETCH AS PREVIOUS

Date Record of Station

Checked

STATION MANTON TS 6593

Station Diagram: Not to Scale

North

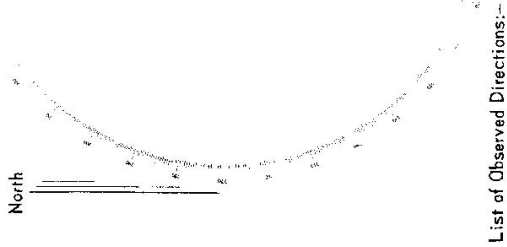

List of Observed Directions:-

Standpoint:		Station		Direction	
Station	Direction	Station	Direction	Station	Direction

Owner's Name:

Address:

18-2-1975
Access

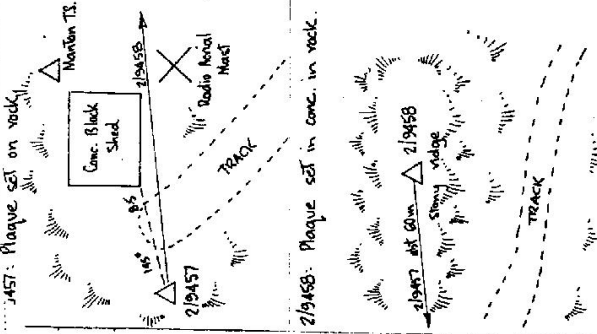

M. KM	M. KM
0.406	0.406
0.813	0.813
1.014	1.014
1.626	1.626

M. KM	M. KM
0.406	0.406
0.813	0.813
1.014	1.014
1.626	1.626

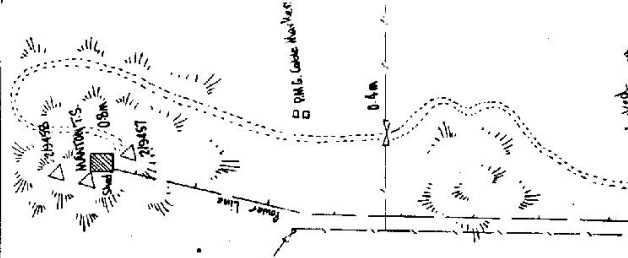

Description of Photo Control Pt.

No photo points

Photo Target required : YES/NO

F1443

Within 100m of R. Manton

SURVEYOR: *[Signature]*

Date: 18/2/75

GEODETTIC SURVEY OF NSM

CENTRAL MAPPING AUTHORITY

GEODETTIC STATION RECONNAISSANCE and MAINTENANCE REPORT

STATION: **MANNTON PILLAR** TS No.: **6593**

MAP SHEET SCALE 1:250 000

INSPECTED BY: **W. MCGILLIVRAY** DATE: **11-7-90**

AUTHORITY: **CMA** FIELD BOOK: **1313**

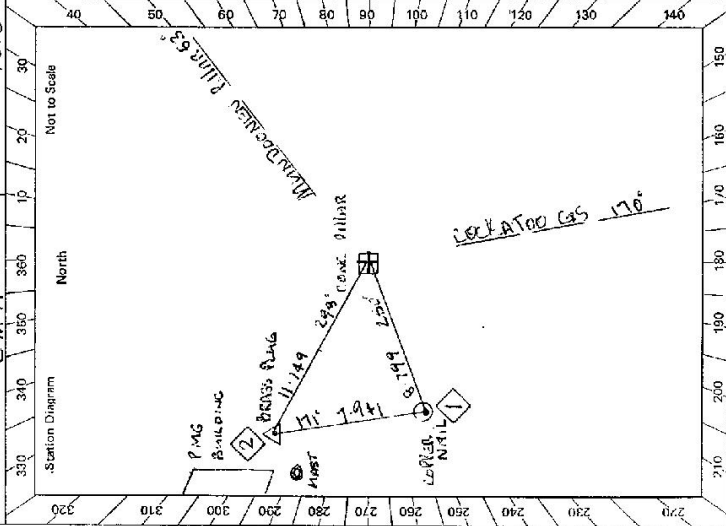

- Description:**
 Note: Cross out word or words which do not apply
- Cleared by lanes bearing **299** from Trig. Mast
 - Mast & Vanes have been painted white & black respectively. ✓
 - The station/pillar was unpiled/feet unpiled/constructed on **10** **7** **19** **30**, dimensions now being:
 Description of mark **Pillar Plate** should be explicit, e.g. S/Steel Pillar Plate, Steel plug, Brass plug, Bolt, G.I. Pipe
 Height of mark **3.30** m. ^{above} ~~below~~ **rock/concrete**. Mark is **1.530** m. ^{above} ~~below~~ **G.L.**
 - Height of Top Vanes to Top Mark/Pillar plate **1.430** m. Diameter of Vanes (vertical) **0.760** m.
 Height of Cairn **0** m. Diameter of Cairn **0** m. Name Plate found/not found/placed.
 Length of Mast **0** m. (approximate if not unpiled)
 - BRASS PLUG** set in **conc/rock** has been placed/found, bearing **298** **0** M from Mast/Plug/Pillar
 - COPPER NAIL** set in **conc/rock** has been placed/found, bearing **250** **6** M from Mast/Plug/Pillar
 - ARMED MARK** set in **conc/rock** has been placed/found, bearing **153** **0** M from Mast/Plug/Pillar
 - A **0** set in **conc/rock** has been placed/found, bearing **0** **0** M from Mast/Plug/Pillar
 - Action required: **0**

STANDPOINT: CONCRETE PILLAR				STANDPOINT: BRASS TRIG PLUG			
Mark	Direction	Horiz. Distance	Height Difference	Mark	Direction	Horiz. Distance	Height Difference
MANTON P	359 59 60		above standpt.	MANTON P	359 59 60		above standpt.
BRASS PLUG	112 57 10		above standpt.	MANTON PILLAR	60 30 15	11.149	above standpt.
COPPER NAIL	175 33 40	8.779	below standpt.	COPPER NAIL	112 09 45	7.941	below standpt.
BRASS PLUG	240 35 30	11.149	below standpt.	LOCK ATOP GS	112 50 20		above standpt.
			above standpt.				below standpt.
			below standpt.				above standpt.
			above standpt.				below standpt.
			below standpt.				above standpt.

Prepared by: _____ Checked: _____ Noted on U.T.M. Card

GS 24

St 2738-3 D. West, Government Printer

<p>STATION MANTON Pillars Is 6593</p> <p>Owner's Name: ROY GARVER Address: MUNROGANAN Phone: YASS 271315</p> <p>Current Occupant: Address: Phone:</p> <p style="text-align: center;">ACCESS</p> <p>Access Report of H. J. 1980 was found suitable/unsuitable.</p> <p>0-0 POST OFFICE YASS, TRAVEL TOWARDS GARRELBURN.</p> <p>4-2 PASS CARREER ROAD ON RIGHT</p> <p>6-1 PASS GUARDRAIL ROAD ON RIGHT</p> <p>9-1 TURN LEFT OFF HUME HWY SIGN ON MAIN BOX "SUNNY RIDGE"</p> <p>12-3 TURN LEFT GATE CAMP LOCK. FOLLOW TRACK.</p> <p>12-9 GATE. FOLLOW TRACK TO G.S.</p> <p>13-7 G.S.</p> <p>OR</p> <p>0-0 P.O. YASS TRAVEL TO WARDE GARRELBURN.</p> <p>0-8 TURN LEFT INTO BROWN ST.</p> <p>1-1 VIELE RIGHT. ONTO MORTON AVE.</p> <p>3-6 WOODEN BRIDGE</p> <p>5-1 TURN RIGHT</p> <p>6-6 TURN RIGHT GATE CIVIA LOCK.</p> <p>7-7 GATE</p> <p>7-9 G.S.</p>	<p>Beacon Diagram</p> <p style="text-align: right;">Not to Scale</p> <p>This section to be completed by officer constructing pillar.</p> <p>Original station mark found/not found.</p> <p>Description of mark: BRASS PLAS</p> <p>Original beacon found/not found.</p> <p>Description of beacon: ROCK CAIRN, MAST & VANES</p> <p>Height Top of Vanes to Top Mark: 3.700 m.</p> <p>Height of mark: 0.60m above rock/bene. m. below G.L.</p> <p>Diameter of Vanes: 0.30 m. Height of Cairn: 1.70 m.</p> <p>Original Beacon has/has not been destroyed by me.</p>
--	--