

TS 6582

STATION: *PICKA BERRABA*
 MAP SHEET SCALE 1:250 000
 No.: *3717*

INSPECTED BY: *M.L. Morrison* DATE: *15/10/79*
 AUTHORITY: *C.M.A.* FIELD BOOK: *1798*

Station Diagram
 330 340 350 360 370 380 390 400 410 420 430
 220 230 240 250 260 270 280 290 300 310 320

TRIS PD UNPILED VANES ISSUE
 MAST BURNT.
 MUST ARMY SURVEY BRASS ANGLE
 FOUND (TRIG MARK)
 * 55m in Conc. ft. G.I. Pipe in Conc. ft.
 Abt 1/2 day clearing for fill
 vision except for large trees
 at eastern end of ridge -> Abt
 1 day for this.
 TRIS PILLARABLE. IF CONCRETE PILLAR
 NOT POSSIBLE A MAST/PILLAR IS BUT
 A BASE WOULD HAVE TO BE dug FOR IT.
 * 55m in Conc. ft. 18d in 2.4m
 G.I. Pipe - Conc. ft. 6.1m 2.07m

Geodetic Station Reconnaissance and Maintenance Report
 Note: Cross out word or words which do not apply
 1. Cleared by lanes bearing..... from Trig. Mast
 2. Mast & Vanes have been painted white & black respectively.
 3. The station/pillar was unpiled/not unpiled/constructed on....., dimensions now being:
 Description of mark..... should be explicit, e.g., S/Steel Pillar Plate, Steel Plug, Brass Plug, Bolt, G.I. Pipe
 Height of mark.....m. above/below rock/concrete; Mark is.....m. above/below G.L.
 Height of Top Vanes to Top Mark/Pillar plate.....m. Diameter of Vanes (vertical).....m.
 Height of Cairn.....m. Diameter of Cairn.....m. Name Plate found/not found/placed.
 Length of Mast.....m. (approximate if not unpiled)

4. A..... set in conc/rock has been placed/found, bearing.....°M from Mast/Plug/Pillar
 5. A..... set in conc/rock has been placed/found, bearing.....°M from Mast/Plug/Pillar
 6. A..... set in conc/rock has been placed/found, bearing.....°M from Mast/Plug/Pillar
 7. A..... set in conc/rock has been placed/found, bearing.....°M from Mast/Plug/Pillar
 8. Action required:.....

STANDPOINT:			
Mark	Direction	Horiz. Distance	Height Difference
			above standpt.
			below standpt.
			above standpt.
			below standpt.
			above standpt.
			below standpt.
			above standpt.
			below standpt.
			above standpt.
			below standpt.

Prepared by: *[Signature]* Checked: *[Signature]*
 Noted on U.T.M. Card

Central Mapping Authority
 Geodetic Survey of NSW

G

STATION **POCKABOORBA. TS 6582**

Owner's Name: **FORESTRY COMMUN.**
 Address: **MOUNT BEDMORE STATE FOREST 16361**
 Current Occupant:
 Address:
 Phone:

ACCESS

Access Report of **15/10/19** was found suitable/unavailable.

Key Direction

- 0.00 **RAVINE RD. HEAD SOUTH.**
- 0.23 **TAKE RIGHT HAND FORK "BUSBY'S FLAT" "PIKARENE WYAN" "N" "WHYPAKE 18"**
- 9.08 **TURN LEFT AT "JUNCTION SIGN GRAPTON SD" "CAMMACK 15" "WHYPAKE 18"**
- 13.13 **TURN RIGHT "N" TO "WYON CK ROAD"**
- 23.53 **TURN RIGHT SIGN "HICKS ROAD MT BEDMORE S.F."**
- 23.74 **WIRE GATE**
- 23.82 **LOG BRIDGE**
- 23.97 **GATE FOLLOW TRACK STRAIGHT AHEAD**
- 24.08 **CREEK CROSSING (ROCKS)**
- 24.24 **TAKE L.H. FORK OVER GARD**
- 24.82 **LOG BRIDGE (WOULD NOT TAKE HEADS LOAD. CREEK CROSSING MEET TO IT OUR LEFT)**
- 26.36 **TAKE R.H. FORK SIGN "HICKS RD MT BEDMORE S.F."**
- 27.70 **TAKE R.H. FORK**
- 29.38 **PASS TRACK ON RIGHT.**
- 31.38 **PASS TICK GATE ON RIGHT.**
- 32.01 **PASS TRACK ON LEFT.**
- 32.49 **IF NO KEY AVAILABLE TRACK TRUCK AT TOB-F-RISE ABT / SIGN CRY WALK WITHIN**
- 32.91 **LOCKED TICK GATE / JACKSON FORESTRY LOCK. 1 LOCKWOOD BEPTUNG LOG**

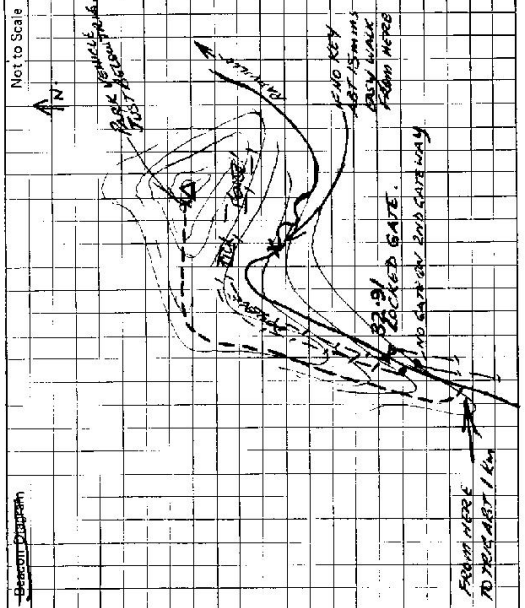

This section to be completed by officer constructing pillar.

Original station mark found/not found.

Description of mark:

Original beacon found/not found.

Description of beacon:

Height Top of Vanes to Top Markm.

Height of markm. above G.L. below

Diameter of Vanesm. Height of Cairnm.

Original Beacon has/has not been destroyed by me.

NOTE

Board of tick control has given approval for a CMA lock to be placed on the "Mt Bedmore Gate". Two things to suggest contact Inspector in Charge at Maitland. C. Peterson when lock placed. Access should be allowed so that it says where the tick gate is and how to get through it. 9 Aug 21. 1980

CENTRAL MAPPING AUTHORITY

GEODETIC SURVEY OF A.S.W.
 GEODETIC STATION RECONNAISSANCE and MAINTENANCE REPORT

STATION: PICKAPENS (Pillar) G.S. No.: TS 6582

MAP SHEET SCALE 1:250 000

INSPECTED BY: D J Kain DATE: 4 July 1980

AUTHORITY: C.M.A. FIELD BOOK: J 1980

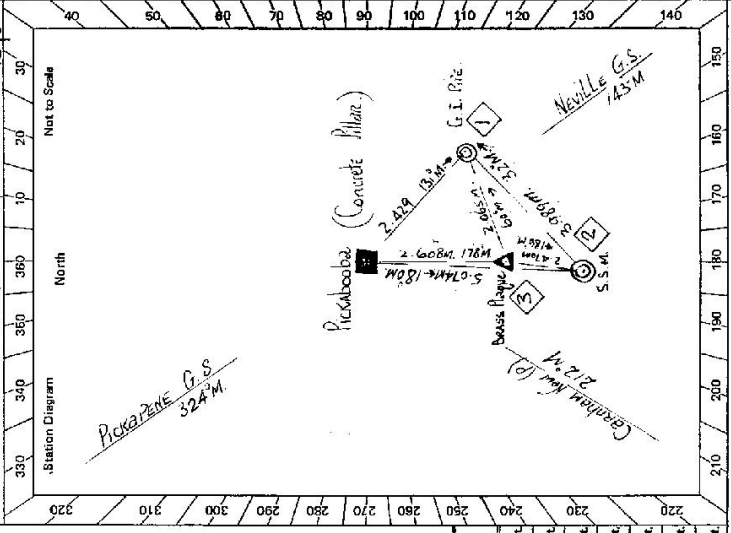

- Description:
1. Cleared by lanes bearing 125° 122° from Trig. Mast pillar. *Note: Cross out word or words which do not apply*
 2. Mast & Vanes have been painted white & black respectively.
 3. The station/pillar was ~~constructed~~ constructed on 26° 19° dimensions now being: Description of mark: ~~S/Steel Pillar~~ S/Steel Pillar Plate, Steel plug, Brass plug, Bolt, G.I. Pipe
 - Height of mark 1.310 m. ^{above} ~~rock/concrete~~ ^{above} G.L. Mark is 1.474 m. ^{above} G.L.
 - Height of Top Vanes to Top ~~Mast/Pillar plate~~ Mast/Pillar plate 1.449 m. Diameter of Vanes (vertical) 0.150 m.
 - Height of Cairn 0 m. Diameter of Cairn 0 m. Name Plate ~~placed~~ placed 4.120 m. Length of Mast 1.542 m. ~~(approximate if not completed)~~
 - A ~~set in conc/rock~~ set in conc/rock has been ~~placed~~ found, bearing 177° $0'$ M from ~~Mast/Pillar~~ Mast/Pillar
 - A ~~set in conc/rock~~ set in conc/rock has been ~~placed~~ found, bearing 180° $0'$ M from ~~Mast/Pillar~~ Mast/Pillar
 - A ~~set in conc/rock~~ set in conc/rock has been ~~placed~~ found, bearing 173° $0'$ M from ~~Mast/Pillar~~ Mast/Pillar
 - A ~~set in conc/rock~~ set in conc/rock has been ~~placed~~ found, bearing 173° $0'$ M from ~~Mast/Pillar~~ Mast/Pillar

8. Action required: ~~Concrete observation Pillar~~ **Trig. Plaque.**

Mark	Direction	Horiz. Distance	Height Difference	Mark	Direction	Horiz. Distance	Height Difference
Neville G.S.	$0^\circ 00' 00''$		above standpt.	Neville G.S.	$0^\circ 00' 00''$		above standpt.
Trig. Mast	$35^\circ 38' 39''$	2.608	below standpt.	S.S.M.	$40^\circ 01' 02''$	2.470	above standpt.
S.S.M.	$37^\circ 46' 48''$	5.074	below standpt.	Carnham New (P)	$65^\circ 54' 10.5''$		above standpt.
Carnham New (P)	$65^\circ 53' 55.5''$		below standpt.	Pickapens G.S.	$177^\circ 24' 01''$		above standpt.
Pickapens G.S.	$177^\circ 23' 19''$		below standpt.	Cont. obs. Pillar	$215^\circ 40' 16.5''$	2.608	above standpt.
G.I. Pipe	$347^\circ 20' 43.5''$	2.429	below standpt.	G.I. pipe	$276^\circ 58' 16''$	2.065	below standpt.

Prepared by: *[Signature]* Noted on U.T.M. Card
 Checked: *[Signature]*

