

CENTRAL MAPPING AUTHORITY

GEODETIC SURVEY OF N.S.W.  
 GEODETIC STATION RECONNAISSANCE and MAINTENANCE REPORT

Description:  
 1. Cleared by lanes bearing.....  
 Note: Cross out word or words which do not apply

2. Mast & Vanes have been painted white & black respectively.  
 3. The station/pillar was unpiled/not unpiled/constructed on.....19....., dimensions now being:

Description of mark.....should be explicit, e.g., S/Steel Pillar Plate, Steel plug, Brass plug, Bolt, G.I. Pipe  
 Height of mark.....m.....<sup>above</sup>/<sub>below</sub> rock/concrete; Mark is.....m.....<sup>above</sup>/<sub>below</sub> G.L.

Height of Top Vanes to Top Mark/Pillar plate .....m. Diameter of Vanes (vertical).....m.  
 Height of Cairn.....m. Diameter of Cairn.....m. Name Plate found/not found/placed.

Length of Mast .....m. (approximate if not unpiled)

4. A.....set in conc/rock has been placed/found, bearing.....°M from Mast/Plug/Pillar  
 5. A.....set in conc/rock has been placed/found, bearing.....°M from Mast/Plug/Pillar

6. A.....set in conc/rock has been placed/found, bearing.....°M from Mast/Plug/Pillar  
 7. A.....set in conc/rock has been placed/found, bearing.....°M from Mast/Plug/Pillar

8. Action required:.....

STANDPOINT:

Mark	Direction	Horiz. Distance	Height Difference	Mark	Direction	Horiz. Distance	Height Difference
			above standpt.				above standpt.
			below standpt.				below standpt.
			above standpt.				above standpt.
			below standpt.				below standpt.
			above standpt.				above standpt.
			below standpt.				below standpt.
			above standpt.				above standpt.
			below standpt.				below standpt.

Prepared by: *[Signature]* S1119  
 Checked: *[Signature]*  
 Noted on U.T.M. Card

STATION: *BARYULEIL* \* *6557*  
 No.: *772*  
 MAP SHEET SCALE 1:250 000 *GRAFTON*  
 INSPECTED BY: *M.L. Morrison* DATE: *15/10/99*  
 AUTHORITY: *C.M.A.* FIELD BOOK: *1798*

Station Diagram  
 North  
 320 330 340 350 360 370 380 390 400  
 220 230 240 250 260 270 280 290 300 310 320

*Trig set down no other marks for.*  
*OWNER OF LAND ON BOTH SIDES OF TICK FENCES GAVE PERMISSION TO CLEAR TIMBER AND ACCESS AT ANY TIME*  
*TRIG IS IN BETWEEN TWO TICK FENCES*  
*Abt 1 to 2 days Clearing Required for 360° vision. +*  
*CONCRETE PILLAR POSSIBLE.*  
 PERMISSION OBTAINED FROM BOARD OF TICK CONTROL TO CONSTRUCT PILLAR + CLEAR BETWEEN FENCES FILE 55/1/580.  
 COPY OF LETTER ATTACHED WITH CONDITIONS.

Checked



GEODETTIC SURVEY OF N.S.W.

CENTRAL MAPPING AUTHORITY

GEODETTIC STATION RECONNAISSANCE and MAINTENANCE REPORT

STATION: BARRULGIL (1) No: 6557

MAP SHEET SCALE 1:250 000

INSPECTED BY: L. O. HOLLIS DATE: 20th June 2020

AUTHORITY: C.M.A. FIELD BOOK: 1815

- Description:
- Note: Cross out word or words which do not apply
- Cleared by lanes bearing..... from Trig, Mast
  - Mast & Vanes have been painted white & black respectively. ✓
  - The ~~station~~/pillar was ~~unplaced~~/~~not replaced~~/constructed on ~~rock~~/~~concrete~~..... 19.80m, dimensions now being: Description of mark: ~~Mast~~..... should be explicit, e.g. S/Steel Pillar Plate, Steel plug, Brass plug, Bolt, G.I. Pipe Height of mark.....m, above ~~below~~ ~~rock~~/concrete; Mark is ~~1.50m~~.....m, above ~~below~~ G.L.
  - Height of Top Vanes to Top Mast/Pillar plate.....m. Diameter of Vanes (vertical). 300.....m.
  - Height of Cairn.....m. Diameter of Cairn.....m. Name Plate ~~found~~/not found/placed.
  - Length of Mast.....m. (approximate if not unplaced)
  - A ~~Cairn~~..... set in conc/rock has been placed/found, bearing.....°M from Mast/Plug/Pillar
  - A ~~Cairn~~..... set in conc/rock has been placed/found, bearing.....°M from Mast/Plug/Pillar
  - A..... set in conc/rock has been placed/found, bearing.....°M from Mast/Plug/Pillar
  - A..... set in conc/rock has been placed/found, bearing.....°M from Mast/Plug/Pillar
  - Action required: ~~Maint. Route~~.....

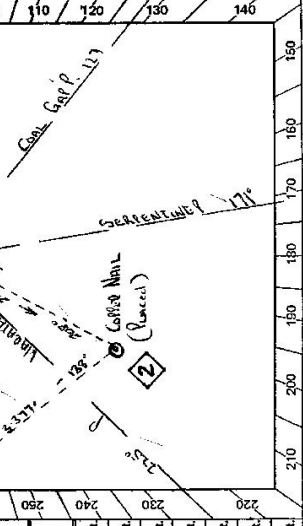

STANDPOINT: <u>Pillar Plate</u>		STANDPOINT: <u>Concrete Cairn</u>	
Mark	Direction	Mark	Direction
<u>Cairn 1</u>	<u>0 00 00</u>	<u>Cairn 1</u>	<u>0 00 00</u>
<u>Cairn 2</u>	<u>43 14 10</u>	<u>Cairn 2</u>	<u>9 14 30</u>
<u>Cairn 3</u>	<u>77 42 20</u>	<u>Station</u>	<u>43 13 10</u>
<u>Mast</u>	<u>94 14 50</u>	<u>Mast</u>	<u>94 14 50</u>
<u>Concrete Cairn</u>	<u>138 27 10</u>	<u>Pillar Plate</u>	<u>148 28 40</u>
			<u>178 28 40</u>
			<u>178 28 40</u>
			<u>178 28 40</u>

Prepared by: [Signature] Checked: [Signature] Noted on U.T.M. Card

61-2733-2 D. West Government Printer

STATION Banyuwangi P. 6557

Owner's Name: .....  
 Current Occupant: .....  
 Address: .....  
 Phone: .....  
 Phone: .....

ACCESS  
 Access Report of 3/16/1982 was found suitable/unsuitable.

Feature  
 Directional Rd Head Towards Gunung  
 Road "Crampon Rd" on Left  
 Hill Gate (Manned)  
 Turn Left Turntable. Hill Gate Just After Meads at Foundry Hill  
 Hill at "0.75" Sign Foundry Tunnel Down to Right side Gate.  
 Gate  
 Turn Left Through Campground - Foundry Field Line  
 Gate Foundry Tunnel  
 Hill off Road to Right to Field and Follow of Ridge Marking  
 Fence on Hill Gate  
 Hill Gate  
 Fence - Turn 20 metres other side

Notes  
 H. Morrison Access Found Suitable

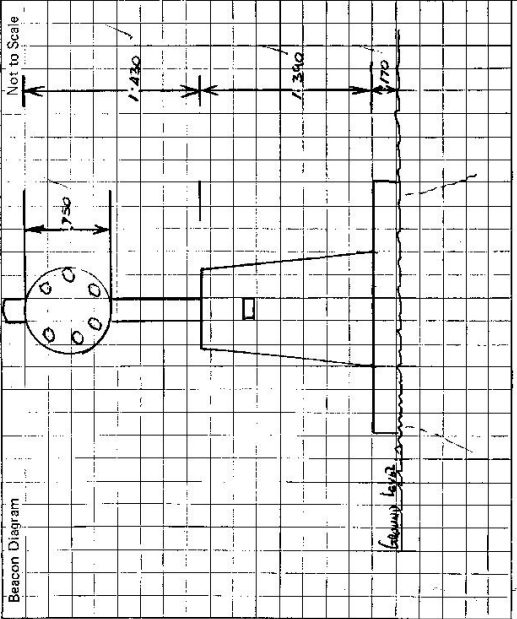

This section to be completed by officer constructing pillar.

Original station mark found/~~not found~~.  
 Description of mark: Concrete Pillar on Level  
 Original beacon found/~~not found~~.  
 Description of beacon: Concrete Pillar with 4 Vanes  
 Height Top of Vanes to Top Mark 1.430 m.  
 Height of mark: 1.430 m. above ~~below~~ G.L.  
 Diameter of Vanes 100 mm. Height of Cairn 1.430 m.  
 Original Beacon has/~~has not~~ been destroyed by me.

Date	Record of Station